

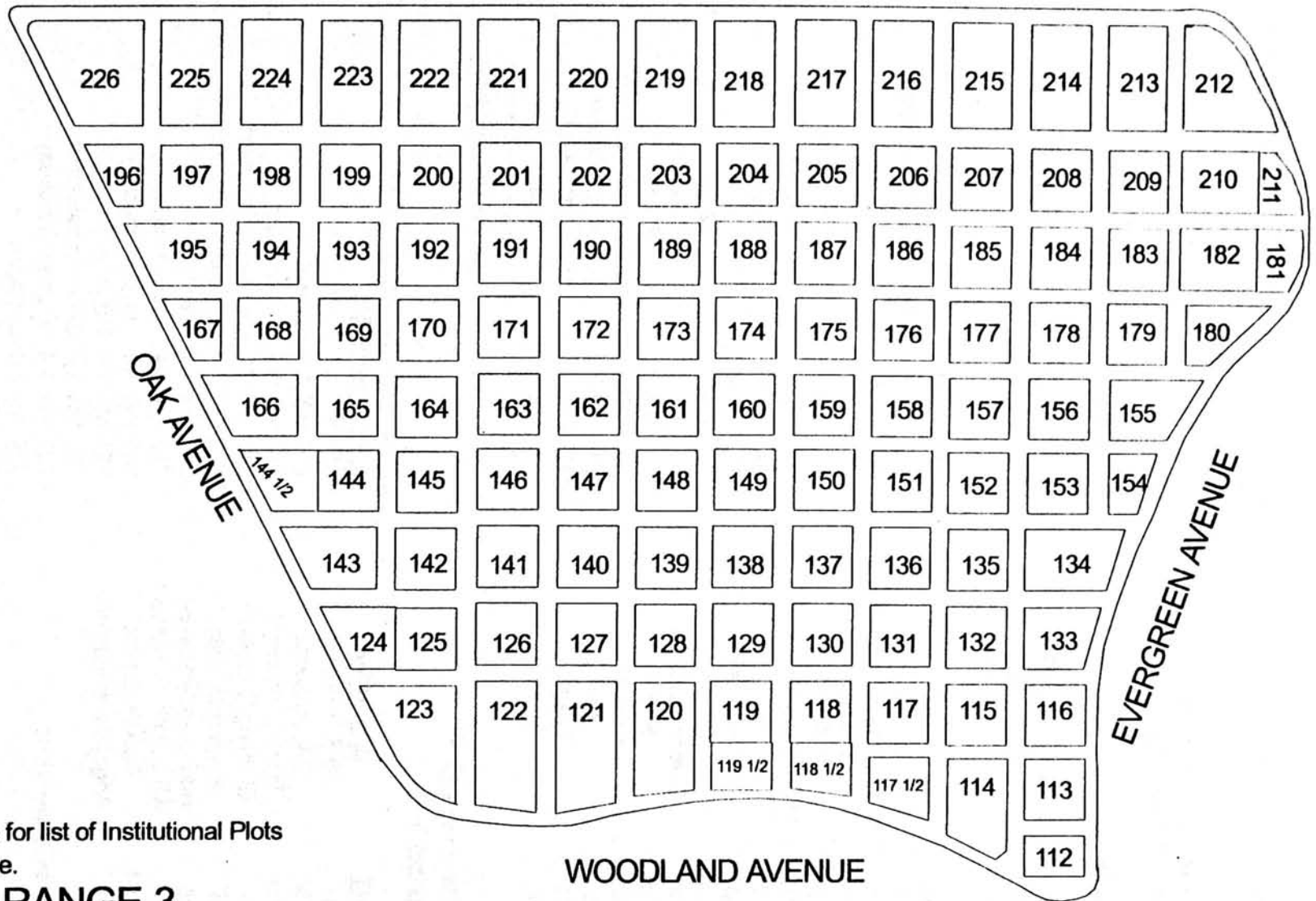



FOREST AVENUE



See reverse for list of Institutional Plots in this Range.

# RANGE 3 Lots 112-226

Frank Gillespie July 1999  
The Friends of Mount Hope Cemetery

**RANGE 3**

Lots 112-226

Stone listings from Forest Avenue to  
Woodland Avenue (West to East)

Lot 123 Western NY Institute For Deaf Mutes Plot  
Lot 165 Congregation Beth Israel  
Lot 212 New Scottish Burial Plot  
Lot 226 Congregation Bena David

**Oak Avenue Side**

<u>LOT</u>	<u>PART</u>	<u>SURNAME</u>
226	All	Levinson
226	All	Bloom
226	All	Levy
196	W pt	Kohler
196	E pt	Schulz Monument
195	SW pt	Patteron.Attridge Monument
195	SE pt	Shumway
167	SW 1/4	Tosch
167	E pt	Allush/Kuss Monument
166	SW pt	Percy
166	SE pt	Kenneweg
144 1/2	SW 1/4	Sands
144 1/2	NE pt	Barber Monument
143	SW pt	Frank
143	SE pt	Balmain
124	W pt	Kay
124	E pt	Nagell
123	All	Nodine

**Evergreen Avenue Side**

<u>LOT</u>	<u>PART</u>	<u>SURNAME</u>
212	All	No stones
211	All	Pitcher
211	All	Springer
181	W pt	Salter
181	E pt	Bradstreet Monument
180	All	Cornwell
180	All	Keehn
155	NW pt	Albrect
155	NE 1/4	Hummel
154	W pt	Briggs
154	E pt	Huber
134	NW pt	Ferster
134	NE pt	Fritsche
133	NW pt	Elwood
133	NE pt	Smith/Bishop Monument
116	All	Seaman Monument
113	NW 1/4	Johnson Monument
113	NE 1/4	McLean
112	W pt	Macpherson Monument
112	E pt	Angevine Monument

Listings from Oak to Evergreen

**Woodland Avenue Side**

<u>LOT</u>	<u>PART</u>	<u>SURNAME</u>
122	S pt	S & R Reuter
121	SE pt	E&J Williams
120	SE pt	Martin monument
119 1/2	All	Dunning (3 stones)
118 1/2	All	Parry monument
117 1/2	N pt	Hotchkiss (4 stones)
117 1/2	N pt	J&S Dobbin monument
114	NE 1/4	Tucker obelisk
112	E pt	Angevine monument

Listings from Evergreen to Oak

**Forest Avenue Side**

213	SW 1/4	J. Redfern
214	SW 1/4	J. Emler
215	NW 1/4	M. Holthauer
216	W 1/2	Collinson monument
217	SW 1/4	Kussmaul monument
218	NW 1/4	A&H Virkus
219	SW 1/4	Jones monument
220	SW 1/4	Briggs (4 stones)
221	NW 1/4	Martin (4 stones)
222	NW 1/4	Schmitt monument
223	NW 1/4	Gosnell (3 stones)
224	NW 1/4	L. Fagan
225	NW 1/4	C. Kalwas

Frank Gillespie Revised September 2001

MT. HOPE CEMETERY, PLOT RECORD

RANGE SECTION } 3

LOT NO. 180

Form 1

KEEHN-CORNWALL.  
ALL-180.R3  
PERPETUAL CONTRACT.

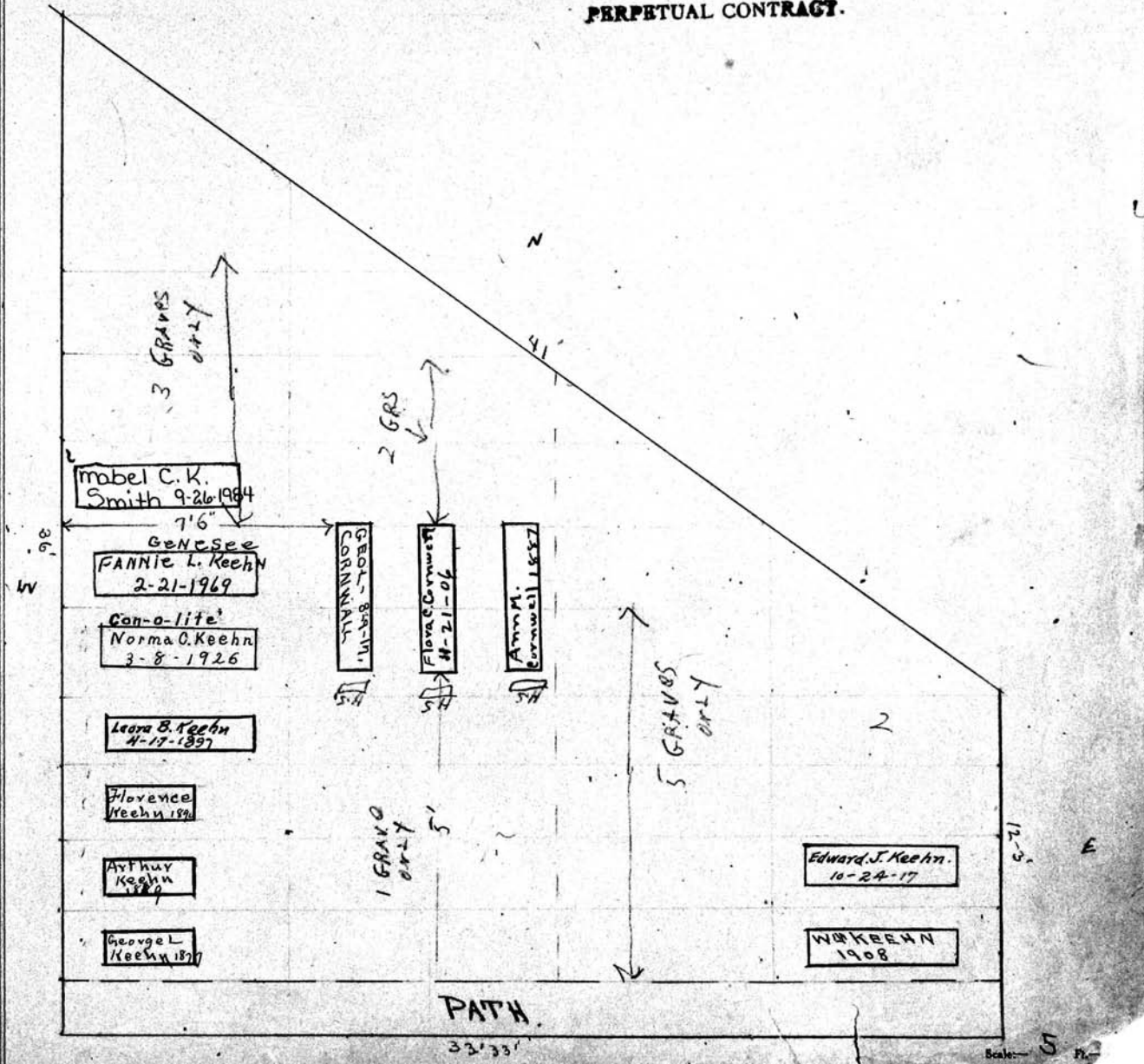

MT. HOPE CEMETERY, PLOT RECORD

RANGE SECTION } 3

LOT NO. 181

Form 1

N

Joseph Lewis

Cleveland S. Bradstreet

West Pt

East, Pt

P.C. 1/1/50 \$200.00 AM S.C.

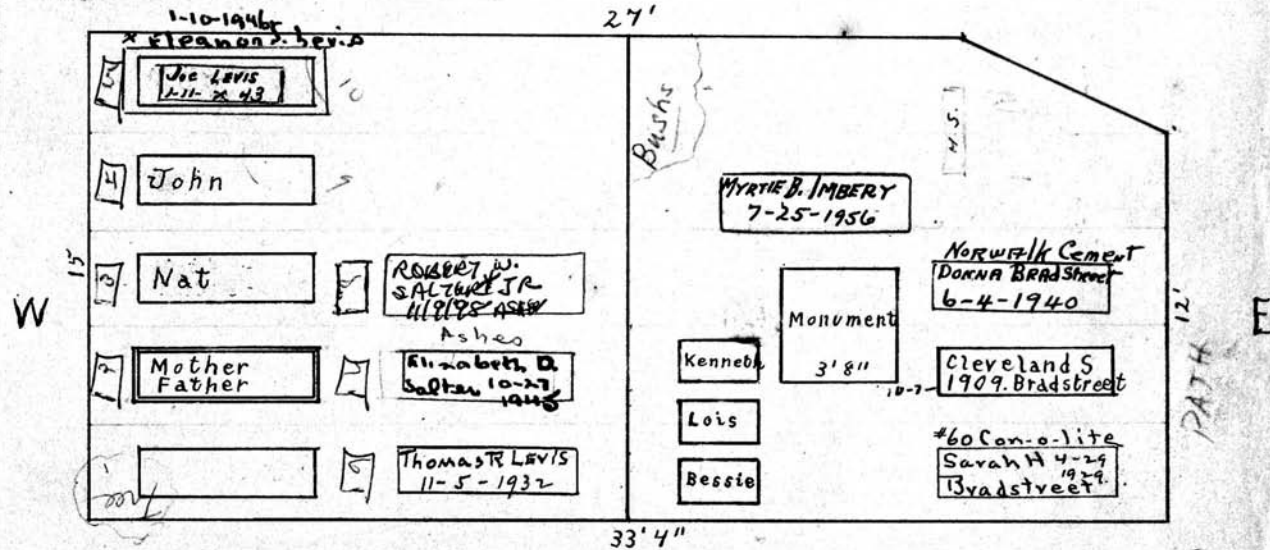

S

Scale: 5" Ft. - 1 Inch.

MT. HOPE CEMETERY, PLOT RECORD

RANGE SECTION

3 LOT NO. 182

Form 1

Robert L. Milliman

Morris Fiedler

N.W. 1/4

N.E. 1/4-182

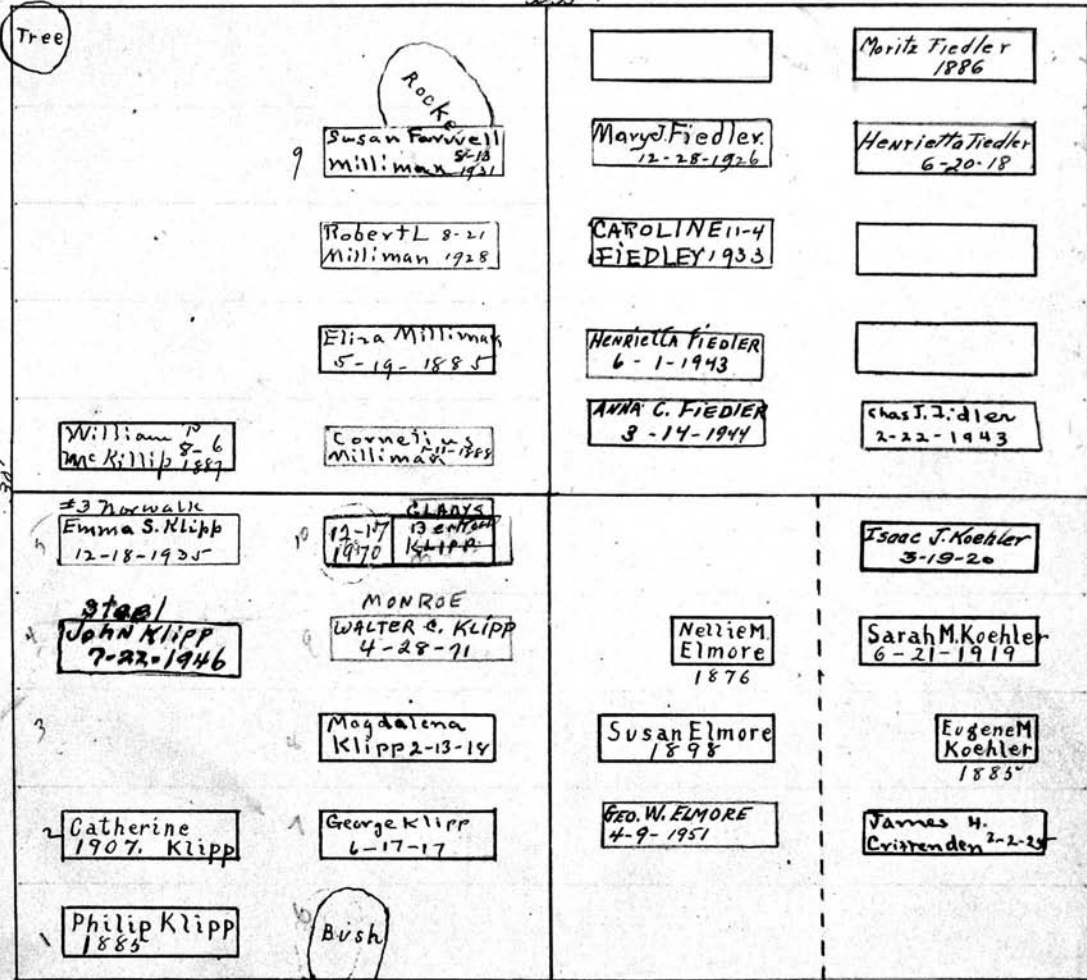

Katherine and Geo Klipp  
S.W. 1/4

Isaac Koehler. E 1/2 of SE 1/4  
Susan Elmore. W 1/2 of SE 1/4

Scale: 5 Ft. = 1 Inch.

MT. HOPE CEMETERY, PLOT RECORD

RANGE SECTION

3

LOT NO.

183

Form 1

John G. Van Vechten

Gertrude Williams

N.W. 1/4

N.E. 1/4

16'8"

16'8"

See GC  
missed up

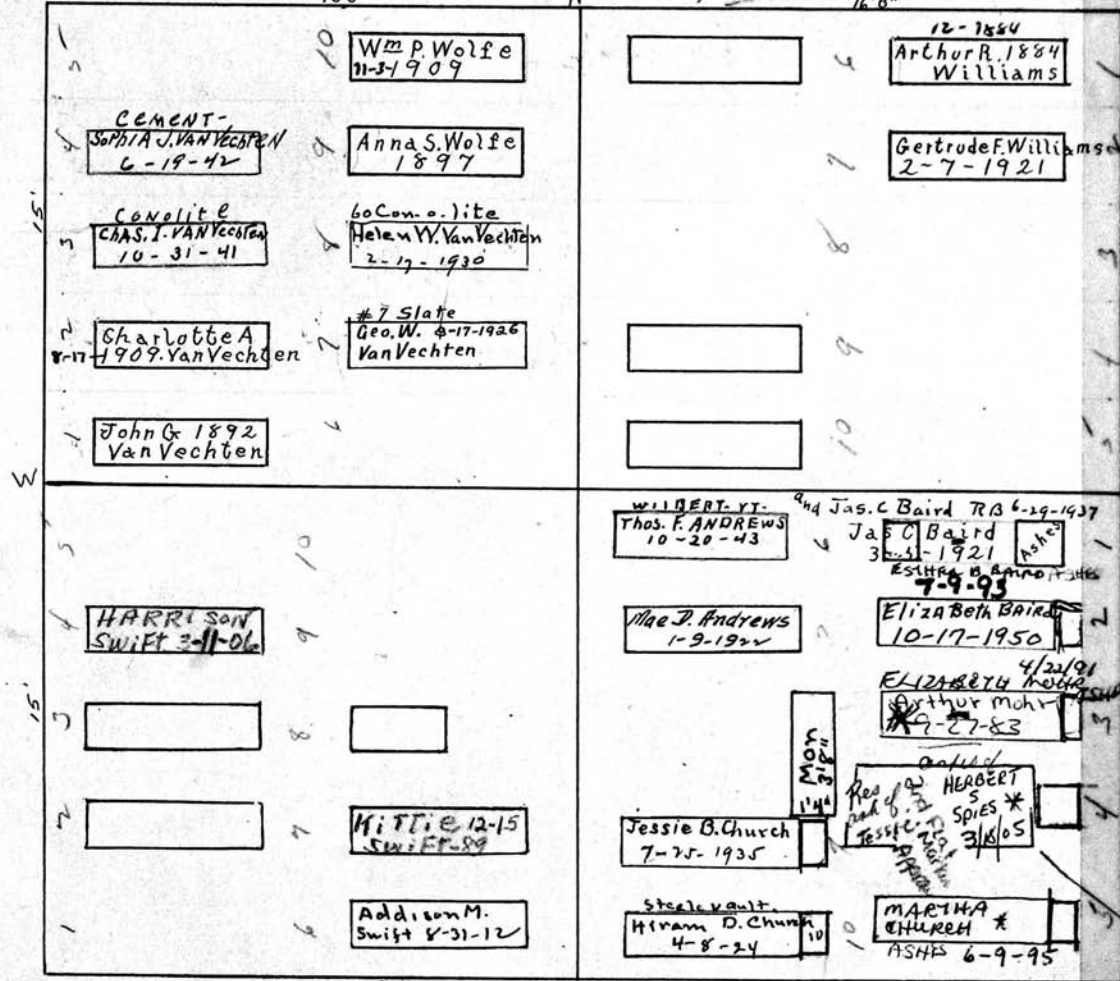

CEMENT-  
Sophia J. VAN VECHTEN  
6-19-42

CONOLITE  
CHAS. J. VAN VECHTEN  
10-31-41

Charlotte A.  
1909 Van Vechten

John G. 1892  
Van Vechten

Wm P. Wolfe  
11-3-1909

Anna S. Wolfe  
1897

60 Con. o. lite  
Helen W. Van Vechten  
2-17-1930

#7 Slate  
Geo. W. 17-1926  
Van Vechten

12-1884  
Arthur R. Williams

Gertrude F. Williams  
2-7-1921

WILBERT VT.  
THOS. F. ANDREWS  
10-20-43

Mae J. Andrews  
1-9-1922

Jessie B. Church  
7-25-1935

Steele vault.  
Hiram D. Church  
4-8-24

Jas. C. Baird  
3-31-1921

ELIZABETH BAIRD  
10-17-1950

ELIZABETH  
4/22/91

HERBERT  
SPIES  
3/18/05

MARTHA  
CHURCH  
ASHB 6-9-95

See GC

CAROLINE SWIFT 12-10-1889

A.M. and C.C. Swift.

S.W. 1/4

PERPETUAL CONTRACT  
James C. Baird  
1500  
1/22/04

SE. 1/4

THOMAS FROTHINGHAM 4-1887  
MARY A. FROTHINGHAM 5-1888  
GERTRUDE WILLIAMS 7/13/1884

Note:  
See order  
in file  
directing  
use of vault  
on plot  
12-21-1950

Scale: - 1/4 inch

MT. HOPE CEMETERY, PLOT RECORD

RANGE SECTION

3

LOT NO.

184

Form 1

John G. Peter  
 Transferred to Aunt's Sauer by deed 6-15-1903.  
 N.W. 1/4

Joseph A. Smith  
 see order on file  
 N.E. 1/4  
 Joseph Smith 1899  
 Margaret " 1894  
 Thomas " 1899  
 Mary A " 1841  
 M. May " 1824

See G.C.

s/2/58  
 Dig this  
 XXX AT  
 1st RY  
 3 RY  
 DUG  
 XXX  
 DEEP

5	*63 Con-o-lite Barbara A. Sauer 9-2-31 Steel Vault	FLORANCE S. KNIGHT 4-17-63	August L. 8-26 Lehnkering 1925	6	Father
4	GUSTAVE 3-31 SAUER 1934.	ALFRED C. KNIGHT 4-16-1968	Ada Lehnkering 10-25-1927		Mother
3	Anna B. Peter 1903		Geo SYBIL Henshaw	Mon 2'	Eucine E. Smith 10-18-21
2	John G Peter 1885	Wm. Peter 1863	Em C. Henshaw 9-20-1946	9	Thomas
1	Jessie Listmann	Jean E. Howell 3-24-34	MARY ANCH HARRIETTE H. HENSHAW 10-5-60		HARRIET J. LEHNKERING 11-12-43
5	ELISE KURFURST 2-2-1937	ALBERT LISTMANN 12-21	JDA S. PAGELS 6-8-1957 CONOLITE VAULT	6	Christian Dammann 1857
4	MABEL L. BROWN 4-14-1956	WALTER J. SNIDER 3-21-1952 Roth 7-1952 4/30/59	LOUISE LEAVENS 6-11-1965	Edward Leavens 1-18-12	Sophia 1865 Dammann
3	Pauline Listmann 2-12-1905	MAUD L. SNIDER 11-23-1956	EDW. R. LEAVENS 5-7-1959	5-0' MON	Joachim Pagels 8-26-1915
2	Chas. H. Listmann	Lois Snider 4-7-1928	BERTHA PAGELS 7-12-1954 CON-o-lite VAULT		Louise M. Pagels 12-11-31
1			Bjorn Sigurdson 7-11-74		Joanette Sigurdson 7-11-74
					EMMA E. PAGELS 8-4-1950 CONOLITE VAULT

PERPETUAL CONTRACT

Pauline Listmann

Christian Dammann

S.W. 1/4

S.E. 1/4

Scale - 1/4" = 1 foot



MT. HOPE CEMETERY, PLOT RECORD

RANGE } 3  
SECTION }

LOT NO. 185

Form 1

Chas & Mary & Alt<sup>N</sup>  
N.W. 1/4

Addison W Bradstreet

N.E. 1/4

PERPETUAL CONTRACT

33.33.

11	Catherine Alt Steffen 3-12-32	11	Florence Edna AIT 4-11-1972 MURKIN	6	Addison Bradstreet 1906
4	George G. Alt 3-25-1930	9	Wallis Alt. R.B. 4-2-08	7	Florence Bradstreet 1885
3	Frank	8	Mabel. alt	8	ESIE B. Hixon 3-31-44
2	Maria Alt 1888	7	Conolite Catherine Alt 6-6-1938	9	
1	Geo Alt 1884	6	Conolite Charles C. Alt 3-16-1938	10	
5	Elwood Fowler 1904	01	Maria Fowler 1889	6	HEKRY Brautigam 1895
4	Freddie	6	Wm Fowler 1870	7	Rochester Anna C Bradshaw 6-3-71
3	Howard 1884	5	Mary Robinson 1896	8	CHARLES BRAUTIGAN 8-14-43
2	Carrie Fowler 1907	4	RUTH FOWLER FRIEND ASHES	9	Andrew Appel 6-15-1936
1	William P Fowler 9-9-27	3	ASHES FLORA A. FOWLER 11-2-66	10	Eliz. Appel 1-14-1937
		2	ASHES WILLIAM-FRANK-FOWLER 5-11-1967		Chas Stone 1897
					Amelia 11-1904 Stowe

Katherine  
Bradstreet  
Addison  
6-1-1906

See File

W

E

Wm P Fowler  
S.W. 1/4

Anna C. Bradshaw  
Catherine Brautigam

Note:  
Restricted S.F. 1  
Graves Reservations

200  
1-25-49

MT. HOPE CEMETERY, PLOT RECORD

RANGE / SECTION

3

LOT NO.

186

Form 1

12/29/04  
BABY NORMAN SEILS  
WAS REMOVED FROM CRIB  
AND PUT IN ETHERIAL CRIB  
AND PLACED IN CASKET  
WITH BROTHER  
CHARLES SEILS

Christopher Wamp

Cook & Plass

N. W 1/4

N. E 1/4

William J. Seils 11-29-1937	William Anthony Johnson 1-17-26		
BERTHA SEILS 8-13-1959	Elwood Seils 10-26-1926	John C. Cook 2-25-14	
Anna Wamp 1885	Etta M. Seils 6-17-16	Jeanette May Cook 11-1-1948	Frank Plass 10-14-13
Wilhelmina Wamp 2-26-1922	CLARENCE SEILS Norman Seils 1902 12/29/04 CONTINENTAL SEE NOTE	ELIZABETH PLASS 12-9-41	ANNA PLASS. 2-26-1935
Christopher Wamp 1905	ARTHUR C. SEILS 7-25-1956	Res Don W. Cook	1892 HAROLD PLASS
Leonard 1904 VanDevate	ISAAC VAN DEVATE 1900	Wm M. Cooper 12-22-1936	Wm. G 6-29- Ritter 1908
Diana 1890 VanDevate	LYADIA SMICH 11-2-42	Estella B. 9-24 Cooper 1934	Bulah 3-19 Ritter 1908
Kate	1-4-1982 HAZEL MAY BINDER	Conlita Cona Ritter 1-15-1947	
May R. 1896 VanDevate	Monroe GEO. B. BINDER 2-9-1966	Geo Bee Jorden Joe Kater Wilson	Edward Ritter 8-9-1926
Peter Vandevate July 9 1925	Ada Wood 2-17-1948	Louis Ritter 1-12-1943	Edwin B. Ritter 1-16-1932

See G.C.

See G.C.

Elizabeth  
1885

Russel  
Cook  
1893

W.M. PLASS  
1890

See  
G.C.

Leonard VanDevate

Bulah Ritter

S. W 1/4

S. E 1/4

Scale: 5 Ft. = 1 Inch

MT. HOPE CEMETERY, PLOT RECORD

RANGE } SECTION }

3

LOT NO.

-187

Form 1

Mrs. J. A. Walsh, Edgar Curtis -

Nellie <sup>Sec. G.C.</sup> Moerdyke

PERPETUAL CONTRACT.

W 1/2 of NW 1/4

E 1/2 of N.W. 1/4

N.E. 1/4

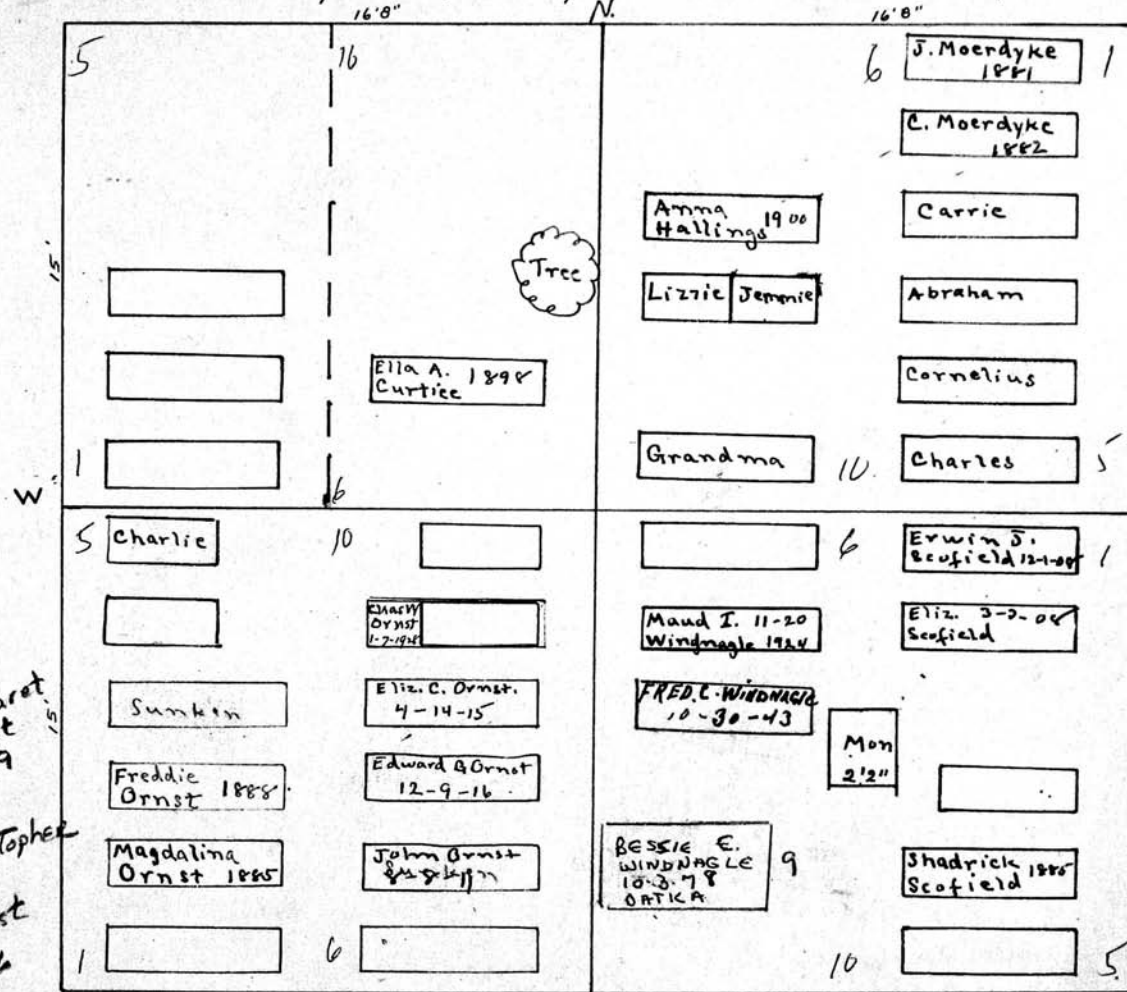

Margaret Ornst 1899  
Christopher Ornst 1896

Shadrick Scofield 1888  
Edwin J Scofield 1908  
Elizabeth Scofield 1908

Martin Ornst 1894

Chas. Ohrens

Fredk & Maude Windnagle

S.W. 1/4

S.E. 1/4

Scale - 5 Ft. - 1 Inch

MT. HOPE CEMETERY, PLOT RECORD

RANGE } SECTION }

3

LOT NO.

188

Form 1

Geo. Miller

James A. Pattee

PERPETUAL CONTRACT.

N.W. 1/4

N.E. 1/4

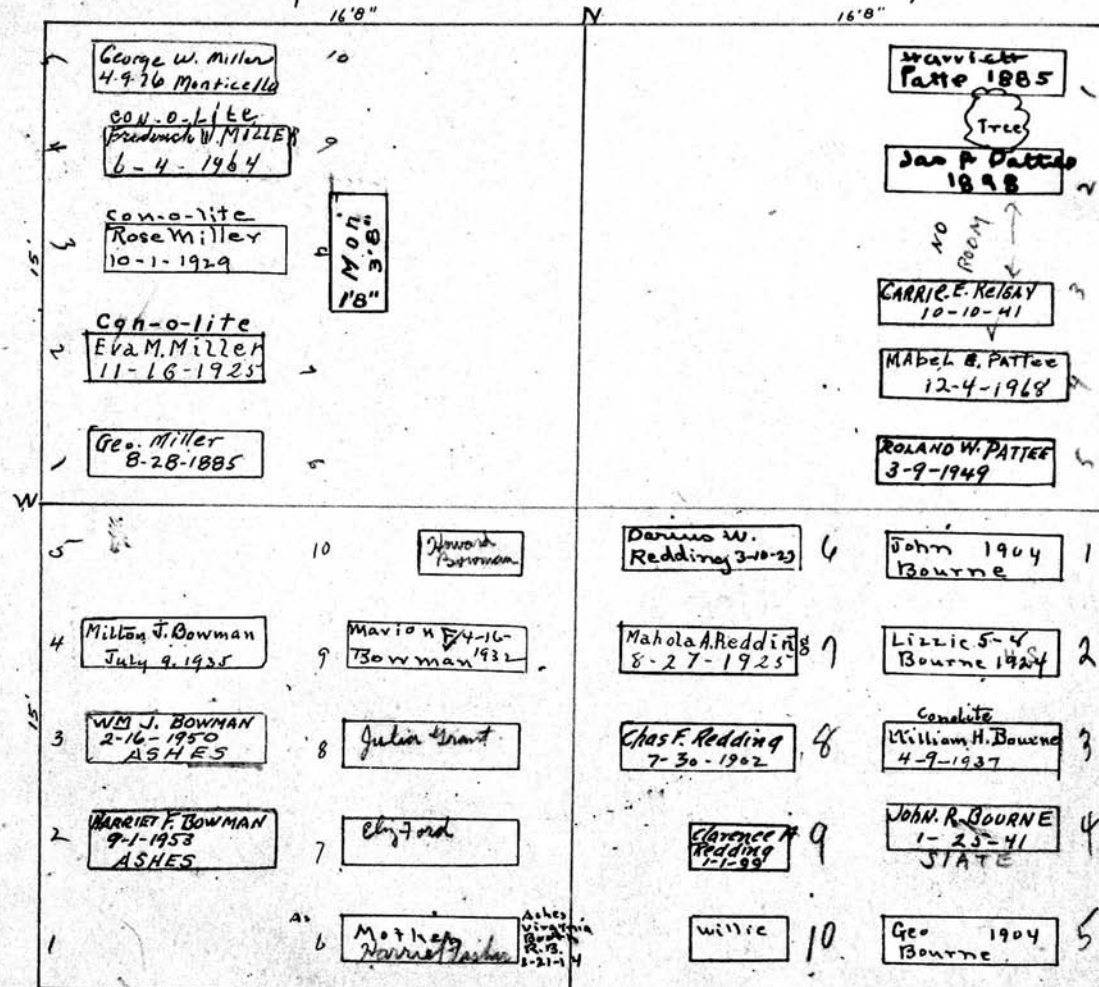

Fisher & McNalley

Bourne & Redding

S.W. 1/4

S.E. 1/4

Scale - 5 Ft. = 1 Inch

MT. HOPE CEMETERY, PLOT RECORD

RANGE SECTION

3

LOT NO.

187

Form 1

Kalamazoo Terra Lot & Blodge Co., Kalamazoo, Mich. K-22208

PERPETUAL CONTRACT

Kate Martin

Mary K Blaheney

8. C  
\$300.00  
1/19/62

N.W. 1/4  
16'8"

N.E. 1/4  
16'8"

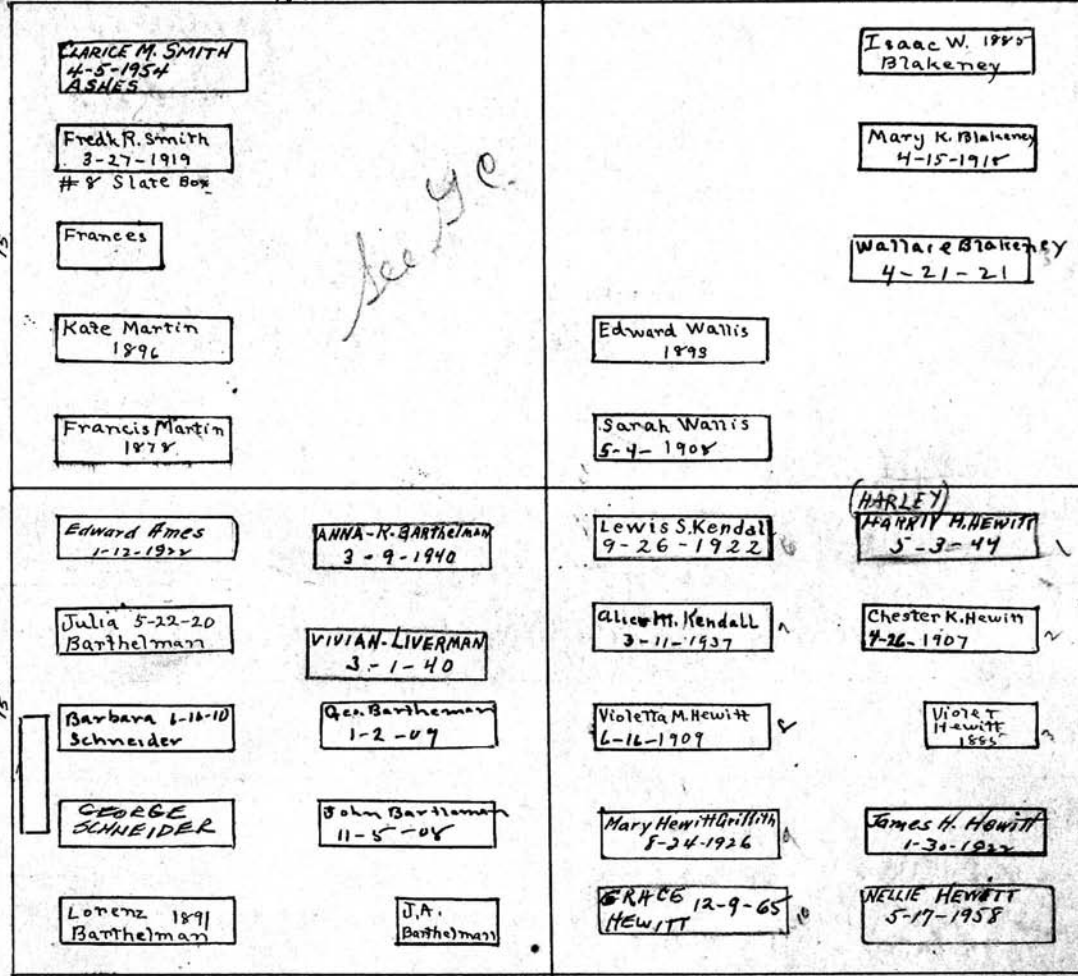

Samuel Barthelmann & Geo. Schneider - Violetta M. Hewitt

S.W. 1/4

S.E. 1/4

Scale - 5" = 1 inch

MT. HOPE CEMETERY, PLOT RECORD

RANGE 3 SECTION 1

LOT NO. 190

Form 1

Anna M. Kusterer

Gustave Kostbahn

See G.L. N.W. 1/4

N.E. 1/4

33.33

PERPETUAL CONTRACT

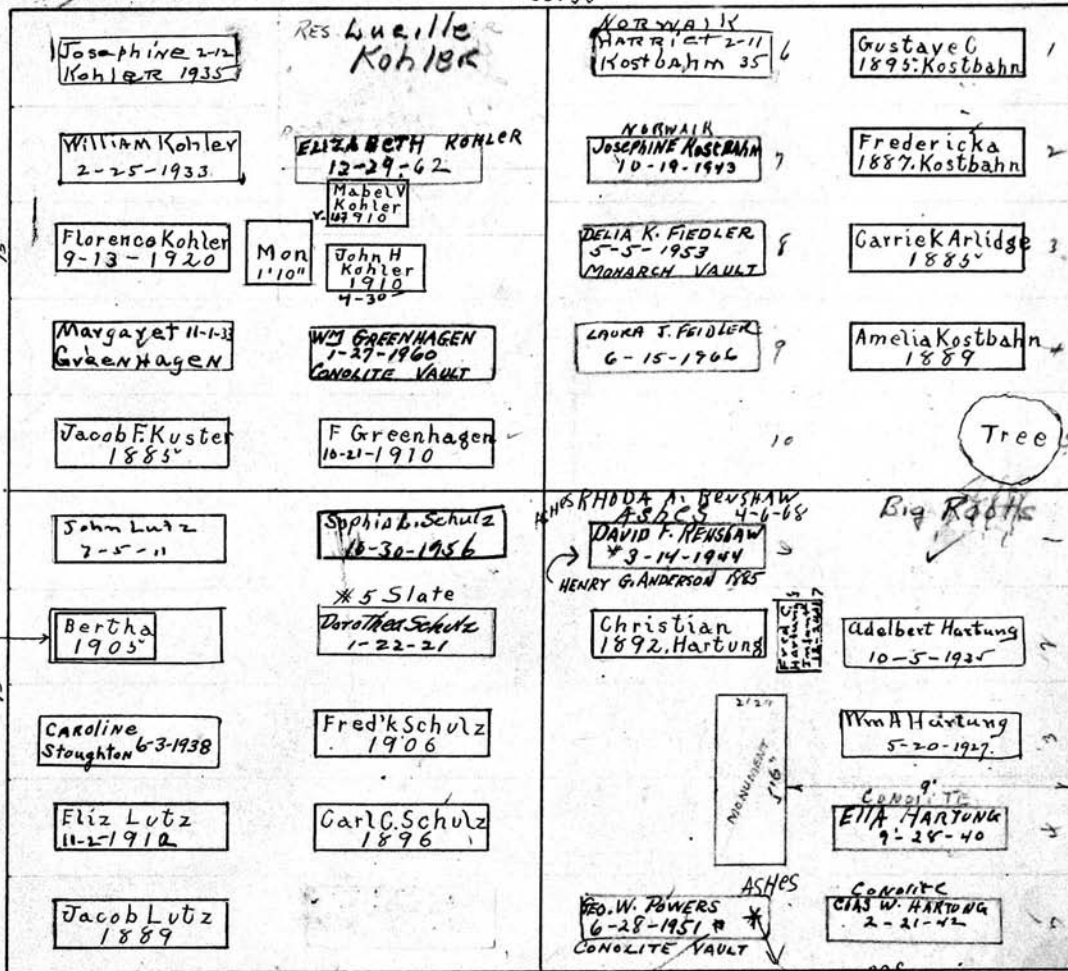

George Sloughton 8-27-1926

See file on hut

PERPETUAL CONTRACT

Lutz and Schulz S.W. 1/4

Jessie June McINTYRE 3-6-78 Charles W. Hartung S.E. 1/4

Scale - 5" = 1 inch

MT. HOPE CEMETERY, PLOT RECORD

RANGE } SECTION }

3 LOT NO. 191

Form 1

John P Lathrop<sup>0</sup>  
Sec. H.C. N.W. 1/4

PERPETUAL CONTRACT  
Henry D Guile. E 1/2 of NE 1/4  
Loomis S. Thompson. W 1/2 of NE 1/4  
33'33" Heads West

<p>Infant of Wm Allen 3-13-19</p> <p>Emily H Lathrop 2-19-1917</p> <p>Milton</p> <p>Alden</p> <p>Mother</p>	<p>2'5" Monument</p> <p>Mary Allen 12-29-1936</p> <p>Wm. C. Allen 7-29-1940</p>	<p>Loomis S. Thompson 5-11-1900</p> <p>Caroline C 1-7 Thompson 24</p> <p>Ella Thompson 1886</p> <p>C. Lila Thompson 1886</p>	<p>Henry D Guile 1-3-1927</p> <p>Mary T. Guile 7-20-1932</p> <p>RES. FOR FLORENCE GUILLE</p> <p>CHESTER Infant Guile 1885</p> <p>BELL GUILLE 6-29-1960</p> <p>Harriet Harnden 1909</p>
<p>Winfield S. Buck 1872</p> <p>Eliza F. Buck 1883</p> <p>Peter S. Buck 1891</p>	<p>Monument 4'6" 2'8"</p>	<p>AMELIA L. Seeger 6-20-42</p> <p>Fredrick 10-12 Seeger 1929</p> <p>Chas. E Seeger 4-30-07</p> <p>Mary Seeger 2-25-18</p> <p>1'10" Monument</p>	<p>Geo. Meyer 4-17-12</p> <p>Elizabeth Meyer 6-7-1927</p>

30'

Heads East

Ulysses S. Buck  
S.W. 1/4

Geo. Meyer and Fred Seeger  
S.E. 1/4 - 191  
SPT. See File

PERPETUAL CONTRACT 250'

See H.C.

Scale - 5 Ft - 1 Inch

MT. HOPE CEMETERY, PLOT RECORD

RANGE SECTION

3 LOT NO. 192

Form 1

Deed For this lot held by Mr. BAUMER

Julius Binder Sr. N.W. 1/4

George H. Jones

Eliza Glenn E. of N.E. 1/4

W 1/2 of N.E. 1/4 - 192 - P-3

MARY SNYDER 2-16-44	Steel Vault. Gertvude L. Baumer 9-18-29		Alexander Livingston 2-19-1907
Chas Snyder 12-30-1939	J. HARRY BAUMER 3-30-1963	Wm L. Sandex 11-19-1931-	Harriett Livingston 1897
Mary Binder 12-18-1928	Phyllis E. Telford 1-7-1936	HARRIET SANDER 4-16-1962	10-5-34 SUSAN B. COLLINS Edith B. Collins 4-30-1935
M. Louisa Binder 1899	J. Frank Binder 1901	Emma F. Ray 6-30-13	Eliza G. Callahan 5-1-16
Julius Binder 1887	Emily Binder 1895		Margaret Cross 1885
Hattie Horn 1904	Alida E. Horn 7-19-1918	EMMA GLIENKE 1-15-1962 MONARCH	60 Con-o-lite Wilhelm C. 630 Glienke 1932
Edwin Horn 1893	CLARENCE L. HORN 10-23-34 - No Box -	CONOLITE EMIL GLIENKE 2-29-1940	
Willie Horn 1898	Mon. 5'6" 2'8" ← 6'6"	CONOLITE JENNIE GLIENKE 2-26-41	Conolite William E. Glienke 6-24-1947
Mina Horn 1885		Steel Archie L. Glienke 9-28-1948	Wilhelmina 1892. Glienke
Henrietta Horn 1907	Frederick Horn 6-18-21	CON-O-LITE Josie Glienke 5-8-1933	Carl Glienke 1907
Chas. 2-14 Horn 1915	Emil 6-26 Horn 1914		

Chas. L. Horn

S.W. 1/4

William Glienke

SE. 1/4

Scale - 5 Ft. - 1 Inch.



MT. HOPE CEMETERY, PLOT RECORD

RANGE SECTION } 3

LOT NO. 193

Form 1

Lucksinger and Schneider NW 1/4  
Francoise and Alway NE 1/4

*Don't* This GRAVE Dug EXTRA to Allow ANOTHER INTERMENT ON TOP. RESERVED FOR WIFE CORA, Brothreed 4-9-1951

CORA M. LUCKSINGER 11-27-1962		Rusina Erbenyer	
ARTHUR LUCKSINGER 4-10-1951		John Alway 1906 R.D. 11-19-12	Jacob Francoise 1880
	Bertha b. 9-24 Schneider 1940	MARY A. LEDERMAN 6-3-44	Mary F 1902 Broekheisen
Adam 1896 Lucksinger	Valentine J 1906. Schneider	RES. ASHES PATRICIA + STEPHEN KING-ELMY 11/2/96 ASHES	Dina Ortelce 5-9-1929
Catherine 1886 Lucksinger	Magdalena 3-24 Schneider 1926	JOHN A. NOWACK EVELYN NOWACK 7/7/1979	Mary Lusk 4-6-1925
Mathias 1886 Lucksinger	Geo Schneider 1918	Dug x x x Deep ELEANOR NOWACK 3-26-1952 CONCRETE VAULT Arthur Nowack 1-12-1925 W. BEAT 1	Steel Vault Alway 2-22-1927
John Strutz 1898	Fredericka Meyer 11-2-07	Ernest Bradt	JAMES S. GIBSON 5-13-1953
Friederika 1878 Strutz	Chas. C Meyer 7-30-12	Harry Bradt 4-7-09	IDA GIBSON 4-3-1969
Minnie Strutz 1886 Minnie S. Block 8-17-55 con-o-life	MAGDEIENA STRUTZ-9-6-40	Wm H. Bradt 4-26-09	3 Norwalk Eleanor M. Beach 11-13-1935
Fredericka Strutz 7-20-25	ANDREW STRUTZ 9-28-40	Margaret J Bradt 12-22-17	Anna Dunyon 1-16-1947
#60 con-o-life Wm Strutz 6-14 1927	Ann thorn 5-4-08	Noah Bradt. 2-1-11	

NO MORE BURIALS ON THIS PLOT LAST OF Family Buried 8-17-55

PERPETUAL CONTRACT

2 grs. only 7E + 8E

LUCY + M. FARRELL'S INFANT - STILLBORN 4/27/1909

1.00  
450.00  
4/23/49

William Strutz SW 1/4

Noah Bradt SE 1/4

MT. HOPE CEMETERY, PLOT RECORD

RANGE SECTION } 3

LOT NO. 194

Form 1  
TAKEN 4 PLOTS  
PURCHASED  
1886  
NO PC OVR

William Peper  
NW 1/4

John Geo Smith  
NE 1/4

33' 4" LETTER IN FILE

P.O.  
250.00  
6/2/83

Edward Boon 3-26-1937 10	MINNIE BOON 1-22-1949 9	MILDRED RENNER 3-25-1960 MONARCH VAULT	CONOLITE CHESTER, G. Smith 4-26-44 6	J. Geo. Smith 5-17-14 1
Sophia Peper 9-1-1909 8	Wm Peper 12-13-1916 7	HAROLD RENNER 5-14-1964 8	Johnna Smith 4-10-87 * 7	Katherine E Smith 3-8-1929 2
Wm Peper 12-13-1916 7	Wm Peper 12-13-1916 7	AUGUSTA DERX 12-17-1952 6	Ree Fred Smith 9	Augusta Smith 2-28-1973 GENESEE 4
Wm Peper 12-13-1916 7	Wm Peper 12-13-1916 7	FRANK DERX 12-20-1952 6	JOSEPHINE SMITH 182490 MONTICELLO 10	Edna Smith 2-11-1947 CONOLITE 5
Wm Peper 12-13-1916 7	Wm Peper 12-13-1916 7	Richard N. Gaylord 11-30-1959 9	George 3-14 KURZROCK 34 4	MARY HAUSMAN 1
Wm Peper 12-13-1916 7	Wm Peper 12-13-1916 7	Edw. H. Carroll 5-12-20 8	CAROLINE KURZROCK 1886 7	Augusta Kurzrock 1886 2
Wm Peper 12-13-1916 7	Wm Peper 12-13-1916 7	Emily J. Gaylord 8-25-1984 8	J. d. Kurzrock Res. 10	Anna Kelly 10-19-15 3
Wm Peper 12-13-1916 7	Wm Peper 12-13-1916 7	Orpha E 3-3 Jennym 22 7	ELIZ. LINDSAY 11-14-1957 9	CONOLITE MARY-P. KURZROCK 12-21-38 4
Wm Peper 12-13-1916 7	Wm Peper 12-13-1916 7	Wm J. Jennings 9-5-1940 6	Louis Kupfer 4-22-18 10	John 4-18-25 Kurzrock 6

W

E

see file

See file

William E. Carroll  
SW 1/4

John H. Kurzrock  
SE 1/4

Scale - 5" Ft. - 1 Inch.

MT. HOPE CEMETERY, PLOT RECORD

RANGE 3 SECTION 33.33

LOT NO. 195

Form 1

*Henry Seils*  
*George & Baker*  
*Geo Patterson*

N.W. Pt  
 Sec. G. E.  
 W  
 Mid. Pt. of W. Pt  
 S.W. Pt  
 PERPETUAL CONTRACT

*Lucy 250.00*  
*500.00*  
*12-21-59*  
*830000*

*Dug 4x4 Deep to follow another on top.*

5 Albert P. Seils 2-1-1933	10 HERMANN, Seils 12-6-1934	Bush Cina Wirsching B. & C. 1888	6 Freddie Wirsching 1884
4 AMANDA R. SEILS 8-4-41	9 GENESE ANNA M. SEILS 12-20-1967	George P. Fromm 6-24-1933	Baby 1884
3 George C. 1-11 Jund 1929	8 SOPHIA C. SEILS 9-2-55 CORALITE VAULT	ANN K. PFROMM 1-29-1970	Sussie Wirsching 1888
Johanna Seils 1887	7 CONSTANCE LARS SEILS 10-16-41	CHECK FOR ROOM Elizabeth 11-13 Gardner 1895	CLAIMS Unoccupied
1 Heinrich Seils 1892	6 MINNIE GEO. JUND 11-18-1952 3-8-1897	CHECK FOR ROOM Elizabeth 11-13 Gardner 1895	G. Wirsching 1-18-1895
Anna L. 3-28 Dilcher 07	11 Geo. Edeman 10-3-06 Fred Edeman 7-9-07	Wm. Shumway 7-12-1909	Erwin J. 2-27 Lathrop 1932
FREDY. W. EDMAN 1-14-42	9 Baby LUCILE E. ANGE 6-11-13	Sarah E. Shumway 4-9-1913	Charlotte J. Lathrop 2-14-24
Bessie Edeman 1-2-1919	8 MARGARET DOLAN 2-26-1958		Freddie Lathrop 1889
LOUISA BAKER 7-7-1900	7 HARRIET BAKER 1894 FRANCIS E. Curlette 2-2-1926		Lucy Adams 5-9-1895
Helen Dolan 1-23-17 Geo S Baker 1891/10-12-1947 Karon Edeman	6 Leo S. 4-8- BAKER 1897		
MABLE A. PATTERSON 11-14-44	STEWART A. PATTERSON 2-16-1952	Andrew Attridge 1879	
Eliz Patterson 1916		Evesia Attridge 1902	
Geo Patterson 8-1-1908	Mon 2'5"		

Aug 8. C.  
 August 8 Wirsching  
 N.E. Pt

See G.C.  
 See G.C.  
 HEADS EAST

Lynn G. Shumway  
 and  
 Edward J. Erwin  
 Erwin J. Lathrop  
 S.E. Pt

MT. HOPE CEMETERY, PLOT RECORD

RANGE SECTION } 3

LOT NO. 196

Form 1

Ida Sadler O

N. West Pt.

See Folder

N

Lottie and Fred G Schulz

East Part

33'33"

W

27'6"

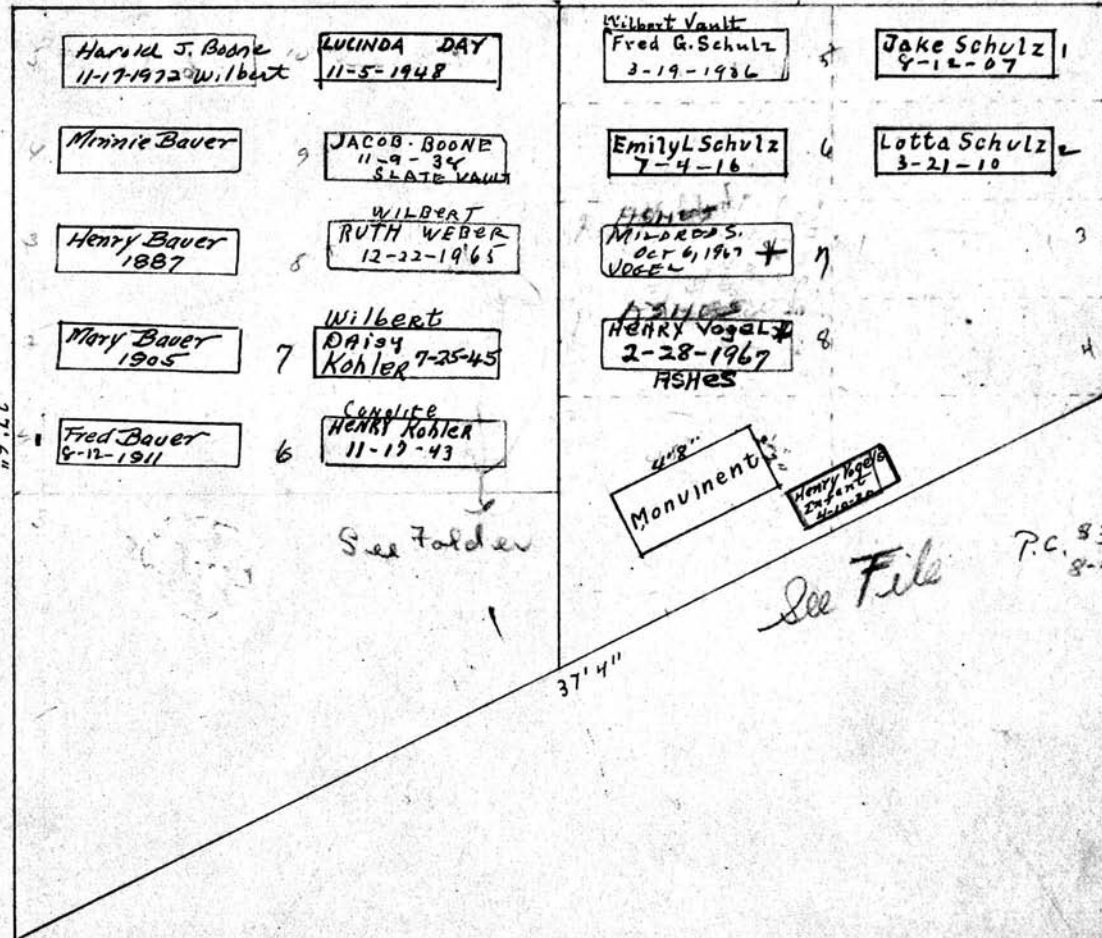

See Folder

37'4"

See File

P.C. \$300.00  
8-4-64

S

Scale 5' Pt. - 1 inch

MT. HOPE CEMETERY, PLOT RECORD

RANGE SECTION

3

LOT NO.

197

Form 1

Kalamazoo Loose Leaf Binder Co., Kalamazoo, Mich. X-2200

Henry S. Ballou

N. W. 1/4

16'0"

Mary A. Dake

PERPETUAL CONTRACT

N. E. 1/4

16'0"

Henry J. Dake to be interred here and his daughter Grace Dake Ashlon on top.

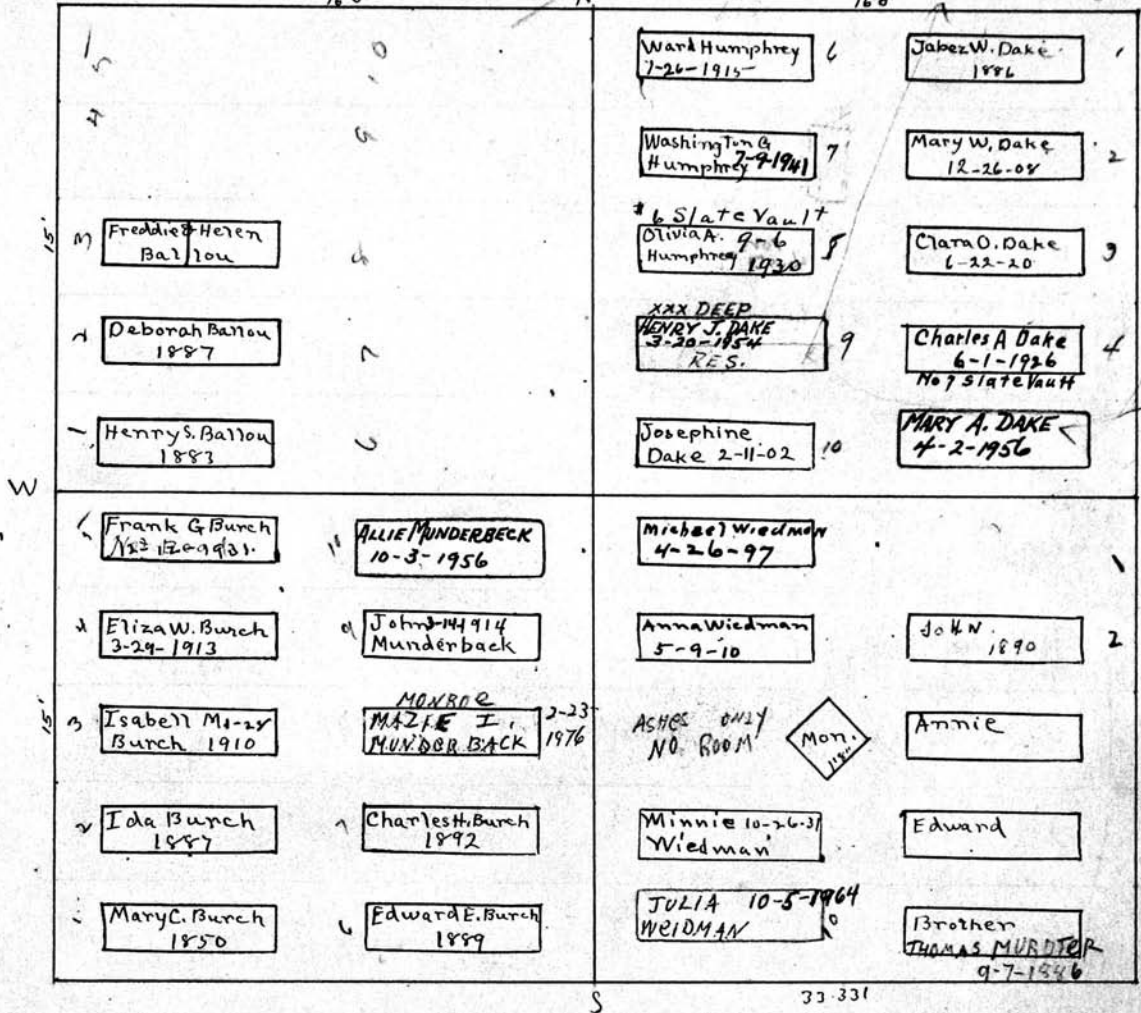

Frank G Burch - Annie Wideman

PERPETUAL CONTRACT.

S. W. 1/4

S. E. 1/4

Scale - 5 Ft. - 1 Inch.

MT. HOPE CEMETERY, PLOT RECORD

RANGE SECTION

3

LOT NO.

198

Form 1

August Wundes  
PERPETUAL CONTRACT  
N.W. 1/4

Chas. Scholl

16'8"

N.

16'8"

10 Daniel Wundes 2-13-1904	10 ARTHUR ERIC THORNTON 6-30-98	6 LOUIS J. LITZENBERGER 4-30-1963	1 #3 NORWALK LOUIS J. LITZENBERGER 1-28-1960
9 Ros John THORNTON	9 LUCY W. THORNTON 6-5-08	7 FLORENCE E. LITZENBERGER 5-31-41	2 (IN ONE CONTAINER) FLORENCE A. AUSD WALLACE BAUER 6/17/98 UNUSUAL URN
8 Wm Wundes 2-27-1932	8 Lucille Wundes 11-3-1959	8 Walter Kopp 8-22-1945	3 Mrs. Linnet CHRISTINE KUMER
7 August Wundes 3-13-1916	7 August Wundes 7-29-1959	9 Bessie Kope 10-28-71 Wilber	4 Ros Sam FANNY CASBARI
6 Agnes Wundes 7-11-1901	6	10 TO BE RELEASED BY JAMES F. BOUER PER FRANK LITZENBERGER 2/22/01	5 JOHN J. LITZENBERGER 4-23-68
5 Hanna Piper 1888	10 con-o-lite Carl 6 1/2 Piper 1933	6 Julius 1881 Litzenberger	6 Norwalk Josephine O. Scholl 9-20-1935
4 Minnie King 2-24-17	9 Maria S. 6-12 Piper 1914	7 Linda Litzenberger 9-5-1899	7 Daniel J. Scholl 12-24-1926 No 7. State.
3 Frank King 2-24-1903	8 Unser Wulle 1899	8 Isaac Kopp 12-14-1943	8 Chas Scholl 1901
2 Norwalk Carrie Piper 8-3-1926	7 Clara Piper Wulle 1886	9 Marie Streunig 9-20-85	9 Caroline Scholl 1903
1 Chas M Piper 1-4-1902	6 Hazel Piper 10-21-04	10 Willard Streunig 8/30/65	5 Mathew 4-20 Scholl 1921

Chas. Piper  
PERPETUAL CONTRACT.  
S.W. 1/4  
No more burials to be made on  
this lot after relatives are  
buried this  
restriction to  
cover still graves  
also order of  
Chas Piper in 1925  
12-30-1926

Scale: 5 Ft. - 1 Inch

MT. HOPE CEMETERY, PLOT RECORD

RANGE SECTION } 3

LOT NO. 199

Form 1

Schoeller Vogel N

see G.C. Margaret Leary

NW 1/4

33.33'

see Letter on file

NE 1/4

Emily P. Niedermeier 7-9-34

Margaret Egbert 9-16-1915

(Tree)	Otto L. 8-1-11 Niedermaier	6	Thos. Leary 1883
		7	Margaret Leary 6-20-21
Hermine Vogel 1863		8	Reuben W. Parks 2-4-18 CONOLIC MAREHA PARKES 4-18-44
Wilhelmina 1905: Vogel		9	Jane Attridge 5-13-1911
J. Christian 1871: Vogel		10	Eugene Egbert 1-25-1913
LENA V. BROST 7-3-19	FRANCES MUELLER 6-3-1958	1	John Stewart 8-9-1919
George Borst 11-4-1927	Harold Mueller 12-7-1936	2	10-16-1897 See also Stewart MONROE CHRISTEN G. SALMON 1-9-1968
Emily P. 7-9-34 Niedermeier	Herman Mueller 9-19-1923	3	Agnes L. Stewart 7-1-1904
MONROE BERTHA C. SHELL 4-13-65	BERTHA MUELLER 1892	4	ELIZ. T. SALMON 8-5-1959
Wm Shell 1-8-1946	HERMAN VIE MUELLER	5	WILLIAM E. WRIGHT 12-3-1962
		10	Claude Stewart 1883
			Chas D Stewart 1896
			MARGARET STEWART 6-21-91

BERTHA M. MUELLER

GEO BORST WIFE  
SW 1/4

Chester Gann Edigbeth T. Salmon (dis wife)

John Stewart

SE 1/4

Note  
Graves 1-2-3  
4-5-6  
Not to be  
disturbed

Scale - 5 ft. = 1 inch

MT. HOPE CEMETERY, PLOT RECORD

RANGE SECTION

3

LOT NO.

200

Form 1

John Peth 0

Eliza Martin

PERPETUAL CONTRACT.

N.W. 1/4  
16'8"

N.E. 1/4  
16'8"

OK August Peck 7-3-1890  
OK Fred Peth 11-6-1861  
OK Fred Peth 2-18-1905  
OK Wilhelm Peth 6-8-1897  
Quade OK

<p>Quade 10</p> <p>August Married 6-12-14</p> <p>WILHELMINA MALLOCH</p> <p>Adeline Dusky 5-14-10</p> <p>3-27-1940</p> <p>NOTWALK.</p> <p>Elmer Mallek → FRED DUSKY 7-18-1908</p> <p>Henrietta Peth</p> <p>John Peth</p> <p>Tree</p>	<p>No 7 State Vault.</p> <p>Jacob Peck 1899</p> <p>Eliza A Martin 1-31-1931</p> <p>Sarah 5-7 Martin 1910</p> <p>Philip Martin 1891</p> <p>Cynthia Wilcox 1885</p> <p>ASHES</p> <p>ROBERT M. MADDEN 6-6-38</p> <p>ASHES</p> <p>GEORGINA MADDEN 11-20-39</p>
<p>Minnie Boldt 1895</p> <p>Fred 1895 Schoenemann</p> <p>Sophie Hatch 1890</p> <p>Mary S. 1904 Schoenemann</p> <p>Henry 1886 Schoenemann</p>	<p>Fred Nelson 7-20-1929</p> <p>FRANK P. GLINKA 1902</p> <p>HATTIE GLINKE 9-22-14</p> <p>AIDA WALESON</p> <p>GERDRA WALESON</p>
	<p>Theodore Meldola 1886</p> <p>Caroline Meldola 1895</p> <p>ARNOLD R. MELDOLA 6-13-1963</p> <p>ALICE 10-5 MELDOLA 1943</p> <p>HERMAN G. MELDOLA 10-13-1948</p>

Mary Schoenemann

Hattie Glinke

Herman Meldola

W 1/2 of SW 1/4

E 1/2 of SW 1/4

S.E. 1/4

Scale 5 ft = 1 inch



MT. HOPE CEMETERY, PLOT RECORD

RANGE SECTION

3

LOT NO. 201

Form 1

Ludwig and Agatha Miller

Anna Mehne

N.W. 1/4

Su. G.C. N.E. 1/4

"spaced 4 graves E-Tie 33.33"

SNOW  
HAZEL  
1-16-1907  
Su. G.C.

#3 Cement Box		#3 Cement Box	
Eleanor 6-1 Schaffer 1909	Louise Miller 5-1-1929	Emma 7-26 Riedesel 1920	Johann Mehne 1871
Albert L. 3-11 Schaffer 1925	Mary Miller 1899		Anna Mehne 1893
12-19-1946 Agatha Miller Schaffner	ANNA STEIRIE 9-16-40	Ashes Frederick Johanna Sterry 10-28-1922	Johann 71 Anna 1867 Mehne
Agatha Miller 1905	Wm Steudle 1901	Joseph Gabel 5-7-1929	Frederick G. Mehne 1871
Ludwig Miller 1900		Mary Gabel 6-7-24	Frederick J. Gabel 1903
John A. 1897 Richardson	Sarah Goodwin 1-21-1926		Herbert V. Vander Koorde 1-8-16
Jane Richardson 9-29-1922	WILLIAM A. GOODWIN 7-20-43	cond. to Beatha G. Hauch 7-12-46	Tannetja Van der Koorde 5-29-36
Ebbie Ferrer 1922	LOUISE M. GOODWIN 2-7-1955 MONARCH VAULT.	Slate Vault. Emil 1-1-1916 Gmelin	
Frances Ferron 9-12-1930		ELIZABETH GMEIN 3-8-34	
Louis Richardson 3-20-1926			

W

15'

15'

30'

E

Su. G.C.

Post 75-  
Map 14.10.30

Louise M Goodwin. E 1/4  
Frances A. Ferrer W 1/2

Hubert B. Van. DeKoorde  
S.E. 1/4

S.W. 1/4

S

Scale: 5 Ft. = 1 Inch.

MT. HOPE CEMETERY, PLOT RECORD

RANGE SECTION

3 LOT NO. 202

Form 1

Wm. Horn & wife

Frank Thompson

N.W 1/4

N.E 1/4

PERPETUAL CONTRACT

33'33"

5/20/82  
Home broken into  
& deed stolen  
only Wilbur Stein  
has right of  
burial on this  
lot

Geo. Mentzer Eng. 11-2-88	Geo. Men. Acvs. 3-5-11-13-10	10 WILBUR C. STEIN 8-26-18 MONTICELLO	HERBERT THOMPSON 18-11-41	Frank 7-26-15 Thompson
	9 Mary Horn 1880	9 Harrison Stein 1-8-81 C.P. Chest	LEDA J. WILBERT THOMPSON 1-15-62	Ambella Thompson 1916
Edward Horn 1888		11-18-1891 IRMA STEIN Horn 1891 HYLAND	Geo. THOMPSON 10-9-1963 CONOLITE	CLARENCE A. VICK 5-21-1969
Caroline 11-21 Horn 1913		Matilda 3-17 Horn 1913		Ethel T. Vick 12-3-1971 Moneau
Wilhelm Horn 1894		Wm C. 5-29 Horn 1928		Sunken
Harriet M. Taylor R.B. 4-6-20	10 Ruth B. Taylor 2-28-12		M.O. Tarba 1904	Jonathan Nicol 1886
Norwalk Vault George Taylor 3-17-1932 TR 3.5/3.2	9 ASHP'S DAVID T. CROTHERS X 12-12-1967		Fannie Tarba 12-21-17	Hannah Nicol 1904
Jay Taylor 5-27-16	8 Brian E. Crothers 1-16-1923 Genesee		Steel Vault Mathew J. Nicol 12-5-1935	Sarah E. Osborn 3-26-1927
Anne H Taylor	7		4-3 Cement V Ella Nicol 6-14-1926	GUY M. OSBORN 10-15-1949
Chas R Taylor	6 ELIZ. T. VANDERPOOL 7-19-1952			

Charles R. Taylor

Mathew J AND Sarah E. Nicol

S.W. 1/4

S.E 1/4-202

PERPETUAL CONTRACT

MT. HOPE CEMETERY, PLOT RECORD

RANGE SECTION

3

LOT NO.

203

Form 1

M.E. Dyson  
PERPETUAL CONTRACT  
N.W. 1/4  
16'0"

McVicar & Elliott  
PERPETUAL CONTRACT  
N.E. 1/4  
16'0"

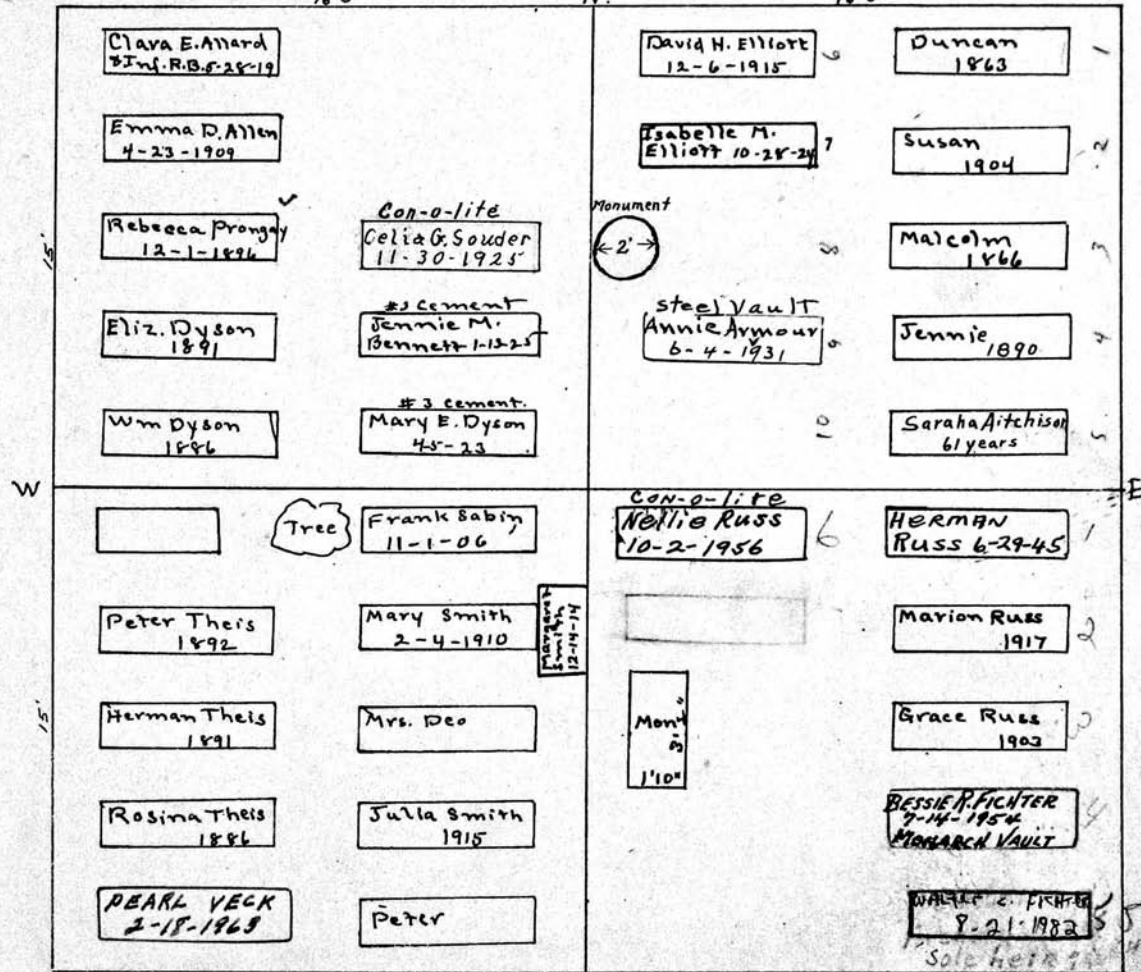

John Theis  
S.W. 1/4

~~Chas. D. ...~~  
HERMAN RUSS  
S.E. 1/4

Scale: 3 Ft. = 1 Inch

MT. HOPE CEMETERY, PLOT RECORD

RANGE SECTION

3

LOT NO.

204

Form 1

Joseph Ziem's<sup>2nd</sup> John Stutzrihm Julia McCormick

PERPETUAL CONTRACT

N.W. 1/4

N.E. 1/4

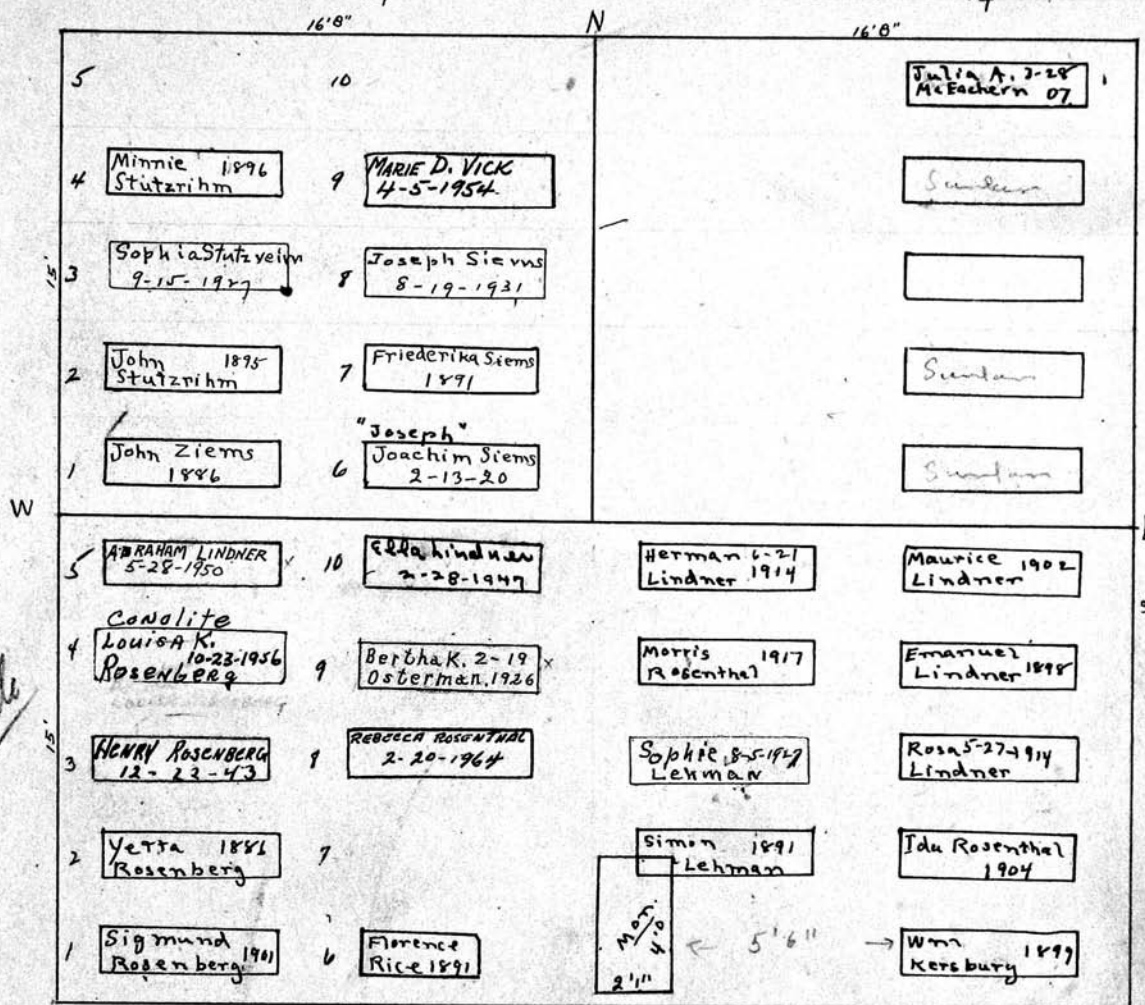

*See side*

S Heads West 33.33' Heads East

Simon Lehman PERPETUAL CONTRACT

S 1/2

Scale - 5' Pl. - 1 Inch

MT. HOPE CEMETERY, PLOT RECORD

RANGE SECTION } 3

LOT NO. 205

Form 1

William Horn

N Fred Albrecht - Fritz Dreier

N. W. 1/4

See G.C.

NE 1/4

PERPETUAL CONTRACT

33'33"

See G.C.

Grant PC  
3000 ft  
10-25-1958

Emma Horn  
also buried  
prior

10000 ft  
4/11/1958 - PC

5 1 1/2" pipe WILHELMINA HORN 4-4-1964	10 ESTHER A. HORN 10-12-1960	FRED DREIER 2-10-1908	FRED ALBRECHT 4-20-17
4 Caroline Lord 6-3-1919	9 HENRIETA HORN 10-9-1958	Minnie Dreier 1-2-1935	Lena Albrecht 7-17-1931
3 Albertina HORN 1876 1934	8 WILLIAM A. HORN 6-7-41	MINNIE DREIER 1888	CAROLINE ALBRECHT 1885
2 Albertina J. Horn 1885	7 Gross Mutter	FRANKIE DREIER 1889	MILDRED ALBRECHT 10-22-1881
1 Wilhelm F. Horn 1898	6 Gross Vater 2-18 John Karmelich 1907	EDW. DREIER 1880	
5 Stevie 1895	10 ERNEST - ROSS - 2-12-41	ASHES William L.P. Mohr 4-19-33	
4 Chas. C. Fletcher 1896	9 GEO. N. FLETCHER 7-3-1952 CONOLITE	MINNIE ROSS 10-11-1952	Philip Mohr 6-12-18
3 Jannie 10-23 Fletcher 1945	8 MONA REH FLORA 4-21-66 FLETCHER		Catherine Mohr 4-5-1928
2 NANCY C. 3-6-34 FLETCHER	7 MARY F. DEPUY 11-6-1948 *3 MORWALK		Bessie Mohr 9-3-1914
1 Malcom Fletcher 1907	6 Philip A. DePuy 9-10-1946	See G.C.	

PERPETUAL CONTRACT

33'33"

Malcom Fletcher

Philip Mohr

S.W. 1/4

S.E. 1/4 - 205 - P-3

Scale - 5 ft. = 1 inch

MT. HOPE CEMETERY, PLOT RECORD

RANGE SECTION

3

LOT NO.

206

Form 1

Kalamazoo Loose Leaf Binder Co., Kalamazoo, Mich. X-32209

Albert & Johanna Kubitz

Rachel L. Knowlton

N.W. 1/4

N.E. 1/4

Head West 76'8"

N

16'8"

See Order outside

5 EDWARD A. KUBITZ 5-7-1963 CONOLITE CONOLITE	Henrich Kubitz 1887	
4 MARIE KUBITZ 12-28-1960		Rachael L. 8-4 Knowlton '06
3 CONOLITE HENRY KUBITZ 9-10-62	Geo. A Wandtke 4-11-11	
2 Adeline G. Kubitz 8-28-1926	Johanna 1-13 Wandtke 1913	Electa Roach 7-7-13
1 Albert 9-27-09 Kubitz	Ferdinand Kubitz 1885	Minnie C 1888 Walcott
Louisa Ehrlich	Laura St Louis 2 Mo	6 Frank St Louis 11 Mo
Frieda 9-29 Ehrlich 07	Ervia St Louis 4 yrs	7 Arthur St Louis 4 yrs
Oscar 8 yrs. old		Tree
Henrietta Ehrlich	Sophie Levy 1890	9 Francis 4-18-33 St. Louis
Samuel 12-7 Ehrlich 1911	Jacob Levy	10 POSELLA ST. LOUIS 2-17-1954
		30' 1 2 3 4 5 6 7 8 9 10

Ehrlich and Levy PERPETUAL CONTRACT

FRED D. ZWICK PERPETUAL CONTRACT

Frank P. St. Louis W 1/2 of S.E. 1/4 PERPETUAL CONTRACT

Scale - 3" = 1' 1" 1/2

MT. HOPE CEMETERY, PLOT RECORD

RANGE SECTION

3

LOT NO. 207

Form 1

Edward Bosche  
NW 1/4

Susan A. Gummer. W 1/2 of NE 1/4  
Knapp & Smith. E 1/2 of NE 1/4

Josephine Hartman 7-20-93	Henry A. Hartman 4-10-74 General	Susan A. Gummer 4-2-17	
MARY G. BOSCHE 6-11-1953 MONARCH VAULT	MONTICELLO GILBERT E BOSCHE 2/29/96		Effie Smith
Edward Bosche 7-8-1919	Virginia Bosche 11/1/1982	Monument 3' 2"	ROBERT P. SMITH, JR 6-7-1957 * ASHES
Josephine 1902. Bosche	Pella W. Bosche 1900		Mildred Ashbee SANBORN 4-29-1938
Adam Bosche 1886	Lydia A. Bosche 1900	Frank Gummer 6-2-1947	Bessie Smith
Res. JACOB Schnessler	JOHN RIEDESEL 11-6-1950 CONCRETE VAULT	Ashes OLIVE ELIZ. MARSHALL Marshall R.B. 4-10-44	Mary Marshall 3-30-20
		CHARLES E. MARSHALL 10-27-1947	Ida Marshall
CORA J. 8-3- Gisbel 1960		LUELLA P. MARSHALL 12-16-72 WILBERT	WILBERT-MARY SANFORD 2-15-43
Pino Giedrel 12-17-1944	Mother	Wilbert Sherman Dodge Marshall 9-20-1947	Theodore
ELIZABETH 3-14-40 RIEDESEL	John Riedesel 5-3-1929	Chas. E. Marshall 12-26-1921	Chas. G. Westfall 5-17-34
		MARY MARSHALL Baby Boy Marshall 7-21-48 Ft. Erie	Edith Westfall 6-19-34

\* H.S. Pella & Lydia (Baby) in same grave.

See Folder  
Pella & Lydia (Baby) 1000 65.57

John Riedesel  
SW 1/4

Chas & Mary M. Marshall  
SE 1/4

PERPETUAL CONTRACT.

Scale: 1/4" = 1 foot

MT. HOPE CEMETERY, PLOT RECORD

RANGE 3

3

LOT NO.

208

Form 1

Kalamazoo Loose Leaf Binder Co., Kalamazoo, Mich. X-2000

Skinner & Hickman  
4/14/14  
PERPETUAL CONTRACT  
N.W. 1/4  
33' 4"

William Line  
Emma Bond  
700<sup>00</sup>  
1964  
N.E. 1/4  
250<sup>00</sup>  
PERPETUAL CONTRACT 2-28-1967

5 ROY HICKMAN 6-11-64	10	EMMA V. LINE 8-8-1934	7	JOSEPH HUNT 1886	1
4 ANNA E. HICKMAN 4-6-44	9	WILLIAM LINE 5-21-1938	8	ANN HUNT 1897	2
3 Mattie 1885 Hickman	8	WAITER H. LINE 2-14-1941	9		3
2 Sarah M 1909 Hickman 2-15	7	GRACE LINE 12-20-1962	10	Wm H. Bond 9-4-1887	4
1 Jeremiah 6-13 Hickman 1921	6	CARRIE HILDEBRANDT 4-18-1973 SUNNY CRIST R.B. 3-13-62		ANN HUNNY BOND 1-27-21	5
		DANIEL HILDEBRANDT 7-9-1887		ETHEL D. BOND 2-4-18	6
		John Bradley 9-8-1923		John Kleiner 1905	
MEX. A. BRADLEY 10-22-40 Complete		Louise Tietze 5-2-1934		Mary 1886 Fichtner	1
Monroe	Mon 4'5" 4'5"	JOHN L. FICHTNER 12-16-1968		Jacob John 12-31 Fichtner 1929	3
Mother		MARIE C. FICHTNER 8-26-91 Wilbert		Catherine 8-18 Fichtner 1939	4
Father		Herman Jacob Fichtner 2-18-84		ROSE E. FICHTNER 2-9-1983 CONTINENTAL	5

Luther P. Andrews 1885-  
Elsie Andrews 1887  
W Monroe Andrews 1876

Under article  
of her will on file.  
No more interments  
to go upon plot

Jmez A. Bradley  
S.W. 1/4  
PERPETUAL CONTRACT

J. J. Fichtner  
S.E. 1/4

Scale - 5 Ft. - 1 Inch.



MT. HOPE CEMETERY, PLOT RECORD

RANGE SECTION

3

LOT NO.

209

Form 1

8-3-1890  
 JULIA  
 HEWLETT  
 EDWIN J. MANN  
 7-16-1886

Edwin J.  
 Mann  
 7-16-1886

Plot  
 for  
 Mrs. Mann  
 3/7/1928

Alfred P. Mann

L. C. Smith

N.W. 1/4  
16'0"

N.E. 1/4  
16'0"

	Mary J. Mann. 2-13-1928		
	Frederick Mann 3-6-22		
Alfred P. Mann 10-20-06	George A. Swan 4-6-1929 DBL. H.S. ON GAS. 7-8 HAS JENNIE SWAN'S NAME ON IT.		
ELEANOR HEWLETT 3-21-1946	JENNIE F. SWAN 5-31-1968		
Stella Schetter 1893	MONROE ROBERT L. AUSTIN JACQUE	Wm Bender R.B. 5-9-19	
Wm Schetter 1889	3 NORWALK HENRY G SAUER 2-9-1935	Matilda B. Shaw 11-31-1932	Jane E. Bender 2-19-1919
Jas. w. Shone 1905	#2 cement Mary E. Sauer 6-25-17	Joseph C. Shaw 1908	Bertha Bender RR 4-1908
9-4-1907 S. A. Shone Arth. H. 1880	Elizabeth Hunt 2-28-05	Geo. Bevan R.B. 4-26-1910	Richard Owen 3-4-1907
Alfred J. Shone 4-2-1919	James Hunt 7-1-1887	H.S. Mary Mary Bevan 3-28-1929	MARION WHITE 6-7-1888 MONROE

Hunt and Shone  
 PERPETUAL CONTRACT  
 S.W. 1/4

5,6 - City Bought back  
 Fred'k E. Linscott

S.E. 1/4

Scale - 5 Ft. - 1 Inch

MT. HOPE CEMETERY, PLOT RECORD

RANGE SECTION

3

LOT NO.

210

Form 1

Kalamazoo Loose Leaf Binder Co., Kalamazoo, Mich. K-32015

PERPETUAL CONTRACT

PERPETUAL CONTRACT

E. LAUCHLAN

- PRUNER PT.

R. D. Babbage

Mears & Pruner

250 PC  
11-15-57

PERPETUAL CONTRACT

N.W. 1/4

FREDERICK P. MEARS  
E-S-76 1/2 1/4 N.E. 1/4  
N.W. 1/4

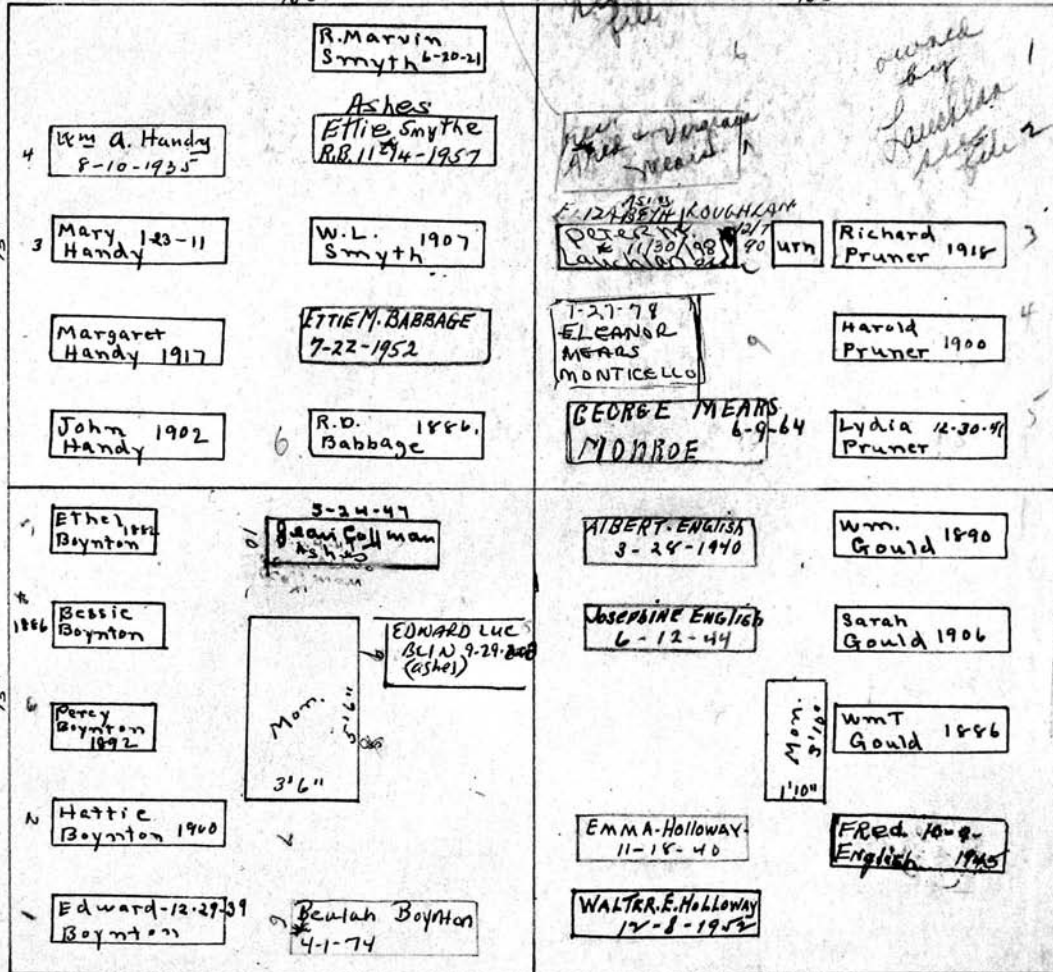

E E Boynton  
PERPETUAL CONTRACT

Sarah A. Gould.

S.W. 1/4

S.E. 1/4

SEE ORDER  
ON FILE

Scale: 0 - Ft. - 1 Inch

MT. HOPE CEMETERY, PLOT RECORD

RANGE SECTION

3

LOT NO.

211

Form 1

Pitcher & Springer  
All. 1400<sup>00</sup> P.E.  
3-27-52

See G.C.

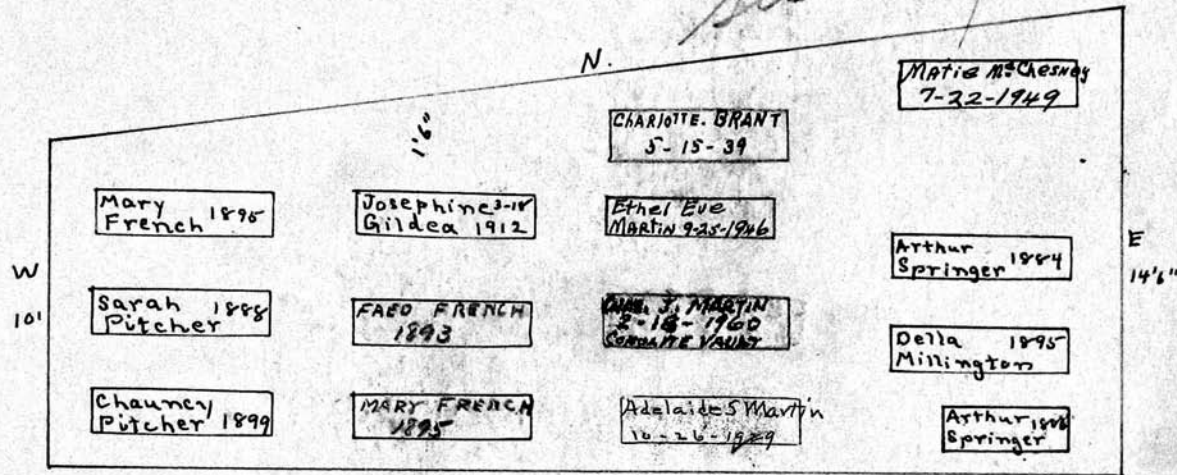

Fredk & French  
on hot 6/30/1893

S 3 1/2'  
Heads East.

Scale: 3" = 1 Foot

MT. HOPE CEMETERY, PLOT RECORD

RANGE }  
SECTION }

3

LOT NO.

212

Form 1

NEW SCOTTISH BURIAL PLOT (SEE 442-SEC. 0) OLD PLOT.

Available for  
reclaim in  
2008

John L. Stewart *Edw*

A77

W

E

38.5

S 45'

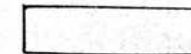
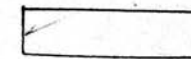

Scale - 3" Ft. - 1 Inch

MT. HOPE CEMETERY, PLOT RECORD

RANGE SECTION

3

LOT NO.

213

Form 1

Mass & Stadler

John Kerber & Chris Jass

PERPETUAL CONTRACT

N.W. 1/4

N.E. 1/4

See G.C. N. 46'

Johanna his wife 1887	Frieda Thiasson 10-8-1954	Baby Seils. Baby Thiasson	John Kerber 9-23-1922	Christopher Jess 1903
Charles Mass 1905	ANNIE SEILS.	HARRY MASS.	Emma Kerber 7-16-24	Maria Jess 1887
#5 cement Elizabeth Mass 9-6-1934	No room	Conalite Geo. H. Stedler 12-14-1927	ASHES ELISA MERRELL * R.B. 3-25-60 * FRED MERRELL R.B. 7-26-1951	
Con-o-lite Fredericka his wife 2-25-18		MARTHA H. SUTTER 3-7-1964	LUCILLE M. GARVEY 12-18-2006	Maria Zander 1903
Geo. 5-26-1 Stedler 1910	Geo. 2-13 1912 Hilfer	Frank R. Howard 11-9-1929	WILBERT ALFRED GARVEY 9-20-08	Friedrich Zander 1887
John H. Redfern 6-7-1929	No room	Pincinea Redfern 1899	Adam 1-6-Knight 1913	
Emma Redfern 11-16-1935		Richard S. Redfern 5-17-1933	Fred Pflaum 5-8-1936	Catharine Meyer 1887
	Mon 2'4"	JENNIE B. REDFERN 6-14-1952 WILBERT VAULT	CARRIE PFLAUM 1-17-1957	Tree
Lucy Hartley 1899	See order in file	BLANCHE F. REDFERN 4-2-1963	Kate Knight 1-15-1936	
Charles Hartley 1887		FREDERICK C. REDFERN 11-10-41	CEMENT August Knight 12-18-1929	

Note:- Redferns have right to use Grave No. 8.

These graves to remain in disturbed Note:- Hartleys to have right to use grave No. 3

John Redfern - ~~Chris Hartley~~ Frederick C. Redfern N. 1/2 of S.W. 1/4 S. 1/2 of S.W. 1/4 PERPETUAL CONTRACT

Knight & Meyer Mary Meyer 12-18-1893 S.E. 1/4

Scale: 3 Ft. - 1 Inch

MT. HOPE CEMETERY, PLOT RECORD

RANGE SECTION 3

LOT NO. 214

Form 1

N. 1/2 of N.W. 1/4 Van Renslear & White  
S. 1/2 of N.W. 1/4 Walter Bruce Sec. G.C.  
PERPETUAL CONTRACT 47.

ASHES 2-3-1964  
LEROY PATTERSON 4-2-62

VAN RENSELLAR G. WHITE 7-22-1903	JANET W. NICHOLS 12-26-1951	Arthur F. Kamm 9-19-14	Christiam Kamm 6-5-1942	LOUISE R. PATTERSON WILBERT.
JEAN WHITE 4-18-1904	JOHN T. WARING 10-18-1894	Benj F. Nichols 11-18-19	ELIZ. K. KAMM 9-19-43	Casper Kamm 5-23-1932
JANETTE BRUCE 6-1-1887	HATTIE WARING 3-26-1889	Mary A. Laing 1902	CON-LITE John Kamm 5-24-1904	Catherine Kamm 12-27-15
Walter Bruce 1898	Olivia W. Bruce 3-18-1919	ELIZABETH KAMM 5-1-1963	CON-O-LIFE MINNIE KAMM 7-22-61	Cath Kamm 3-22-1917
Josephine M. Bruce R.B. 4-9-20	DAVID W. BRUCE 3-23-44	BERTHA K. RUND 12-20-1948	CON-LITE	Rosa Kamm 1907
Mary Emler 1-19-1926	EDNA MCLAUGHLIN 5-19-93	Margaret MCLAUGHLIN 1901	Emil Rund 2-15-1938	Rosina Kamm 1887
Joseph Emler 3-17-1926	John A. MCLAUGHLIN 1-11-1885	EMMA M. MCLAUGHLIN 9-11-1967	Viala Kamm 12-20-1931	John Kamm 4-9-1908
Sophia Ravster 1897	Marie H. Miller 1-12-21	Gottfried. Beyler 4-3-19	Frederick Kamm Sr. 3-11-1930	Tanning Kamm 3-26-1932
Sophia Stubbe 8-5-1926	Fred W. Miller 4-15-1909	Arthur W. Kamm 2-4-13	Mrs. Kundest	Reserved
John J. F. Stubbe 1849				

W 30.

use of Joseph Emler (his wife) 4-30-1920  
HERMAN MILLER 1/11/1897  
9/16/1890

letter in file  
See File

E 1/2 of SW 1/4 Fred Miller  
W 1/2 of SW 1/4 Sophia Stubbe  
All Heads EAST  
Edward of Rosina Kamm East 1/2  
Catherine Kamm  
Clara Kamm  
John Kamm  
Edward Kamm  
H.H. Kamm

Scale - 5' Ft. - 1 Inch

MT. HOPE CEMETERY, PLOT RECORD

RANGE SECTION } 3

LOT NO. 215

Form 1

W. 1/2 of N.W. 1/4

Christ Holzhauser and Wife

Wm Shand

PERPETUAL CONTRACT

Franklin Johns

E. 1/2 of N.W. 1/4

Conrad Witzel and Wife

N. 1/2 of N.E. 1/4 Sec. 5, T. 4

S. 1/2 of N.E. 1/4

MARTIN HOLZHAUSER - 2-6-1939 Anna B. Hawkins 3-14-1927	Frank Spague 1905	Wm Shand 1898
Wm Holzhauser 6-12-1914	Herbert H. Baker 3-21-13	Ella Shand 1889
Louis Holzhauser 1901	Henry 2-22-Weitzel 1910	Isabel Shand 1874
Mary Holzhauser 1-8-1919	Maria Witzel 1900	JOHN D. WALSH 5-21-1949
Christ Holzhauser 1903	Conrad Witzel 1915	Franklin Johns 1910
		Emma Walsh 6-9-1952
		Resina 2-27-Johns 1915
		Chas. Johns 1874
		Carrie Johns 1873
		Clark Johns 1871
Frank Tack 1-2-1937	DOROTHY LOUISE GREEN 5-22-1963	Frank W. Greene 8-17-74 City Burial
LEONA S. TACK 12-25-40	CATHERINE MORSE ASHES 1895	ALBERT GLENNON 7-13-1961
Amie Tack	ROGER W. MORSE 6-2-1973 VAULT	CATHERINE GLENNON 2-7-1964
Lucinda S. Tack 10-16-1924	Cath Tack 1901	Susan Green 2-20-1918
Jacob Tack 7-8-1918	Francis Tack 1890	Westroppe Green 11-5-1908
		Arthur K.
		Mary Schied
		Jacob Schild 1900
		Arthur H. Kreckman 8-16-06
		Cora E. Kreckman 12-4-1931
		Elizabeth Schild 1897
		John Kreckman 12-18-1923
		Ed. Schild
		Mary A. Shields 12-28-05
		ANNA L. SCHILD 4-20-1939 WILBERT VAULT
		Jacob Schild 12-2-15
		ALBERT S. SCHILD 3-20-1853 WILBERT VAULT

W

E 30'

PERPETUAL CONTRACT 46'6"

Jacob and Susan Tack

Jacob Schild & Elizabeth Schied

S.W. 1/4

S.E. 1/4

Scale 5" = 1 foot

MT. HOPE CEMETERY, PLOT RECORD

RANGE } SECTION }

3 LOT NO. 216

Form 1

SEE TRUST DEED  
Wm. Collinson  
N.W. 1/4  
PERPETUAL CONTRACT.

N  
Clare C. Sullstad  
PERPETUAL CONTRACT  
N.E. 1/4

HARRY B. ARCHER  
12-20-1954

Steel Vault  
Lottie M. Archer  
11-4-1927

steel Vault  
MARY A. 3-8-34  
RUTHERFORD.

Arthur J. Rutherford  
3-25-1922

HOMER L. PERKINS  
11-23-1956

Ida B Perkins  
12-20-1939

ARTHUR E. PERKINS  
4-18-1949

Husband

Wife

Christopher  
Anderson 1896

Brady Gordon  
3-1-1927

Nicoline Gordon  
2-2-1937

Clara  
Vegiard 1909

Chas. J. Vegiard  
12-8-1936

Emma Collinson  
(Mother)  
8-7-1907

Father  
1887

Wm J. 6-5-25  
Collinson

Hazel K.  
1900

FRANK B.  
HEBAND 1-24-49

DELPHINE COLLINSON  
12-17-1925

Delphine Collinson  
12-17-1925

Chas. A.  
1897

Elizabeth Porter  
1897

Sarah Parker  
1905

Wm. Parker  
1902

Jesse H. Webb  
8-23-1968

Margaret Webb  
1892

#3 Cement  
Wm. F. Webb  
4-29-18

Elizabeth Webb  
1902

Edna

Wm. E. Webb  
1892

Heirs of Wm. Collinson  
PERPETUAL CONTRACT.  
S.W. 1/4

Wm. E. Webb

SE 1/4 216

S

Claire Sullstad 1894  
Caroline Sullstad 1905

see order  
on file



**MT. HOPE CEMETERY, PLOT RECORD**

RANGE SECTION } **3** LOT NO. **217**

Form 1

*200.00 PC.  
2-8-1910  
\$75 only*

**Chas. Kreckman** *N.W. 1/4* **PERPETUAL CONTRACT** **Frederick Kreckman** *N.E. 1/4* *See. H.C.*

<p><b>Chas Kreckman Jr</b> 2-17-1926</p> <p><b>Isabel 2-2</b> Kreckman 1907</p> <p><b>Julia 12-27-23</b> Kreckman</p> <p><b>CHAS. W. KRECKMAN</b> 2-8-1940</p>	<p><b>F.F. Jenkins</b> 11-2-15 <b>Lloyd "</b> 6-12-16</p> <p><b>Earl Kuebel</b> 10-22-1934</p> <p><b>Clarence Kuebel</b> 4-22-15</p> <p><b>Margaret Kuebel</b> 3-8-1926</p> <p><b>Joseph Kuebel</b> 10-19-1932</p> <p><b>William G. Fox</b> 3-3-1930</p> <p><b>John P. Fox</b> 9-12-23</p> <p><b>Frederick</b></p> <p><b>Louisa 3-1-12</b> Kreckman</p> <p><b>Lillie</b></p> <p><b>M. Goodman</b></p> <p><b>F. Kreckman</b></p>
<p><b>LEONA J. MCKENNA</b> 11-8-95 MONTICELLO</p> <p><i>Willis</i> <b>McKenna</b> 12-3-87</p> <p><b>Lorraine A. CATALDO</b> 1-11-1933 OGTKA</p> <p><b>Oliva 3-31-1928</b> McKenna</p> <p><b>Patk P. McKenna</b> 8-9-1937</p> <p><i>Monument</i> 2 1/2" x 5 1/2"</p> <p><b>#7 Slate Vault</b> Emma Kussmaul 7-28-1927</p> <p><b>Jacob 1922</b> Kussmaul</p> <p><b>Minnie 1903</b> Kussmaul</p> <p><b>Christian 10-9</b> Kussmaul 1933</p>	<p><i>GENESEE</i> <b>IRVING C. BURRELL</b> 7-31-1908</p> <p><i>GENESEE</i> <b>LABRA BURRELL</b> 6/6/64</p> <p><i>GENESEE</i> <b>Phillian Woellert</b> 10-13-1965</p> <p><b>Chas. Woellert</b> 1901</p> <p><i>Extends 2' into this block on east of headstone</i></p> <p><b>State Vault</b> <b>Louise W.</b> 11-23-1933 H.S.</p> <p><b>Wm. C. 12-14-18</b> Woellert</p> <p><b>HENRY C. ROSS,</b> 7-19-1950 CONOLITE VAULT</p> <p><b>#5 Slate Vault</b> <b>CLARA ROSS</b> 1-5-1952</p>

W 30'

N 46' 1/2" Heads East

S' Heads East

**Jacob Kussmaul** *S.W. 1/4* **Charles Woellert.** *S.E. 1/4*

*High GRAVE TO CLEAR  
OFF SET TO CLEAR  
PERPETUAL CONTRACT  
2 GRG. ONLY  
HENRY C. CLARA ROSS  
Scale - 5" = 10'*

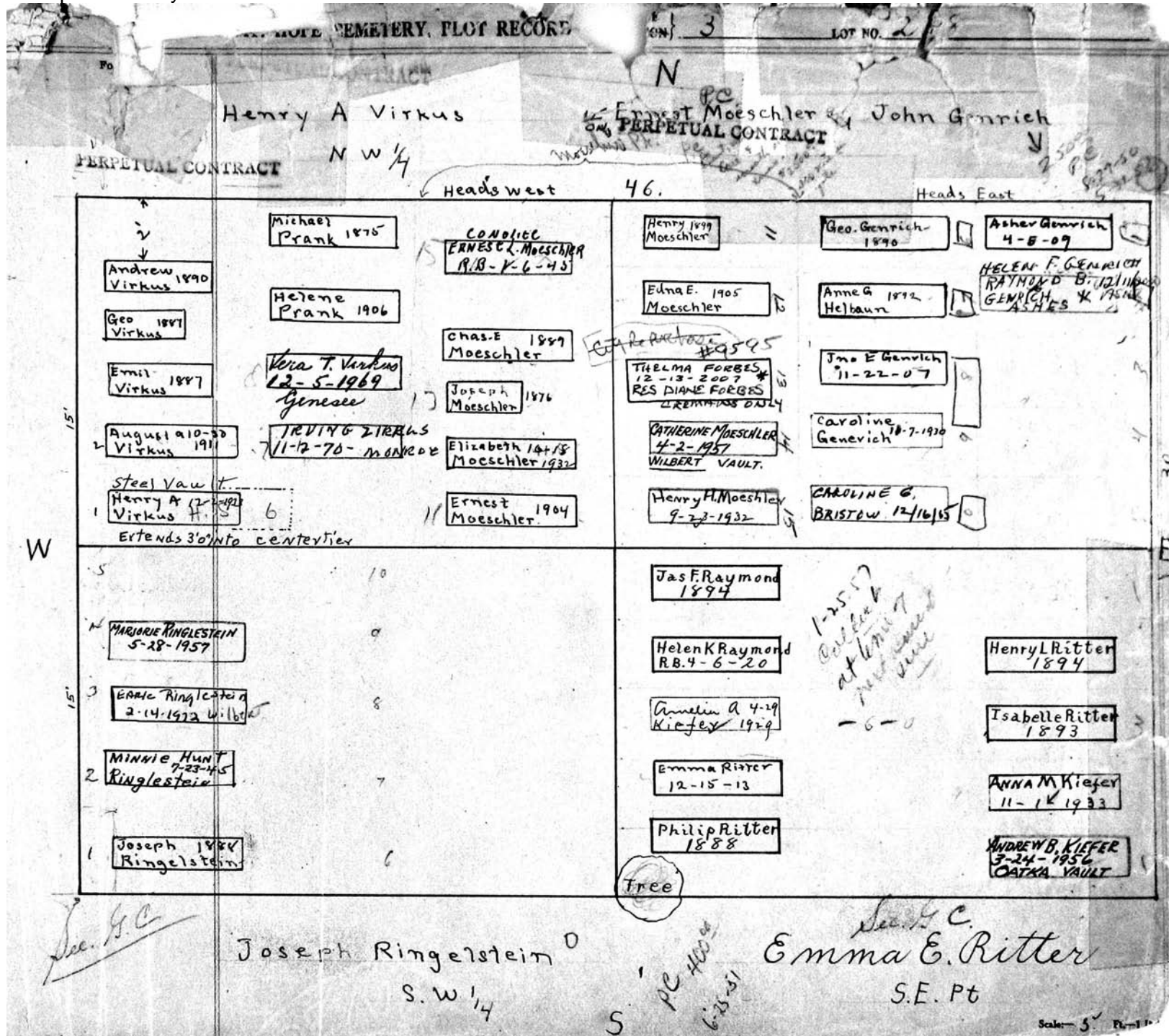

Form 1

IT. HOPE CEMETERY, RECORD SECTION 5 LOT NO. 219

N

Peter Loysen Chas Kueter

350<sup>00</sup> 38<sup>00</sup> 4-14-50 NW 1/4 N.E. 1/4

PC. 360.00 11-26-67

Charles Kueter 1891  
Charlotti Kueter 1906  
Charles F Kueter 1890

RICHARD J. LOYSEN 5-12-1943	WALTER C. LOYSEN 8-24-1954	AUGUST H E LOYSEN 10-11-77 ROCH. DE LUKE	George J. Barth 12-6-45	
Johanna C. Loysen 5-14-20	Agnes Zugelder 5-20-22	RAYMOND C. WHITE 9-23-1961 MONARCH	JOHANNA BARTH R.B. 1-6-45	Charlotte Kueter 7-2-06
Peter Loysen 3-11-1911	Marion F. White 2-10-1906	MATTIE L. WHITE 9-26-78 WILBEE	LORELDA C. BARTH 6-9-49 CHEST	BERTHA KUETER 3-28-62 CONOLITE
		*1916 LOWE 8-27-92 ROBERT LOWE 7/10/95 ASHES	AMELIA Oehlbeck 9-3-39 CONDITTE	Conolite William Kueter 11-27-1926
			August Oehlbeck 5-18-1926 *3 Cement	
			Jacob Wagner 5-12-1918 RB 10-20-1937	Samuel Gottry 3-11-1922
			Steel Caroline Wagner 8-2-1946	Samuel Gottry RB 4-30-1937
Wm H. Jones 6-16-09			HELEN L. WAGNER 12-2-1953 STEEL VAULT	Charlie 12-29-1885
#7 Slate Vault MARY J. JONES 6-21-1938				Edith
#7 Slate Vault John Jones 7-10-1923				Jamel Gottry Jan. 19, 1905

Mon 2'7"

Mon 1'8" 9'6"

Mon

PC. 850.00 1-28-67

Tree Removed MAR 1954

Edwin W & Helen L. Wagner  
Wm F. Richter  
W 1/2 of S.E. 1/4 E 1/2 of S.E. 1/4

John Jones PERPETUAL CONTRACT S.W. 1/4

See file 332 R 9

Scale - 5" Ft. - 1 inch

MT. HOPE CEMETERY, PLOT RECORD

RANGE SECTION 3

LOT NO.

220

Form 1

Adam Reithel

Henry Lewerenz N. 1/2 of N.E. 1/4  
Est of Christian Lewerenz. S. 1/2 of N.E. 1/4

N.W. 1/4

"Heads West"

N 46.67'

5 RES FLORENCE HARRISON	CONTINENTAL WILLIAM H HARRISON d. 1916	WILLIAM DUMMER 10-7-12	See Hilbert Ins. 6-13-07		Minnie Strebina 1902	Christian 1888. Lewerenz
4 FRANK DUMMER 3-8-1951 MONROE	Elizabeth Reithel 6-19-43	Eliz. A. Reithel 1226-24			MINNIE LEWERENZ 3-28-1991 Wilbert	Wilhelmina 1887. Lewerenz
3 13080 MONROE ELLA S. DUMMER	JOHN G. HILBERT 9-4-1957 WILBERT VAULT	Adam 7-25-17 Reithel				Friederick Leverenz
2 EDWARD REITHEL 9-21-1951	IDA R. HILBERT 5-31-40 cement	Katie 1907 Krause 3-22			OATHA VAULT OTTO F. KUSKE 12-30-1959	LENA LEWERENZ 8-1-1957 GRANITE VAULT
1 SLATE GEORGE W. 11-12 REITHEL 1945	Stenna 7-29 Reithel 1921	Albert 1888 Krause			Ida Kuske 12-13-1985	CON-O-LITE HENRY LEWERENZ 4-6-1933
Nettie H. Briggs 2-24-1908	CATHERINE BRIGGS 11-29-1950	Jennie E Griffith 5-5-1930			CONCRETE CHRISTIAN M. LICHTWART 5-9-40	Christian 1892. Lichtwart
John H. Briggs 2-8-1939	JOSEPH A. BRIGGS 10-15-40				Anna Lichtwart 1-4-1920	Friedericka 1888. Lichtwart
Fred W. Briggs 1901	Edwin F. B. 1945 1903				Augusta E. Bloomer 8-28 1947	see File
Harriet Briggs 1903					see File	Minnie Lichtwart 7-27-21
Chas. Briggs 1899.	Chas. Lewis 7 Briggs 4-30-34				Chas Young 1893	JOHN LICHTWART 6-6-1951

7.C. 1882  
2 graves  
see Jenna  
W

Heads West.

S 4517'

Heads East

Chas., John and Wm. Fowler Briggs.

C., J.A., C.M. and A Lichtwart

S.W. 1/4.

S.E. 1/4

P.C. 350.00  
12-5-66

Scale - 5" = 1 inch

MT. HOPE CEMETERY, PLOT RECORD

RANGE SECTION 3

LOT NO. 221

Form 1

Kalamazoo Loose Leaf Binder Co., Kalamazoo, Mich. 49001

J Arthur Martin N.W. 1/4

Ludwig Krause. W 1/3 of N.E. 1/4  
Charles Krause. Mid 1/3 of N.E. 1/4  
Charles Kubitz. E 1/3 of N.E. 1/4  
PERPETUAL CONTRACT  
- 45' P.C. 250' 5-17-51 2/3

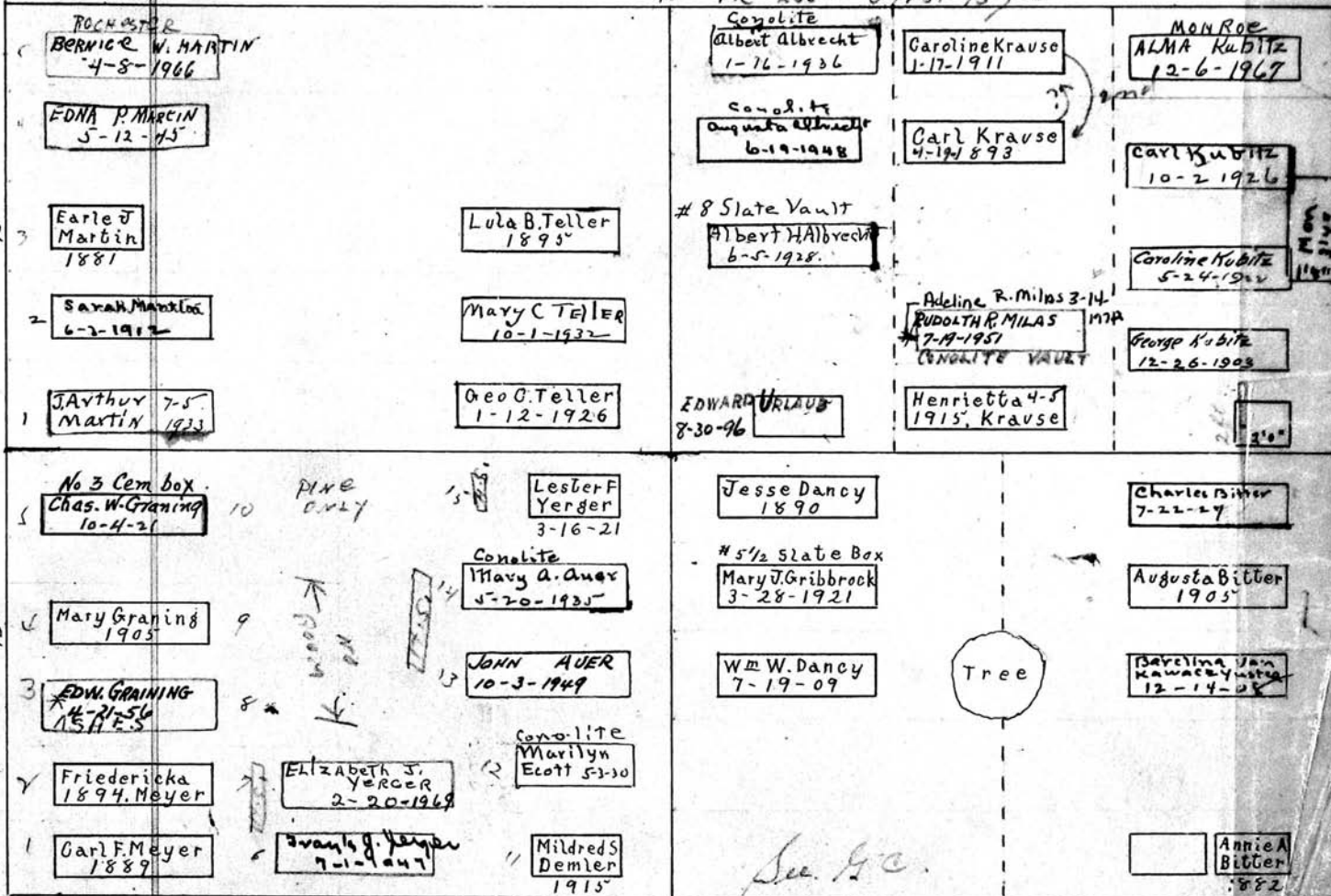

W

15'

15'

JR 8 - WALTON YACGER 3-10-1946  
Graning and Meyer S.W. 1/4

Charles H. Bitter. E 1/2 of S.E. 1/4  
Mary J. Dancy. W 1/2 of S.E. 1/4

MT. HOPE CEMETERY, PLOT RECORD

RANGE SECTION } 3

LOT NO. 222

Form 1

Leopold Schmitt

NW 1/4

PERPETUAL CONTRACT

John T. Killip

NE 1/4

PERPETUAL CONTRACT

44.83

Heads East

<p>Cereso MAUDS BITTER 4-4-1966</p> <p>CONSTANCE FRANK H. BILGER 4-19-43</p> <p>Addie Schmitt 5-28-1927</p> <p>Mary A. Schmidt Mother 10-12-1907</p> <p>LEOPOLD SCHMITT Father 1901</p>	<p>Capl. Wm. Schmitt 10-10-1867</p> <p>Monument 4'10" x 3'2" 7/16/92</p> <p>ELIZABETH B. SMARZO</p> <p>Albert E. Melahar 5-29-1912 Div-5-12-62</p>	<p>William 1875</p> <p>Mary 1875</p> <p>Cora</p> <p>Edw A Schmitt 5-6-1935</p> <p>Elizabeth B. Schmitt 6-4-34</p> <p>Conrad Schmitt 2-17-1930</p>	<p>Florence S. Killip 3-4-1972 Monticello</p> <p>Wilbert Arthur S. Killip 4-7-1947</p>	<p>Eliza Killip 12-18-1919</p> <p>Margaret 1892</p> <p>Margaret Killip 1891</p> <p>Lulu 1882</p> <p>Norrah 1883</p> <p>Eva F 1884</p> <p>Kittie 1887</p> <p>Geck 1888</p> <p>Margaret 1892</p>	<p>John Killip 1891</p> <p>Lillian P. Killip 1-14-1943</p> <p>Cath. Killip 8-17-1935</p> <p>Harry B. Killip 8-11-1928</p>
<p>WILBERT VAULT Wm R. BAKER 8-7-1951</p> <p>IDA K. BAKER 6-10-1955 WILBERT VAULT</p> <p>Edw. 2-18-1946 Stoll</p>	<p>Norwalk Vault Louise H. Klein 7-10-1945</p> <p>Chas E. Klein 1891</p> <p>#3 Cement Philippina Klein 2-2-1922</p> <p>Peter C. Klein 1888</p>	<p>David W. Grey 1888</p> <p>HERBERT D. GREY 9-24-43 MARY A. Grey 3-29-1935</p> <p>Jennie Charlotte Grey 5-21-1935</p> <p>Thomas Y. Goode 10-19-1914</p> <p>JANE GOODE 7-5-1950</p>	<p>James S. Gosnell 9-17-06</p> <p>Sarah Gosnell 1899</p> <p>and ashes of Sylvia Gosnell 1/4 Rev James Gosnell 1900</p> <p>Dan L. Gosnell 1-15-1938</p> <p>Maudie V. Gosnell 9-3-1925</p>		

Heads West

W 30.

44.67

Phillipina Kleine

PERPETUAL CONTRACT SW 1/4

Daniel G. Wm Gosnell

SE 1/4

2000e. 11-8-45

MT. HOPE CEMETERY, PLOT RECORD

RANGE SECTION

3

LOT NO.

223

Form 1

Samuel Gosnell Jr.

Catherine C. Whitbeck

P.C. 5350.-

Sec. 9. C. N.W. 1/4

N.E. 1/4

P.C. 2500  
1/2 x 1/2  
1/4 x 1/4

N

44.3'

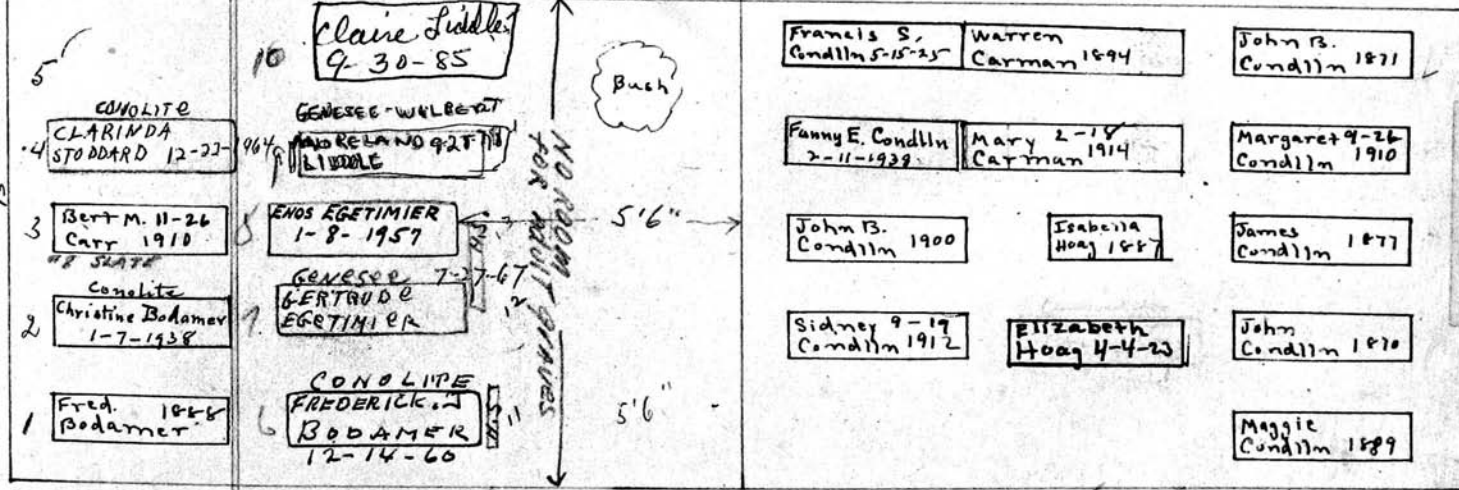
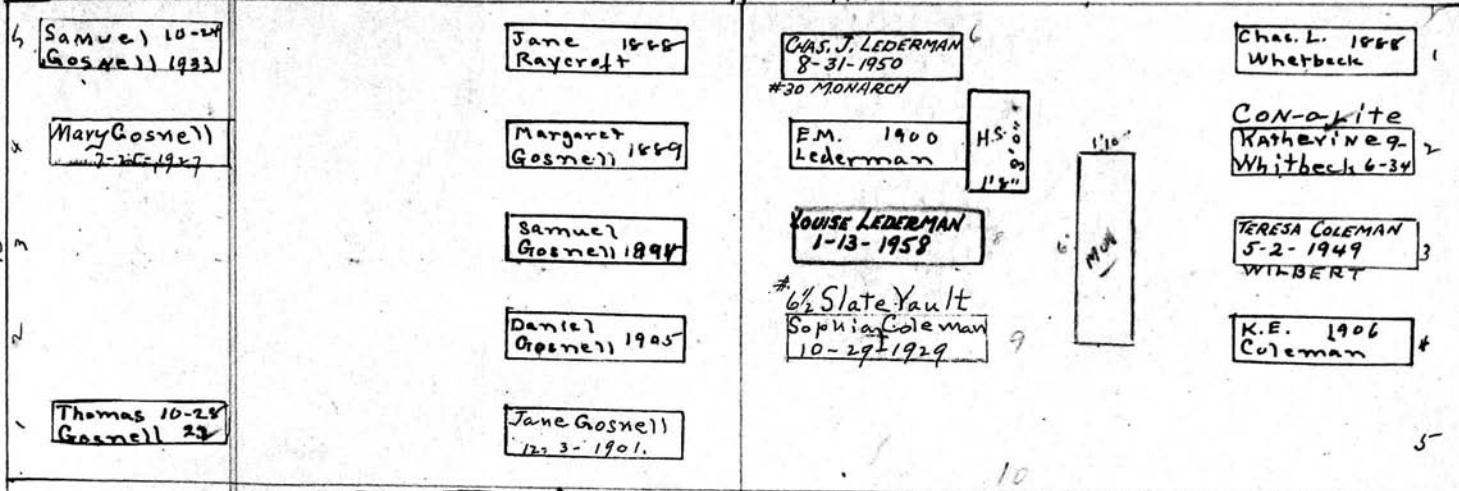

Christine Bodamer

Margaret, Francis & Fannie Condit

S.W. 1/4

S.E. 1/4

Scale - 1/2" = 1 foot

MT. HOPE CEMETERY, PLOT RECORD

RANGE SECTION

3 LOT NO. 224

Form 1

Oliver C. Andrew & Adeline McLaren

Christian Lange  
PERPETUAL CONTRACT N.E. 1/4

Tree

NW 1/4  
44.5"

Susan C. Chandler 1898

Adeline Haynes  
12-21-1929

John Doerr  
1903

Infant Rice

John Arnet  
1907

See G.C.

Fredericka Doerr  
1-19-27

Arthur Doerr  
1890

Charlotte Arnet  
1904

NETTIE D. RICE  
11-1-1957

Jennie Doerr  
1892

Carrie 7-5  
Arnet 1921

Sunken

CLARENCE O. LONGMORE  
8-20-1959

\* Carl H. Doerr  
6/25/87

Monument  
3' 10"

Minnie Lange  
6-18-1914

Lora H. Faqax  
11-25-21

no room

Kitty Longmore  
2-18-1924

conolite  
Florence May  
DORR 6-1-46

LARDING  
DOERR  
1-23-38

Christian Lange  
1916

Herman  
Kenning

Alice Barons  
8-7-17

Ernst Luedeke  
7-19-1940

Wm. Luedeke  
3-29-18

Baby 1899

Wm. Barons  
2-7-1913

Bertha Luedeke  
2-29-1916

Wilhelmine  
1915 Grieppe

BERTHA KENNING  
WEST  
5-7-1969

Bernard Grieppe  
5-2-25

Henry Grieppe  
1906

Clara L. Kenning  
10-16-17

See File  
HRECHAUCH

conolite  
William Grieppe  
11-15-1947

Wm. Grieppe  
1905

Henry J. Kenning  
9-29-1908

Fanny (Aperunch)  
Pisiki FF 7-7-1972

AUGUST BUNDE 6-21-50  
CONOLITE VAULT  
CAROL BUNDE  
10-29-01  
Arnet H. Bunde  
12-14-64

Henrietta 5-5  
1913 Grieppe

RES. ARCHES OR DOLORES BUNDE

Henry J. Kenning

William Grieppe

PERPETUAL CONTRACT

S.W. 1/4-224-TR-3

DUG XXX DEEP  
6-21-58

S.E. 1/4-224-TR-3



MT. HOPE CEMETERY, PLOT RECORD

RANGE SECTION } 3 LOT NO. 225

Form 1

N 1/2 of N.W. 1/4 Albert Kalwas E 1/2 of NE 1/4 Christian Kramer  
S 1/2 of N.W. 1/4 Reinhold Miller W 1/2 of NE 1/4 John Bisher  
44.5" Sec. G.C.

TRESA  
INFELT  
2-1960  
LITE VAULT

Charles Kalwas 9-27-1935	Wm Kalwas 1876	Albert Karwoick 11-18-1908	John Bisher 12-16-19	Christian 1891. Kramer
Martha 1882	Albertina Kalwas 3-12-1919	Katharina 1-22-1914, Bisher	Cath K Kramer 1888	
Henry 1888	Albert Kalwas 1912	Geo. C. Bisher 5-29-1935	Caroline Loderarf 2-21-94	
Albert Kalwas 5-10-1954 CONOLITE VAULT	EXTRA DEEP	Lillian G. Bisher 6-23-1972 Munroe	Erene Koch- 4-2-19	
Wilhelm Durdel 1886	Reinhold Miller 1-1-1976	Martha F. Miller 2-19-75 Erie 3-29-1983	ASW RANDALL LARUE 4 EBNER 107885 K AEW KATHRYN W. EBNER 3-29-2006	
Johanna Miller 9-8-20	ANNA DEEGAN 9-27-85	Hennietta Miller Gm Vault		
Reinhold Miller 10-26-1923				
	Concreted Doabel B. Brooks 3-8-80	George Peter Rice 9-19-1972 Rochester	Peter Rice 3-20-1908	
	CONCRETE ARNOLD S. BROOKS 4-17-1961	4-18-21 Carl Eisenberg Infant	Elizabeth R. 7/20/9 Simon	Agusta Rice 1895
	GURNEY F. BROOKS 2-15-1950	CONOLITE JACOB 4-11-64 LIEBERUM	Natie Rice 1906	
Regena Goldberg 1889	#30 Wilbert IDA BROOKS 10-24-1960	CON-O-LITE CAROLINE R LIEBERUM 1932	Geo. Reuss 1898	
Soloman 1907. Goldberg	ANSON G. BROOKS 7-21-1949	#6-CONOLITE LENA. RICE 3-3-1941	Edward Reuss 1888	

W 1/2 of SW 1/4 Solomon H. Goldberg S  
E 1/2 of SW 1/4 Anson G. and Ida Brooks  
Peter Rice  
S.E 1/4-225

MT. HOPE CEMETERY, PLOT RECORD

RANGE SECTION

3

LOT NO.

226

Form 1

Congregation of Bena David.

