

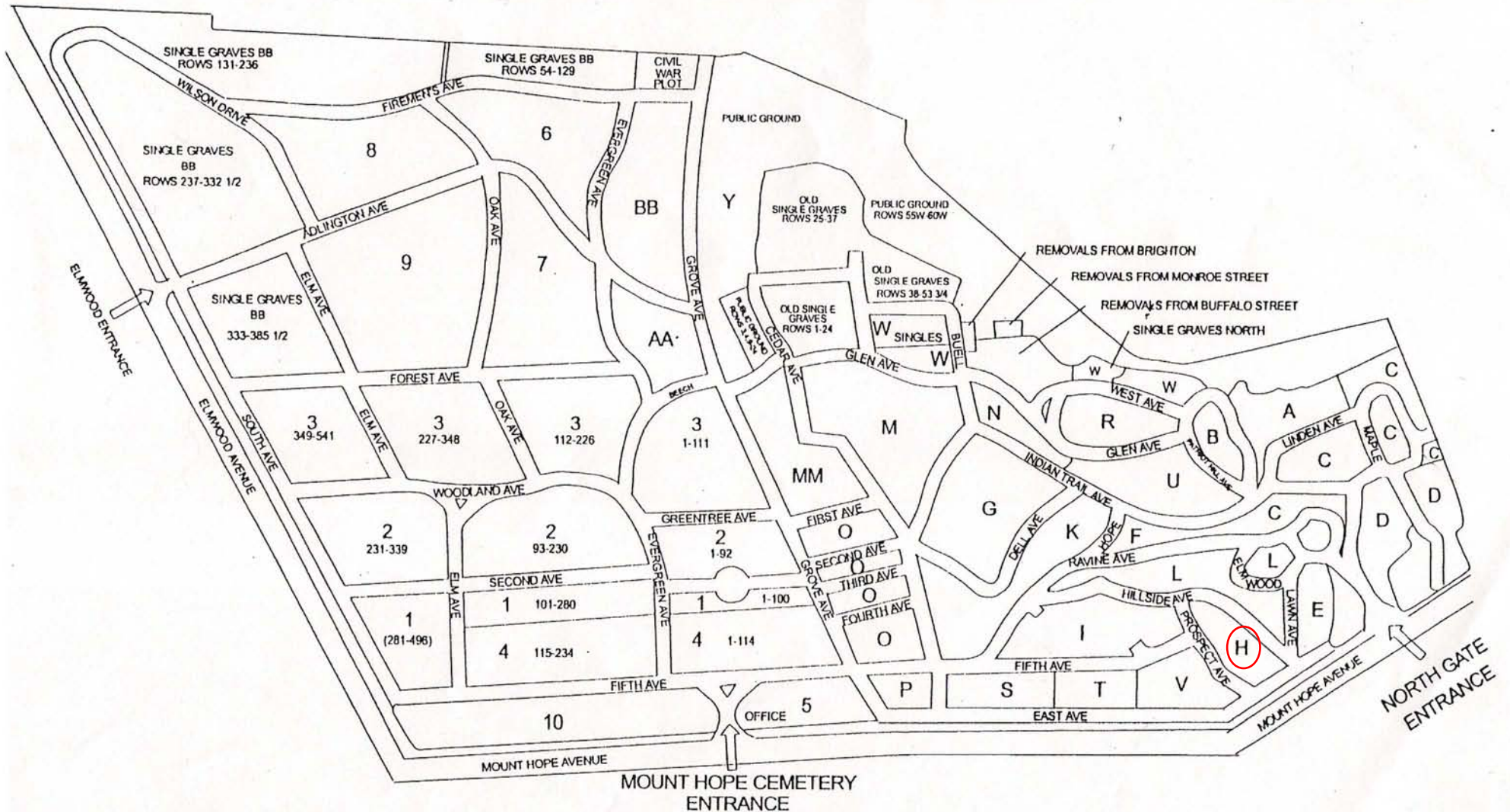

# MOUNT HOPE CEMETERY

1133 Mount Hope Avenue  
Rochester, New York 14620



The Friends of Mount Hope Cemetery  
Frank Gillespie, September 1999

# SECTION H

Frank Gillespie March 2000  
The Friends of Mount Hope Cemetery

Section L



HILLSIDE AVENUE

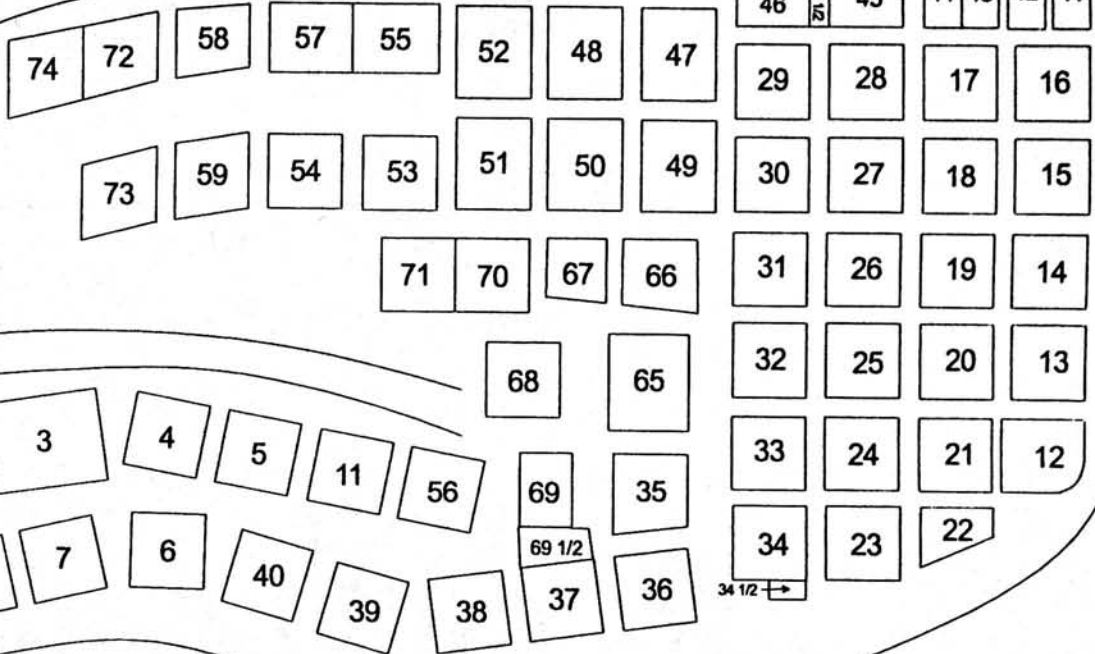
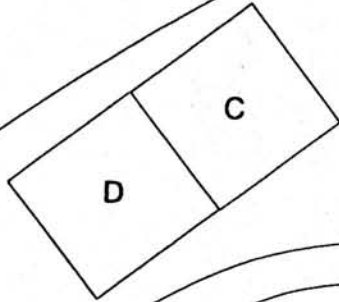

EAST AVENUE

PROSPECT AVENUE

PROSPECT AVENUE

Section I

FIFTH AVE

F. Gillespie rev June 2000

Section V

**SECTION H****HILLSIDE AVENUE SIDE**

Beginning at Hillside and East heading  
west on Hillside

<u>LOT</u>	<u>PART</u>	<u>NAME</u>
41	All	Willis/Linn monument
46	All	Bowerman
48	E 1/2	G. Southard
48	W 1/2	Nelson monument
55	E 1/2	C. Friedrich (3 stones)
55	W 1/2	Hummel monument
57	E 1/2	C. Faber
<i>( 6 steps)</i>		
58	All	H, Sabin
72	All	M. Ewart
<i>(11 steps)</i>		
74	N 1/2	Ellsworth monument
64, 64 1/2	All	Joslyn (2 satones)
63	N 1/2	A. Cooke
63	S 1/2	W. Buell
60	All	J. Baker

*(Corner Hillside and Prospect -  
now on Prospect)*

**PROSPECT AVENUE SIDE**

<u>LOT</u>	<u>PART</u>	<u>NAME</u>
61	W 1/2	J. Baker
<i>(Go up three steps)</i>		
10	All	V. Mathews monument
9	All	J, Biden monument

At corner of Fifth and Prospect,  
going east on Prospect

<u>LOT</u>	<u>PART</u>	<u>NAME</u>
8	All	E. Treat monument
7	All	R. Smith
<i>(Up 4 steps)</i>		
6	SE 1/4	P. Chapman
40	W 1/2	F. Ainsworth
39	All	Love monument
38	W 1/2	E. Shelmire
38	E 1/2	C. Barnes
36	W 1/2	J. Langham
36	E 1/2	I. Beagle
34 1/2	W 1/2	Attridge monument
34, 34 1/2	E 1/2	Defendorf monument
23	All	S. Parsons
22	All	J, Healy

*(At corner of Prospect and East  
going North on East Avenue)*

**EAST AVENUE SIDE**

<u>LOT</u>	<u>PART</u>	<u>NAME</u>
12	All	Parsons monument
13, 14	All	Barton/Wolcott monument
16	E 1/2	M. Shaw

NOTE: Hillside and Prospect are now unpaved paths.

MT. HOPE CEMETERY, PLOT RECORD

RANGE } SECTION }

H

LOT NO.

1

Form 1

Jacob M. Schermerhorn

A 71

PERPETUAL CONTRACT.

N 20

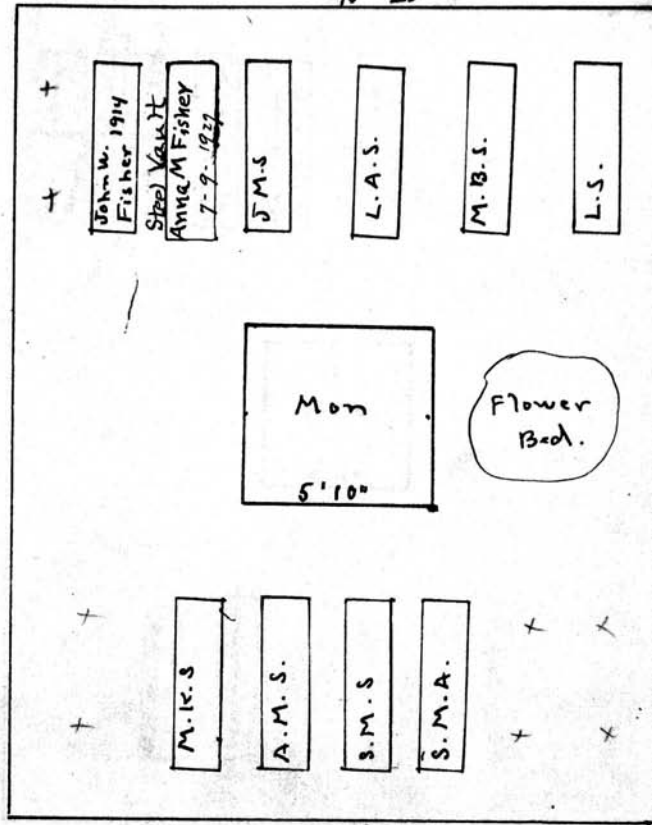

E 20

S. 20

- Jacob M. Schermerhorn 1840
- Louisa " 1849
- Mary K " 1853
- Susan M. Adams 1842
- Susan Morrison 1846
- Matilda Barber 1874
- A. M. Schermerhorn 1855
- Louisa " 1839

Heads North

Scale: 5" Fr. 1/4 inch



MT. HOPE CEMETERY, PLOT RECORD

RANGE }  
SECTION }

H.

LOT NO.

2

Form 1

Samuel Miller<sup>o</sup>

411

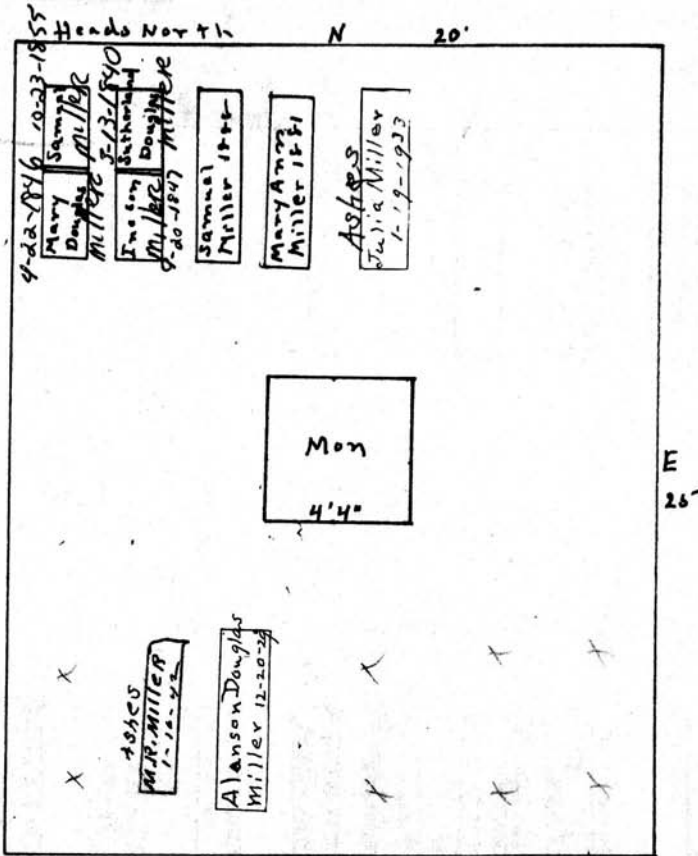

Spaced 6 Graves.-So.Tier.  
Heads South S

Scale - 5 Ft. = 1 Inch

MT. HOPE CEMETERY, PLOT RECORD

RANGE } SECTION }

H

LOT NO.

3

Form 1

Elizabeth F. Smith

All-3-H

PREPARED BY

Elizabeth F. Smith  
 9-14-1880  
 Charles P. Smith  
 8-1-1873  
 Henry H. Smith  
 4-4-1887  
 Elizabeth F. Smith  
 9-10-1878  
 Henry H. Smith  
 4-4-1887  
 Charles P. Smith  
 8-1-1873  
 Elizabeth F. Smith  
 9-14-1880

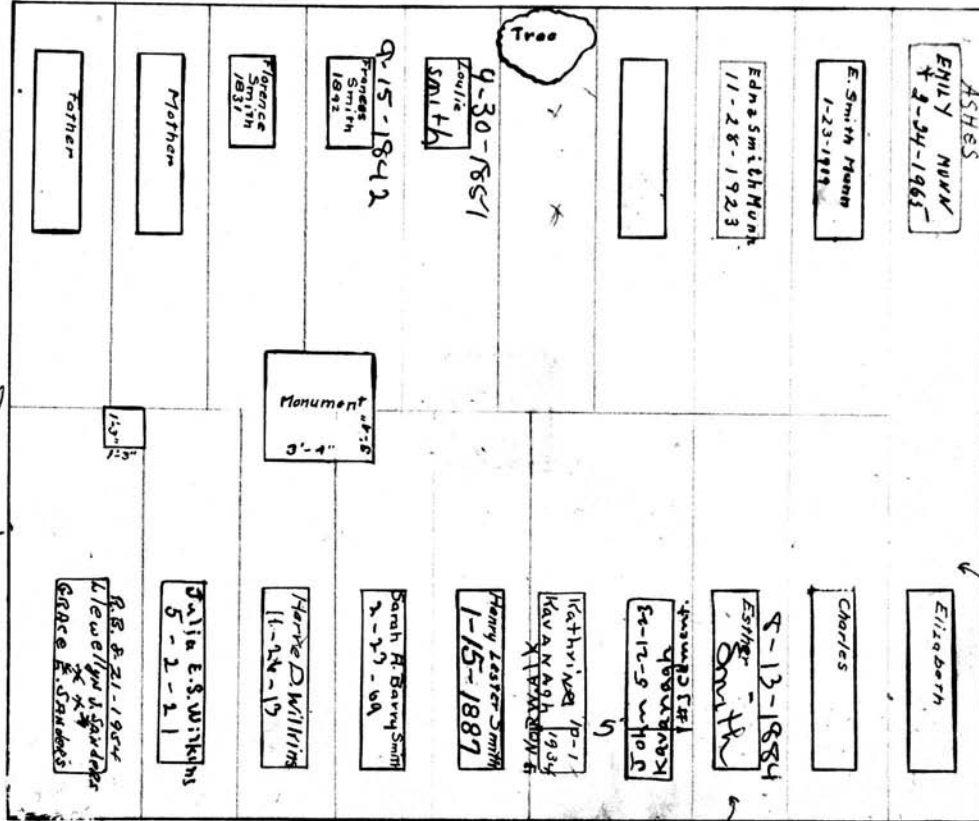

These Remains to be Removed Here  
To MAKE ROOM FOR FRED L. SMITH.  
AT HIS INTERMENT.

Scale: 5 Ft. = 1 Inch.

MT. HOPE CEMETERY, PLOT RECORD

RANGE SECTION } H

LOT NO. 4

Form 1

N

Wm. C. Crane and N H Galusha

All. 4

PERPETUAL CONTRACT.

20.

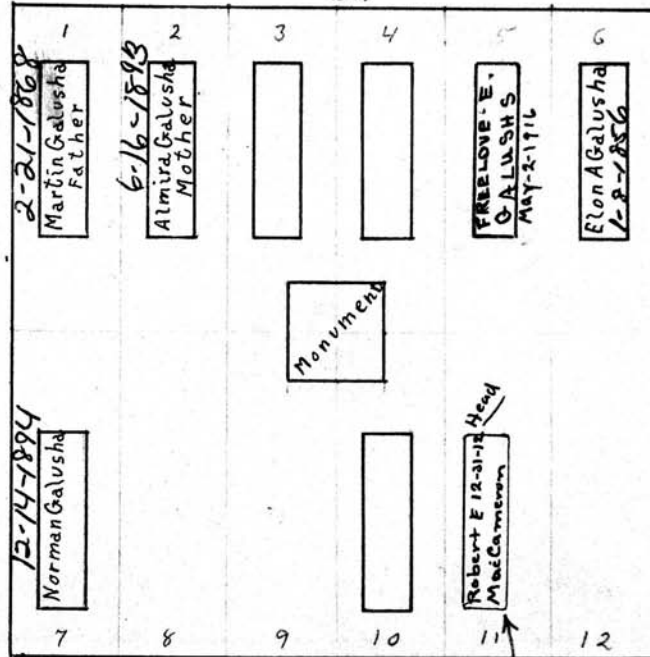

W

20.  
J. J. Galusha  
10-12-1876  
Samuel Galusha  
4-7-1863

LOUISE VAN YODRIS  
MAC CAMERON  
10-31-1962 ASHES

S

Scale: 5" Ft. - 1 Inch.

MT. HOPE CEMETERY, PLOT RECORD

RANGE }  
SECTION }

H

LOT NO.

5

Form 1

Wm. P. Smith <sup>0</sup>

A 71

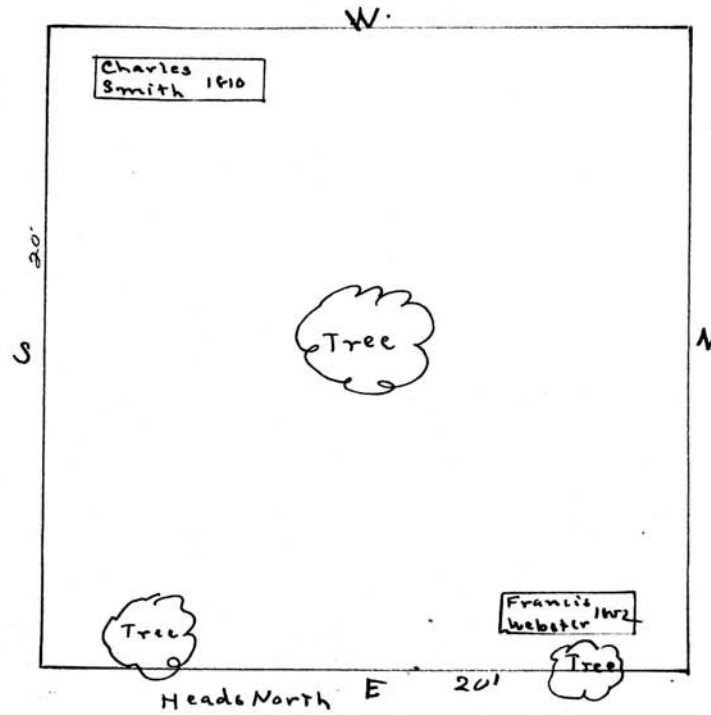

2. freeman  
1-28-1859

Scale: 6 Ft. = 1 Inch



**MT. HOPE CEMETERY, PLOT RECORD**

RANGE } H  
SECTION } LOT NO. 6

Form 1

Newell A. Stone  $\frac{NE}{4}$

NW  $\frac{1}{2}$

N.

1855 Dec 23	Fred K Stone	5 yrs				
1857 Aug 7	Lamont	11	31"	5 4 1/2 1802		
1868 Aug 28	Mary N	11	75"			
1885 Apr 14	Joseph	11	94"			
1887 Apr 3	Samuel A.	4	67"			
1893 July 7	Geo. L.	11	44"			

pc  
200<sup>00</sup> 2-2-47  
400<sup>00</sup> 2/27/50

EMMA 2-14-23 1848-1878						
Pierpont 1877 Chapman				Emeline 1878 Chapman		Julius Traugott 4-9-1934

W

E

S 20' See 35-H

Pier Chapman and R. J. French

S.E.  $\frac{1}{2}$

Scale: 5 Ft. = 1 Inch

Jonathan French  
 Sarah J. French  
 A French Child  
 Caroline A. French  
 12-23-1855

MT. HOPE CEMETERY, PLOT RECORD

RANGE SECTION

H

LOT NO.

7

Form 1

Rufus Smith

PERPETUAL CONTRACT.

N Heads North

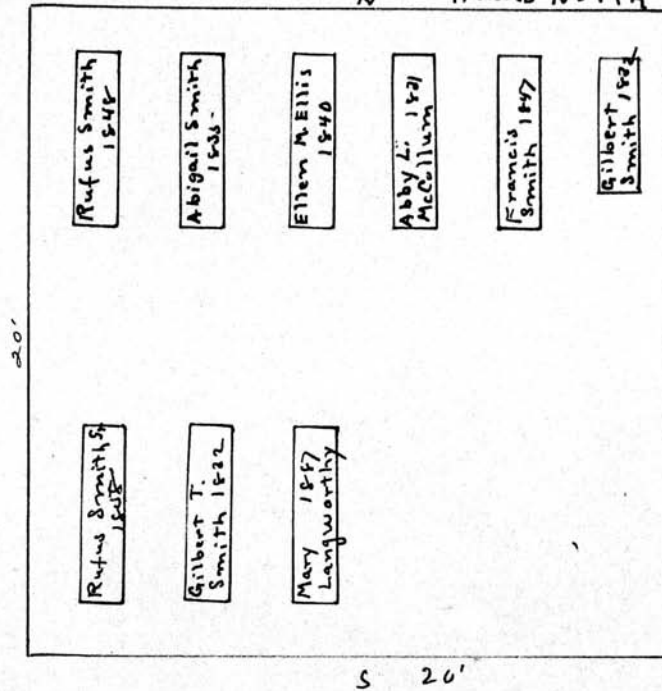

Scale: 1/4" = 1 Foot

MT. HOPE CEMETERY, PLOT RECORD

RANGE SECTION

H.

LOT NO.

8

Form 1

Ellery J Treat

John Treat

W 1/2

E 1/2

pe.  
30000  
5/29/09

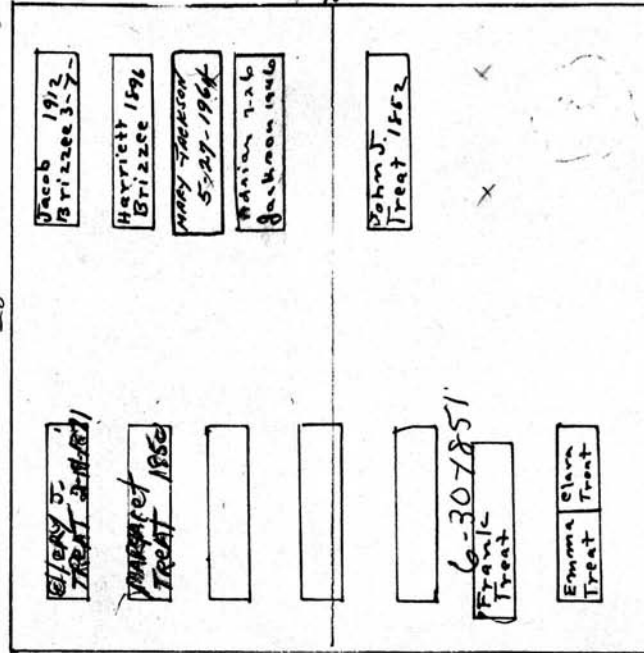

M 20'

20' Heads North

(Clara) Child 8-23-1849  
Benjamin Treat 7-22-1841  
Emma 7/7/1843

Scale: 6 Ft. = 1 Inch

**MT. HOPE CEMETERY, PLOT RECORD**

RANGE SECTION } **H** LOT NO. **9**

Form 1

**W**

*John Biden*  
All. 9

20 Heads South

Henry Heath Nettleton	John Biden
Henry Sanford Nettleton	Sarah Biden
Fannie Nettleton 6-17-1922	Mary Ann Biden
EMILY NETTLETON RB. 9-27-1961 ASHES	Eliza Biden
Emily Biden 4-25-1910 Procter	Honoria Biden 1882
Henry M. Biden 1883	John Biden, Jr
	Georgiana <sup>Wife of</sup> George Biden

Gate Monument 3'

S N

20'

E

These names appear on Monument

John Biden	1853	Aged	47 yrs
Edmund Biden	1830	"	23 "
Eliza Biden	1849	"	41 "
Sarah Biden	1824	"	45 "
John Biden	1870	"	86 "
Mary A Biden	1848	"	35 "
Georgiana Barnard	1838	"	25 "
Georgiana Barnard	1838	"	11 Months
George B. Biden	1842	"	22 "

Scale 5" = 1 foot



MT. HOPE CEMETERY, PLOT RECORD

RANGE SECTION

H

LOT NO.

10

Form 1

V and S. Mathews

PERPETUAL CONTRACT.

A11

N. 22' Heads North

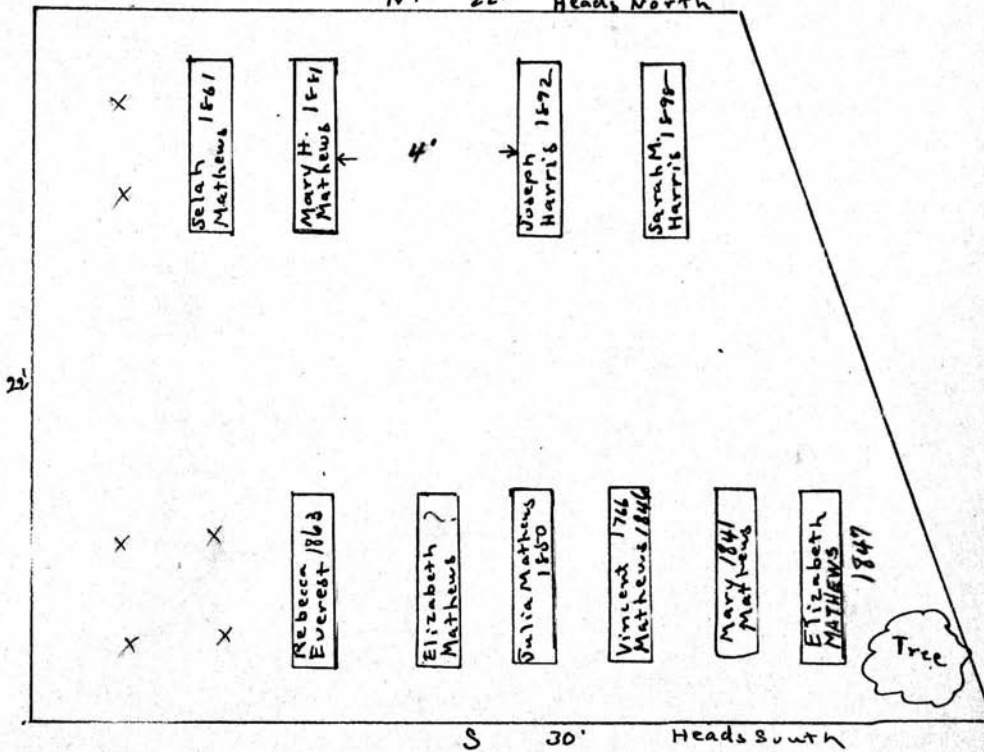

Scale: 5 Ft. = 1 Inch

MT. HOPE CEMETERY, PLOT RECORD

RANGE SECTION

H

LOT NO. 11

Form 1

N

Edward Dawson<sup>o</sup>

Roland Jones<sup>o</sup>

N.W. 1/4  
once shared all north

N.E. 1/4

Mary Dawson  
8-5-1860  
Edward Dawson  
10-29-1861

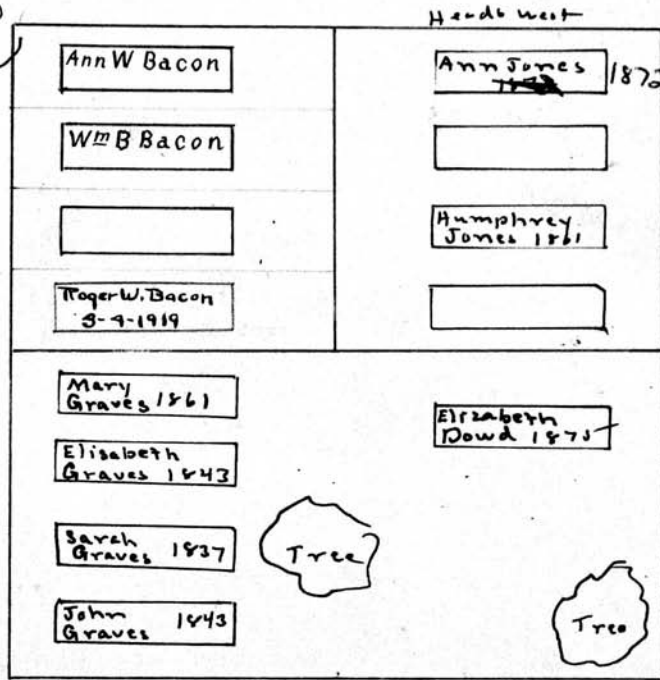

Rowland Jones  
5-12-1884

Mary Graves<sup>o</sup>

S 1/2

S

Scale - 5" = 1 inch

MT. HOPE CEMETERY, PLOT RECORD

RANGE }  
SECTION }

H. LOT NO.

12

Form 1

Augusta B. Parsons

PERPETUAL CONTRACT.

A21

N 23'

W  
20'

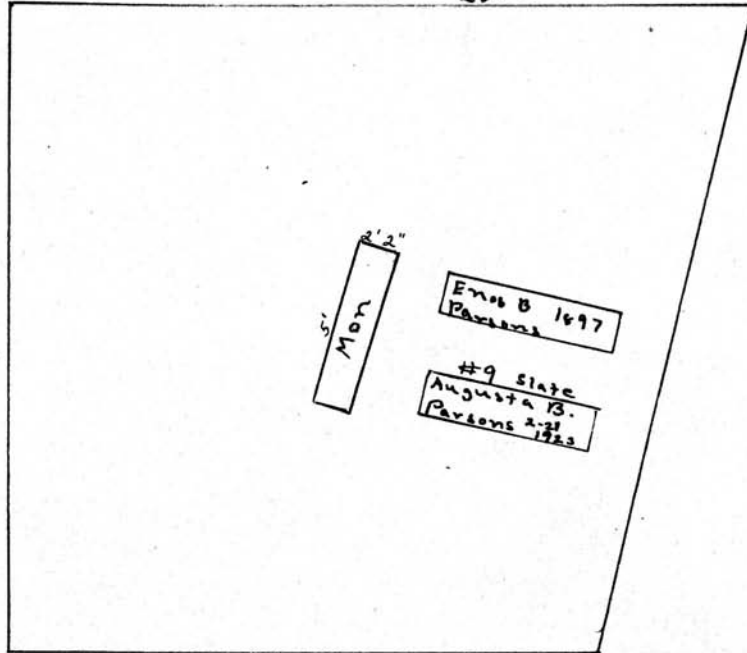

5' Mon  
2'2"

Enc B 1697  
Parsons

#9 slate  
Augusta B.  
Parsons 2-21  
1923

Scale: 5" = 1 inch

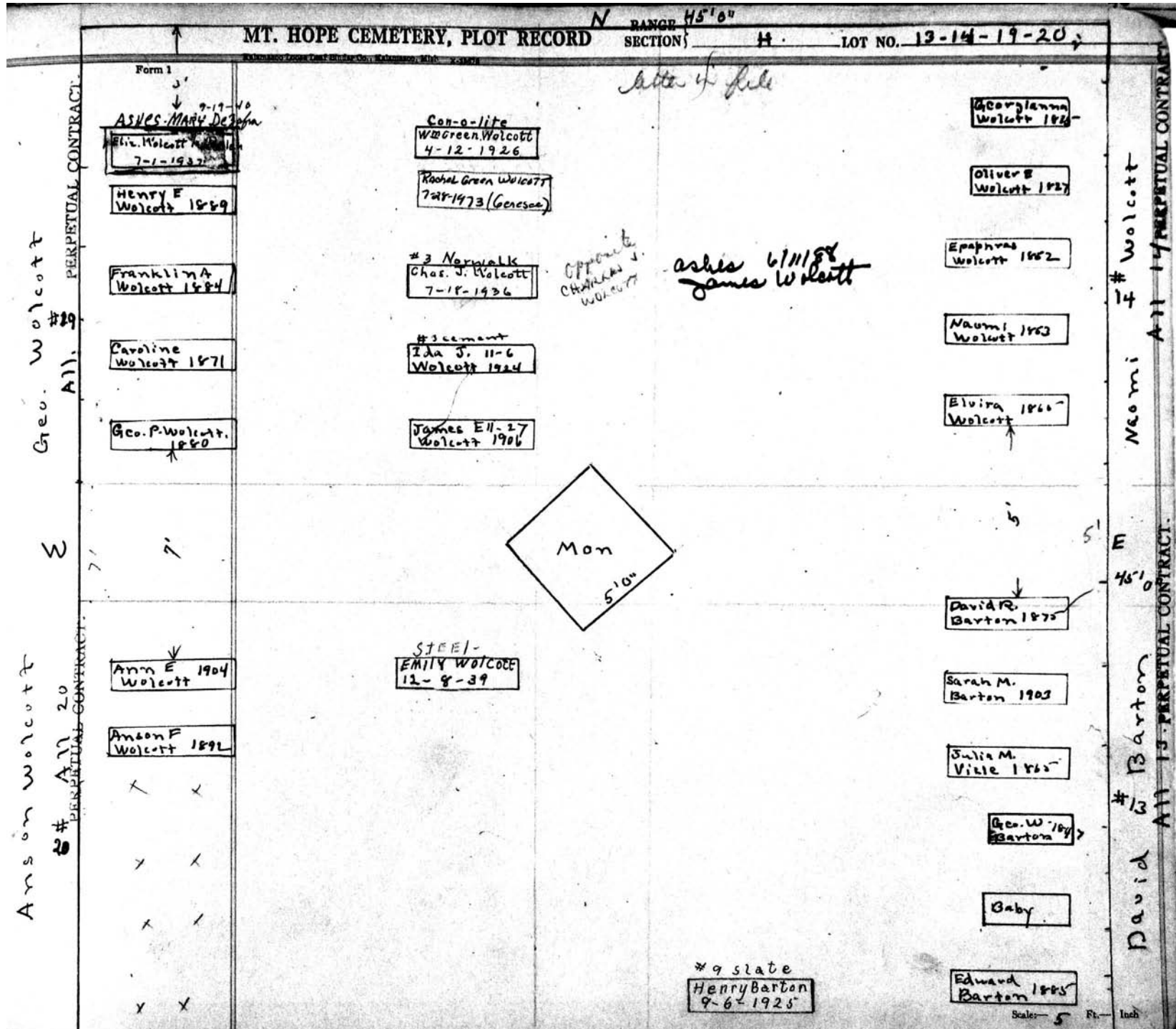





MT. HOPE CEMETERY, PLOT RECORD RANGE } H  
SECTION } LOT NO. 16

Form 1

N

Wm Cummings Horatio N. Shaw<sup>o</sup>  
W 1/2 Head in Vault. East. 1/2  
PERPETUAL CONTRACT.

20'

W. H Cummings 1850	Maggie A Bradstreet 1869
Lucy A. 1885 Hughson	Tree
Elizabeth C. Nutting 1874	Randolph P. 1879 Bradstreet
[Empty Box]	Louisa 1892 Bradstreet
Nancy 1833 Cummings	H. N. Shaw 1863
Chas. Cummings 1852	Melissa B. Shaw 1853
	Lloyd Shaw 1859

20'

W E

PHOEBE  
CUMMINGS  
1833

Albert S. Cummings  
2-8-1839  
Helen Cummings  
10-21-1840

S

Scale - 5 Ft. - 1 Inch.

MT. HOPE CEMETERY, PLOT RECORD

RANGE } SECTION } H LOT NO. } 67

Form 1

James Abrams<sup>o</sup> Elizabeth Arnold<sup>o</sup>

W 1/2 E 1/2

N.

20'

Tree Tree

Sarah Abrams 1853

Margaretha E Berron 1865

Henry Engels 1854

Elizabeth Arnold 1873

Jacob Arnold 1854

Heads west S 20'

Baby-Margaret Arnold 6-18-1854

Scale— 1/2 Ft.—1 Inch

MT. HOPE CEMETERY, PLOT RECORD

RANGE SECTION

H

LOT NO.

18

Form 1

Andrew McWhorter

Edward Gray

W 1/2

E 1/2

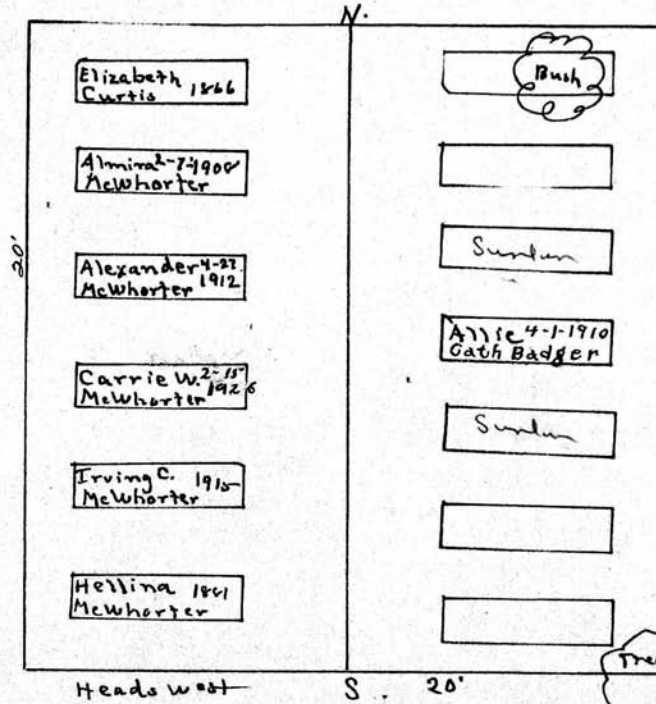

John W. Gray  
12-27-1891

Catherine Gray  
12/4/1875

Edward R. Gray  
2-3-1853

Catherine J. Gray  
5-22-1853

R. J. Gray's child  
9-5-1854

Edward Gray  
7-20-1873

Scale: 3 FE. = 1 Inch



**MT. HOPE CEMETERY, PLOT RECORD**

RANGE } SECTION } H LOT NO. 21

For 19-20 see 13 H.

Form 1

John Quackenbush	WILLIAM SMITH 4-28-45
Nancy 4-3-1900 Quackenbush	Alma F. Smith <small>2nd from 7th Cav</small> 10-17-1906
Henry Stickley 11-23-17	ALBERT H. SMITH 10-16-43
Margaret H-25 Stickley 1925	Fred W. Smith 11-13-09
Mary Smith 1853	[Empty Box]
Wm. H. Smith 1891	[Empty Box]
	Clayton C. Smith 5-28-16

NANCY QUACKENBUSH IS BURIED ON THE SAME PLOT WHERE SHE WAS BORN IN LOG CABIN  
IN 1818

CHAUNSEY HARRIS  
9-19-1863 AGE 47

Polly Ann Smith  
3-8-1859  
baby - J. Mortimer  
See G<sup>c</sup> Smith  
4-2-1859

John and Wm. Smith  
11-21-4

Scale 5 ft = 1 inch

MT. HOPE CEMETERY, PLOT RECORD

RANGE }  
SECTION }

H

LOT NO.

22

Form 1

Mary Wolcott

James Hair <sup>o</sup>

PERPETUAL CONTRACT.

2 Graves only

Mary & Sarah Wolcott

Bal. of Lot.

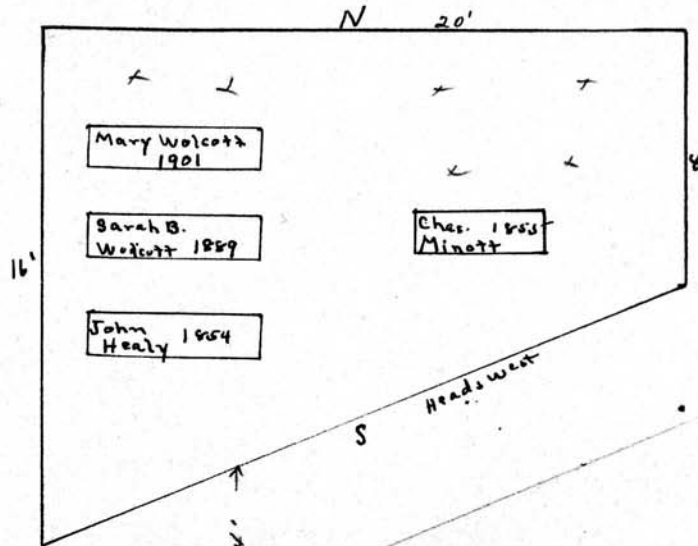

Geo. PIERCE  
2-3-1863

Scale: 3 Ft. = 1 Inch

Form 1

MT. HOPE CEMETERY, PLOT RECORD

RANGE SECTION } H LOT NO. 23

Shadrick Parsons O

A 71

Sec. G. C.

N.

5'

20'

W

E.

Elizabeth  
Parson 1862

MIEE 2-13-  
PARSONS 1860

Baby  
TAYLOR

Martha Parsons  
3-29-07

ELIZA 1902  
PARSONS

SHADRICK  
PARSONS 1895

Henry W  
Taylor 11-19-24

Head west

S 20

Tree

Pie 7/9/36  
@ 50000

Scale 6 Ft. = 1 Inch

MT. HOPE CEMETERY, PLOT RECORD

RANGE }  
SECTION } H

LOT NO. 24

Form 1

O. D. Hayden<sup>o</sup>

West.  $\frac{1}{2}$

N  
index Schlotzger  
E. G. Schortzel

PERPETUAL CONTRACT East.  $\frac{1}{2}$

Geo. CHAMBERLAIN'S  
CHILD  
7-14-1866

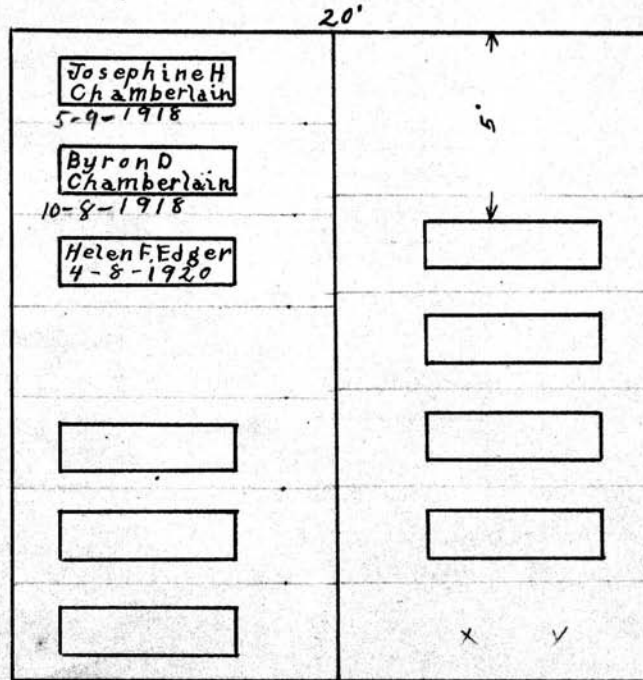

W

E. F. SMITH  
9-12-1854  
35 YRS  
S. D. HAYDEN  
9-1-1863  
42 YRS.  
OLIVE D. HAYDEN  
9-10-1874  
75 YRS  
HAYDEN CHILD  
3 DAYS old  
9-24-1862

E  
Bertha Schlotzger  
9-15-1854  
Barbara Schlotzger  
3-7-1857

S

Scale 5' PL-1 Dist.



MT. HOPE CEMETERY, PLOT RECORD

RANGE SECTION

LOT NO.

25

25

Form 1

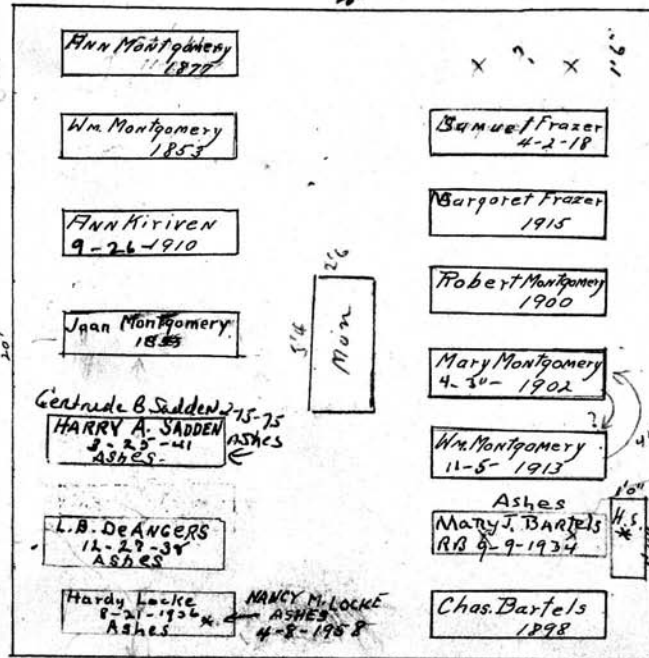

WILLIAM W. FRAZER  
11/8/1873 (BORN)

Additional  
care of 1 for go  
\$300.00  
4/20/51

No H.S.  
on plot  
4/5 marked  
on Mon

PERPETUAL CONTRACT

William Montgomery

F11-25-H

Cremated remains of  
Nan. Montgomery Locke, granddaughter of owner  
are to be interred in grave  
with her husband Hardy Locke  
HARLEY



MT. HOPE CEMETERY, PLOT RECORD

RANGE SECTION

H

000

LOT NO. 26

Form 1

WOLSTEIN-FALING

All

All

N

20'

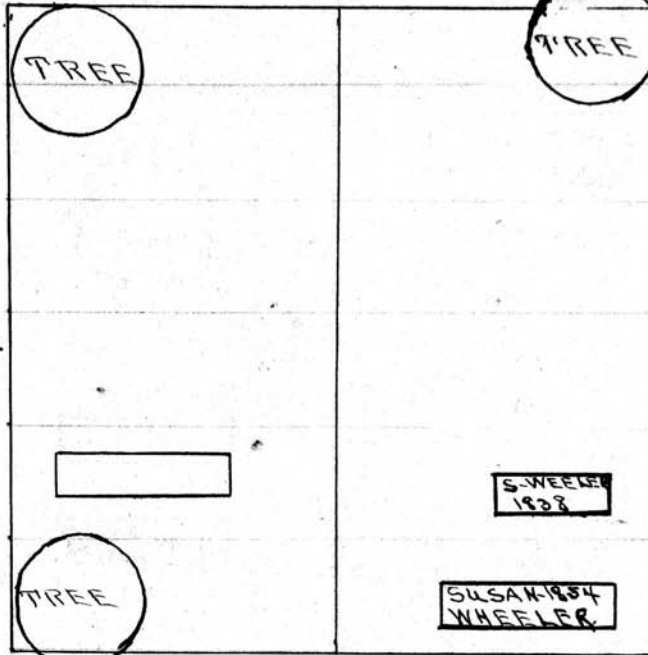

W

20'

20'

E

20'

S

see n 1/2-29A

Scale— 5 Ft.—1 Inch

MT. HOPE CEMETERY, PLOT RECORD

RANGE } SECTION }

H

LOT NO.

27

Form 1

H. Norton Strong

Jacob Garrison

W 1/2

E 1/2

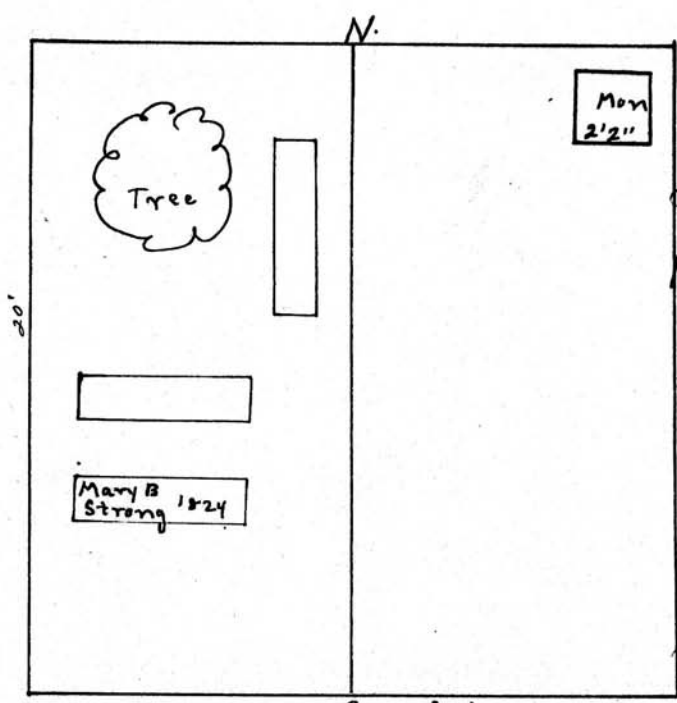

20'

N.

S

20'

Peter S. Garrison 1853  
Wm. Garrison 1857

Mon  
2'2"

Ralph Garrison  
9-25-1863

Leah Garrison  
3-30-1877

Mathew W. Love  
32 yrs. 7-27-1853

Peter S. Garrison  
4-29-1853

Wm. Garrison  
3-5-1857

D. P. Garrison's  
Child  
3-22-1863

David P. Garrison's  
Child  
3-25-1863

Jacob Garrison  
3-20-1873

Scale: 5 Ft. = 1 Inch

**MT. HOPE CEMETERY, PLOT RECORD**

RANGE / SECTION } H LOT NO. 28

Form 1

Chas. Foote<sup>o</sup>

W 1/2

James Brown<sup>o</sup>

E 1/2

N.

Fannie A. Foote 1858	Jane Brown 7-11-16
Erastus Foote 1869	Baby
Harry B. Foote 1873	James 1859 Whitaker
Josephine Foote 1858	James Brown 1876
Ella M. Foote 1855	

H S 20'

Heads West

Anna Foote  
5-5-1862

Ella Foote  
10-2-1861

Baby - James Whitaker  
9-12-1859

John Brown  
12-24-1854

Ann Brown  
12-11-1854

Mary Brown  
8-17-1854

Mary Brown  
7-3-1872

Seabilla Lascaine  
3-17-1874

Fredk Lascaine  
2-26-1876

Scale: 5 Ft. = 1 Inch

**MT. HOPE CEMETERY, PLOT RECORD**

RANGE }  
SECTION } H LOT NO. 29

Form 1

John Hayes<sup>o</sup>

W 1/2

Geo. G. Cooper<sup>o</sup>

E 1/2

Diana Hayes  
6-13-1841  
 Wm. H. Hayes  
6-16-1853  
 Mary E. Hayes  
3-30-1846  
 John Hayes' child  
7-15-1846

Tree

477

N

S

CHARLES F. DAVIS  
10-6-1958

Eveline  
Cooper 1882

Geo. B. Cooper  
1866

James B.  
Cooper  
1866

Shirley  
Cooper  
1864

Theodocia A.  
Cooper 1861

Geo. G.  
Cooper 1890

William H. Hays 1853

20'

Scale: 5 Ft. = 1 Inch

Form 1

MT. HOPE CEMETERY, PLOT RECORD

RANGE SECTION } H LOT NO. 30

Adam Brownell<sup>0</sup> Wm. Scott.<sup>0</sup>

W 1/2 E 1/2

AARON BROWNELL OCT. 12, 1862	[ ]	Julia Scott 1861
ARMENIA BROWNELL MAR. 4, 1870	[ ]	[ ]
EPHRAIM BROWNELL APRIL 25, 1879	[ ]	Mother
ADAM BROWNELL MAR 10, 1896	[ ]	Wm Scott 1855
DEC. 30, 1863	John W. Brownell	Phebe Scott 1852
SARAH A BROWNELL AUG 10, 1870	[ ]	12-15-1896 Jennie M. Scott
Mary Brownell 2-16-1854	Sunkan	4-11-1907 Minnie Scott
	S	201

James Scott 11-20-1923

Abella Scott 3-3-1879  
Wm. Scotts 9-27-1859 Child  
Abella Scott 6-11-1887

LOIS LEE 6/2/1853

Scale: 5 Ft. - 1 Inch





MT. HOPE CEMETERY, PLOT RECORD

RANGE / SECTION

H

LOT NO.

32

Form 1

Maria Green<sup>o</sup>

James James<sup>o</sup>  
PERPETUAL CONTRACT 150<sup>00</sup> for  
P.C. granted 7/9/34

NW 1/4

E 1/2

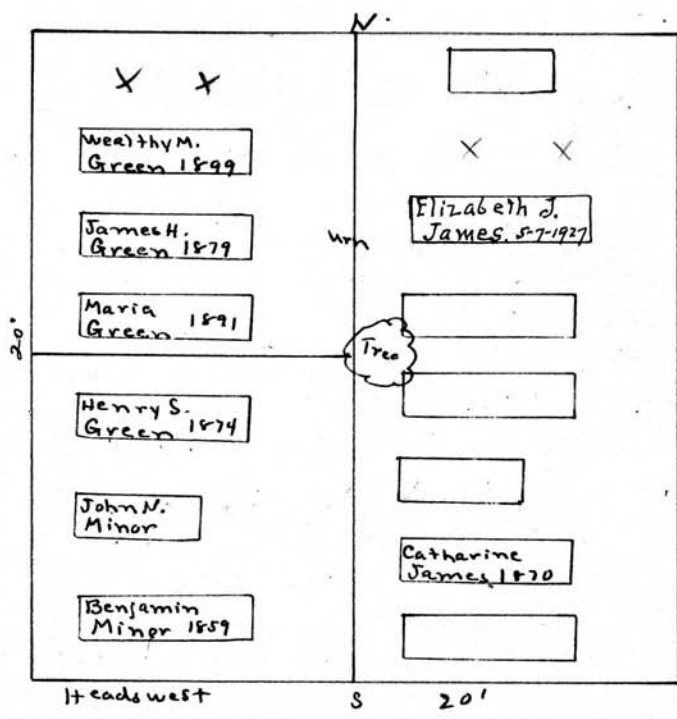

Sarah M. Minor  
7-22-1855

- Mar 9-1853  
Lucy James = 10 Mos
- Oct 30-1870  
Catherine James = 40 yrs
- July 1st 1880  
Wm H. James = 21 yrs 5 Mos
- May 31-1887  
James J. James = No age given
- Aug 22-1893  
Howard J. Meyer = 6 Mos
- Dec 2-1894  
John E. James = 45 Yrs.

Benjamin Minor<sup>o</sup>

SW 1/4

Scale: 5 Ft. = 1 Inch

MT. HOPE CEMETERY, PLOT RECORD

SECTION } H LOT NO. 33

Form 1

N

Dwight Gibbons Julia St Hellens

W 1/2 East 1/2

PERPETUAL CONTRACT

20'

X X

Julia 3-2-14 St Helena 1

Minnie Gibbons 1853

John H. 4-4-22 St. Helena

Tree

Dwight 1874 Gibbons

4-9-1853 Mary Gibbons 1853

Heads west

W E

Jesse St Hellens 8-15-1873

Robt R St. Hellens 11-7-1878

John St. Hellens 3-31-1874

Eliza St. Hellens 2-6-1873

Raymond St. Hellens 10-2-1872

Pe 10-11-1869

Pe 250 9-22-66

Pe #15000 2-1-34

Scale: 5" Ft. - 1 Inch

MT. HOPE CEMETERY, PLOT RECORD

RANGE 1  
SECTION 1

H

LOT NO. 34 - 34 1/2

Form 1

Wm. Cogswell  
W 1/2 34.

Miss  
Louisa Defendorf  
E 1/2 of 34 and 34 1/2

PERPETUAL CONTRACT.

N.

20'

PERPETUAL CONTRACT.

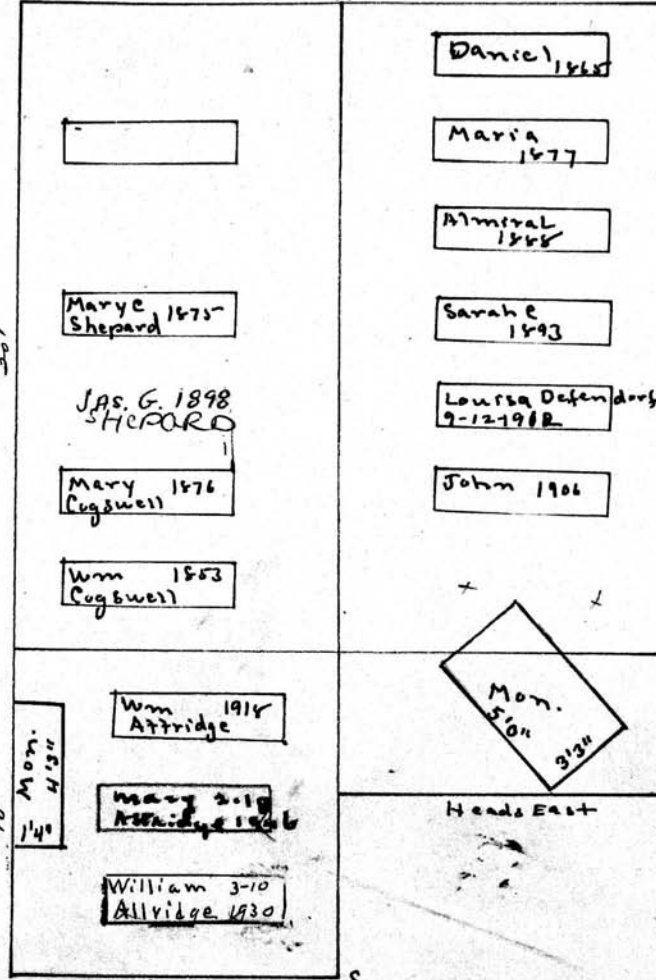

20'

10'

Heads West S.

Heads East

W 1/2 34 1/2

Wm and Mary Attridge

PERPETUAL CONTRACT.

Scale: 1/4" = 1 Inch

**MT. HOPE CEMETERY, PLOT RECORD**

RANGE }  
SECTION } # LOT NO. 57

Form 1

El Nathan Austin<sup>o</sup>      Ann. Drake<sup>o</sup>

W 1/2      E 1/2

10'      N      10'

Level?

Israel 1866  
Chapman

Charity  
Chapman 1863

Israel 1875  
Chapman

Aldin B.  
Drake 1864

S      Heads west

Amanda M.  
Austin  
6-23-1853

Jesse V. Drake  
born 1818  
died 8/5/37  
P.C. 2000

Profile  
in regard to G.C.

Scale: 5 Ft. = 1 Inch



MT. HOPE CEMETERY, PLOT RECORD

RANGE } SECTION }

H.

LOT NO.

36

Form 1

John Langham<sup>o</sup>

Ira Beagle<sup>o</sup>

W 1/2

E 1/2

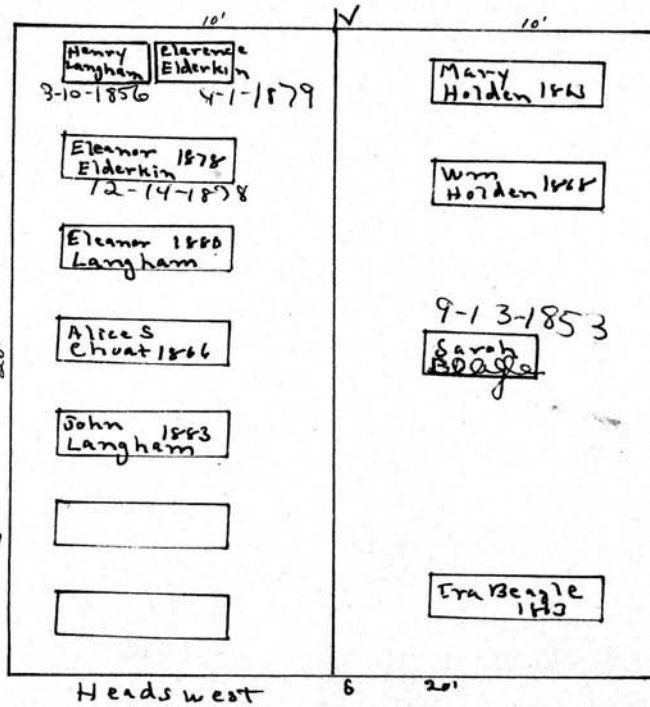

*Ellen Langham  
12-25-1853  
Elyza Langham  
12-5-1859*

Scale: 5 Ft. = 1 Inch

MT. HOPE CEMETERY, PLOT RECORD

RANGE }  
SECTION }

H

LOT NO.

37

Form 1

Wm H. Gibson<sup>o</sup>      Eva West<sup>o</sup>  
W 1/2                      E 1/2

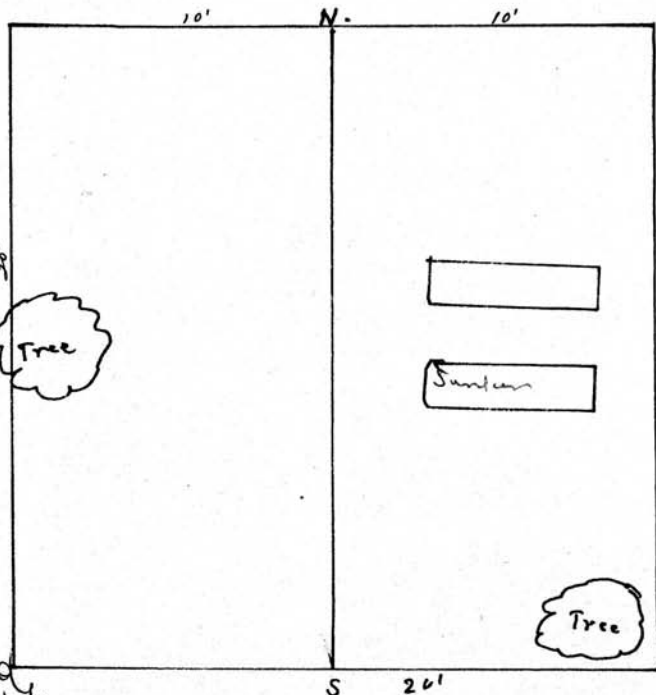

baby- Andrew H. Gibson  
 baby- Harriet H. Gibson  
 Harriet A. Gibson  
 3-28-1863  
 8-5-1856  
 12-1-1860  
 1860

Eva West  
 4-28-1854

Scale: 5 Ft. = 1 Inch

**MT. HOPE CEMETERY, PLOT RECORD**

RANGE SECTION } H LOT NO. 38

Form 1

Elias D. Shelmire<sup>o</sup>      Norman Barnes<sup>o</sup>

W 1/2      E 1/2      Sec. G. C.

10'      N      10'

<p>+      +</p> <p style="text-align: center;">Tree</p> <p style="border: 1px solid black; padding: 2px;">Grover 1870 Shelmire</p> <p style="border: 1px solid black; padding: 2px;">M. OLIVIA BRADMAN</p> <p style="margin-left: 100px;">5-19 1902</p> <p style="border: 1px solid black; padding: 2px;">J. H. 1853 Shelmire</p> <p style="border: 1px solid black; padding: 2px;">Maria 1865 Shelmire</p> <p style="border: 1px solid black; padding: 2px;">Elias D. 1859 Shelmire</p> <p style="text-align: center;">Heads west</p>	<p>x      x</p> <p style="border: 1px solid black; padding: 2px;">Alfred Barnes</p> <p style="border: 1px solid black; padding: 2px;">Kittie B.W. Barnes 1873</p> <p style="border: 1px solid black; padding: 2px;">Laura 1876 Hubbell</p> <p style="border: 1px solid black; padding: 2px;">Chas. W. Barnes 10-2-1911</p>
--	--

20'

*George Barnes  
8-27-1864*

Scale: 6 Ft. = 1 Inch

MT. HOPE CEMETERY, PLOT RECORD

RANGE }  
SECTION }

H.

LOT NO.

39

Form 1

Andrew Love

PERPETUAL CONTRACT.

A 71

N

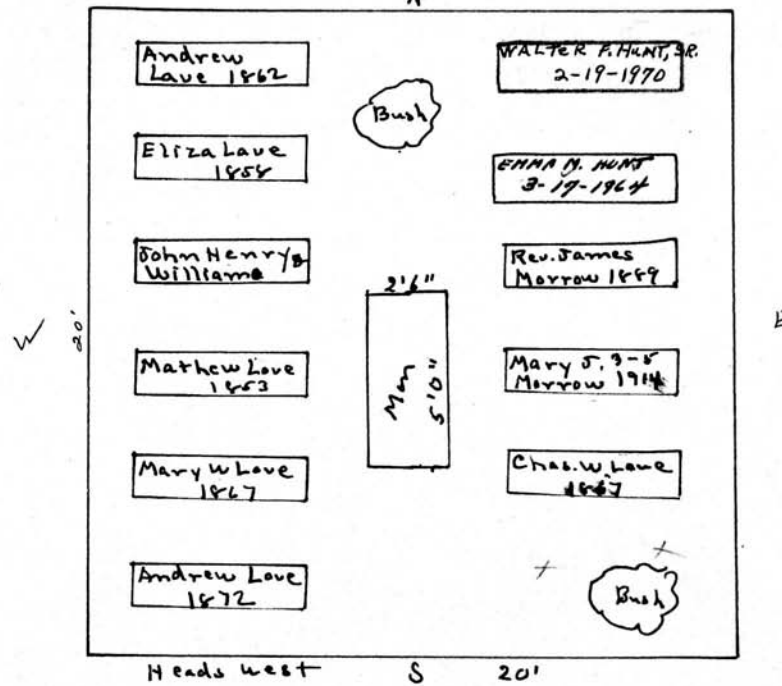

Scale: 5 Ft. = 1 Inch

MT. HOPE CEMETERY, PLOT RECORD

RANGE SECTION

H

LOT NO.

40

Form 1

Spencer Ainsworth<sup>0</sup>  
West 1/2

See p. c

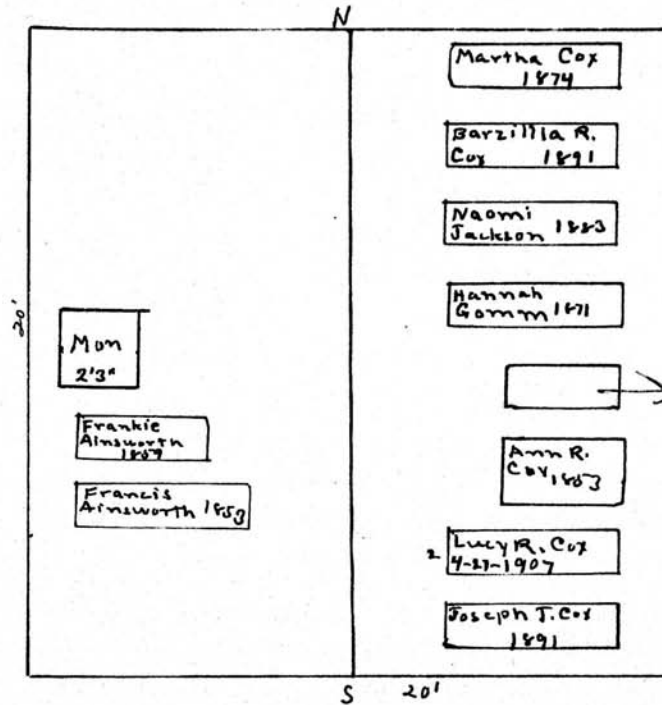

Joseph T. Cox<sup>0 5 yrs</sup>  
East 1/2

Scale 5 Ft. = 1 Inch



MT. HOPE CEMETERY, PLOT RECORD

RANGE }  
SECTION }

H

LOT NO.

41

Form 1

Sam. H. and Edith Linn.

A 11

N.

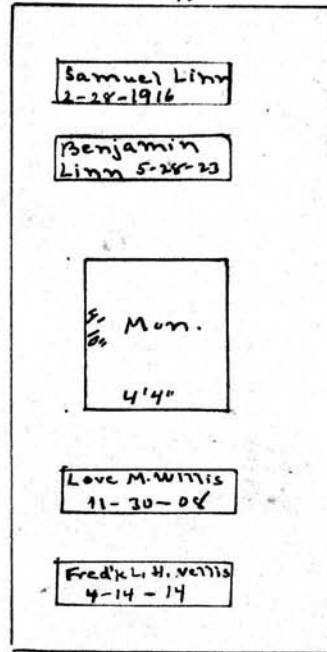

pe  
10/19/48  
\$ 200.00

E  
20'

Head west 8 10'

Scale— 5 Ft.—1 inch

MT. HOPE CEMETERY, PLOT RECORD

RANGE 1  
SECTION 4

LOT NO. 42-43

Form 1

Joseph Cowles.  
A11

Sec. B. C.

Tho Cowles Child  
 9-16-1848  
 Thomas Cowles 12/29/1848  
 Mary Cowles 4-25-1852  
 Ether Cowles 6-4-1860  
 John Cowles 5-1-1888  
 Jesse Cowles 1-3-1884

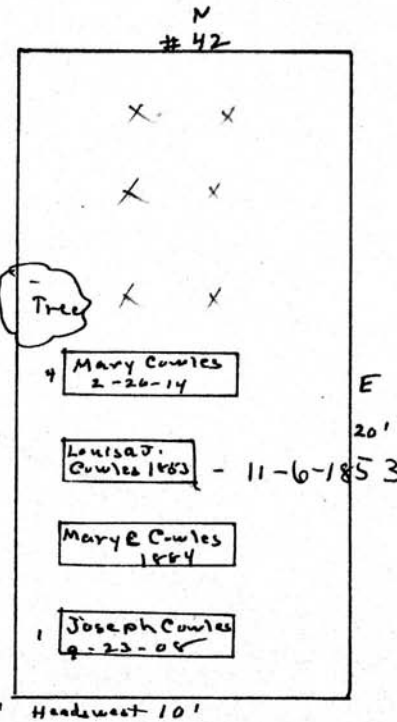
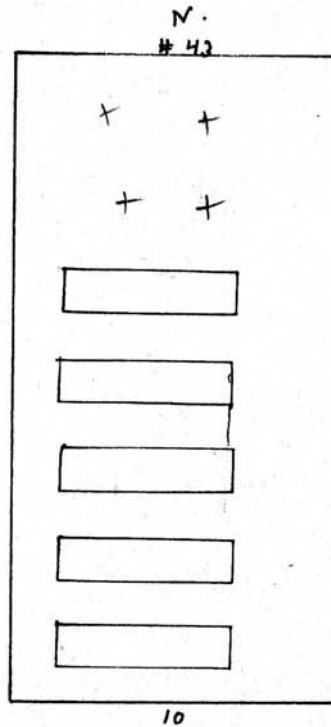

Scale 5 Ft. - 1 Inch

MT. HOPE CEMETERY, PLOT RECORD

RANGE SECTION

H

LOT NO.

44

Form 1

James  
John Craib. 0

A77

N

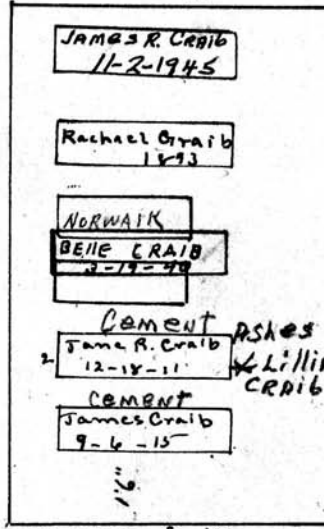

E  
181

Headwest 8 101

Charles Craib  
7-2-1862  
Susan Craib  
5-14-1864

CEMENT ASHES  
James R. Craib  
12-18-11  
Lillian  
Craib 5-9-52

Scale: 0 Ft. = 1 Inch

MT. HOPE CEMETERY, PLOT RECORD

RANGE SECTION

H

LOT NO.

45 & 45 1/2

Form 1

Elizabeth P. Gorton

A 11

See G.C.

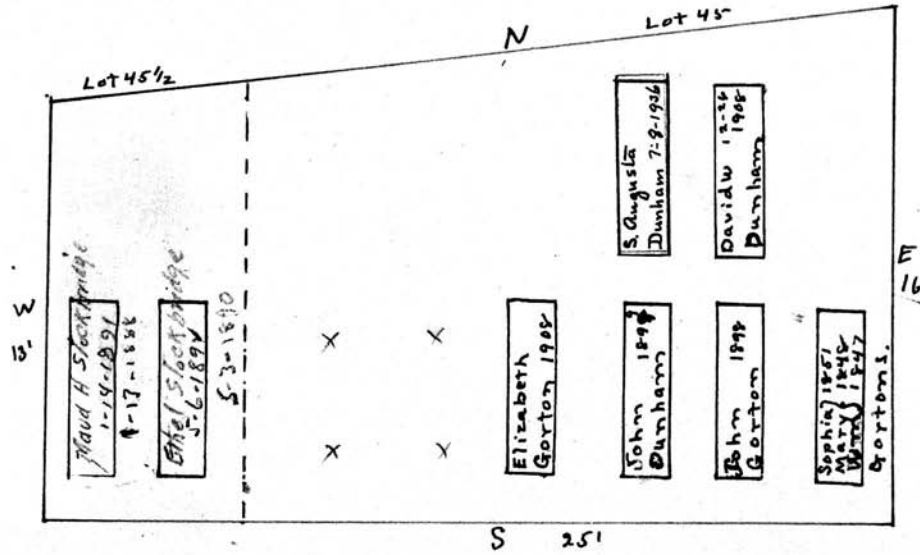

Scale: 5 Ft. = 1 Inch

MT. HOPE CEMETERY, PLOT RECORD

RANGE SECTION

H

LOT NO.

46

Form 1

Edward J Green <sup>0</sup>

A11

W 11

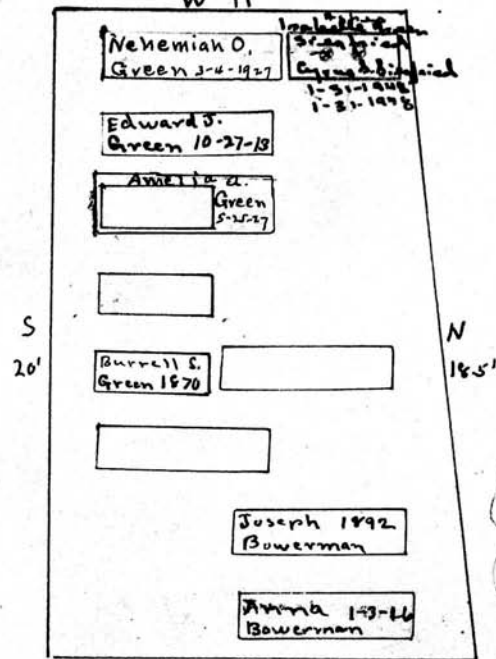

S 20'

N 18\''

E 13

Heads South

*Jacob Rumber*  
*3-25-1864*  
*Frank B. Green*  
*8-30-1876*

Scale: 5 Ft. = 1 Inch



**MT. HOPE CEMETERY, PLOT RECORD**

RANGE }  
SECTION } H LOT NO. 47

Form 1

T. B. Forsyth<sup>o</sup>  
W 1/2

Charles Briggs<sup>o</sup>  
NE Pt.

TRUST DEED

N

Elizabeth H. Bemish	
	Charles H. Briggs 1878
	Frances M. Briggs 1904
	Florence M. Briggs 1878
Mon 2'2"	X X
Lucretia Forsyth 1884	Lunta
Lucretia Forsyth 1882	Henry D. Taft
Thomas B. Forsyth 1854	Myra Taft 4-29-25

S 20'

E 25'

Heads west

PERPETUAL CONTRACT.  
on S.W. 1/4

Myra Taft.  
S pt of E 1/2

Scale: 6 FT = 1 Inch

MT. HOPE CEMETERY, PLOT RECORD

RANGE / SECTION

H.

LOT NO.

48

Form 1

Eliza Nelson

W 1/2

Charles Clark

E 1/2

10' N

10'

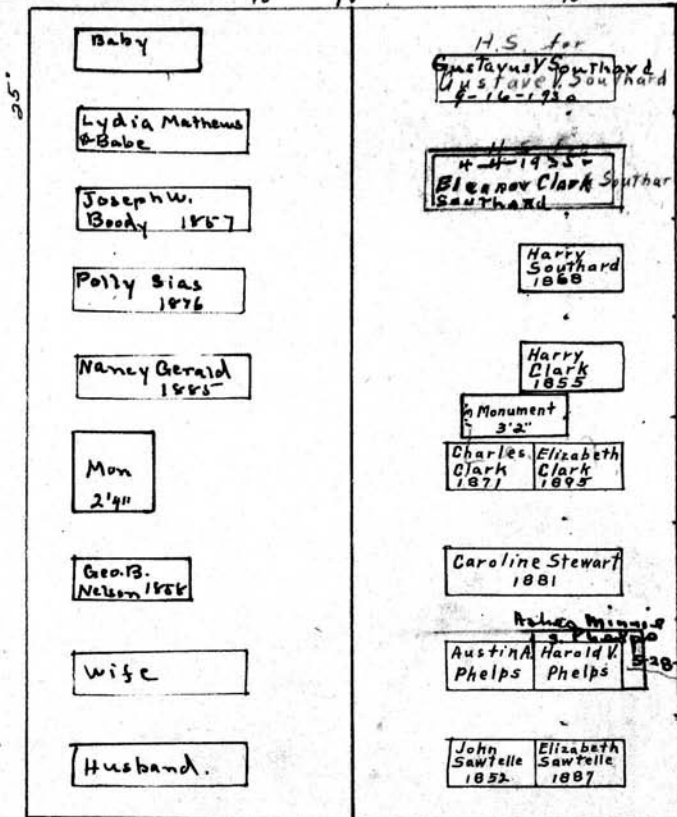

Sawtelle  
 John Eliza  
 1852 1887  
 Austin A.  
 Harold V.  
 Phelps.  
 Caroline P. Stewart  
 1828 - 1881  
 Clark  
 Charles Elizabeth  
 1871 1895  
 Baby  
 Harry Clark  
 1865  
 Baby  
 Harry Southard  
 1868  
 Heads East  
 1872-38  
 WBM old right  
 burial place  
 Minnie Phelps  
 niece of Char  
 Clark

Jonathan Nelson 1867  
 Eliza Nelson 1867  
 Heads west

Heads East

Scale 0 Ft. - 1 Inch

MT. HOPE CEMETERY, PLOT RECORD

RANGE SECTION

H

LOT NO.

49

Form 1

Alfred Benedict<sup>o</sup>  
150.00 for PC  
graves 7/24/24 W 1/2

Frisch and Hoffman<sup>o</sup>  
E 1/2

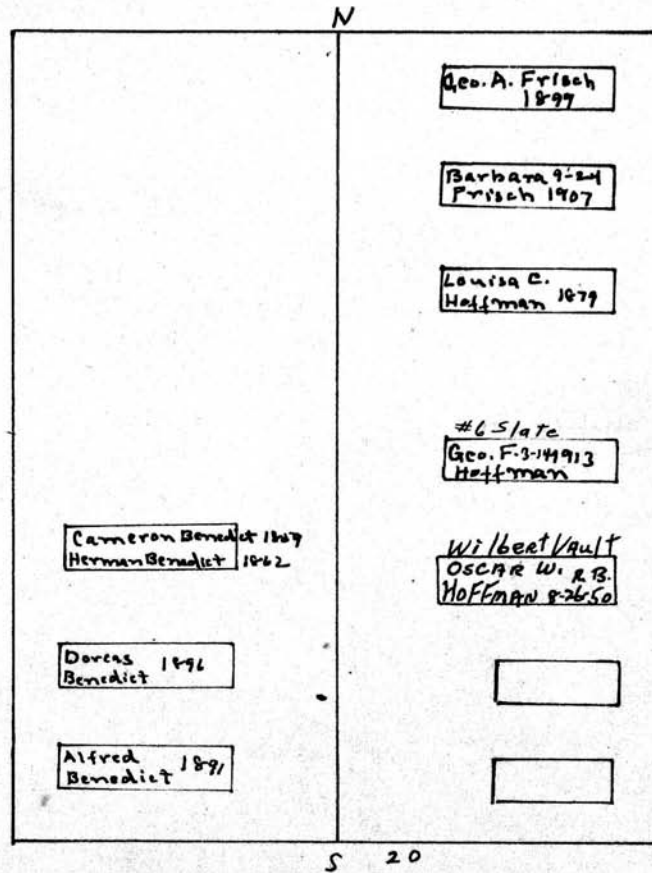

See page

4400?  
14. do?  
E 21-  
Ellen C. Gray  
1885  
10-13-1885  
1885

Scale: 6 Ft. = 1 Inch

MT. HOPE CEMETERY, PLOT RECORD

RANGE }  
SECTION }

H

LOT NO.

50

Form 1

Anne Woodbury  
PERPETUAL CONTRACT.  
NW 1/4

Simon Smith<sup>o</sup>  
E 1/2

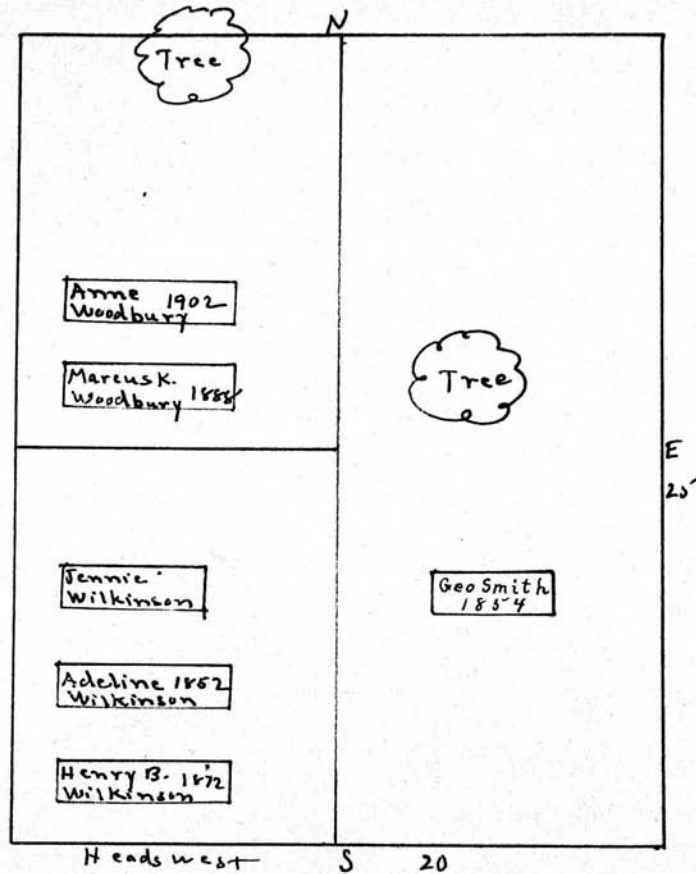

Henry B. Wilkinson<sup>o</sup>

SW 1/4

Scale: 3" = 1 foot

MT. HOPE CEMETERY, PLOT RECORD

RANGE }  
SECTION }

H

LOT NO.

51

Form 1

Peter H. Clute  
PERPETUAL CONTRACT,  
W 1/2

Joseph W. Pierce  
E 1/2

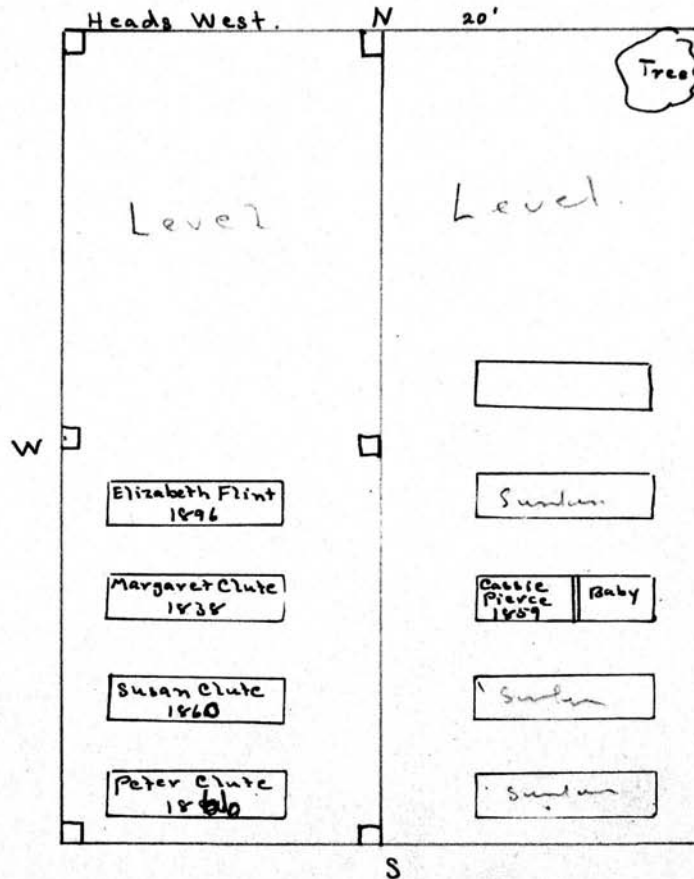

*William Pierce  
4-12-1892  
Baby Wm. Pierce  
7-28-1855  
Joseph W. Pierce  
8-19-1879  
Rachel E. Pierce  
1-2-1880*

Scale: 5 Ft. = 1 Inch



Form 1

MT. HOPE CEMETERY, PLOT RECORD

RANGE SECTION H LOT NO. 52.

~~Elizabeth Sarah Allgood~~ Sarah Fenner<sup>o</sup>

Salvation Army W. Pt. E. Pt.

N

W

E 25'

S 20'

Tree

All Level

Old Mound

Tree

Caleb Fenner  
8-31-1860

Sarah Fenner  
11-2-1867

Scale: 1/4" = 1 foot

MT. HOPE CEMETERY, PLOT RECORD

RANGE SECTION

H

LOT NO.

53

Form 1

Alonzo Payne - John Miller<sup>o</sup>  
PERPETUAL CONTRACT

W 1/2

E 1/2

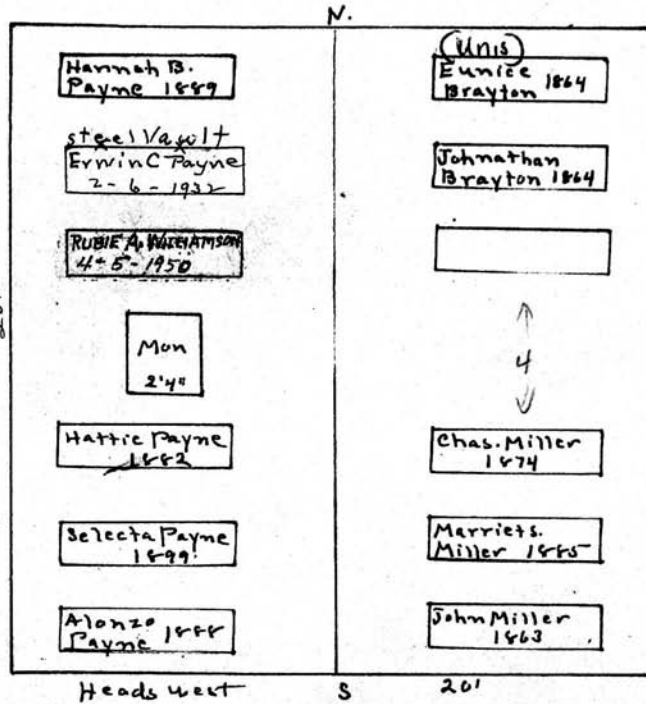

*No more room on lot*

Scale— 6" = 1" Inch

MT. HOPE CEMETERY, PLOT RECORD

RANGE }  
SECTION }

H

LOT NO.

54

Form 1

PERPETUAL CONTRACT Pd. 5/9/85 Jno 112

G. & J. Boulton<sup>0</sup>

Mary S Lee<sup>0</sup>

PE 12500  
1-13-59

N.W. 1/4

N.E. 1/4

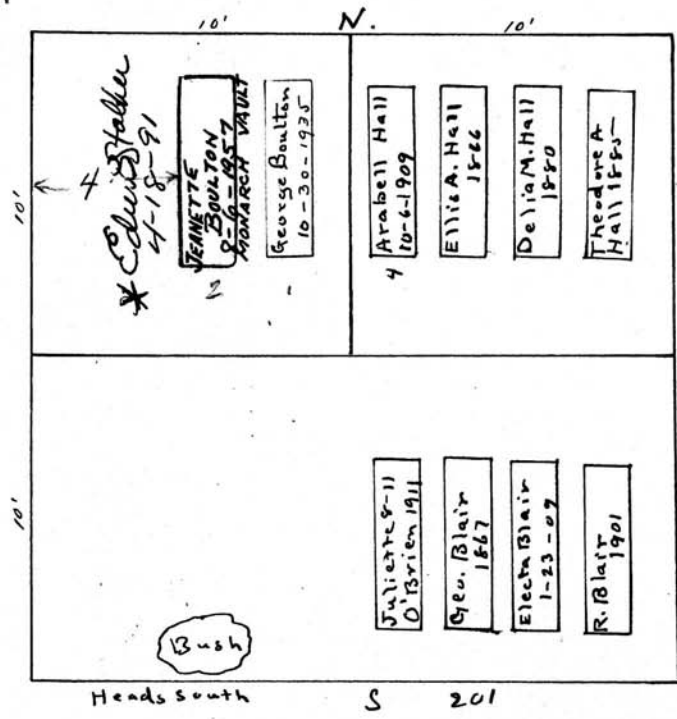

Bush

Heds south

S 201

Robert Blair<sup>0</sup>

S 1/2

Scale - 5 Ft. - 1 Inch

MT. HOPE CEMETERY, PLOT RECORD

RANGE SECTION

H

LOT NO.

55

Form 1

Christian H. and  
Fredericka Hummel

~~Chas. H. Yost~~

PERPETUAL CONTRACT

W 1/2

(has after the d. according to Will & residuary)  
Friederick Schelker

PERPETUAL CONTRACT

E 1/2

pe 250.00  
7-27-57

pe  
250.00  
125/52

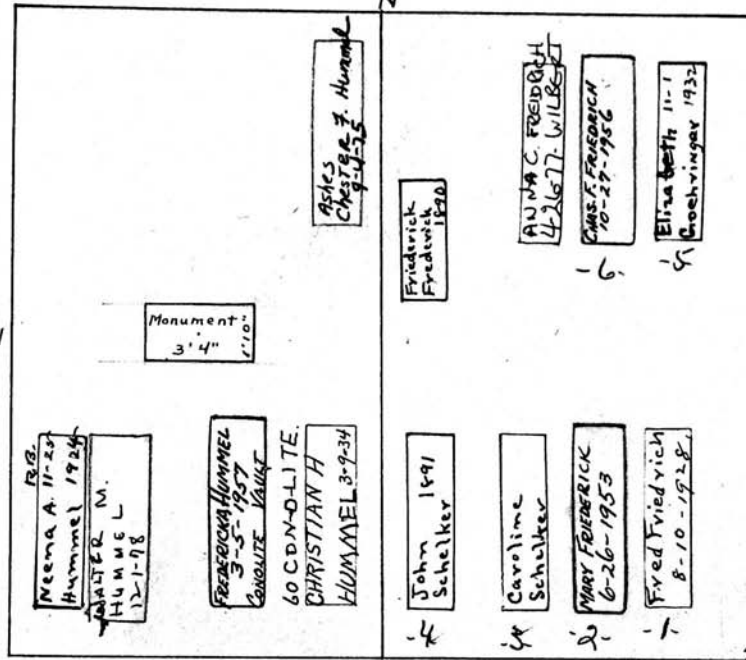

S 23'  
Heads South

E 19'

Scale: 5 Ft. = 1 Inch

MT. HOPE CEMETERY, PLOT RECORD

RANGE 1  
SECTION 1

#

LOT NO.

56

Form 1

Elon Galusha<sup>o</sup>

All

See G.C.

N

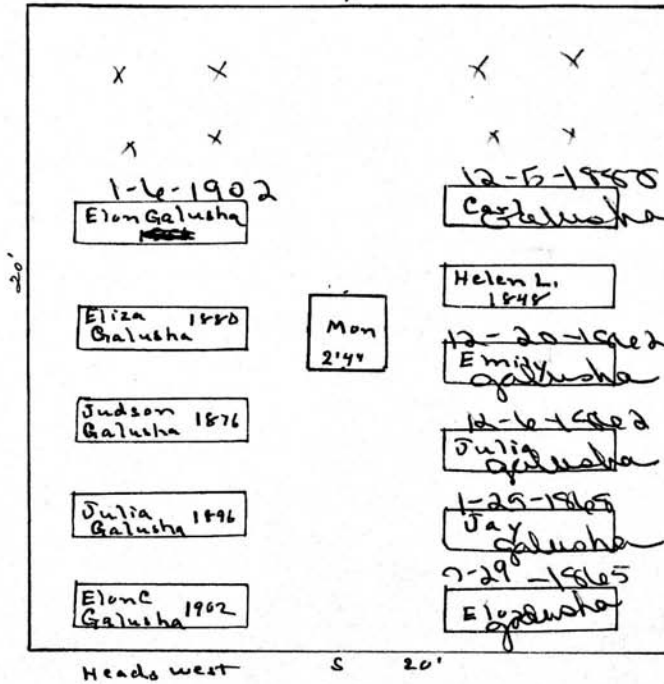



MT. HOPE CEMETERY, PLOT RECORD

RANGE } SECTION }

H

LOT NO.

57

Form 1

Mary Young<sup>o</sup>

Cornelia Faas<sup>o</sup>

W 1/2

E 1/2

See G.C.

George Young  
5-21-1904  
his young child  
6-26-1881

Boro Nelson Young  
11-23-1883

James K. Young  
12-16-1882

Mary E. Young  
4-8-1901

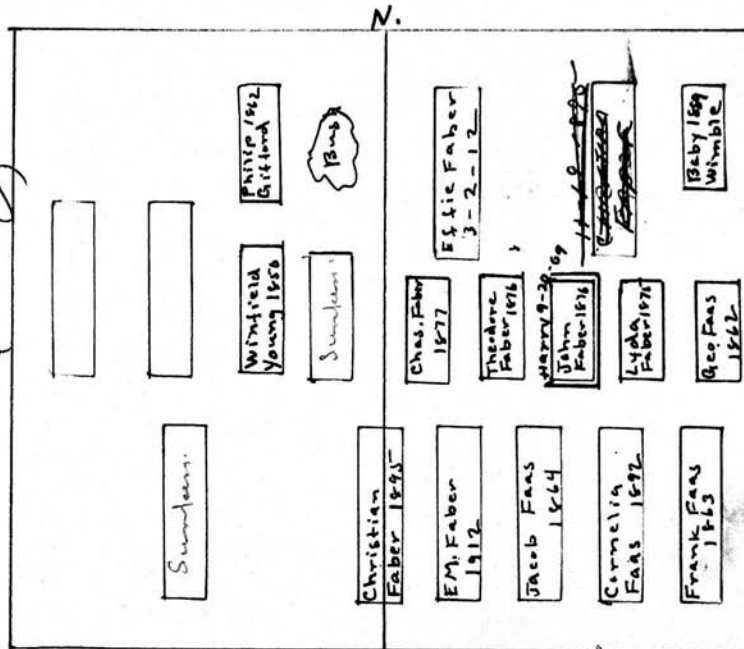

Heads South

S

19'

8-21-1908  
Baby faber 16-2-1904  
Harry faber baby  
9-20-1909

Scale: 6 Ft. - 1 Inch

MT. HOPE CEMETERY, PLOT RECORD

RANGE }  
SECTION }

H

LOT NO.

58

Form 1

Erastus W. Sabin

PERPETUAL CONTRACT.

All

N.

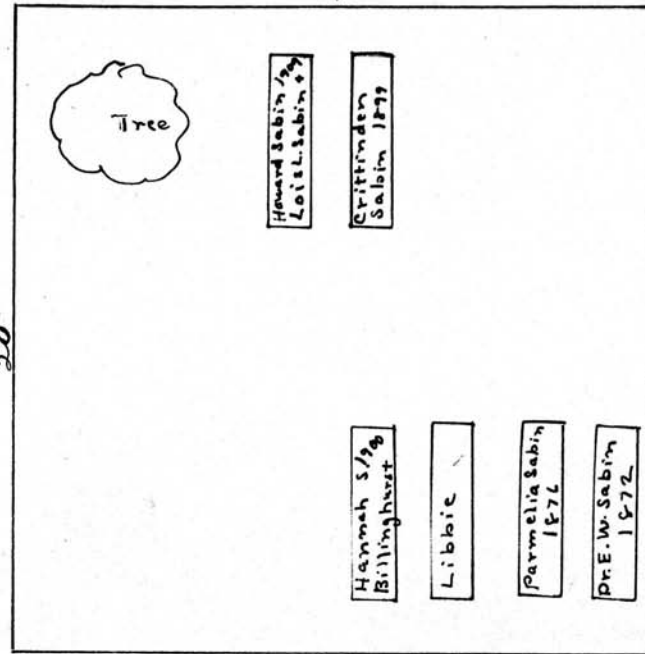

*Susan Sabin*  
6/26/1887

20'

S 20'

Scale: 6 Ft. — 1 Inch

MT. HOPE CEMETERY, PLOT RECORD

RANGE SECTION

H 59

LOT NO.

H. 59

Form 1

Geo. Twist

PERPETUAL CONTRACT

All.

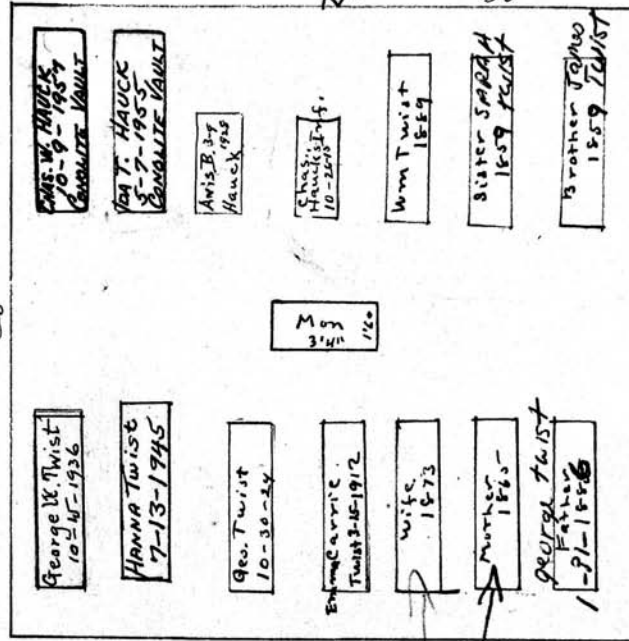

50000 pc  
6-6-55  
Will 25000 will  
as paid & add.  
to come later.

George Twist 1851  
Hattie Twist 1873  
Caroline Twist 1873  
Baby Charles Twist 1871

Scale - 1/2" = 1 foot

MT. HOPE CEMETERY, PLOT RECORD

RANGE }  
SECTION }

#

LOT NO.

60

Form 1

James Baker <sup>0</sup>

All

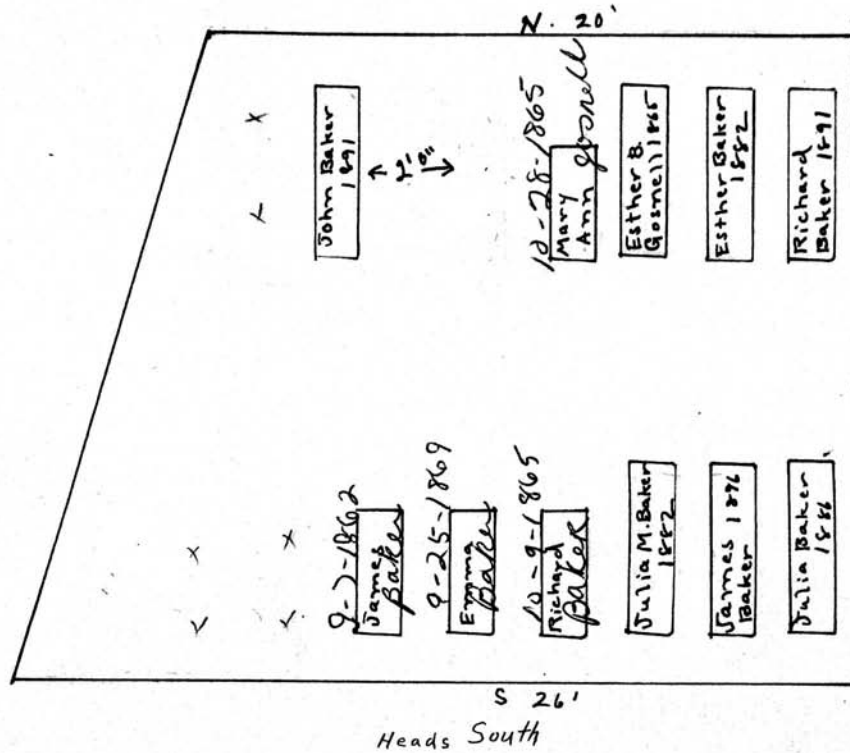

1-10-1887  
Mary Goodwin  
95 yrs

E  
20'

Scale - 8 - Pt. - 1 Inch

MT. HOPE CEMETERY, PLOT RECORD

RANGE SECTION

H

LOT NO. 61

Form 1

*baby Thos. Baker 12/5/1862 N*

*See GC*

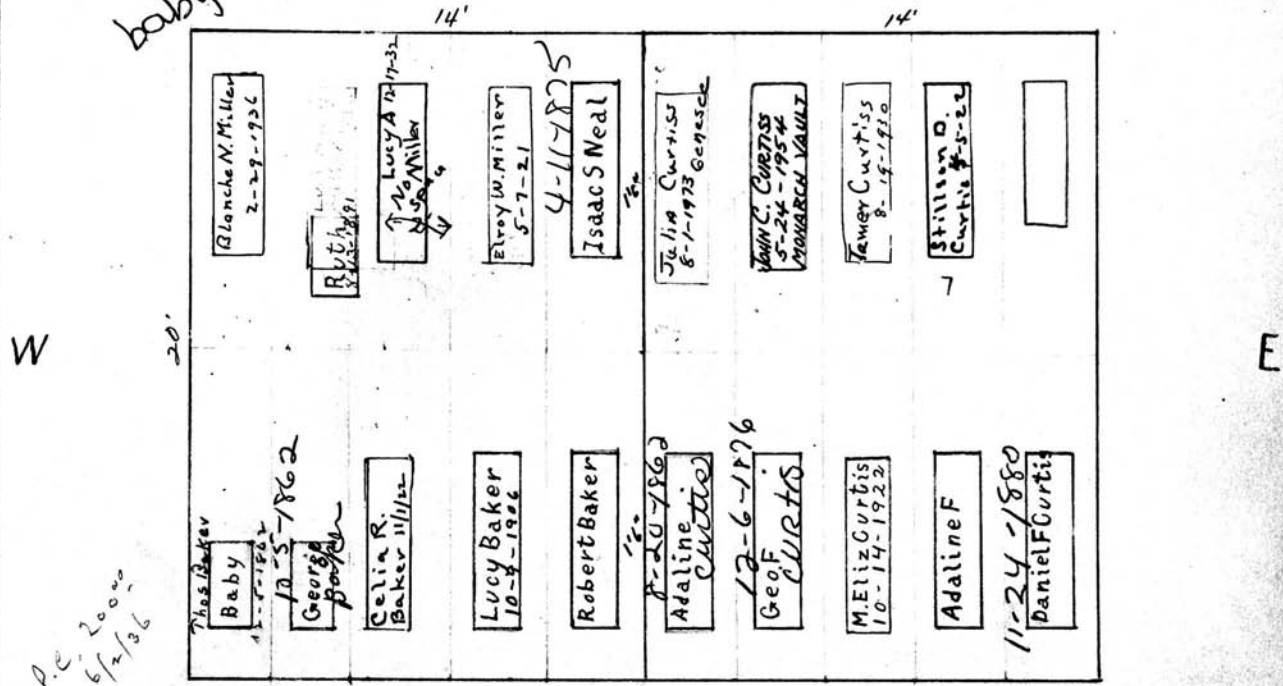

*P.C. 2000  
6/2/36*

*Robert Baker*  
West  $\frac{1}{2}$

*Daniel F Curtis*  
East  $\frac{1}{2}$

PERPETUAL CONTRACT

*S*

Scale— 5" Ft.—1 Inch.



MT. HOPE CEMETERY, PLOT RECORD

RANGE SECTION

H

LOT NO.

62

Form 1

Wm. Kennedy  
A17

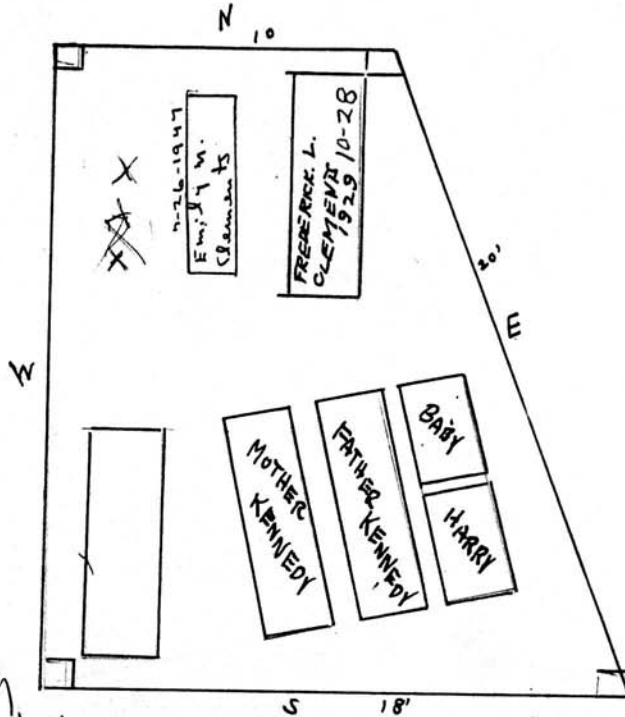

200<sup>00</sup>  
P.C.  
4/22/48

*Wm. Kennedy  
6-1-1869  
Emily W. Kennedy  
3-1-1885  
J. J. Kennedy  
1-1-1885*

Scale 5 ft. = 1 inch

MT. HOPE CEMETERY, PLOT RECORD

RANGE }  
SECTION }

H

LOT NO.

63

Form 1

Martin W. Cooke

PERPETUAL CONTRACT.

N 1/2

N.

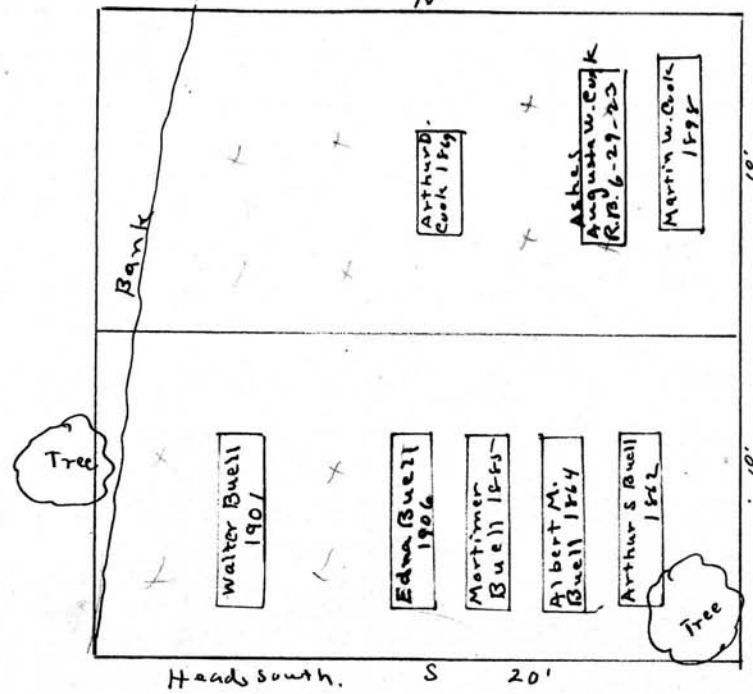

Mortimer Buell  
PERPETUAL CONTRACT.

S 1/2

Scale— 6 Ft.—1 Inch

MT. HOPE CEMETERY, PLOT RECORD

RANGE }  
SECTION }

H

LOT NO. 64-64 1/2

Form 1

McNamee Loose Leaf Binder Co., Baltimore, Md. X-18978

Almirin Joslyn

PERPETUAL CONTRACT.

All

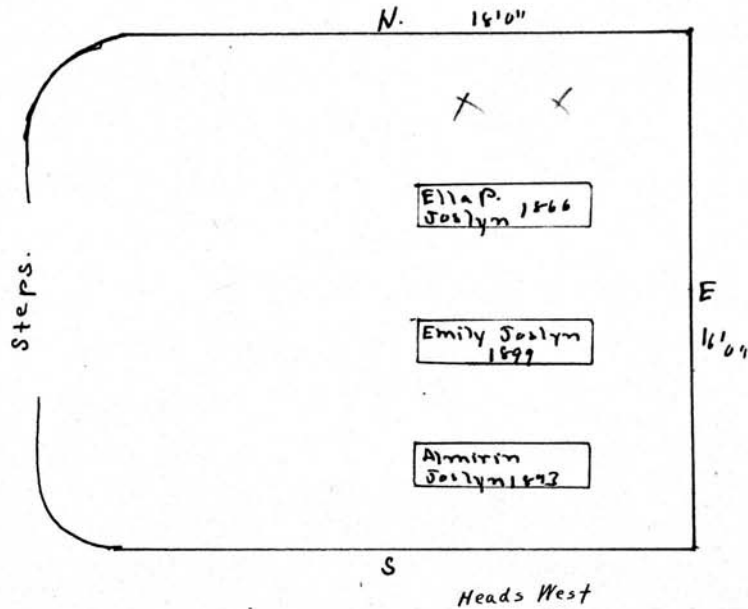

Scale: 5 Fe.—1 Inch

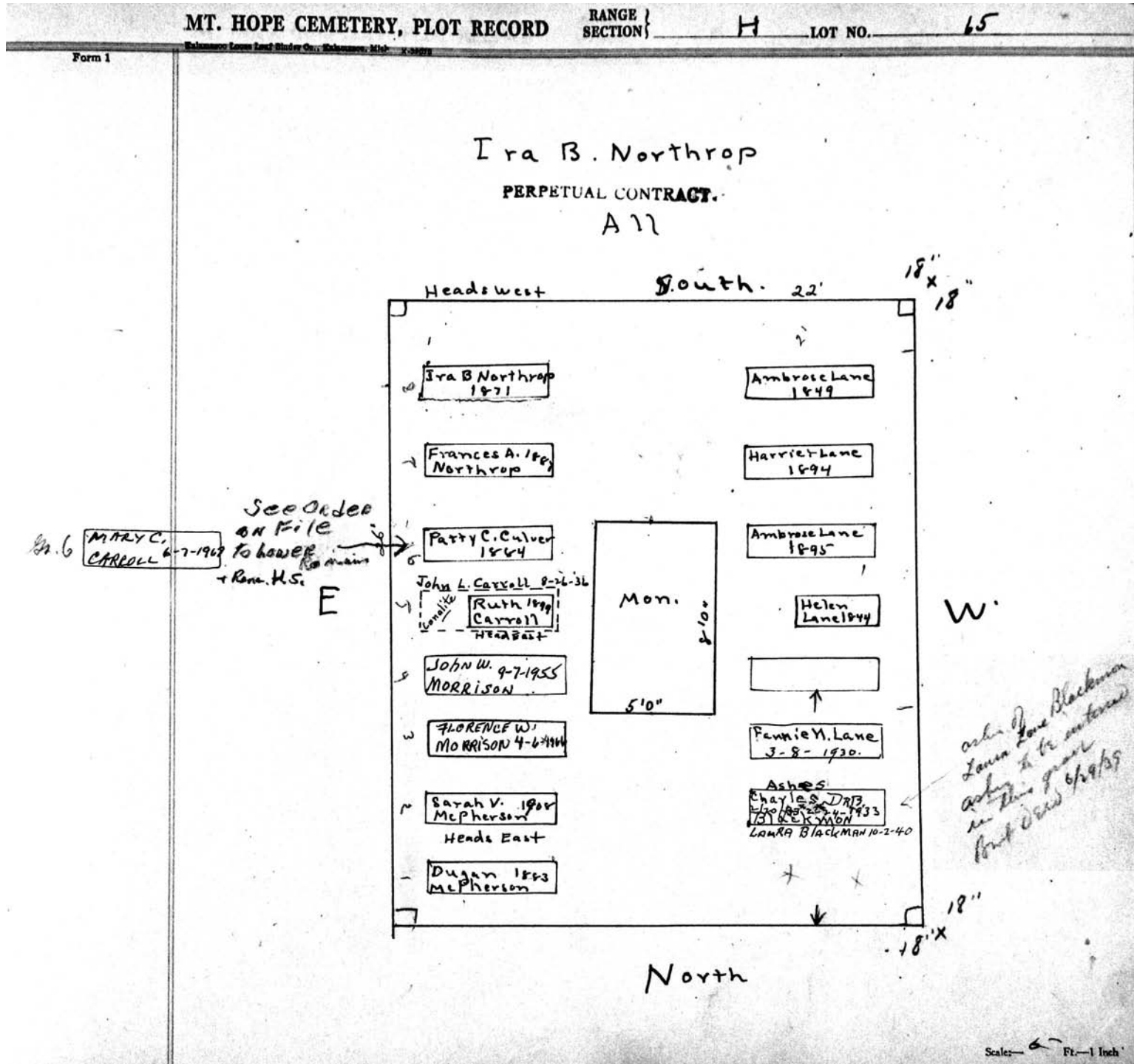

MT. HOPE CEMETERY, PLOT RECORD

SECTION

H

LOT NO.

66

Form 1

Alexander Scott  
West 1/2

Charles T. Brower  
East 1/2

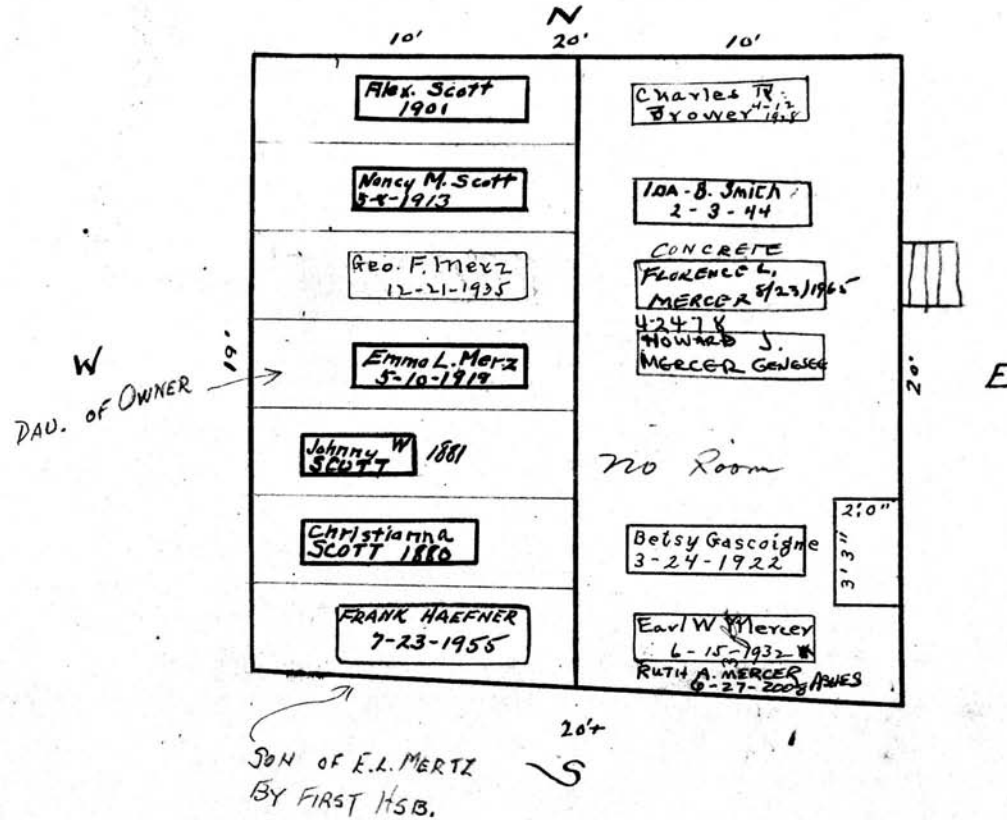



**MT. HOPE CEMETERY, PLOT RECORD**      RANGE } SECTION }      H      LOT NO.      67

Form 1

Henry Eilingen

W. and NE. pts.

N 76'

CORA WAGNER 3-17-1957	Peter Weirich 1913 Louise 1887
FRED P. WAGNER 12-28-1953	Caroline Weirich 1899 Mary J. Eilingen 2-7-12 Anna Weirich 1917
Mother	FREDERICK L. KRONSBELN-10-24-34 Mary Louise Kronsbein 8-2-29
Father	Frederick W. Kronsbein 3-29-29

Head West 16'

17' W      16' E

These 2 Graves reserved for Fred. P. and Cora Wagner (His Wife) of Henry Eilingen 1/9/39  
Deed Lost

Mary Eilingen 2-22-1899  
Henry Eilingen 2-4-1872  
Baby Albert Eilingen 8-23-1863

MARY EILINGER 14 ROL 811/1865  
MARY EILINGER 20 MOS OLD 101/1870

see page

SE Pt 100<sup>00</sup>  
7/14/41

Frederick Kronsbein

SE Pt

Scale - 5 Feet

MT. HOPE CEMETERY, PLOT RECORD

RANGE } SECTION }

H

LOT NO.

68

Form 1

Frank Ellinwood

PERPETUAL CONTRACT

A 11

N.

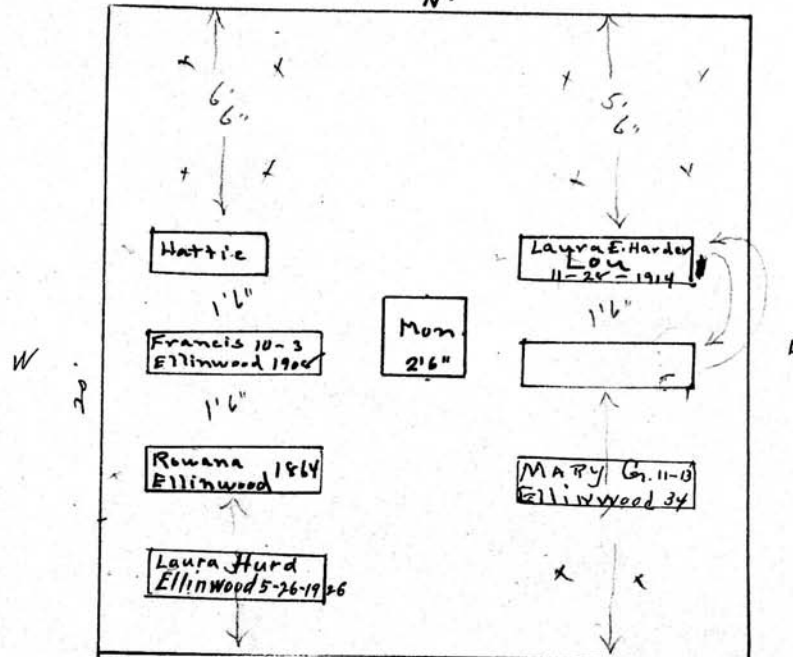

Harriet H. Ellinwood 1857  
 Frank " 1905  
 Lucy G " 1903  
 Laura H Hardie 1914  
 Heads west

S.

P.E.  
250.00  
6-4-25

Scale: 6 Ft. = 1 Inch

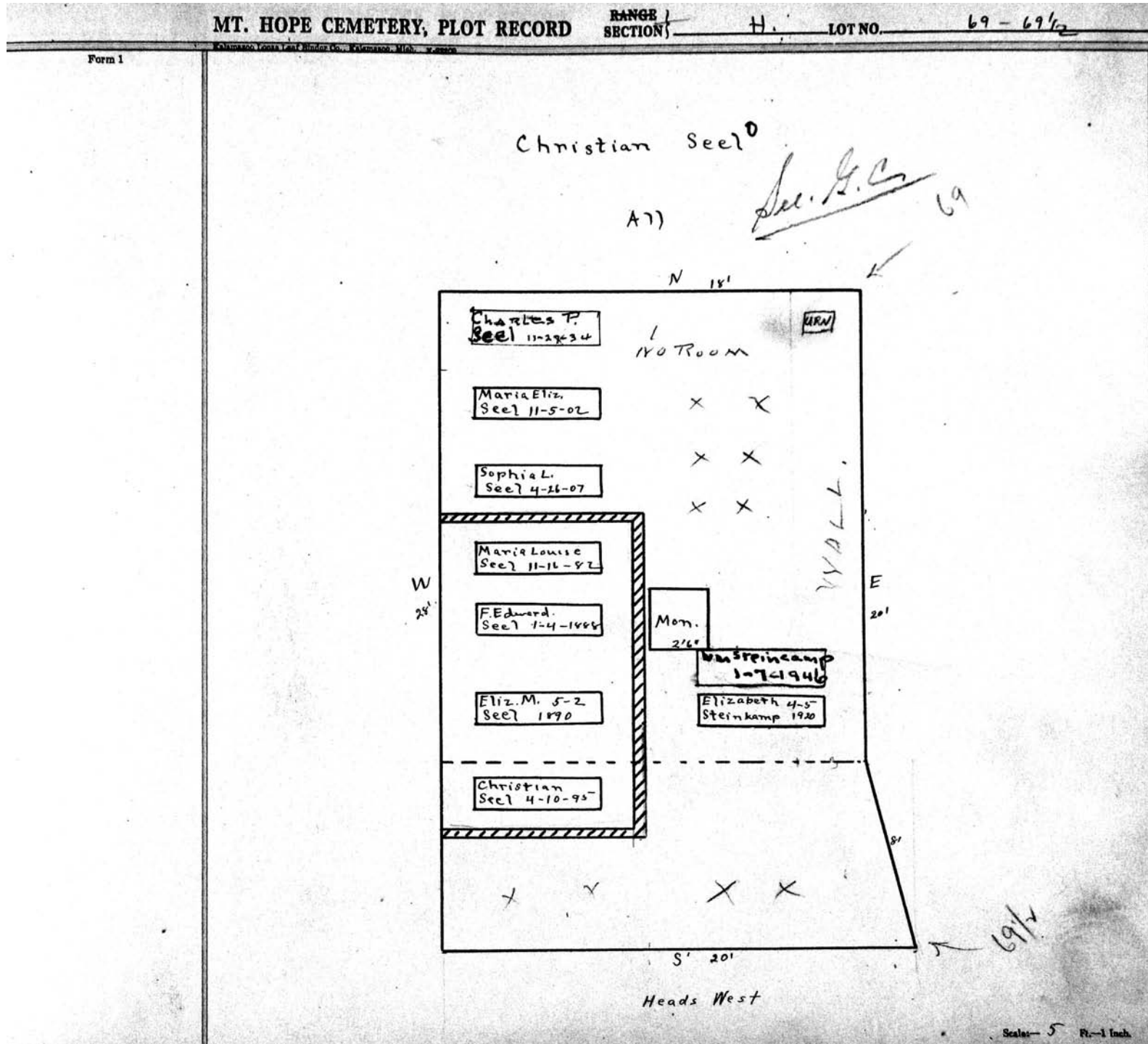

**MT. HOPE CEMETERY, PLOT RECORD**

RANGE }  
SECTION } H LOT NO. 70

Form 1

Lucy McCoy  
A12

E.

Charles M E Coy 2-9-1927	Scharbs Stone 1865
WILLIAM H. McCoy. 9-9-39	
	Lucy S. McCoy 6-8-1907
	Chas. B. McCoy 1893
	Cordelia A. McCoy 2-5-1907

W 20' Head South

baby - Lucy E. McCoy  
3/9/1878  
 Wm. J. Stone  
1-12-1874  
 Lillie J. Stone  
1-15-1874  
 Cora A. Stone  
1-12-1874

Abigail McCoy  
12-28-1896  
 S  
20'  
Lucy McCoy  
4/5/1899  
 Cornelia McCoy  
3-3-1881

Scale - 5 Ft. - 1 Inch

Form 1

MT. HOPE CEMETERY, PLOT RECORD

RANGE } SECTION } H. LOT NO. 71

Mary Van Zandt

N.

owner  
Henry D. Stockbridge w/2<sup>nd</sup>

A77 Level

John Gorton Jr. owner: 1/2 E-2

S 20'

Ethel Stockbridge  
s: -6-1892

Maud Stockbridge  
1-14-1891

Scale: 5 Ft. = 1 Inch



MT. HOPE CEMETERY, PLOT RECORD

RANGE }  
SECTION }

H

LOT NO.

72

Form 1

Richard Ewart<sup>o</sup>

A 71

N. 20'

JULIA E. EWART  
5/12/1881

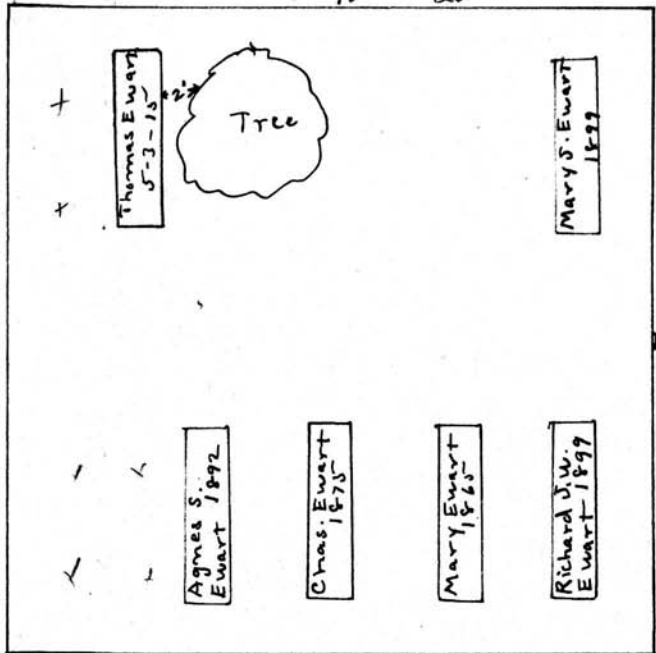

E  
20'

S' Heads South

Scale: 6 Ft. = 1 Inch

MT. HOPE CEMETERY, PLOT RECORD

RANGE }  
SECTION }

H

LOT NO.

73.

Form 1

Kalamazoo Loose Leaf Binder Co., Kalamazoo, Mich. X-22070

John P. and Mrs N. H. Kelley <sup>o</sup>

A 21

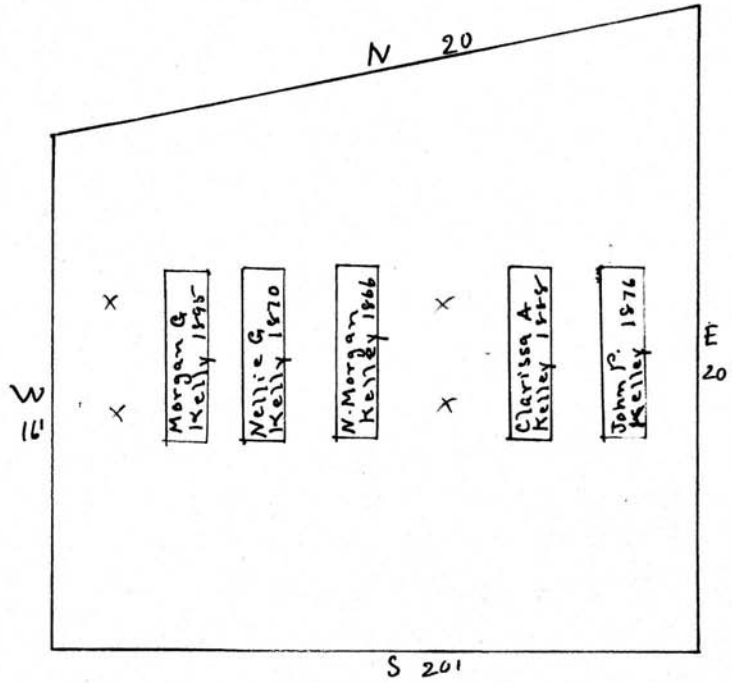

Scale: Ft.—1 Inch

MT. HOPE CEMETERY, PLOT RECORD

RANGE }  
SECTION }

H

LOT NO.

74

Form 1

Kalamazoo Loose Leaf Binder Co., Kalamazoo, Mich. K-2077

Ed Ellsworth  
PERPETUAL CONTRACT.

N 1/2

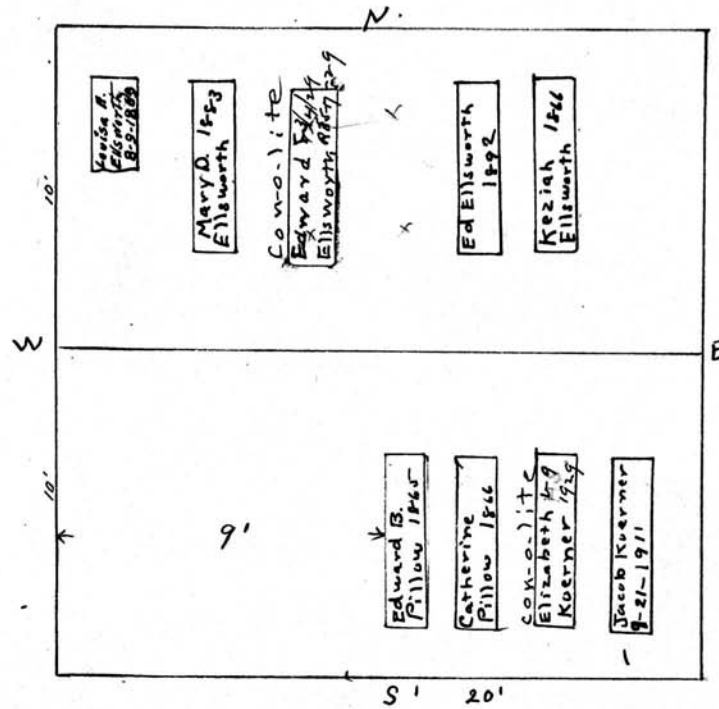

Koerner and Pillow  
PERPETUAL CONTRACT.

S 1/2

Scale: 1/2" = 1 Foot