

Church/Organization: Riverside Cemetery
2650 Lake Avenue
Rochester, NY 14612

Years of Operation 1892– present

Volume Title: Sections G-4 and G-5

Film/Scan Location: Riverside Cemetery
2650 Lake Avenue
Rochester, NY 14612

(585) 428-7775
<http://www.cityofrochester.gov/Riverside/>

Dates Imaged: June 2013 – September 2013

Number of pages: 118

Notes: Riverside and Mount Hope Cemetery indexes, searchable by name, can be found on the University of Rochester website at <http://rbscp.lib.rochester.edu/mthope/search>. We recommend you use this tool to facilitate your search.

Except for blank pages that were not photographed or scanned, the images represent Riverside Cemetery records as they appear in their original form and order. Note: not all records follow logical, chronological or alphabetical order.

Plot Records for Sections G-4, G-5 include plot #, name of plot owners, and map of burials in the plot with the names of those buried. Section maps added.

Digitally photographed or scanned from original documents by:

**The Rochester Genealogical Society, Inc.
Church Records Preservation Committee**

Bob Coomber
Russ Green
Eila Harkonen-Hart
Jim Hendrickson

Roscoe Hastings
Kathryn Heintz
Linda Koehler
Larry Lavery

Larry Naukam
Sharon Perkins

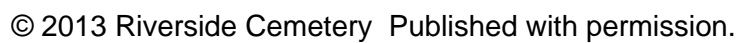

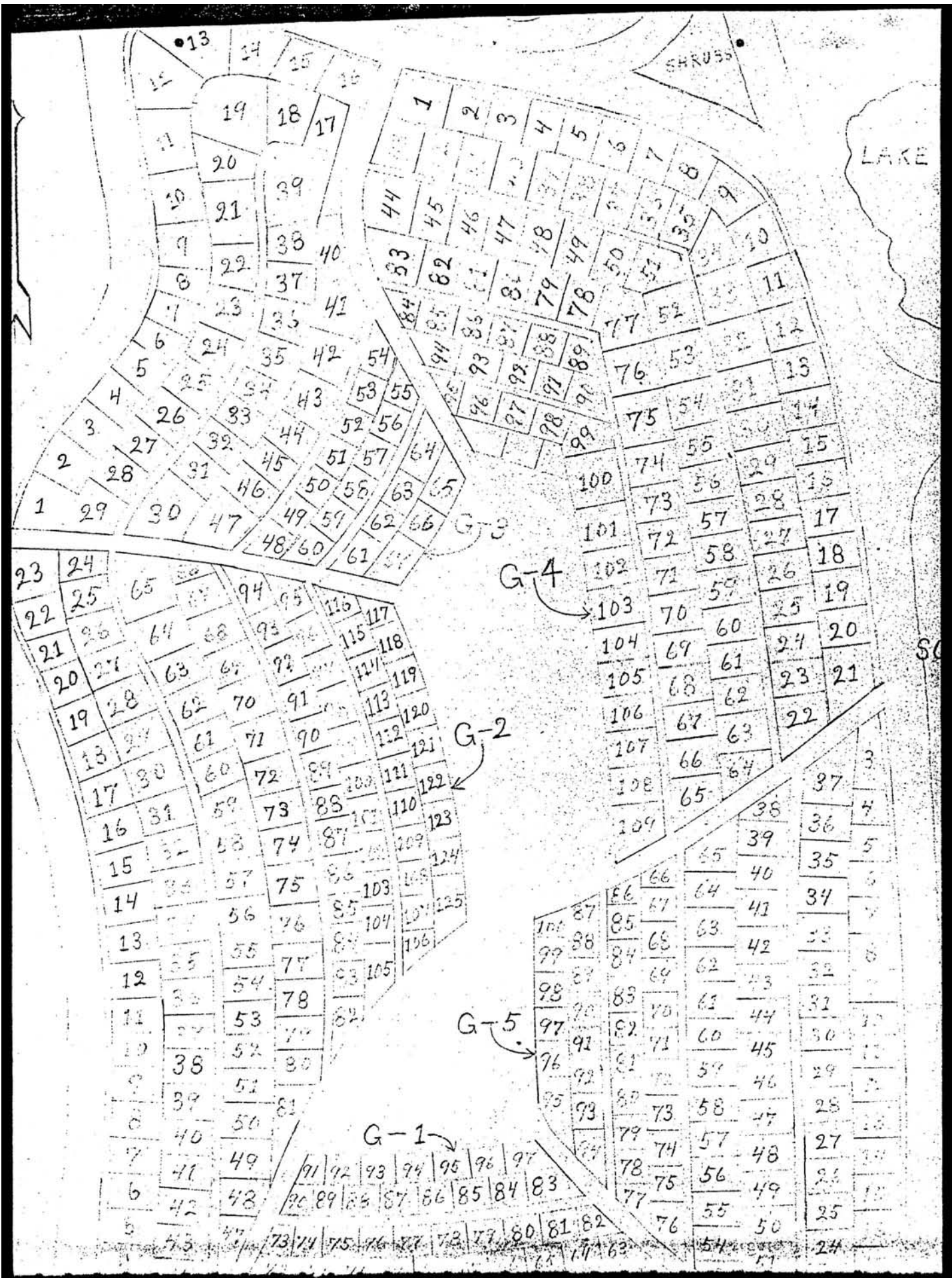

LOT G-4

<u>Lot #</u>	<u>NAME</u>	<u>MONUMENT/MARKER</u>
1	HARTFELDER	MONUMENT
2	PEMBROKE	MARKER
3	BO	MONUMENT
4	DAKE	MONUMENT
5	PAGE MISSING	
6	MCMATH	MARKER
7	CHAPIN	MARKER
14	BUDONG	MARKER
25	WILCOX	MONUMENT
26	DOUGLAS	MONUMENT
28	FREY	MONUMENT
29	HORNBECK	MARKER
30	MENTER	MARKER
31	KIRKPATRICK	MARKER
34	LYON	MARKER
35	WOODBURY	MARKER
36	CHAPIN	MARKER
37	BERGH	MONUMENT
38	MORGAN	MARKER
39	MARHITE	MONUMENT
40	ALDERMAU	MARKER
42	CARLTON	MONUMENT
43	CHARLES/BRYANT	MARKER
	ABRAMS/KEFFAOU	(GR# 10-13 AVAIL)
44	ALLEN	MARKER (GR#16,17 AVAIL)
46	RICHMOND	MONUMENT
47	ROBBINS	MONUMENT
48	FITZSIMONS	MONUMENT
49	MORGAN	MARKER
50	PEMBROKE	MONUMENT
51	BUSKIRK	MARKER
52	ROUSE	MONUMENT
53	WOODWORTH	MARKER
54	VANDERLINDE	MONUMENT
55	MASON	MONUMENT
56	MOSHER	MONUMENT
57	BERGENER	MONUMENT
58	LUNT	MARKER
59	ORPHY/HENCKELL	MONUMENT
60-67		PAGES MISSING
68	INGMIRE	MONUMENT
69	ROBBINS	MONUMENT
70	GRAESER	MARKER
71	JAMESON	MONUMENT
72	CHASE	MARKER
73	LOVEJOY	MARKER
74	BALDWIN	MARKER
75	POTTER	MARKER
76	SEELEY	MARKER

77	WESTERVELT	MONUMENT
78	SHANTZ	MARKER
79-80	GRAVES	MONUMENT
81	PARKHURST	MONUMENT
82	BROCKWAY FLAT	MARKER
83	WILSON/PARDYJAK	(GR#1,2,3 TREE/4, 7-9 AVAIL)
84	MARTIN	MARKER
85	SMITH	MARKER
86	CORNWALL	MONUMENT
87	WRAY/BENEDICT	MARKER
88	MASON	MARKER
89	HILL	MONUMENT
90	ENSIGN	MARKER
91	NEWTON/BENNETT	MARKER
92	WARING	MARKER
93	THOMPSON	MONUMENT
94	KISHLAR	MONUMENT
95	YATES	MARKER
96	DICKINSON	MARKER
97	PARKINSON	MARKER
98	ALVOD	MARKER
99	PAGE MISSING	
100	BROWNELL	MONUMENT
101	RATHBUN/SAWYER	MARKER
102	SMITH	MONUMENT
103-112	PAGES MISSING	

RIVERSIDE CEMETERY, PLOT RECORD

BLOCK
SECTION

G-4

LOT NO.

1

AS OF
2/20/97
SEE G-4, LOT 1
FILE

JOINT
OWNERS:

Karen Jett
Paul H. Clair
Patricia Ramsey
Anne Malone
Jane Williams

PC
#5
1176.45
PD
2/20/97

John E. Hartfelder

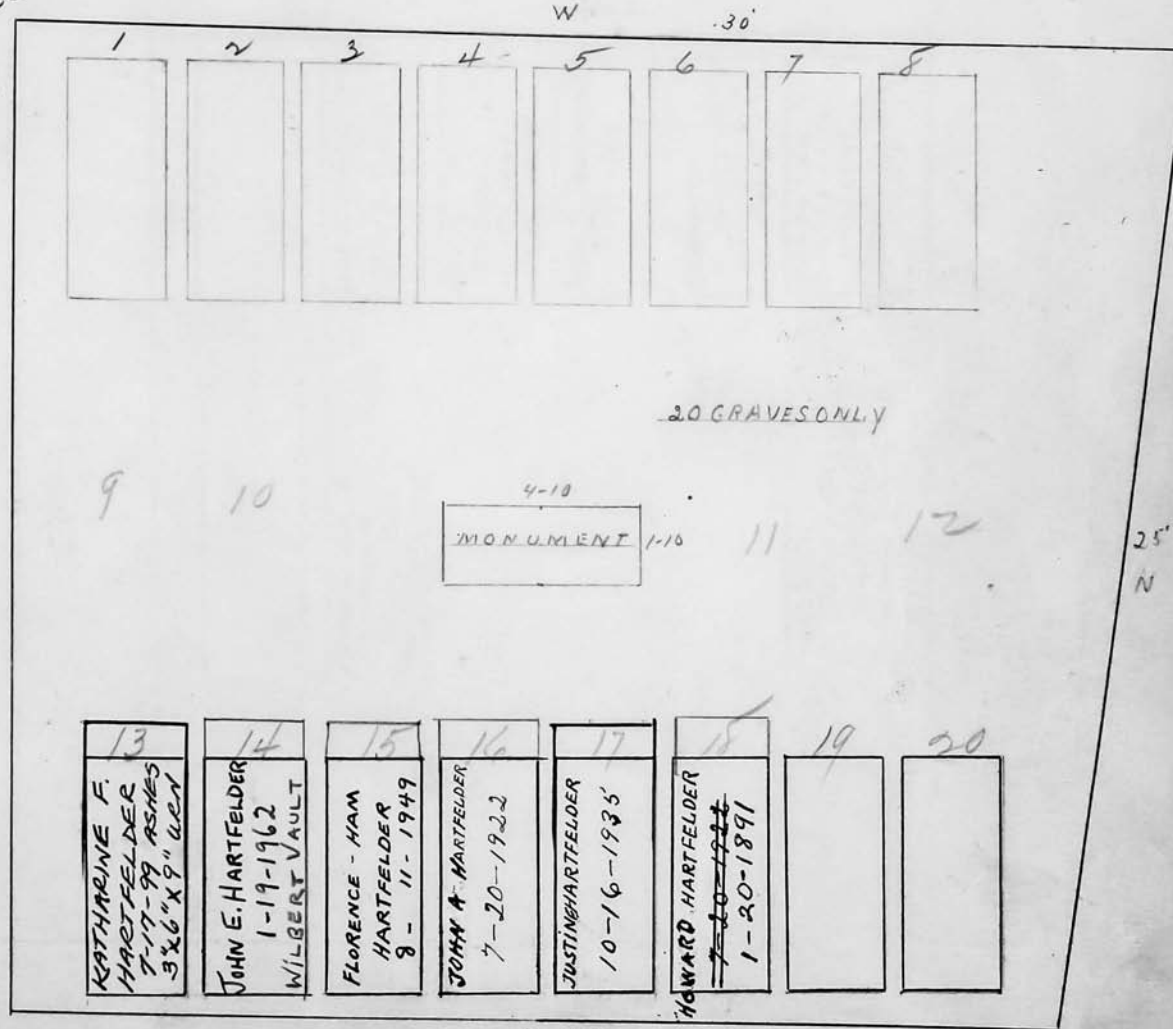

Scale 4 ft. = 1 inch

RIVERSIDE CEMETERY, PLOT RECORD

BLOCK
SECTION

G-4

LOT NO.

2

Winfield Perry Pembroke

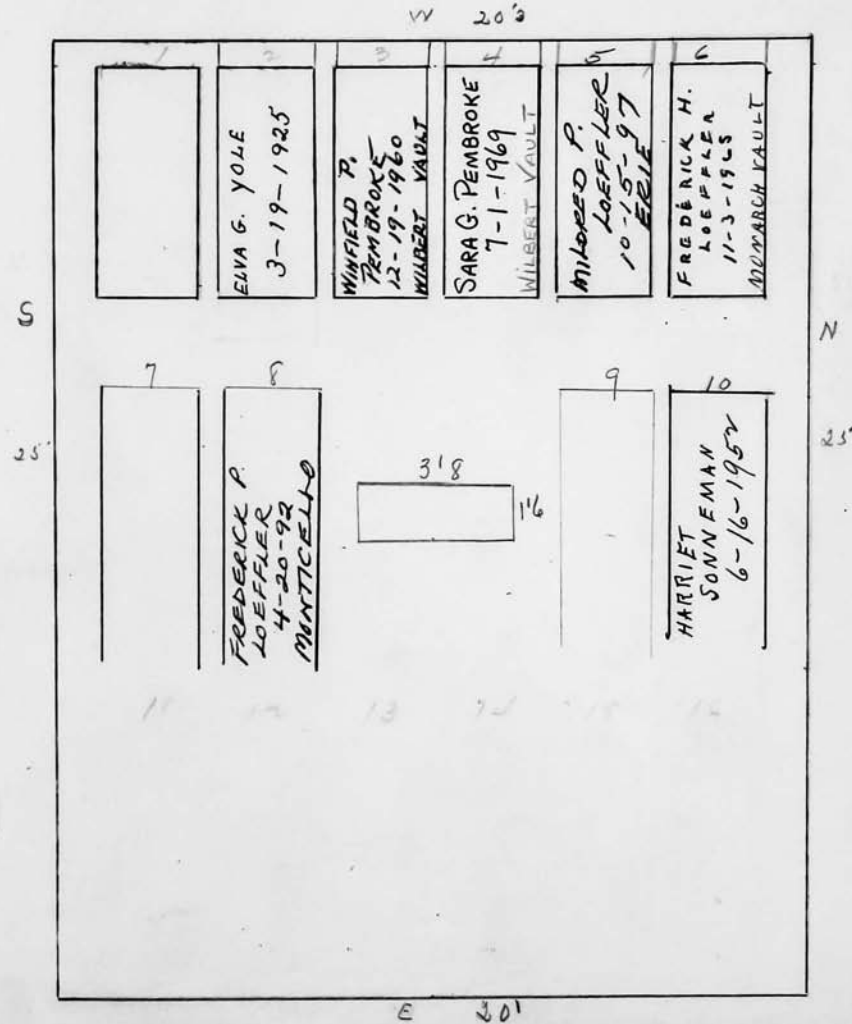

Scale 4 ft. = 1 inch

RIVERSIDE CEMETERY, PLOT RECORD

BLOCK SECTION } G-4 LOT NO. 3

Sigurd B.

25' S

see file

25' N

see file

18' E

Scale 4 ft. = 1 inch

1	2	3	4	5	6
				JAMES P. FREARSON 6-9-1970 MONROE VAULT	see for may for those see file
7	8	3-2 MONUMENT 1-8		9	10
	MARY C. OLSEN 10-6-1971 WILBERT VAULT				
11	12	13	14	15	16
RAYMOND J. OLSEN 7-8-1980 OATKA	STEP MOTHER Juli B. Monroe Juli B. 5-12-87	SIGURD H. BO 3-23-1916	BARBARA BO 5-37-1925 BO INF. OF SIGURD 5-27-1925 INCASKET WITH MOTHER	KRISTINE A. BO 9-4-1919	Beth Ann Jones 12-16-80 Vault

GLANCE MAPLE W 18'

pc

RIVERSIDE CEMETERY, PLOT RECORD

BLOCK
SECTION

G-4

LOT NO.

4

William W. Dake

W. 12'

S 25'

25'

N

MONUMENT

6'-4"

WILLIAM W. DAKE
6-7-1940
CEMENT VAULT

KATHERINE C. DAKE
4-30-1929

ETTA MAY DAKE
9-30-1941
CEMENT VAULT

19' E.

Scale 1/4" ft. = 1 inch

RIVERSIDE CEMETERY, PLOT RECORD

BLOCK
SECTION

G-4

LOT NO.

6

Morrison H. McMath and Elizabeth, his wife.

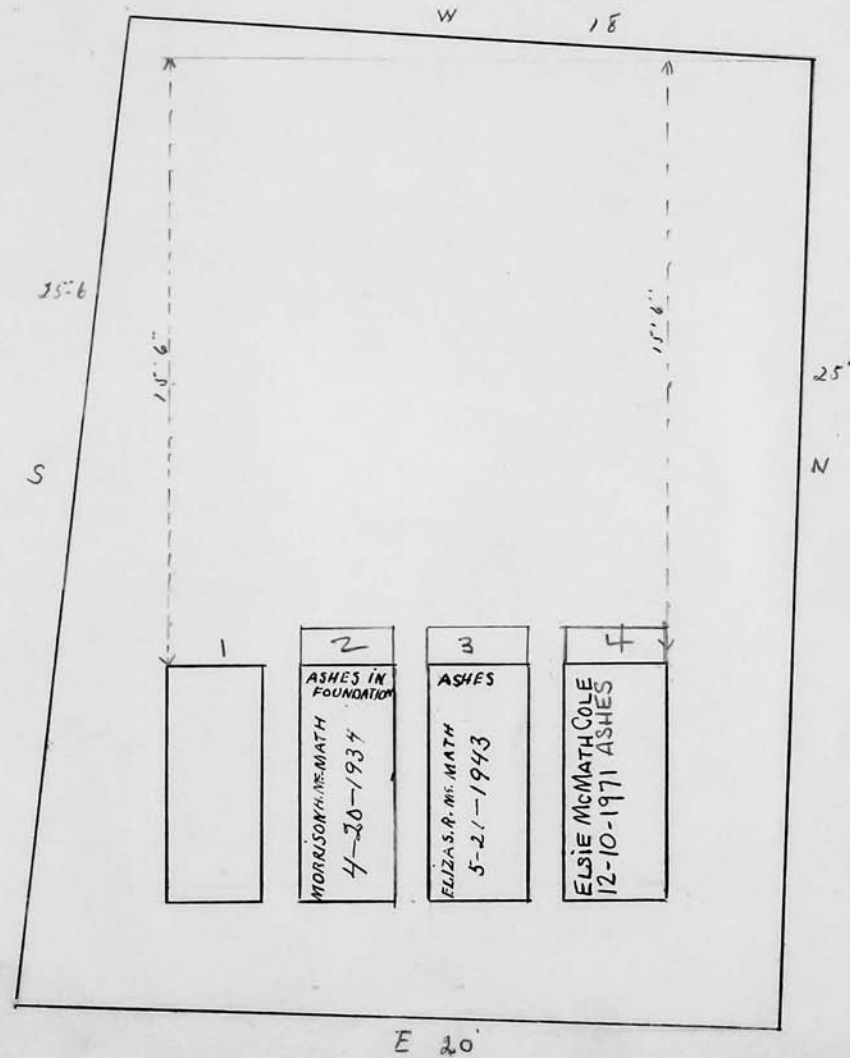

Scale 4 ft. = 1 inch

RIVERSIDE CEMETERY

ROCHESTER N.Y.
5/9, 1928

LOTS 7-8-36-G-4

Elizabeth Lyon Chapin

1	2	3	4	5	6	7
MARKER JANETTE K. CHAPIN 1901-1904	MARKER WILLIAM C. CHAPIN 1901-1904	MARKER LOUIS W. CHAPIN 1901-1904		MARKER PETER K. CHAPIN 1901-1904	MARKER MADE	
8	9	10	11	12	13	14
MARKER DOROTHY L. CHAPIN 1901-1904	MARKER EDNA C. CHAPIN 1901-1904	MARKER LOUIS W. CHAPIN 1901-1904	MARKER WILLIAM W. CHAPIN 1901-1904	MARKER ELIZABETH L. CHAPIN 1901-1904	MARKER FANNY L. CHAPIN 1901-1904	MARKER MARY BOLE 1901-1904
16	17	18	19	20	21	22
		MARKER BARBARA C. CHAPIN 1901-1904	MARKER ESTELLA M. CHAPIN 1901-1904	MARKER EDMUND L. CHAPIN 1901-1904	MARKER ELIZABETH L. CHAPIN 1901-1904	MARKER ERNEST L. WHITE 1901-1904

23 26 27 28 29 30 31 32 33 34 35 36

37 38 39 40 41 42 43 44 45 46 47 48 49

E

SCALE 5' = 1"
BY C.W. COLLINGS

RIVERSIDE CEMETERY, PLOT RECORD	BLOCK SECTION	G-4	LOT NO.	7
<div style="display: flex; justify-content: space-between; align-items: center;"> <div style="text-align: center;"> <p style="font-size: 1.5em; margin: 0;"><i>Elizabeth Lyont Chapin</i></p> <p style="margin: 0;">W</p> </div> <div style="text-align: right;"> <p style="margin: 0;"><i>see #8-36</i></p> </div> </div> <div style="margin-top: 20px;"> </div>				
<p>Scale 1/4" = 1 inch</p>				

RIVERSIDE CEMETERY, PLOT RECORD	BLOCK SECTION } <u>G-4</u>	LOT NO. <u>8</u>
<p><u>Elizabeth Lyon Chapin</u> <i>see #7 = #36</i></p> <p style="margin-left: 150px;">W</p>		
<div style="position: relative; width: 100%; height: 100%;"> <div style="position: absolute; top: 0; right: 0;">20'</div> <div style="position: absolute; bottom: 0; right: 0;">22'</div> <div style="position: absolute; left: 0; top: 50%; transform: translateY(-50%);">S</div> <div style="position: absolute; left: 0; top: 50%; transform: translateY(-50%);">25'</div> <div style="position: absolute; right: 0; top: 50%; transform: translateY(-50%);">N</div> <div style="position: absolute; right: 0; top: 50%; transform: translateY(-50%);">25'</div> <div style="position: absolute; bottom: 0; left: 50%; transform: translateX(-50%);">E</div> </div> <p style="margin-top: 20px;">Family Lots 7, 8, 36 See layout Lot 36</p>		
<p>Scale $\frac{1}{4}$ ft. = 1 inch</p>		

RIVERSIDE CEMETERY, PLOT RECORD		BLOCK SECTION	LOT NO.
		G-4	9
<hr/> <i>Mamie C. Woodbury</i> <i>sec 35</i> <hr/>			
Scale ft. = 1 inch			

RIVERSIDE CEMETERY, PLOT RECORD		BLOCK SECTION	LOT NO.
		G-4	10
<div>PC</div> <div>Carolyn H. Lyon sec #11-133-134</div>			
Scale ft. = 1 inch			

RIVERSIDE CEMETERY, PLOT RECORD		BLOCK SECTION	LOT NO.
		G-4	11
Carolyn H. Lyon			sec #10-133-34

Scale ft. = 1 inch

RIVERSIDE CEMETERY, PLOT RECORD		BLOCK SECTION } <u>G-4</u>	LOT NO. <u>12</u>
<u>Sarah E. Woodworth</u> <u>see #32-#53</u>			
<p>ERNEST B. MILLARD 1 Present owner 4/7/96</p>	<div style="display: flex; justify-content: space-around; align-items: center;"> <div style="border: 1px solid black; width: 80%; height: 50%; position: relative;"> <div style="position: absolute; top: 5%; right: 5%; transform: rotate(90deg);">25'</div> <div style="position: absolute; bottom: 5%; right: 5%;">23'</div> <div style="position: absolute; top: 5%; left: 5%;">2'</div> <div style="position: absolute; top: 10%; left: 10%;"> <div style="display: flex; justify-content: space-between; width: 100%;"> 1234567 </div> <div style="display: flex; justify-content: space-between; width: 100%; margin-top: 40px;"> 891011121314 </div> </div> </div> </div>		
Scale ft. = 1 inch			

RIVERSIDE CEMETERY, PLOT RECORD

BLOCK
SECTION

G-4

LOT NO.

13

G.W. & H.M. Kirkpatrick sec #31

Scale ft. = 1 inch

RIVERSIDE CEMETERY, PLOT RECORD

BLOCK
SECTION

G-4

LOT NO.

14

Hattie B. Menter

see #30

TRANSFERED
1-12-1961

BARRY BUDLONG, JR.

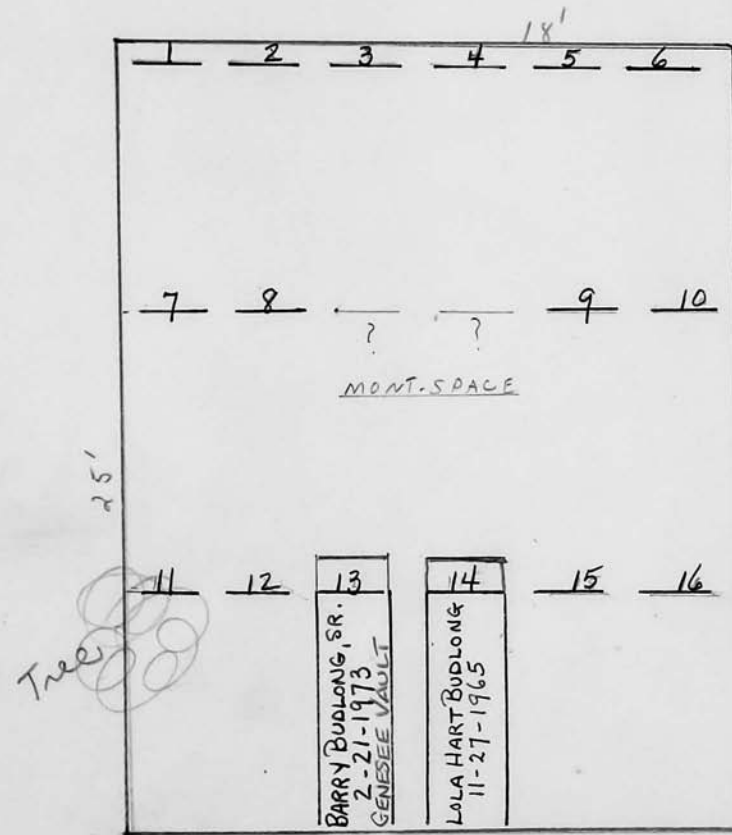

Scale ft. = 1 inch

RIVERSIDE CEMETERY, PLOT RECORD

BLOCK
SECTION

G. 4

LOT NO.

15- Sec 29 G. 4.

Marie W Stombeck

Scale ft. = 1 inch

RIVERSIDE CEMETERY, PLOT RECORD	BLOCK SECTION	G-4	LOT NO.	17
<p><i>Est. of Robert Douglas. sec # 18 - 26 - 27 -</i></p>				
<p>Scale ft. = 1 inch</p>				

RIVERSIDE CEMETERY, PLOT RECORD		BLOCK SECTION	LOT NO.
		G-4	18
<i>Est. of Robert Douglas</i> See #17-26-27			
Scale ft. = 1 inch			

RIVERSIDE CEMETERY, PLOT RECORD		BLOCK SECTION	LOT NO.
		G-4	26
<i>Est of Robert Douglas Dec 17 - 18 27</i>			
Scale ft. = 1 inch			

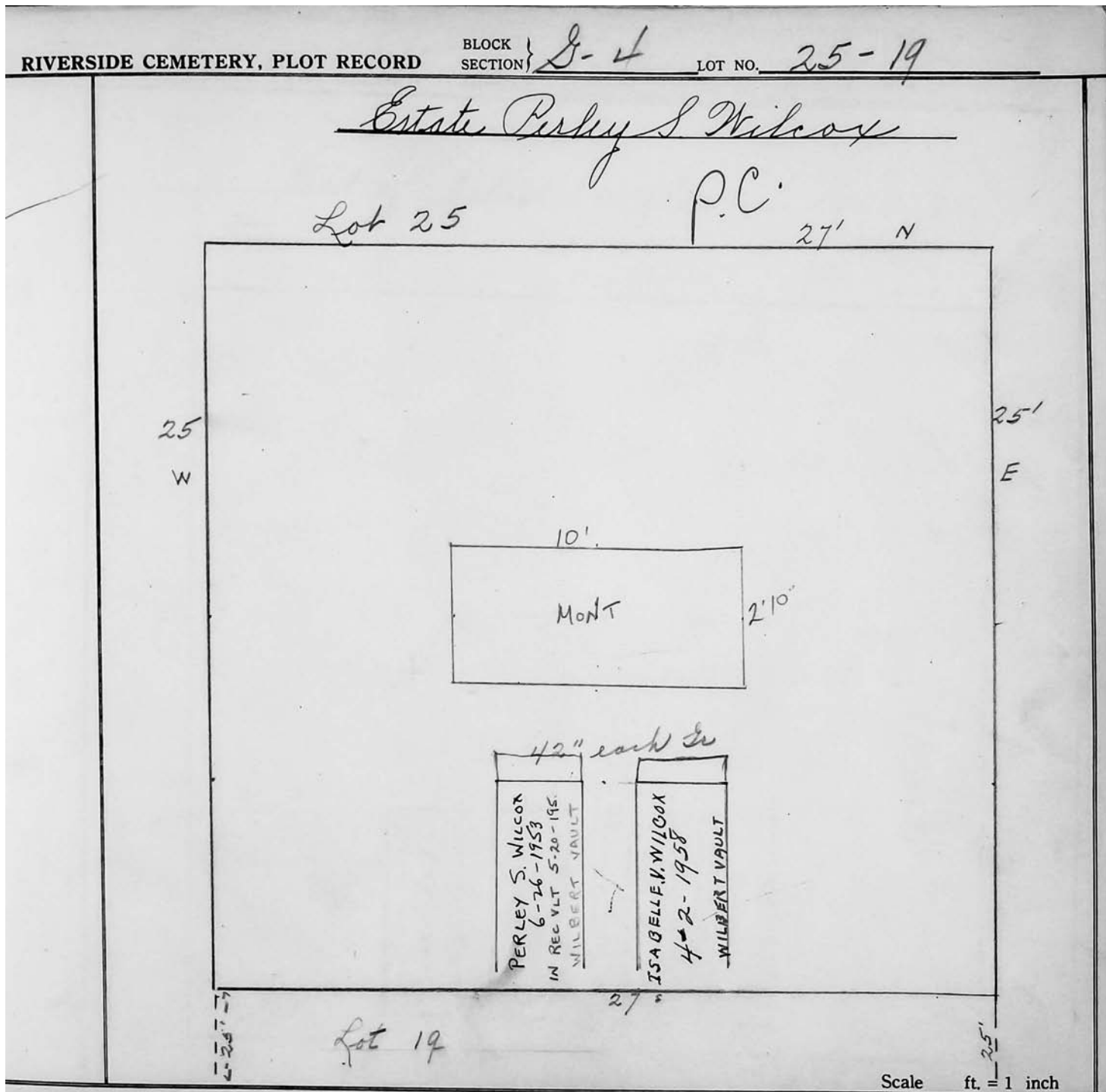

RIVERSIDE CEMETERY, PLOT RECORD

BLOCK SECTION } G-4 LOT NO. 26-27

East of Robert Douglas sec #17-18-26

27 N

25 W

10-0

MONUMENT

4-0 SEE FILE

25 E

27 S

40" EACH GRAVE

TREE SCARLETOAK

FANNIE G. DOUGLAS
3-29-1962
WILBERT VAULT

ROBERT DOUGLAS
7-1-1929
CEMENT VAULT

CEMENT VAULT

CHARLES A. DOUGLAS
5-29-1950

CAROLINE S. DOUGLAS
4-8-1947
CEMENT VAULT

Scale 1/4" = 1 ft.

RIVERSIDE CEMETERY, PLOT RECORD

BLOCK
SECTION

G-4

LOT NO.

28 AND 16-G.4

John Frey - see #16

12' 6" CO. LINE OF MONT

EM. MAR. LATTA
8-12-1933
NORWALK VAULT
HAN VALLETT H. LATTA
11-10-1930
LOUISE M. DENISE
8-1-1919
WILLIAM H. DENISE
4-6-1928
CONOLITE VAULT
HARRY DENISE
12-27-1960
MONARCH VAULT
EMMA DENISE
9-13-1950
Wilbert

REV. SAMUEL J. CLARKSON
1-22-1935
JENNIE FRY CLARKSON
1-17-1924
5' 8" MONUMENT
MRS. VICTORIA FREY
10-29-1960
STEEL VAULT
GEORGE HENRY
3-19-1932
STEEL VAULT

John R. Frey
5-14-81
ashes
MARY BENISH FREY
4-15-1915
JOHN FREY
3-26-1915
FREDERICK FREY
EDWARD M. FREY
ALICE DENISE
DENISE COULD NOT BE
EDWARD 4-15-1915
GRACE C. FREY
4-15-1915

Martha Melvina
Frey
ashes
2-28-89
EMMA LOUISE FREY
12-10-1934
JULIUS C. FREY
8-13-1931

SEE FILE

Scale 5 ft. = 1 inch

RIVERSIDE CEMETERY, PLOT RECORD

BLOCK SECTION } G. 4 LOT NO. 15^{AND} 29

Sold as one lot.

Marie W. Hornbeck

50. E. 50-

18. N. 18-

8' MOUNT SPACE

2' 10"

6

5

4

3

2

1

W.

GE. # 3 S.

CHARLES (SAHLER) HORNBECK

ELLEN MARIE
HORNBECK ARNOLD
6-14-95
ASHES

CHAS. S. HORNBECK
FROM MT. HOPE CEM.
4-27-1949

Scale 5 ft. = 1 inch

RIVERSIDE CEMETERY, PLOT RECORD

BLOCK
SECTION

G-4

LOT NO.

30

see 14

Hattie B Menter

- sole surviving heir - Ruth Menter Joyce

6	MARY D. JOYCE 11-30-1938	10	LOUISE D. NOYES 8-10-1953	16
5	ADRADE F. MEECH 3-27-1914 CEMENT VAULT	9	ASHES MAURICE J. JOYCE 10-4-1947 IN MARKER FOUNDATION	15
4	HARRIET B. MENTER 6-22-1922 CEMENT VAULT			14
3	CEMENT VAULT CHAS. A. MENTER 7-15-1913			13
2	LOUISE S. MEECH 1-14-1975 GENESEE VAULT	8	GERTRUDE O. MEECH 12-26-2006 MONTICELLO	12
1	AVERY M. MEECH 4-11-1973 GENESEE VAULT	7	STEWART M. MEECH 3/21/06 MONTICELLO	11
				10
				9
				8
				7
				6
				5
				4
				3
				2
				1

MONT-SPACE

LOT - 14 - G - 4

TRANSFERRED 1 - 12 - 1961

to

BARRY BUDLONG JR.

16 on 18 - graves

see lot 14 - G - 4

See file

see file 6-1-1970

See 106-E-2 account Mrs. Smith

Scale 5 ft. = 1 inch

RIVERSIDE CEMETERY, PLOT RECORD

BLOCK
SECTION

G-4

LOT NO.

31

G.W. and H.M. Kirkpatrick Sec #13

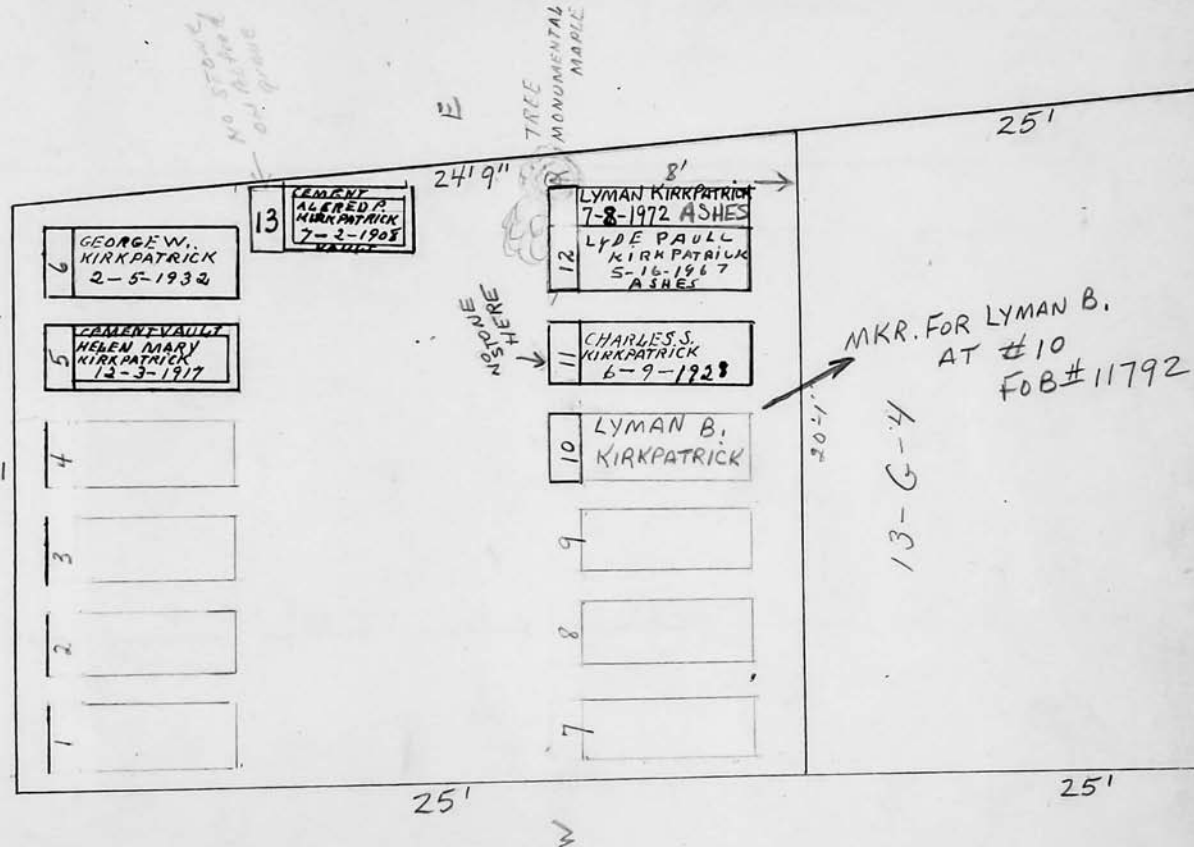

Scale 5" ft. = 1 inch

RIVERSIDE CEMETERY, PLOT RECORD		BLOCK SECTION } <u>G-4</u>	LOT NO. <u>32</u>								
<p style="font-size: 1.2em;"><u>Sarah E. Woodward</u> See #12-53</p> <p style="font-size: 0.8em;">Cenest's mother's mother (Grand-mother) Marie Woodward Millard</p>											
<p style="transform: rotate(-45deg); font-size: 0.8em;">CENEST B MILLARD Present Owner 4/7/96</p>	<p>23'</p>										
	<table style="width: 100%; border-collapse: collapse;"> <tr> <td style="border-bottom: 1px solid black; text-align: center; width: 12.5%;">1</td> <td style="border-bottom: 1px solid black; text-align: center; width: 12.5%;">2</td> <td style="border-bottom: 1px solid black; text-align: center; width: 12.5%;">3</td> <td style="border-bottom: 1px solid black; text-align: center; width: 12.5%;">4</td> <td style="border-bottom: 1px solid black; text-align: center; width: 12.5%;">5</td> <td style="border-bottom: 1px solid black; text-align: center; width: 12.5%;">6</td> <td style="border-bottom: 1px solid black; text-align: center; width: 12.5%;">7</td> <td style="width: 12.5%;"></td> </tr> </table>			1	2	3	4	5	6	7	
	1	2	3	4	5	6	7				
<table style="width: 100%; border-collapse: collapse;"> <tr> <td style="border-bottom: 1px solid black; text-align: center; width: 12.5%;">8</td> <td style="border-bottom: 1px solid black; text-align: center; width: 12.5%;">9</td> <td style="border-bottom: 1px solid black; text-align: center; width: 12.5%;">10</td> <td style="border-bottom: 1px solid black; text-align: center; width: 12.5%;">11</td> <td style="border-bottom: 1px solid black; text-align: center; width: 12.5%;">12</td> <td style="border-bottom: 1px solid black; text-align: center; width: 12.5%;">13</td> <td style="border-bottom: 1px solid black; text-align: center; width: 12.5%;">14</td> <td style="border-bottom: 1px solid black; text-align: center; width: 12.5%;">15</td> </tr> </table>			8	9	10	11	12	13	14	15	
8	9	10	11	12	13	14	15				
<p>25'</p>			<p>24.7</p>								
<p style="text-align: right;">Scale ft. = 1 inch</p>											

RIVERSIDE CEMETERY, PLOT RECORD

BLOCK
SECTION

G-4

LOT NO.

33

PC

Carolyn H. Lyon

Sec #10-#11-#34

H-2 Lat 65
Emily

Harris

342-4175

or

Linda Ambuske

467-8272

Scale ft. = 1 inch

RIVERSIDE CEMETERY, PLOT RECORD

BLOCK
SECTION

G-4

LOT NO.

34

PC

NOTE
13067 EDMUND LYON
DIED 4-24-1920
13068 CAROLYN H. LYON
DIED 12-26-1936

SIDNEY C. CHARLTON
6-10-1931

Carolyn H. Lyon

See 10-11-33

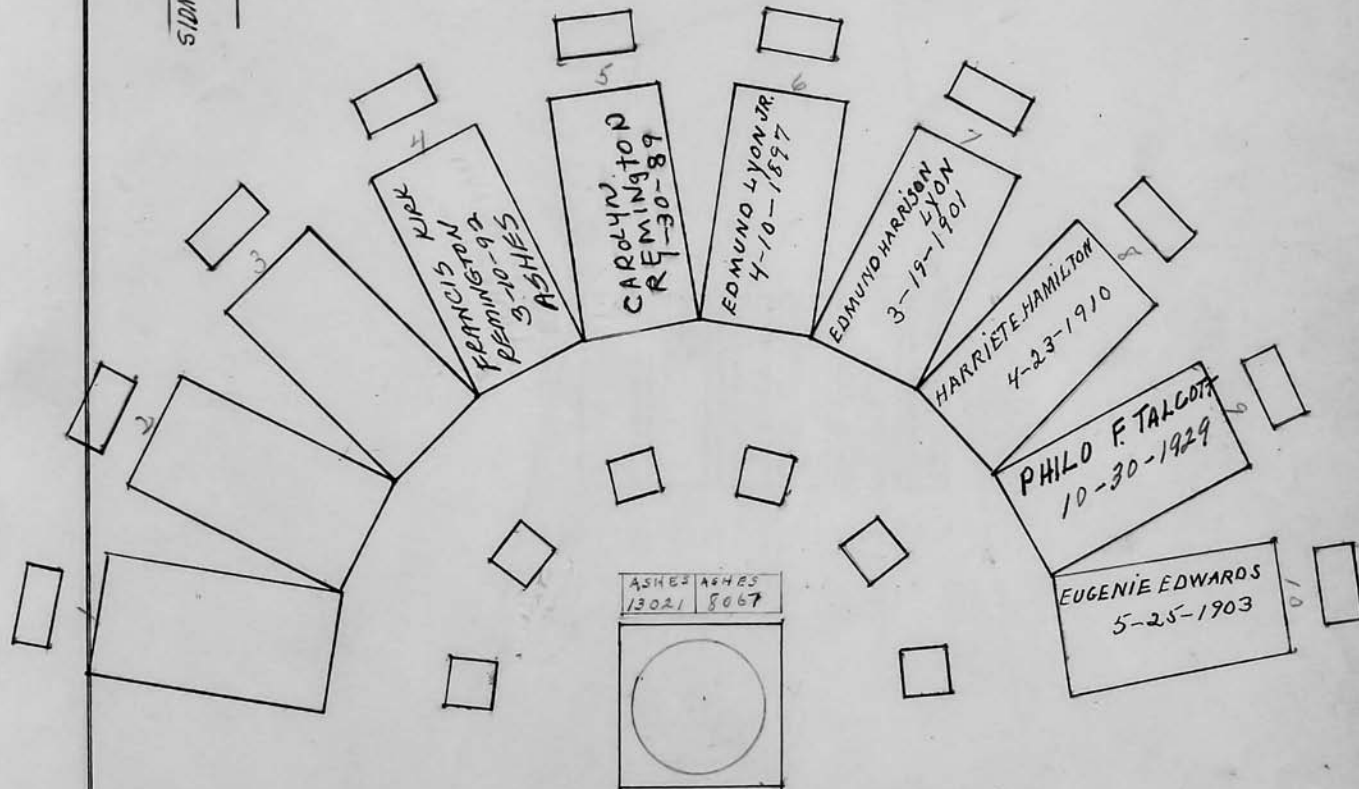

Scale 4 ft. = 1 inch

RIVERSIDE CEMETERY, PLOT RECORD

BLOCK
SECTION

G-4

LOT NO.

35

Mamie Woodbury See #9

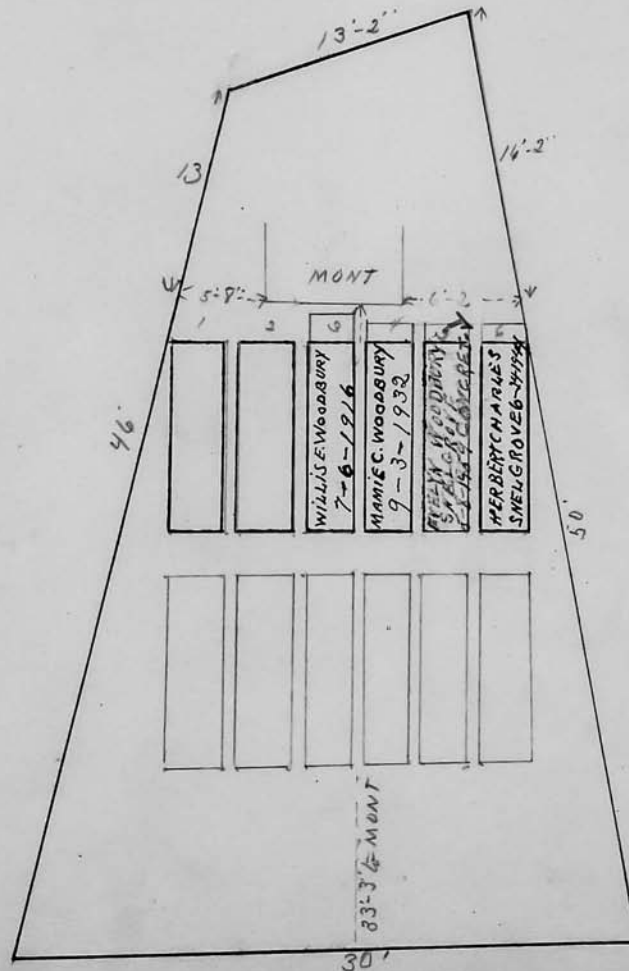

Scale 8 ft. = 1 inch

RIVERSIDE CEMETERY, PLOT RECORD

BLOCK
SECTION

G-4

LOT NO.

36

Elizabeth Lyon Chapin Sec 7-8

(John H. McGee - 508 State St.
monument dealer)
for markers - no mon. on lot

Scale ft. = 1 inch

RIVERSIDE CEMETERY, PLOT RECORD

BLOCK SECTION } *G-4* LOT NO. **37**

Wilhelmina C Bergh

see permission form on file - for Marie K. Rapp

16'6" 1/4

5

25"

25'2"

6-0

MONUMENT 3-8

18'3"

Scale 1/4" = 1' = 1 inch

1 FREDRICK BERGH ROENA PETERSON 3-19-1921	2 CHRISTINE BERGH 3-19-1921	3 WILHELMINA C. 10-14-1888 CEMENT VAULT	4 CHRISTIAN TRONSON 3-19-1921
5 LOUISE BERGH 3-19-1921	6 FRANK C. KING 8-28-1946 CONCRETE VAULT	7 RAYMOND RAPP 9-18-1972 MONROE VAULT	8
			9

4 GRAVE ONLY

RIVERSIDE CEMETERY, PLOT RECORD

BLOCK
SECTION

G-4

LOT NO.

38

Fred D. Morgan

See #49

1/25/96 #
graves #
7-11
Repurchased
from Fred
Morgan

3/22/04 -
#6208 cancelled
or #9 due to
non-payment

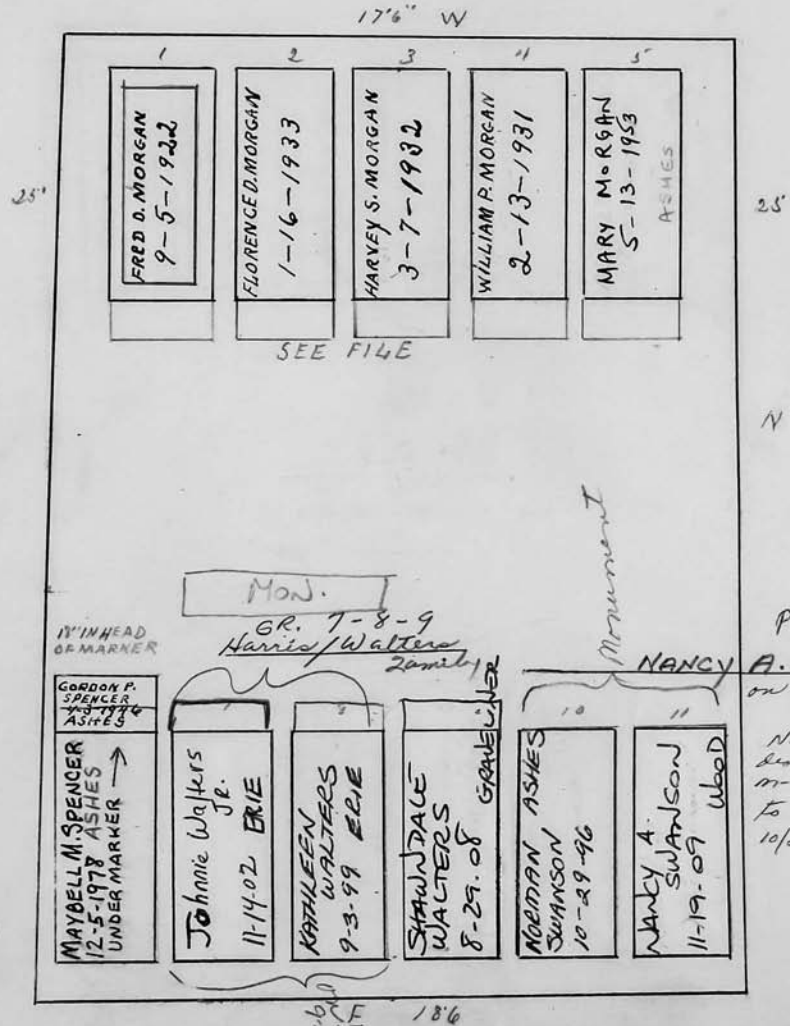

Scale 4 ft. = 1 inch

RIVERSIDE CEMETERY, PLOT RECORD

BLOCK SECTION } *G-4* LOT NO. **39**

Mayme E. Barhite

P.C. 742.50

17'6" W

25' S

8-0

MONUMENT

3-6

25' N

7 8 9 10 11 12

JOHN A. BARHITE
4-5-1924
CEMENT VAULT

MAYME E. BARHITE
4-16-1954

ROBERT S. BARHITE
10-2-90
MONTICELLO

3 FT. EACH GRAVE FROM N.E. CORNER

E 18'2"

Scale 4 ft. = 1 inch

RIVERSIDE CEMETERY, PLOT RECORD

BLOCK
SECTION

G-4

LOT NO.

40

PATRICIA ALDERMAN SNYDER
191 HENRIKSON DR
PRINCETON N.Y. 14534
586-7834

VIRGINIA ALDERMAN MOORE
RFD #1 BOX 157
NEW MARKET VIRGINIA
1-703-740-8119

HENRY O. ALDERMAN III
4675 WEST LAKE RD.
CANANDAIGUA N.Y. 14424
1-716-442-5046

Henry O. Alderman

letter in file

EARL OWNERSHIP
TO

MRS RUTH SCHERER
403 HOLLYWOOD AVE
ROCHESTER N.Y.
14618

20' W

p.c.

JEAN G. SIMMONS 10-4-1941	GEORGE SCOTT SIMMONS 6-25-1920	MARY L. SIMMONS 3-14-1933	RES. FOR JANE TERRY DWYER	MAMIE COLE DWYER 12-30-80	THOMAS R. DWYER 10-23-1939
1	2	3	4	5	6

25'
S

25'
N.

Room for
6 more graves
if no monument
is used →

EARL B. ALDERMAN 7-2-1943	HENRY RES. ALDERMAN	HARRY O. ALDERMAN 3-6-1948 WILBERT VAULT	MARY S. ALDERMAN 8-10-1945 WILBERT VAULT	RES. PATRICIA SNYDER	
7	8	9	10	11	12

E 13'4"

LARGE
TABLE

C. Donald
Snyder
Gr. 12

Scale 4 ft. = 1 inch

RIVERSIDE CEMETERY, PLOT RECORD

BLOCK
SECTION

G-4

LOT NO.

42

William F. Carlton

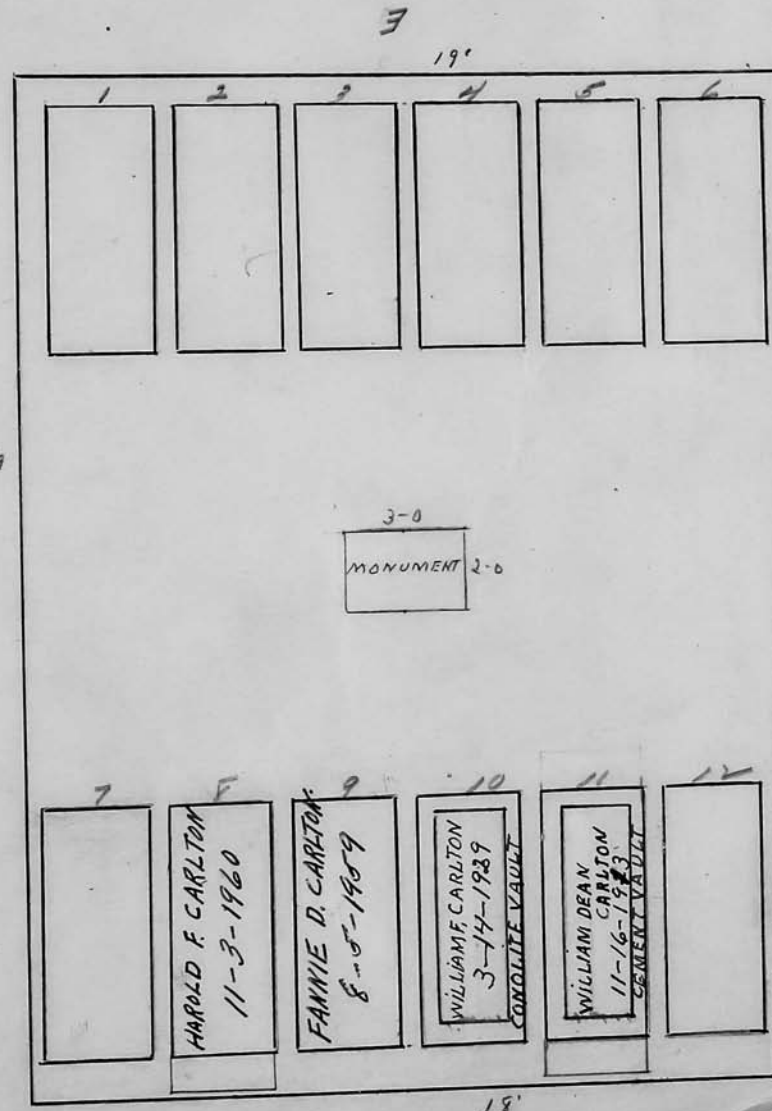

RIVERSIDE CEMETERY, PLOT RECORD

BLOCK SECTION **9-4** LOT NO. **#43**

(5)

<p>Timothy Robert Chokes 7-29-2002 MONTICELLO</p>	<p>Earl Patterson, Jr. 12-28-2012 Gravelined</p>
<p>Arthur Keiske 8-4-03 MONTICELLO</p>	<p>Rsv. Linda Patterson</p>
<p>Dorothy Kriske 5-11-2011 Gravelined</p>	<p>Ricky Storie 11-25-2008 SOLD 9/29/08</p>
<p>#8436 - CRANE 10/4/03 P.F.</p>	<p>Storie 4'6" x 1'0"</p>
<p>#8436 CRANE 10/4/03 P.F.</p>	<p>Maggie Walters on R.P. contract</p>
<p>DELSENIA ABRAMS 11-15-02</p>	<p>Maggie Walters on R.P. contract</p>
<p></p>	<p>JOHN H. SIMPSON 7-19-2008 Gravelined</p>

231

Scale ft. = 1 inch.

(7)

17'-10"

Scale 4 ft. = 1 inch

JOHN C. MOORE CORPORATION, ROCHESTER, N. Y. 412705

RIVERSIDE CEMETERY, PLOT RECORD

BLOCK
SECTION

G-4

LOT NO.

44

* #1-B sold back
to City 3/3/2012.

S.

25'

1 * m.m. #1292 LESENAUER	2 * BENJAMIN HARRIS #12554	3 * SALVADORA PEREZ 12-7-2012 GRAVELINER	4 * KRISTIN VRZOVSKI 3-4-2013	5 * VRZOVSKI #12942	6 * PHONG TRAN 1-4-2013 STEEL	7 * SOLD MINH TRAN 11/26/12 #1288	8 WESLEY WATSON 9-2-2012 Monticello
9 Joseph Reaves 6/15/2009 Graveliner	10 Don. Goff #012414 Marshall Goff	11 DOROTHY HOPKINS 10-27-2008 ERIE	12 Rae. MICHELE BRYANT 7-2-02 #7586	13 MARY E. RIVERS 6-24-2002 Drume	14 Rae. Michelle Bryant #7586	15 BEATRICE WILSON 11-12-2010 GRAVELINER	16 DONALD L. GUSTKE 3-4-03 Monticello
						17 3 P.C.S. DOMENICA GOSH #7802	

MONUMENT

Scale ft. = 1 inch

JOHN C. MOORE CORPORATION, ROCHESTER, N. Y. 412765

E

28'

N.

Scale 4 ft. = 1 inch

RIVERSIDE CEMETERY, PLOT RECORD

BLOCK
SECTION

G-4

LOT NO.

46

Lee Richmond

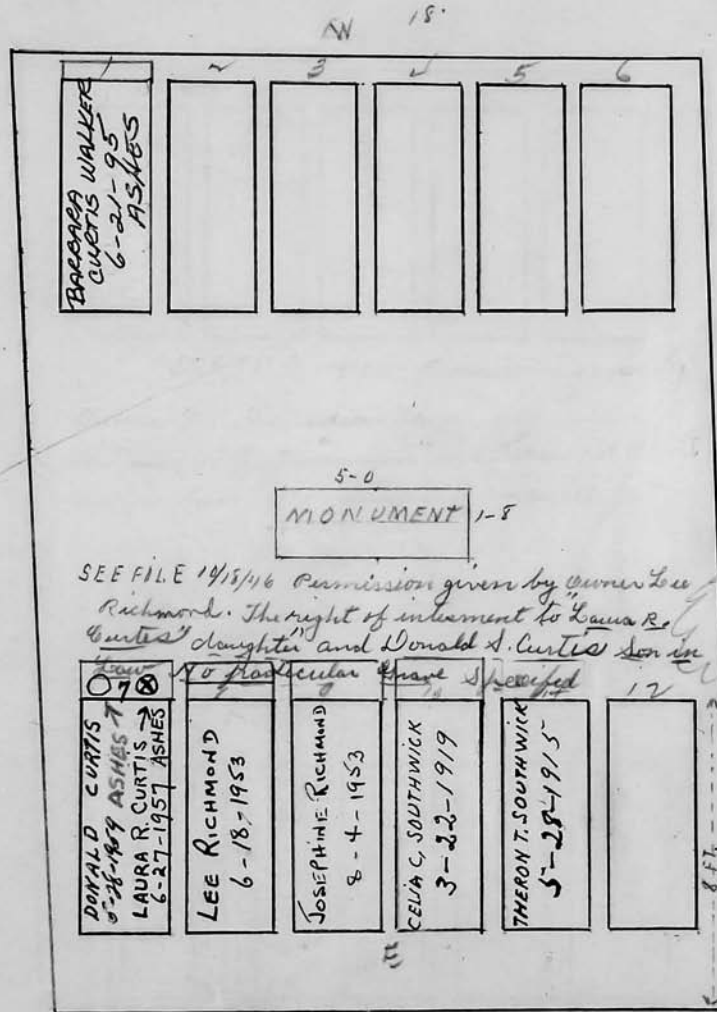

MAPLE

Scale 4 ft. = 1 inch

Scale 1 ft. = 1 inch

RIVERSIDE CEMETERY, PLOT RECORD

BLOCK
SECTION

G-4

LOT NO.

47

Joseph W. Robbins

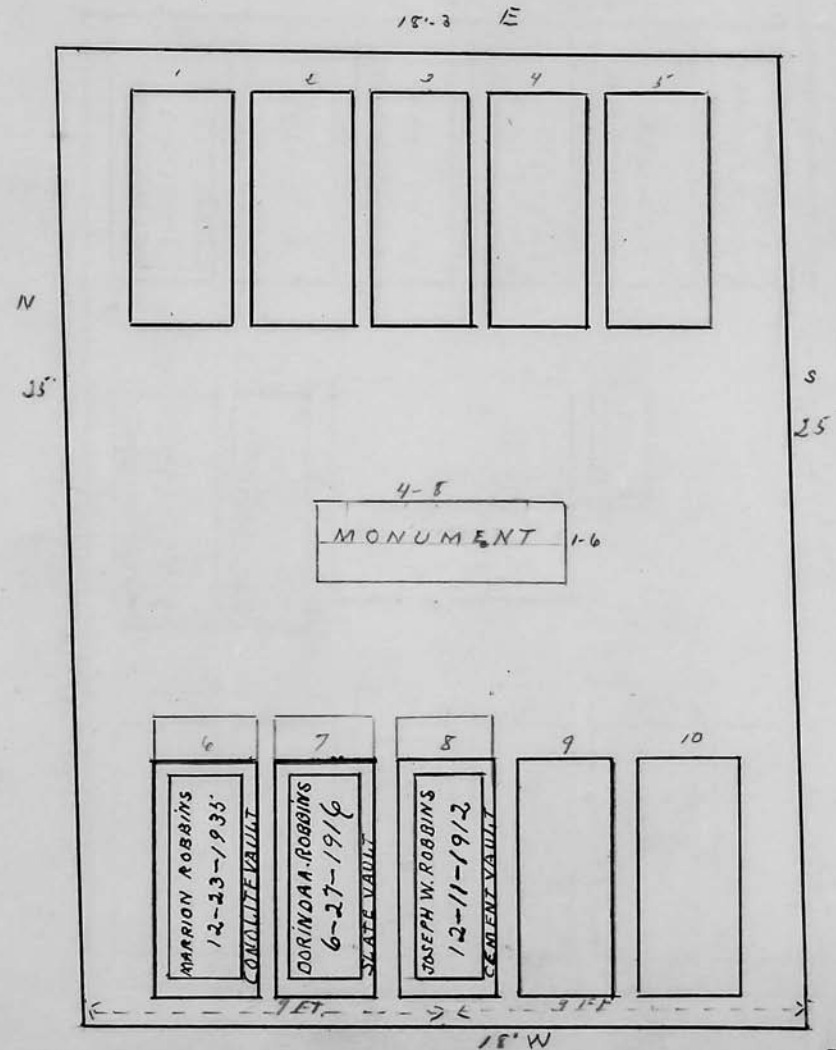

Scale 4 ft. = 1 inch

RIVERSIDE CEMETERY, PLOT RECORD

BLOCK
SECTION

G-4

LOT NO.

48

Caroline S FitzSimons

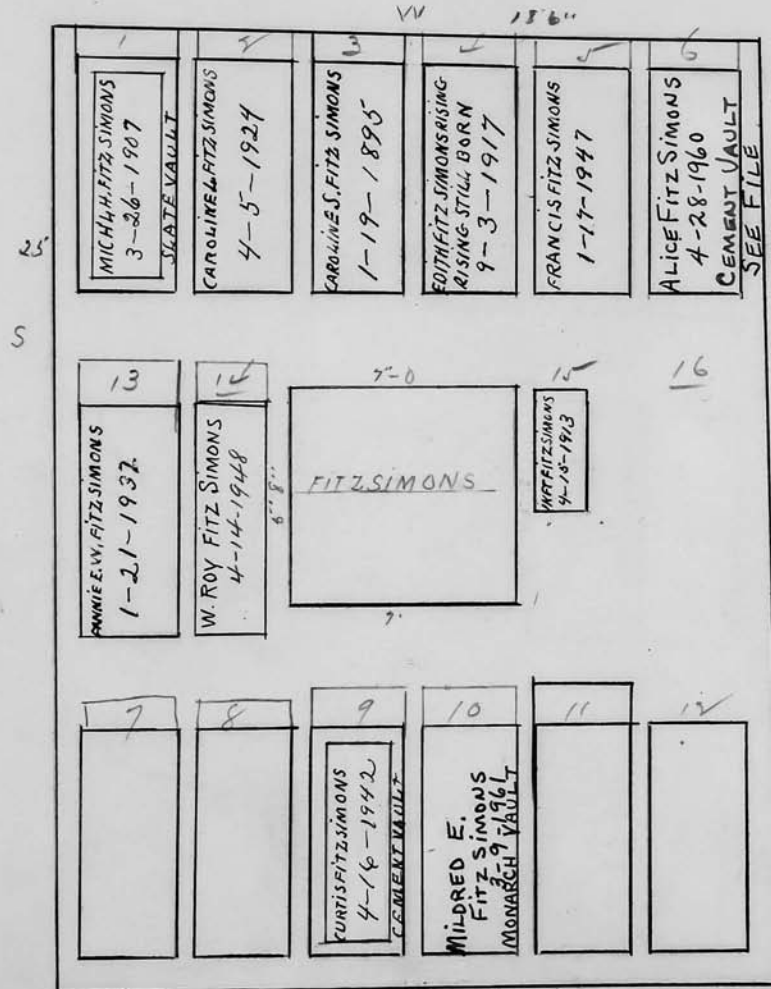

RIVERSIDE CEMETERY, PLOT RECORD

BLOCK
SECTION

G-4

LOT NO.

49

Fred D. and Henry W. Morgan

see 38

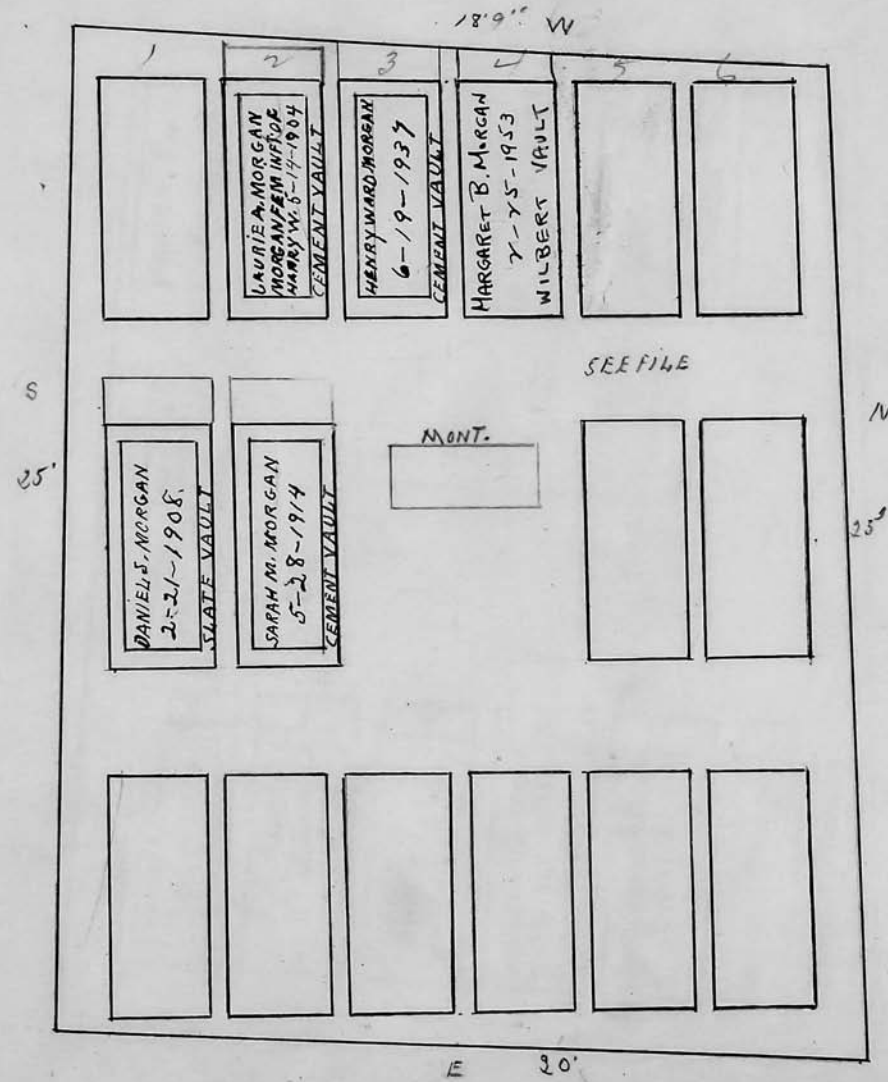

Scale 4 ft = 1 inch

RIVERSIDE CEMETERY, PLOT RECORD

BLOCK
SECTION

G-4

LOT NO.

50

Charles J. Pembroke

P.C.

LOUISE S. PEMBROKE
46 HUXLEY WAY
FAIRPORT 14450

(WIFE OF FRED
PEMBROKE) 25'

letter in file

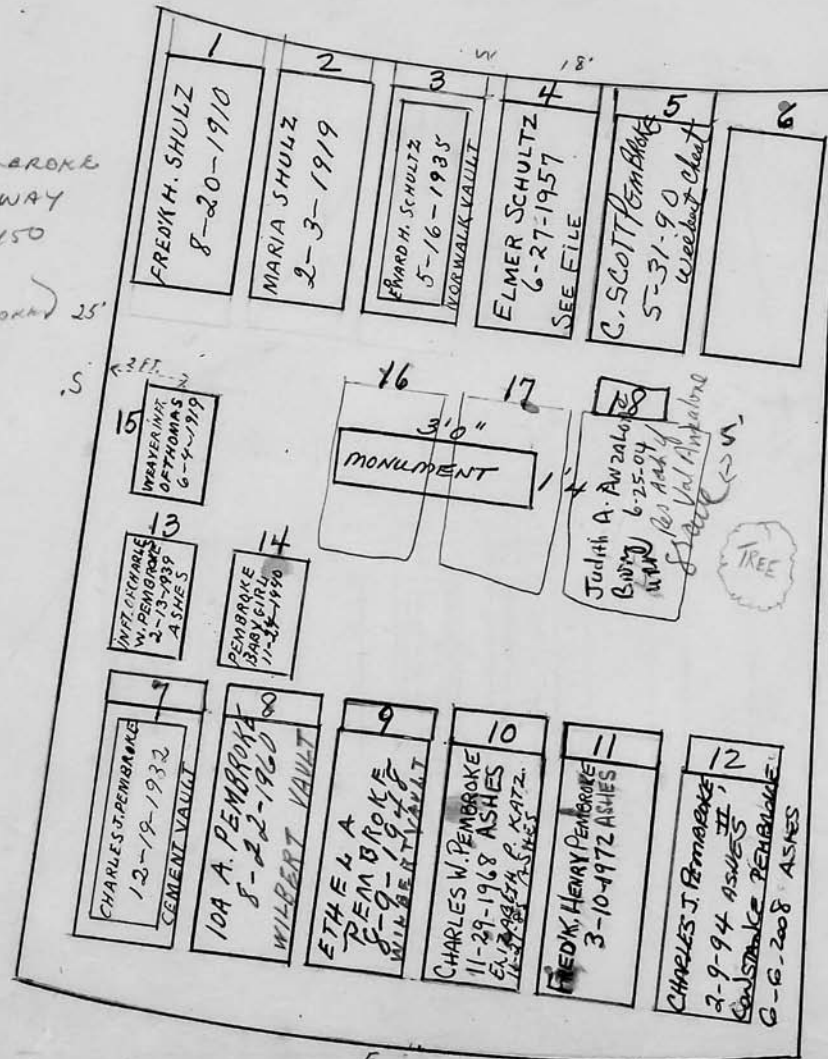

Scale 4 ft. = 1 inch

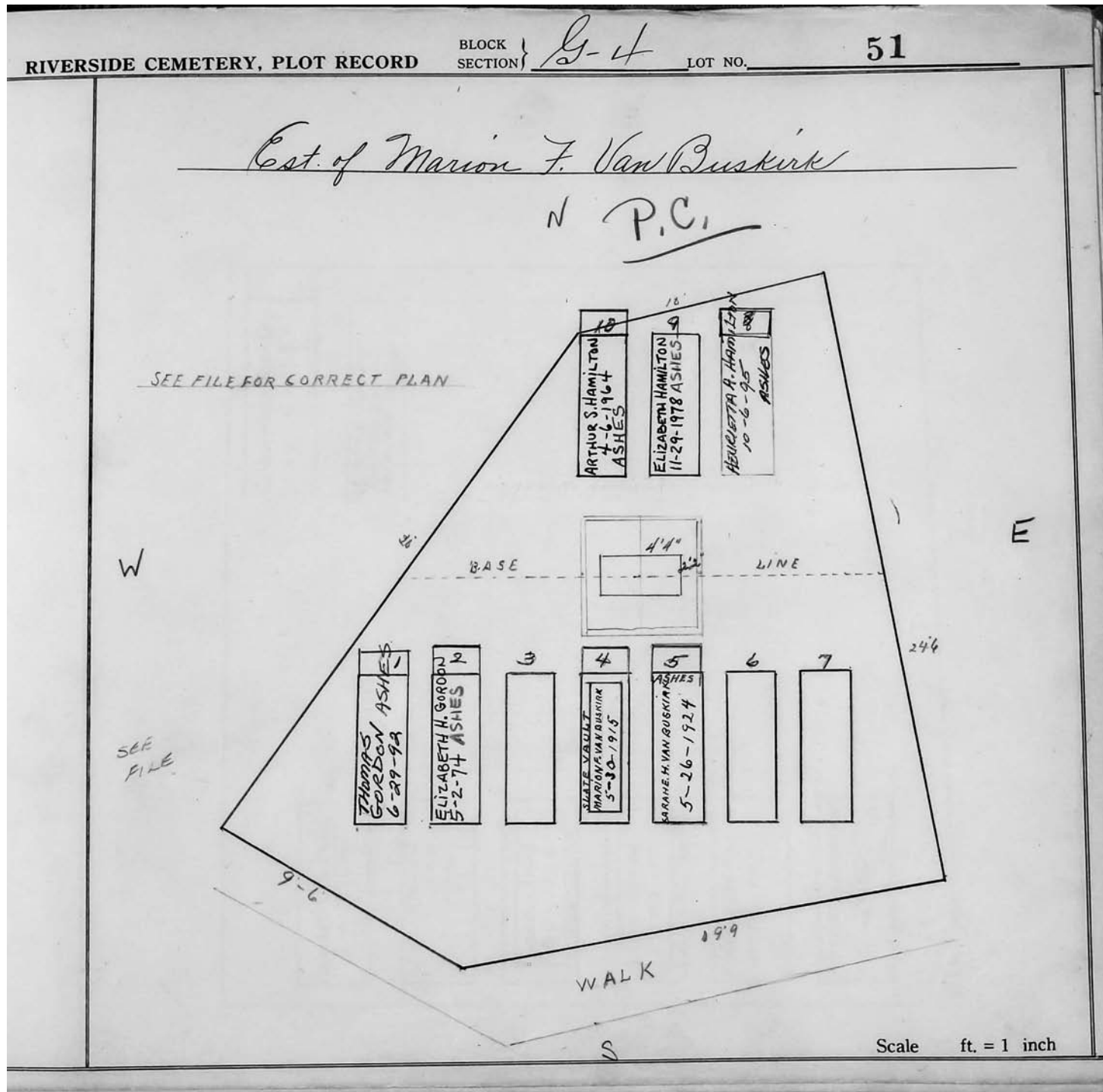

RIVERSIDE CEMETERY, PLOT RECORD

BLOCK
SECTION

G-4

LOT NO.

52

Irving Rouse

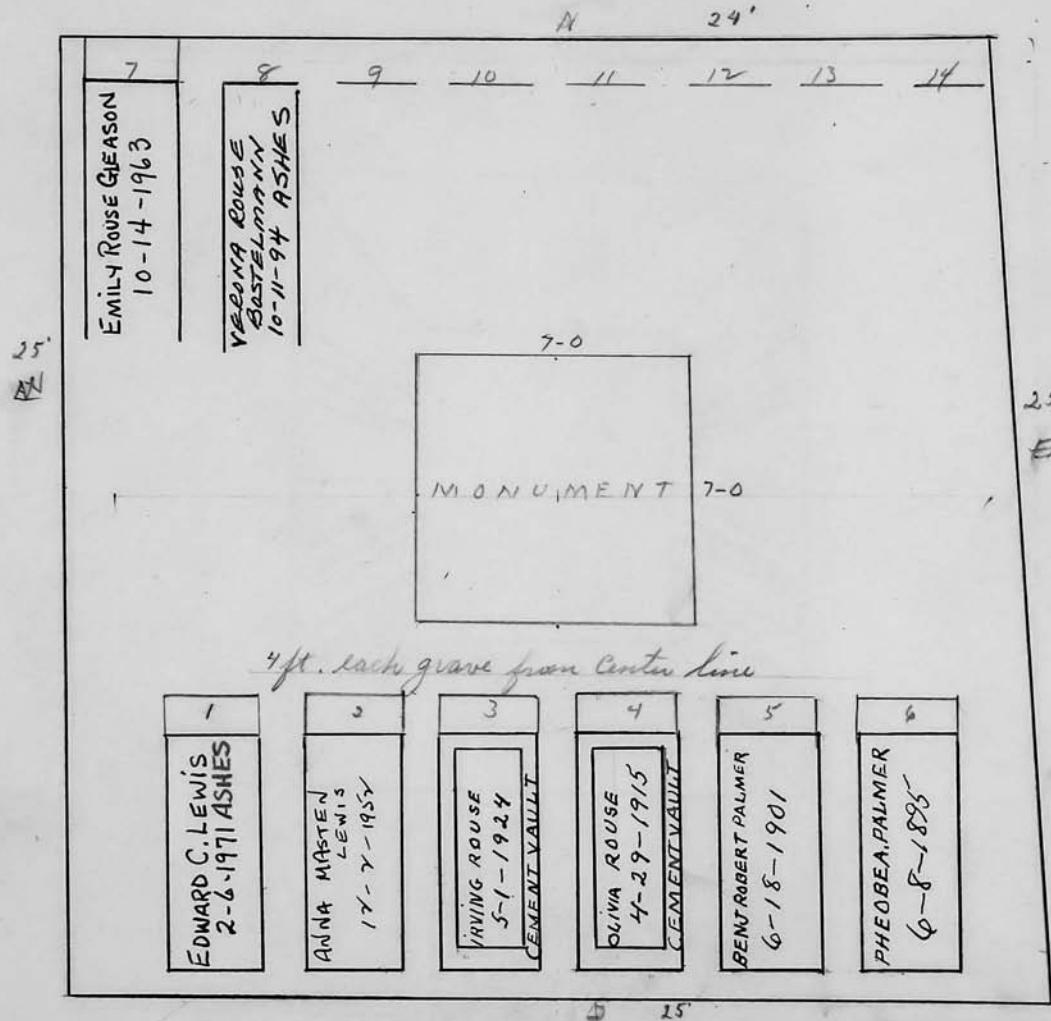

Scale 1/4" ft. = 1" inch

RIVERSIDE CEMETERY, PLOT RECORD

BLOCK
SECTION

G-4

LOT NO.

53

Sarah E. Woodworth

See #12 #32

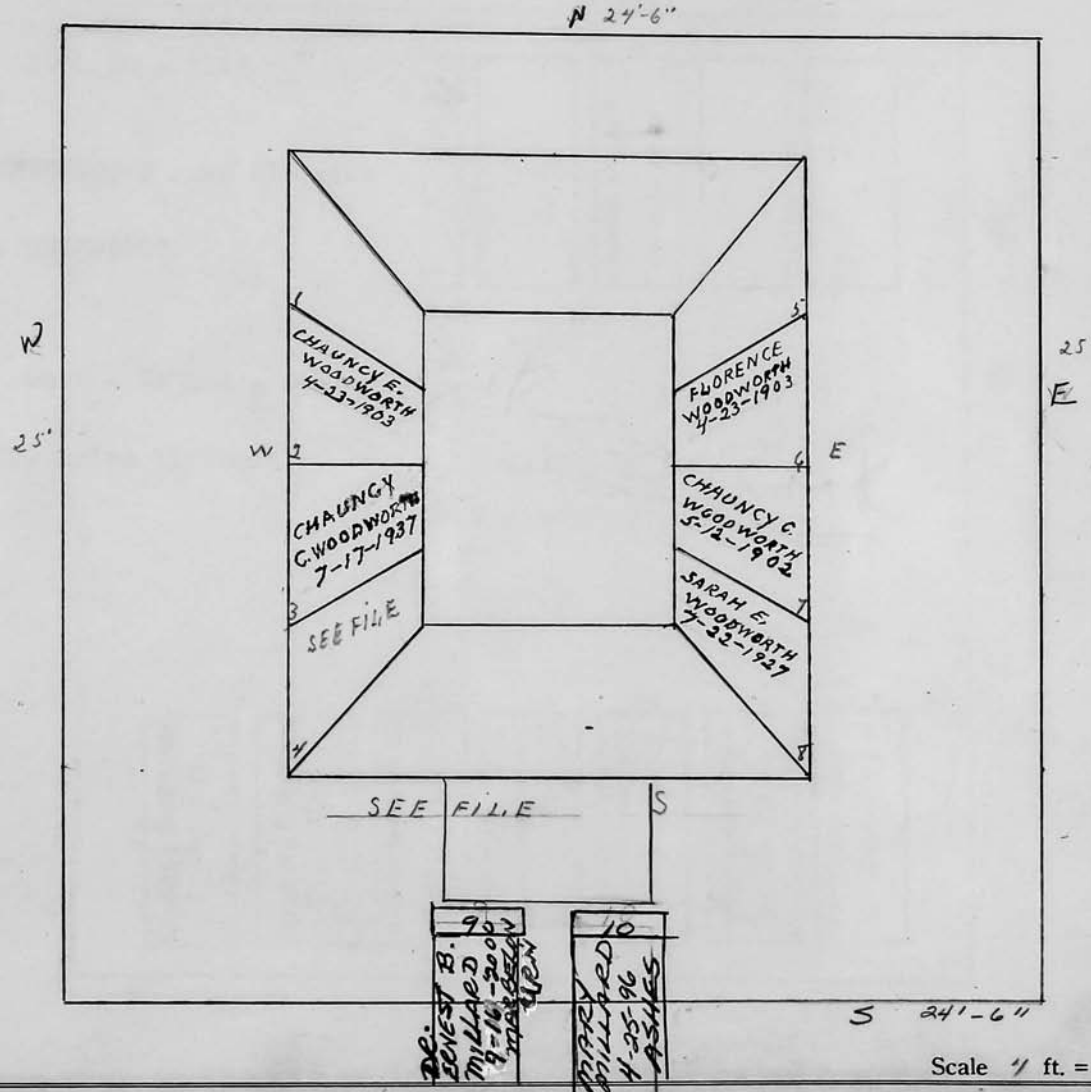

RIVERSIDE CEMETERY, PLOT RECORD

BLOCK
SECTION

G-4

LOT NO.

54

Dennis C Vanderlinde

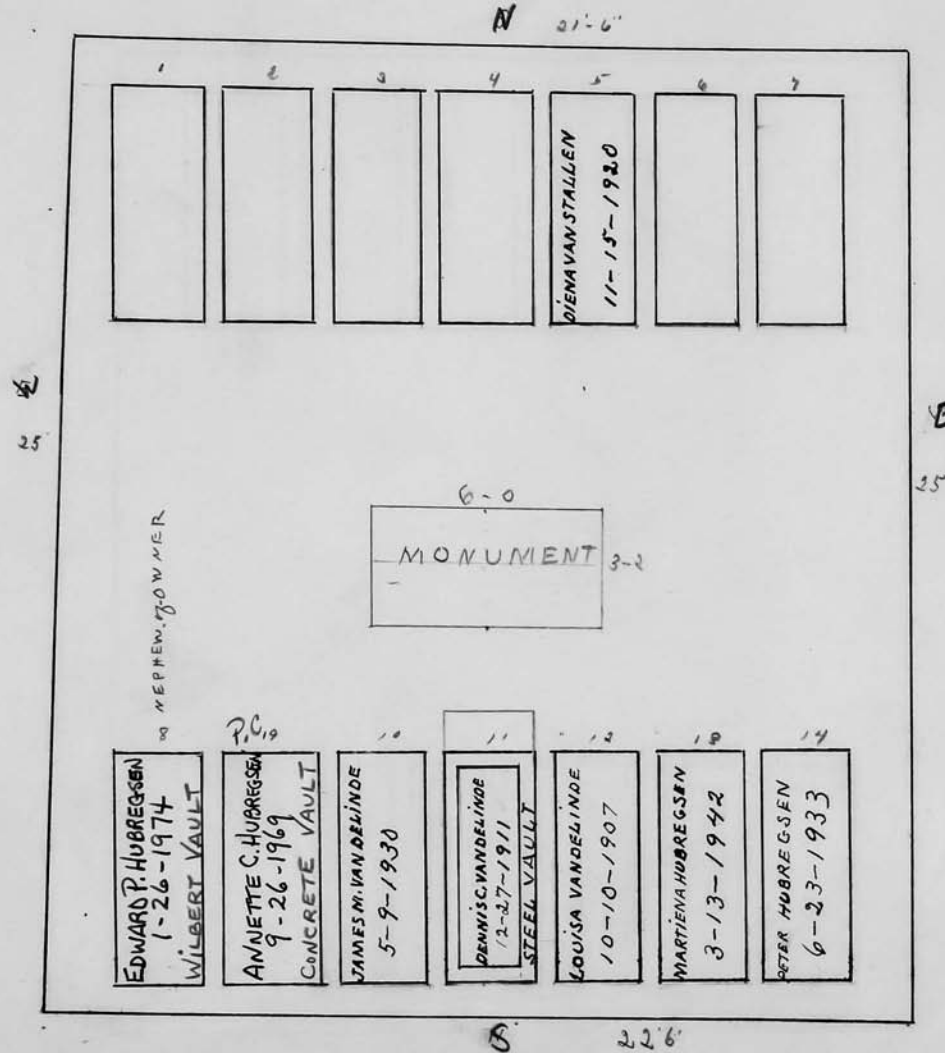

RIVERSIDE CEMETERY, PLOT RECORD

BLOCK
SECTION

G-4

LOT NO.

54

Dennis C Vanderlinde

N 21'-6"

10 - 10 - 1967

RESERVE for - EDWARD P. HUBREGSEN and HIS wife

ANNETTE C. HUBREGSEN

EDWARD is nephew of lot owner - He and a sister
in California are the only heirs living.

EDWARD P. HUBREGSEN
1-26-1974
WILBERT VAULT

ANNETTE C. HUBREGSEN
9-26-1969
CONCRETE VAULT

JAMES M. VANDELINDE
5-9-1930

DENNIS C. VANDELINDE
12-27-1911
STEEL VAULT

LOUISA VANDELINDE
10-10-1907

MARTIENA HUBREGSEN
3-13-1942

PETER HUBREGSEN
6-23-1933

22'-6"

Scale 1/4" ft. = 1 inch

RIVERSIDE CEMETERY, PLOT RECORD

BLOCK SECTION } *G-4* LOT NO. **55**

Lizzie Mason

24' N

26' N

3-10
MONUMENT 2-7

7 8 9 10 11 12

MILDRED A. MASON
6-16-1977
GENESEE

ARTHUR F. MASON
1-24-1936
NORWALK VAULT

LIZZIE MASON
7-21-1945
NORWALK VAULT

SIDNEY ARTHUR
MASON
11-25-1896

21' S

Scale 4 ft. = 1 inch

RIVERSIDE CEMETERY, PLOT RECORD

BLOCK
SECTION

G-4

LOT NO.

56

Gilbert E. and Frank E. Mosher

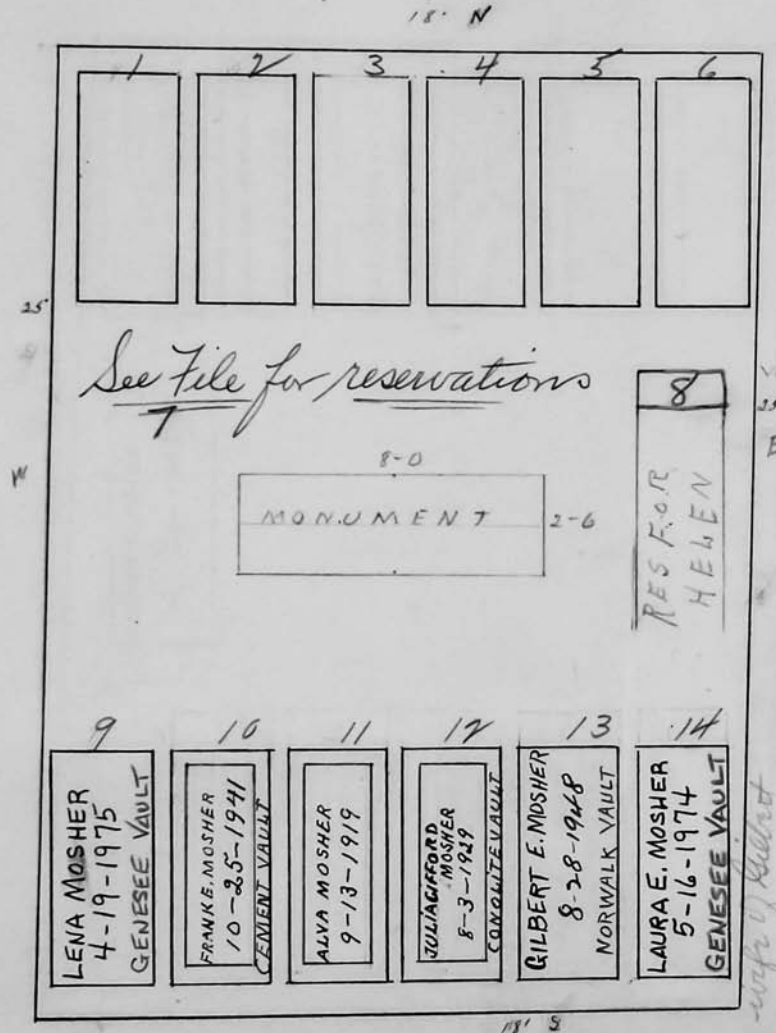

RIVERSIDE CEMETERY, PLOT RECORD

BLOCK
SECTION

G-4

LOT NO.

57

Charles Bergener

PC

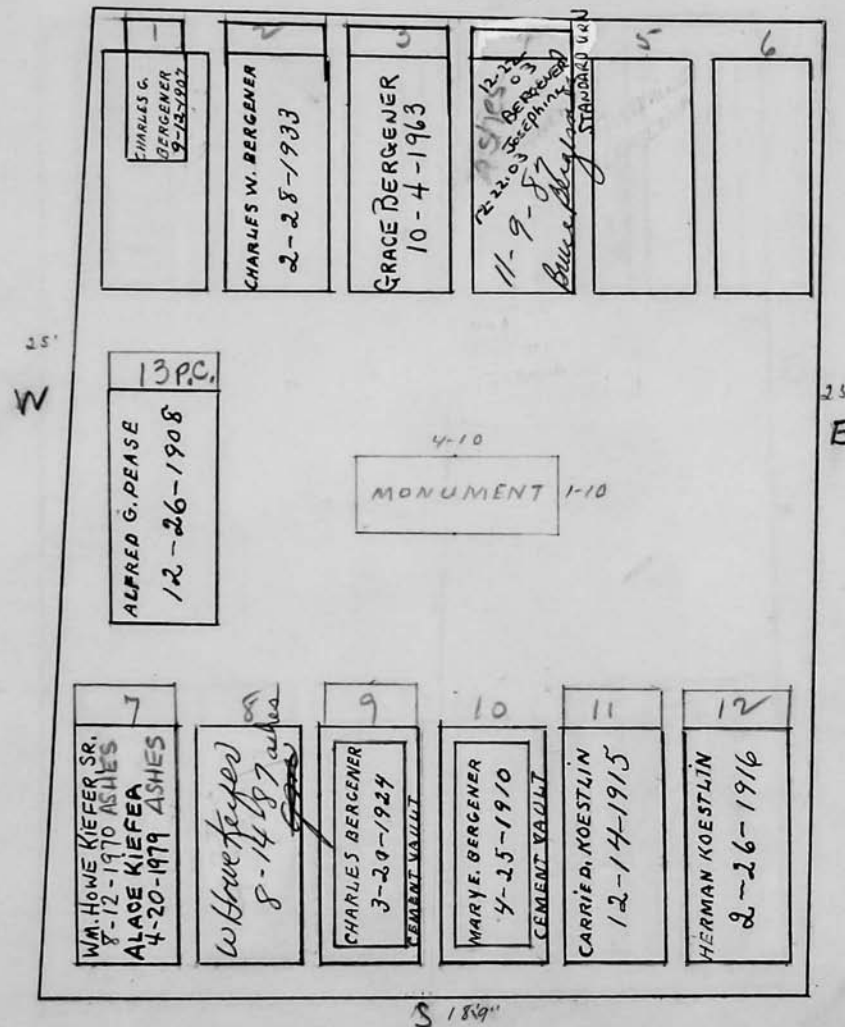

Scale 4 ft. = 1 inch

RIVERSIDE CEMETERY, PLOT RECORD

BLOCK
SECTION

G-4

LOT NO.

58

Edith P. Lunt

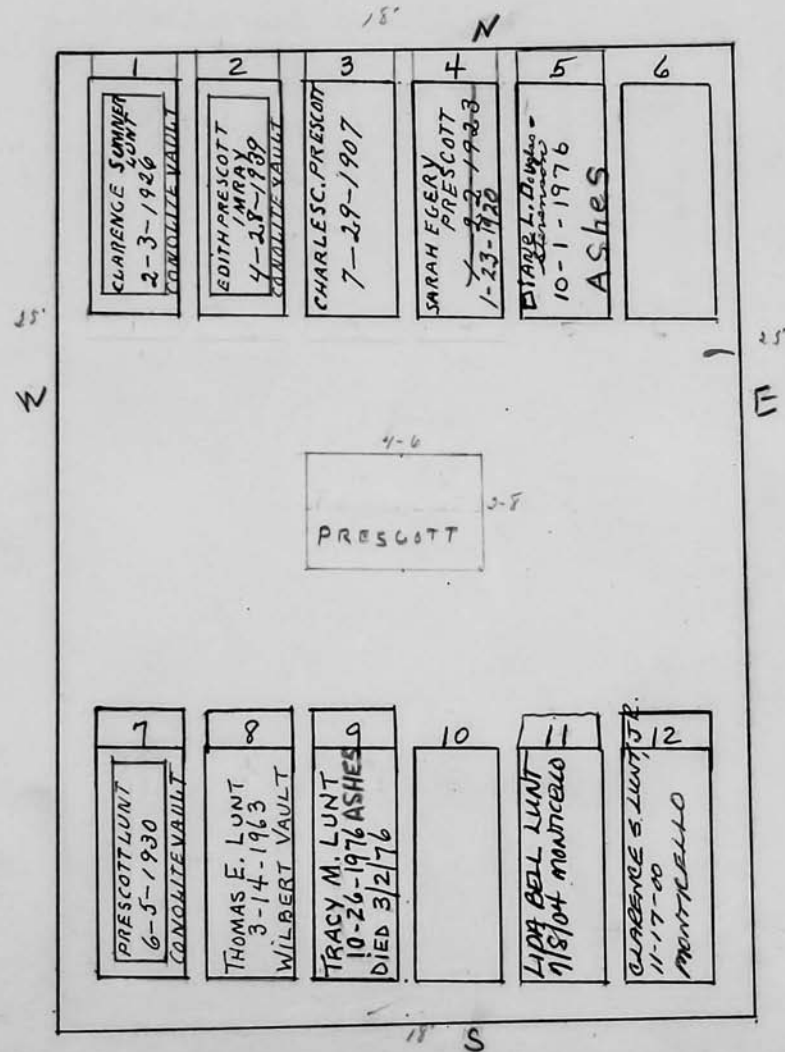

Scale 4 ft. = 1 inch

RIVERSIDE CEMETERY, PLOT RECORD

BLOCK
SECTION

G-4

LOT NO.

59

John William Orphy and Alfred W. Henckell

P.C.

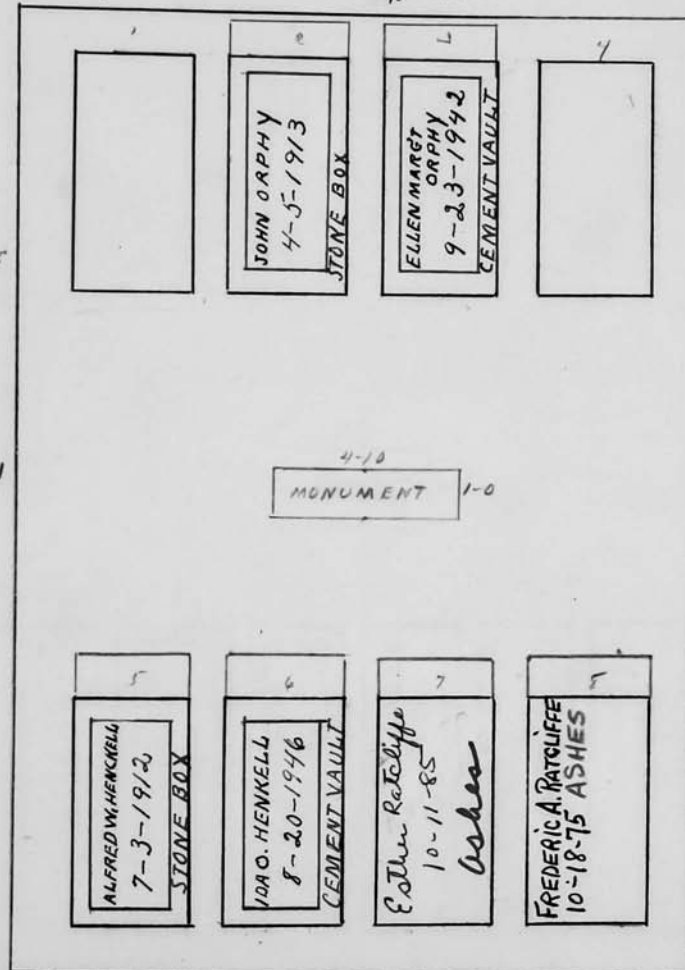

Scale 4 ft. = 1 inch

RIVERSIDE CEMETERY, PLOT RECORD

BLOCK SECTION } G-4 LOT NO. 68

George W. Ingmire and Stella B. his wife

N 15'

25' W

4-0
MONUMENT 2-0

25' E

1	2	3	4	5	6
	GEORGE W. INGMIRE 1-17-1944 CEMENT VAULT	STELLA B. INGMIRE 6-21-1937 CEMENT VAULT	MILDRED S. J. NAGLE 3-7-1958 CONOLITE VAULT	OTIS J. NAGLE 1-3-1944 CEMENT VAULT	

15'

Scale 4" ft. = 1 inch

RIVERSIDE CEMETERY, PLOT RECORD

BLOCK
SECTION

G-4

LOT NO.

69

Jessie S. Robbins

PC

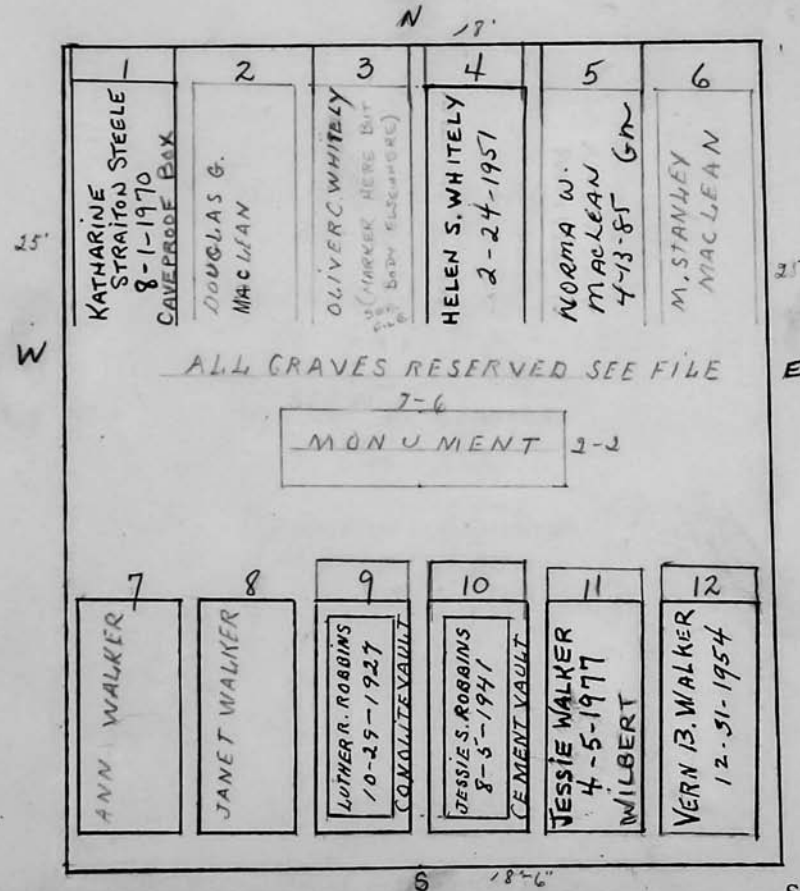

RIVERSIDE CEMETERY, PLOT RECORD

BLOCK
SECTION

G-4

LOT NO.

70

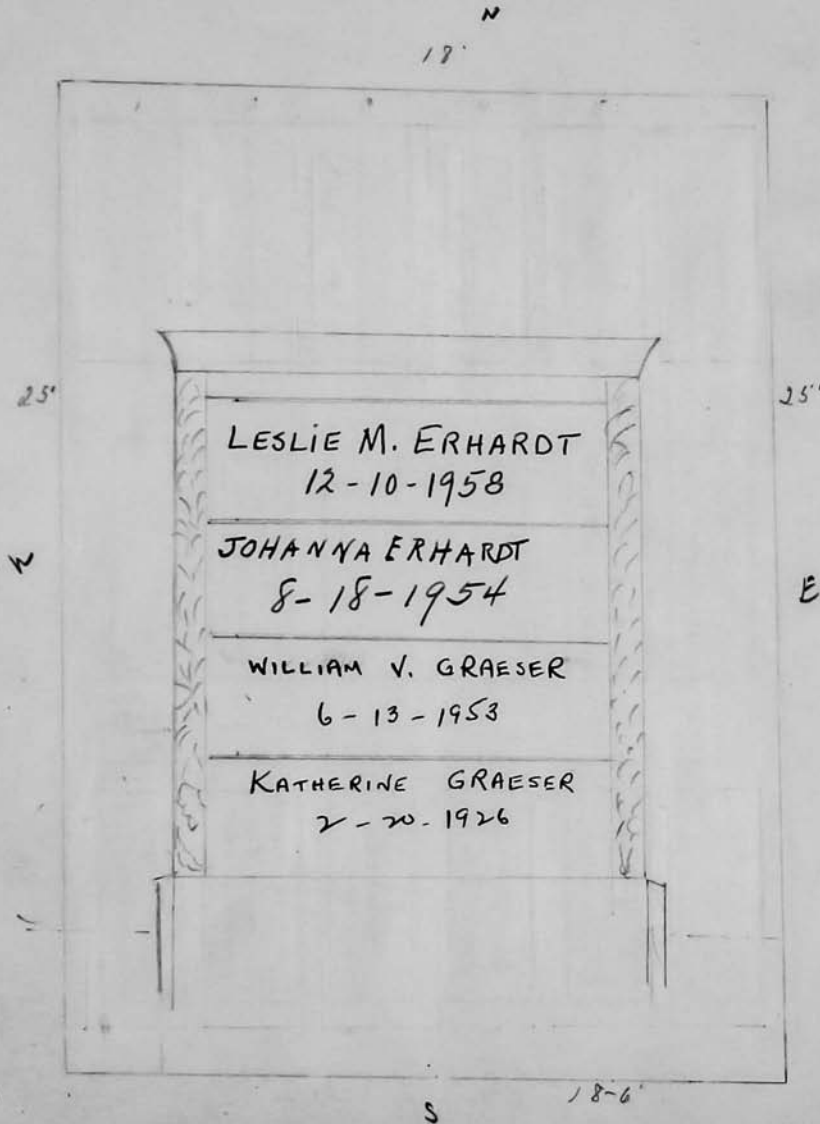
William V. Graeser

Scale 4 ft. = 1 inch

RIVERSIDE CEMETERY, PLOT RECORD

BLOCK
SECTION

G-4

LOT NO.

71

Thomas and Arthur Jameson

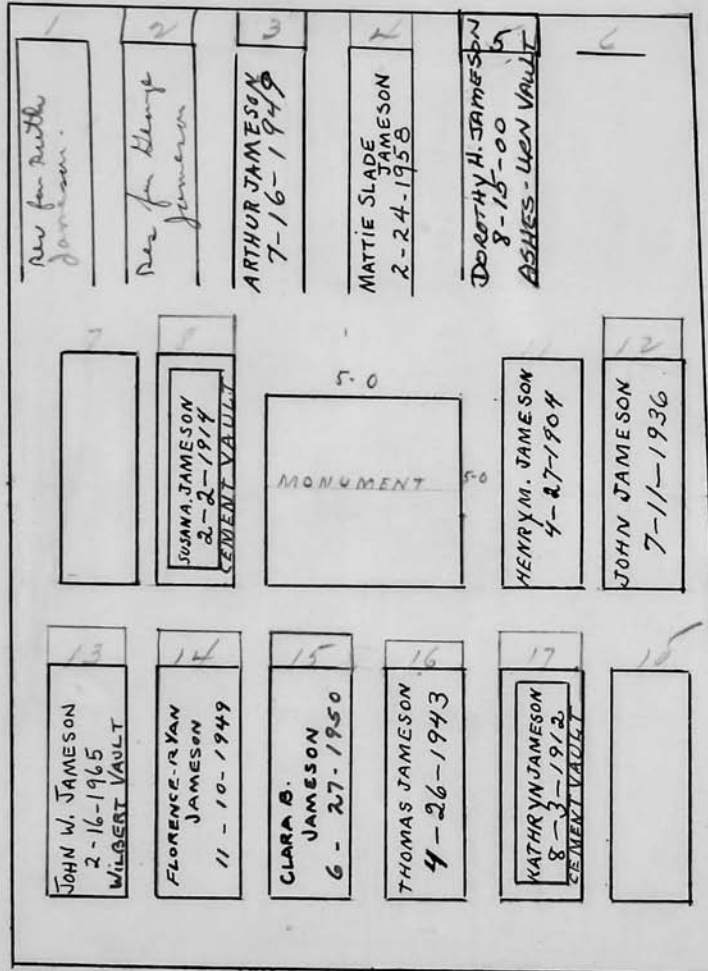

Res. 1-2-5. wide
by Dorothy Jameson-
1-19-1968
Brother & sister-children of
Arthur Jameson.

Scale 4 ft. = 1 inch

RIVERSIDE CEMETERY, PLOT RECORD

BLOCK SECTION } *G-4* LOT NO. **72**

P.C. 742.50

Lewis Chase 1907

Charles Chase

SEE FILE

W 25'

N 18'

E 25'

S 18'9"

4-0

2-0

1	2	3	4	5	6
		EDWARD H. CHASE 1-8-84 CHARLES H. CHASE 11-16-1965 DIED 2/11/64 ASHES	MARY H. HEAD 12-8-1961 ASHES	WARD HEAD 9-2-1909 ASHES	
7	8	9	10	11	12
		CHARLES A CHASE 9-23-1933 ASHES	IDA G. CHASE 8-7-1940 ASHES	MARY E. HESTER 9-15-1977 ASHES	RES ELIZABETH ANN HESTER

MONUMENT

ASHES

MONUMENT

ELIZABETH ANN HESTER

Scale 4 ft. = 1 inch

RIVERSIDE CEMETERY, PLOT RECORD

BLOCK SECTION } G-4 LOT NO. 72

P.C. 742.50

Lewis Chase 1907

Charles Chase

SEE FILE

Chase Plot
Lot 72 - G-4
Great grand son
Charles Chase
607-936-9160
send Copy to him

3	4	5	6
ELPH H. CHASE 1-18-84 CHARLES H. CHASE 11-16-1965 DIED 2/11/64 ASHES	MARY H. HEAD 12-8-1961 ASHES	WARD HEAD 9-2-1969 ASHES	
<p>4-0</p> <p>ASHES LEWIS 7-30-72 MONT ELWING CHASE 7-22-72 ASHES</p> <p>MOVEMENT</p> <p>6-0</p>			
9	10	11	12
CHARLES A. CHASE 9-23-1933 ASHES	IDA G. CHASE 8-7-1944 1940 ASHES	MARY E. HESTER 9-15-1977 ASHES	RES ELIZABETH ANN HESTER

Scale 4 ft. = 1 inch

RIVERSIDE CEMETERY, PLOT RECORD

BLOCK SECTION } *G-4* LOT NO. **73**

Frank W. Lovejoy

N 20'

1 2 3 4 5 6

W 25'

2-0

2-10

LOVEJOY

8-6-97
DR. FRANK ASHES
LOVEJOY, JR.
MOVED FROM
GR. 3 TO GR. 7
7-26-01

7
FREDERICK FULLER
LOVEJOY
6-16-1965
CEMENT VAULT

PC. 9
FRANK WILLIAM
LOVEJOY
9-19-1945
CEMENT VAULT

PC. 10
FLORENCE FULLER
LOVEJOY
10-13-1961
ASHES

PC. 11
HARRIET FULLER
LOVEJOY
4-8-1914
CEMENT VAULT

PC. 12
GEORGE L. LOVEJOY
8-30-1931

GEORGE L. LOVEJOY
8-3-01
WILSON
WILSON

S 40'

Scale 4 ft. = 1 inch

RIVERSIDE CEMETERY, PLOT RECORD

BLOCK SECTION } *G-4* LOT NO. **74**

Est. of Addison R. Baldwin

21' N

1 CHAS. ADDISON BALDWIN 4-24-1918	2 CAROLYN BALDWIN BINGHAM 2-13-1933	3 FRANK E. BALDWIN 6-11-1910	4 ALVIN T. BALDWIN 7-31-1925 STEEL VAULT	5 JAMES B. BINGHAM 5-16-1934 ASHES	6 ESTHER G. BALDWIN 1-17-1954
--	--	------------------------------------	---	---	--

25' W

MONT.

25' E

7	8	9 CAROLINE W. BALDWIN 3-9-1913	10 ADDISON R. BALDWIN 7-15-1896 STONE VAULT	11	12
---	---	--------------------------------------	--	----	----

21' S

Scale 4 ft. = 1 inch

*Esther G. Baldwin
See file*

RIVERSIDE CEMETERY, PLOT RECORD

BLOCK
SECTION

G-4

LOT NO.

75

Charles B. Potter
Mrs. Nathaniel Potter remarried
Now Estelle Z. Burnham 2/4/61

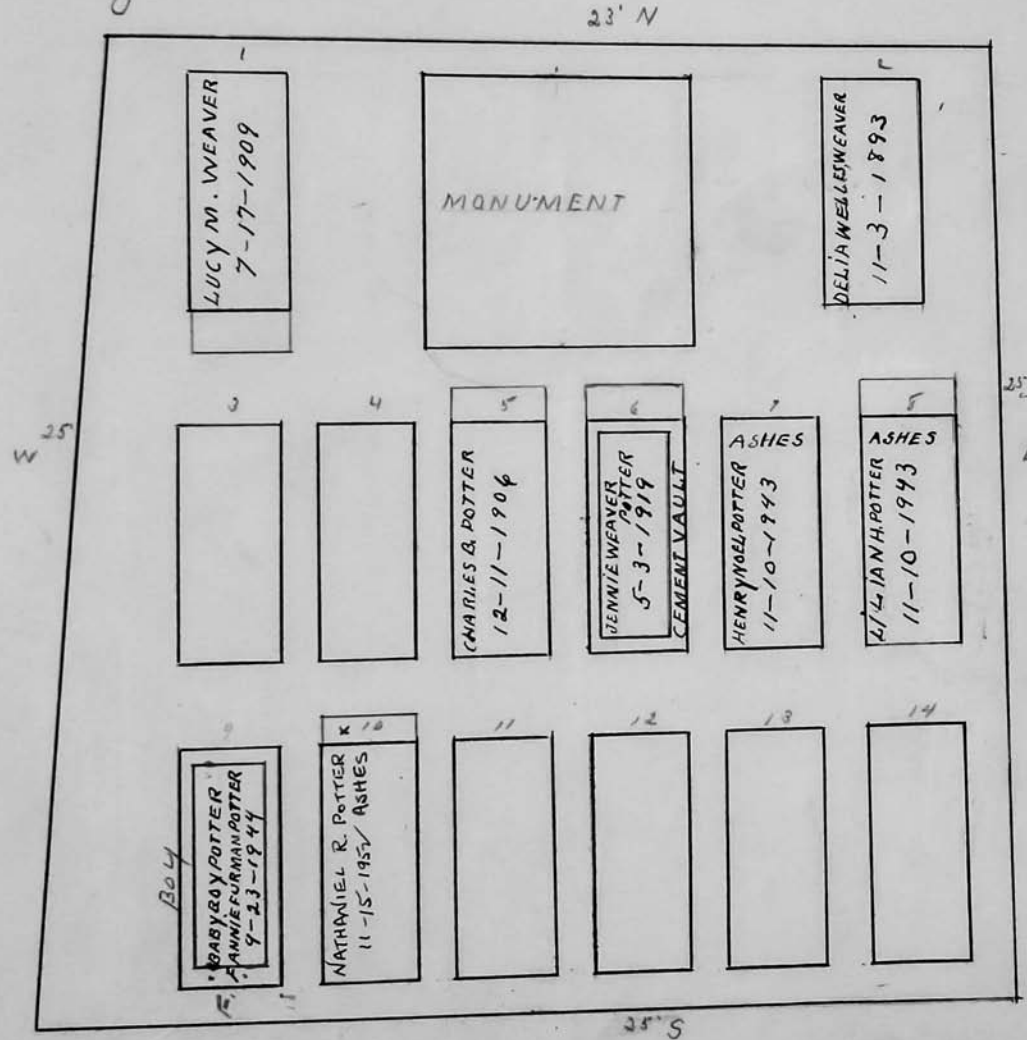

Scale 1/4 ft. = 1 inch

RIVERSIDE CEMETERY, PLOT RECORD

BLOCK
SECTION

G-4

LOT NO.

76

12/10/93
STEVEN SEELY
225-7945
+ RAWKINS
BROTHER & SISTER
ARE SOLE OWNERS
SIGNINGS OK
JAMES M.
SEELY

10/4/88
P.C.

James M. Seely

1	2	3	4	5	6
	JOSEPH T. SEELY 12-18-1913	ELLEN M. SEELY 6-13-1899	JAMES M. SEELY 4-17-1900	LYMAN T. SEELY 5-7-1938	MARGUERITE W. SEELY 7-28-1958
7	8	MONT.		9	10
ELSIE C. SEELY 1-19-1955	JAMES M. SEELY 8-26-1946	SEE FILE		HELEN A. SEELY 2-6-1910 1914	
11	12	13	14	15	16
JAMES M. SEELY 10-13-93 ASHES	C. JEAN SEELY 1-31-91 ASHES	ELIZABETH SEELY 2-18-2010 ASHES	FLORA S. SALMON 9-17-1977 ASHES	WILLIAM H. SALMON 10-16-1965 ASHES	Eleanor S. Salmon 10-11-84 ASHES

Scale 4 ft = 1 inch
Scale 7 ft = 1 inch

RIVERSIDE CEMETERY, PLOT RECORD

BLOCK SECTION } G-4 LOT NO. 77

Genas Westervelt
 11/27/62 TRANS. TO HELENE M. LIPSCOMB
 SEE FILE

11-8' W 4-9' 25'-4' E 18'-4' S, 24'-6'

4-2 MONUMENT 2-6

1	2	3	4	5	6	7	8	9
	EDMUND W. WESTERVELT 9/6/60 ASHES	ASHES ELIZABETH K. WESTERVELT 7-3-1939	MARTHA F. WHITMAN 6-17-1896	GENAS F. WESTERVELT 2-19-1918 CEMENT VAULT	ADELIA P. WESTERVELT 5-6-1931 STEEL VAULT	MARY H. WESTERVELT 8-15-1918		

SEE FILE FOR CORRECT COPY

Scale 4 ft. = 1 inch

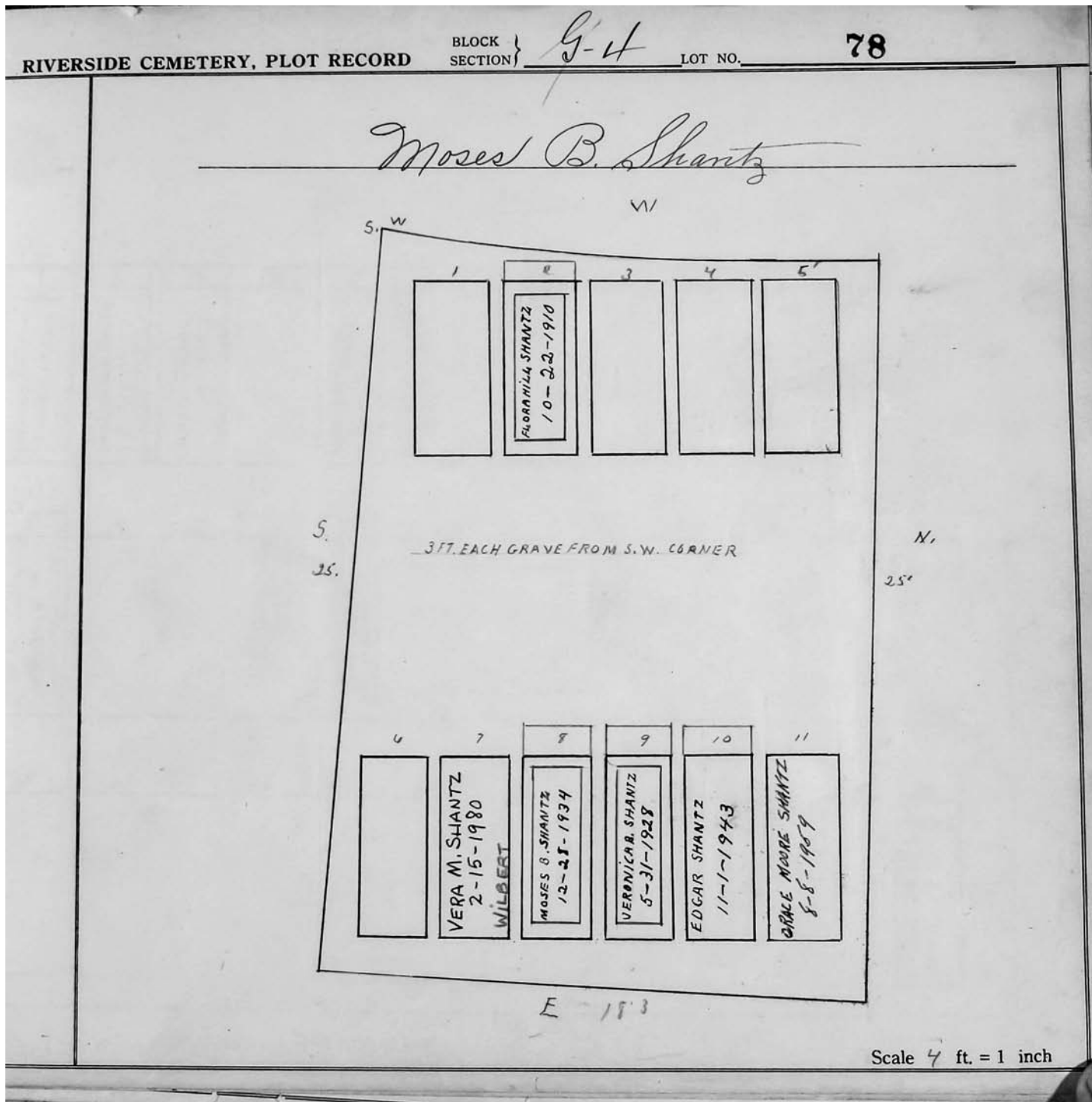

RIVERSIDE CEMETERY, PLOT RECORD

BLOCK SECTION } G-4 LOT NO. 79 + 80

Harvey B. Graves see #80

79 80

P.C. P.C.

35'-6" W

1 HARVEY B. GRAVES 1-16-1936 NO. 3 WALK VAULT	2 CHARLOTTE B. GRAVES 4-20-1924 CONCRETE VAULT	3 EMMA L. GRAVES 4-24-1965 MONARCH VAULT	4	5 CHARLOTTE GRAVES 11-11-1918 CEMENT VAULT	6 HARVEY W. GRAVES 10-23-1973 GENESE VAULT	7 GRAVES MARGARET CROSSA 1-11-1971 GENESE VAULT	8	9	10	11	12
13 RUTH GRAVES 3-3-93 MARRIAGE	14	15	16 MARGARET GRAVES 11-28-1903	17 STANLEY GRAVES 11-28-1903	7-0 MONUMENT		20 JENNIFER GRAVES 11-28-1903 4-2	21	22	23	24
25	26	27	28	29	30	31	32	33	34	35	36 ASHES LOUISAE, DEAN 11-2-1914

35' W

25' N

36' E

Scale 4 ft. = 1 inch

RIVERSIDE CEMETERY, PLOT RECORD		BLOCK SECTION	LOT NO.
		G-4	79+80
<hr/> <p>Harvey B. Graves see #79</p> <p>SEE LOT G-4-79</p> <p>Lot 79+80. one lot.</p>			
Scale ft. = 1 inch			

RIVERSIDE CEMETERY, PLOT RECORD

BLOCK
SECTION

G-4

LOT NO.

81

Edith H. Parkhurst
Mrs. Davis B. Doron daughter } sole heir
Mrs. Arthur D. Hauck granddaughter }
17.6 W

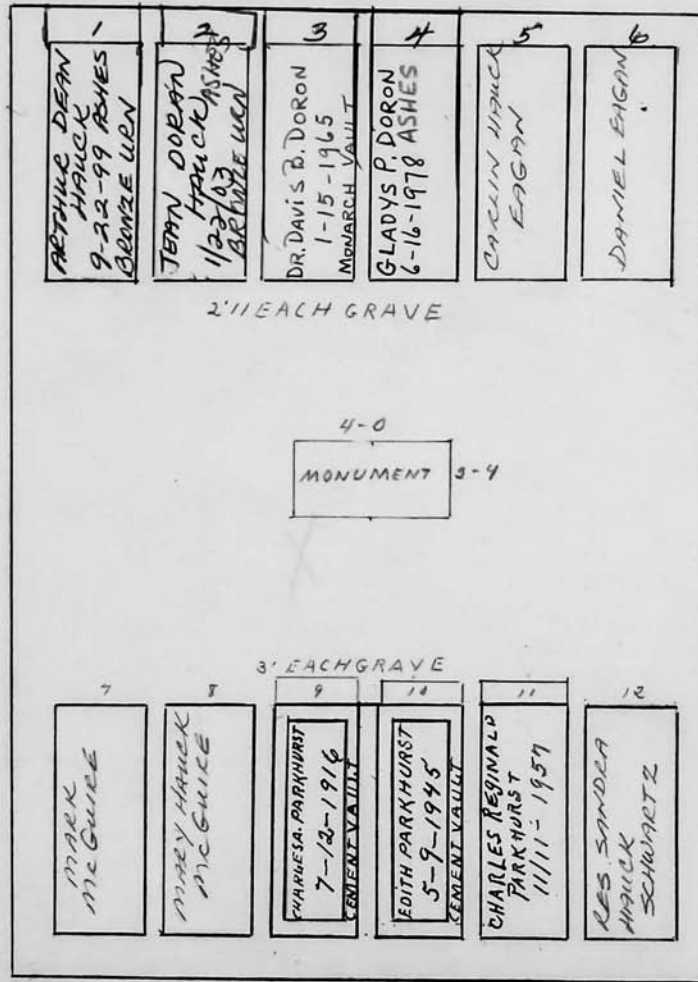

RIVERSIDE CEMETERY, PLOT RECORD

BLOCK SECTION G-4 LOT NO. #82

ANN E. BROCKWAY FLAX

181
Parkhurst

Res. for ground
1, 2, 3, 4
given on plan
by Ann E. Flax
5/13/97 AM.
making notary
letter

all
SOLD
→

1	2	3	4	5	6
RES. FOR DR. MARTIN A. FLAX	RES. FOR ANN E. BROCKWAY FLAX	MARTINER LAMONTE Brockway 6-20-97 ERIE	Shirley E. Brockway 10-13-2011 Idea Bk	SOLD # 13015 # 12952	PAUL J. JONASTON AMY C. JONASTON SOLD # 12952
7	8	9	10	11	12

19.5'

25'-1

E

18.5'

Scale ft. = 1 inch

JOHN C. WOODY CORPORATION, ROCHESTER, N. Y. 412765

RIVERSIDE CEMETERY, PLOT RECORD

BLOCK SECTION 9-4 LOT NO. #83

1	2	3	4	5	6
25' PAULA PINZON 3-13-2013 CHEST	ARACUJO #12952 SOLD 3-8-13	ARACUJO #12952 SOLD 3-8-13	ARACUJO HOLD	MARY KANE on cont. #11688	ARMOND KANE 8-16-08 42" x 26"
7	8	9	10	11	12
THEODORE A. MUNSON 2-14-2005 WOODHURST SOLD - MUNSON TK CONT #9508	DIANE WILSON & ARENE WILSON DE	REGGIE WALTERS 1/14/05 MONTICELLO	LUCAS #12093	RAYMOND INOSTROZA Gravelner 5-4-12 012356	Modesto Inostroza 7/17/2009
13	14	15	16		
SOLD Roper Jarvis #9321 11/12/04	SOLD Roper Jarvis #9321 11/12/04				

19'
 32'5"

WALTERS CANCELLED
 12/13 10/3/07

Scale ft. = 1 inch

G-4 15 & 16
 Contract to be prepared for no payment

JOHN C. MOORE CORPORATION, ROCHESTER, N. Y. 412705

SECTION 7

RIVERSIDE CEMETERY, PLOT RECORD

BLOCK SECTION } *G-4* LOT NO. **84**

Florence P. Martin

P.C.

W

SEE ORDER ON FILE

S *N*

E

12'

16'

12'

1	2	3	4
FREDERICK C. MARTIN 8-23-1944 CEMENT VAULT	FLORENCE P. MARTIN 12-3-1965	MRS. MADELINE HAMILTON	MRS. CHAS. HAMILTON

RIVERSIDE CEMETERY, PLOT RECORD

BLOCK
SECTION

G-4

LOT NO.

85

John R. Smith

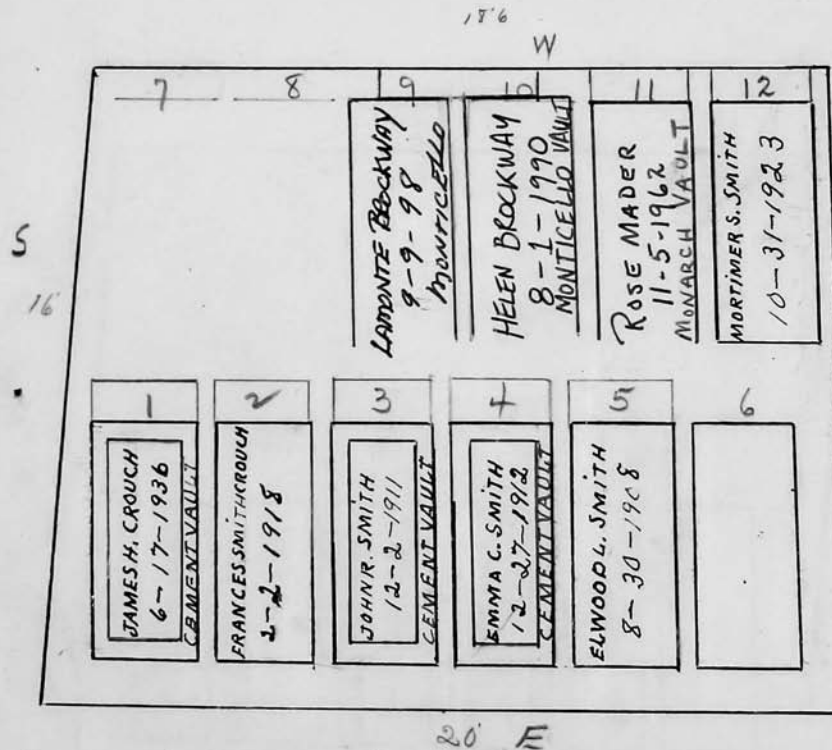

Scale 4 ft. = 1 inch

RIVERSIDE CEMETERY, PLOT RECORD

BLOCK
SECTION

G-4

LOT NO.

86

Anna V. Cornwall
Edward F. Cornwall. sole surviving heir.

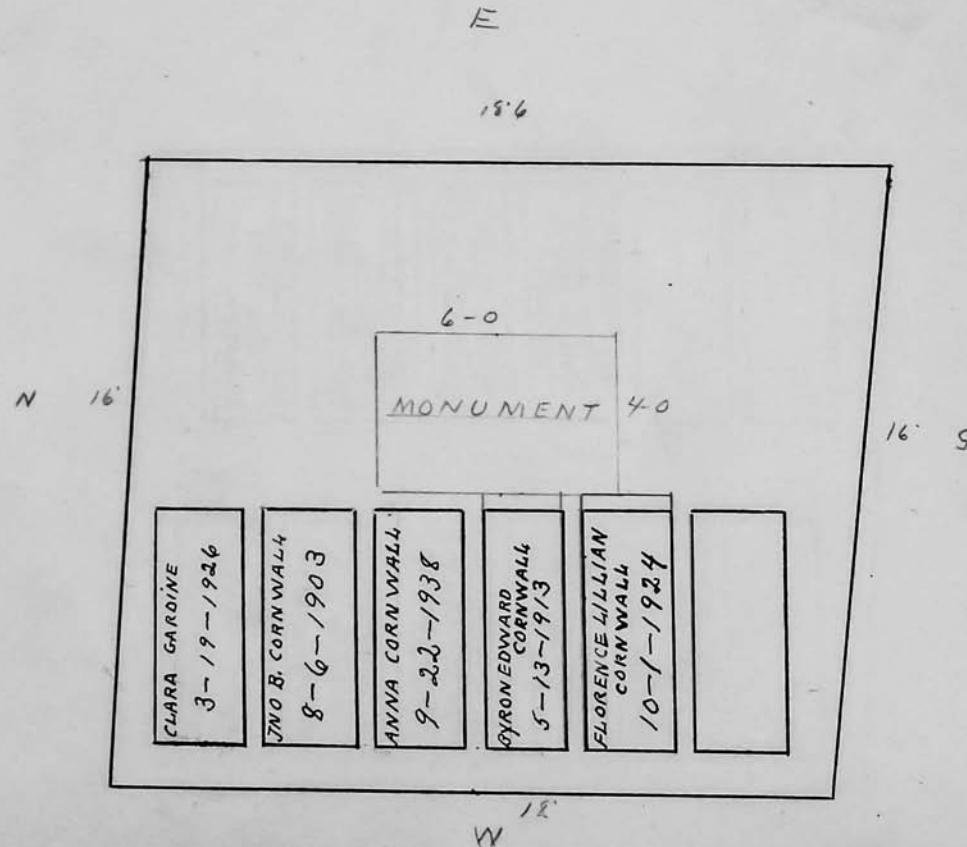

Scale 4 ft. = 1 inch

RIVERSIDE CEMETERY, PLOT RECORD

BLOCK
SECTION

G-4

LOT NO.

87

George S. Benedict & Alice B. Wray
P.C. 88
Arthur B. Edley
Wardson

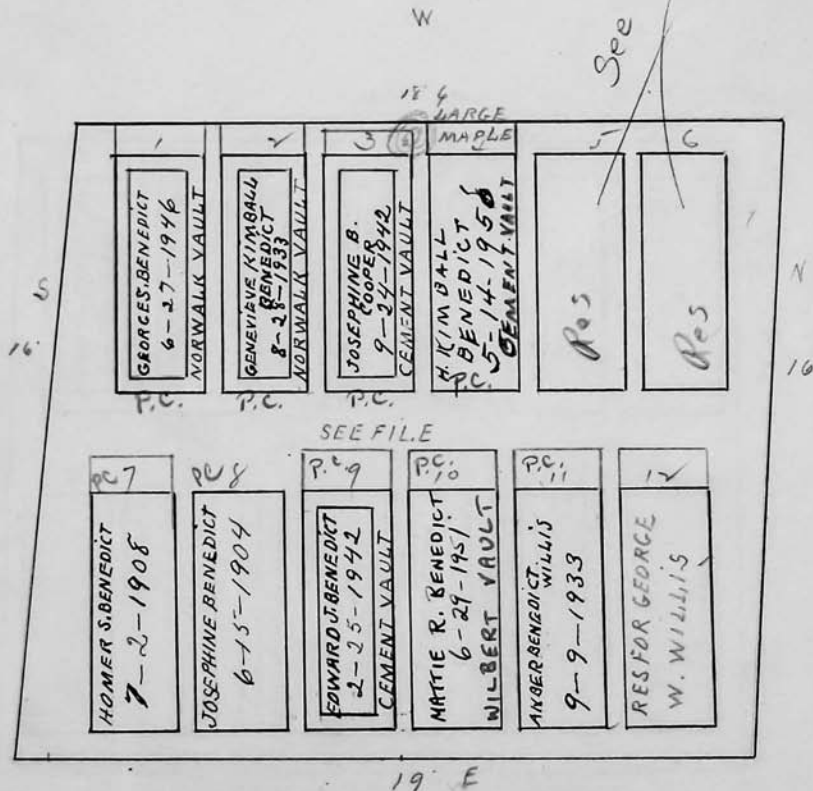

Scale 4 ft. = 1 inch

RIVERSIDE CEMETERY, PLOT RECORD

BLOCK
SECTION

G-4

LOT NO.

88

Georgia A. Mason

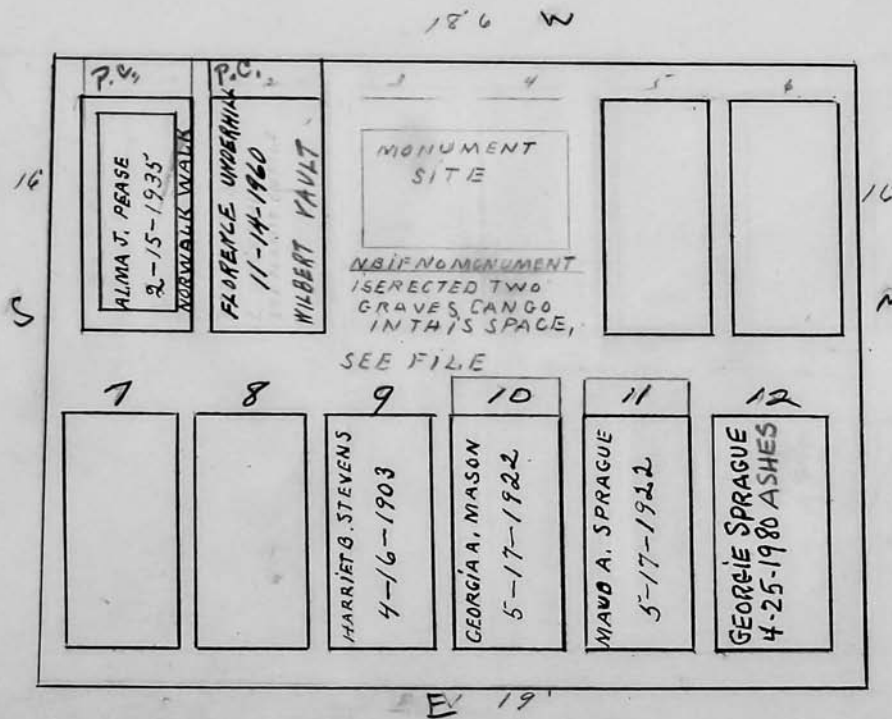

Scale 4 ft. = 1 inch

RIVERSIDE CEMETERY, PLOT RECORD

BLOCK SECTION } *G-4* LOT NO. **89**

Burlew Hill

see file

W

20-4

1 2 3 4 5 6

5

11

14

MONT. 6' 116

7 8 9 10

HENRY M. HILL
6-19-1908

ANNIE BURLEW HILL
12-10-1944
CONCRETE VAULT

BURLEW HILL
2-7-1957
MONARCH VAULT

IDA M. PARKER
1-2-1965

P.C.

13

E

Scale 4 ft. = 1 inch

Helma A. Ensign

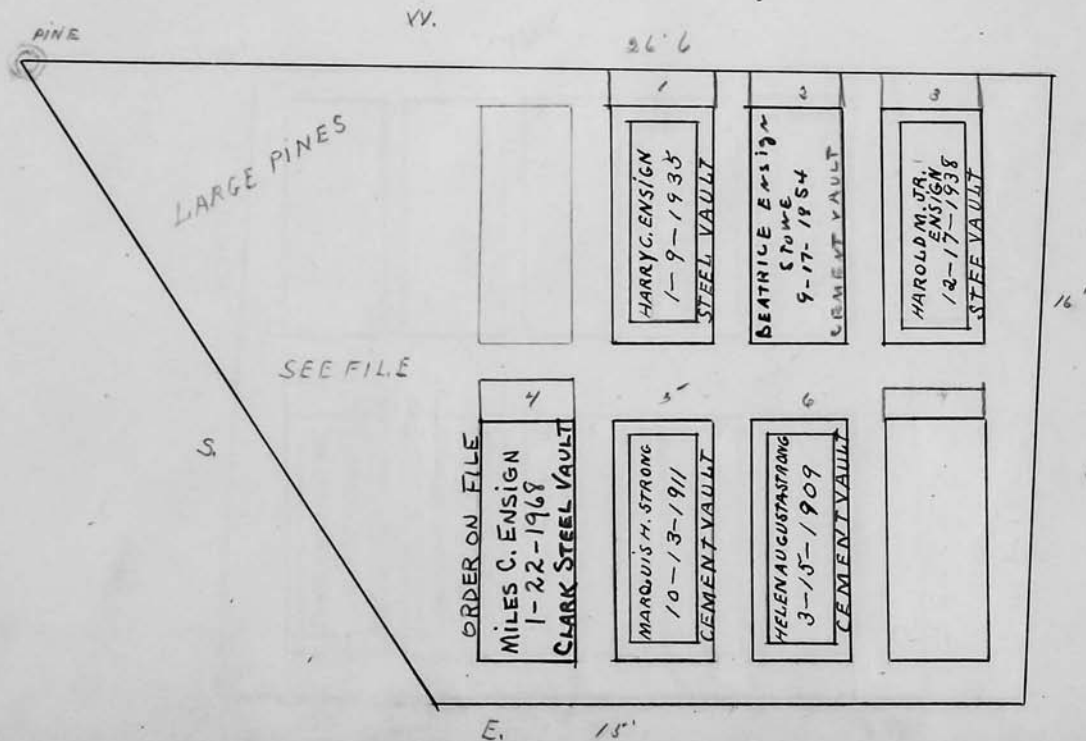

Scale 4 ft. = 1 inch

RIVERSIDE CEMETERY, PLOT RECORD

BLOCK
SECTION

G-4

LOT NO.

91

Louis P. Newton and Mrs. H. C. Bennett

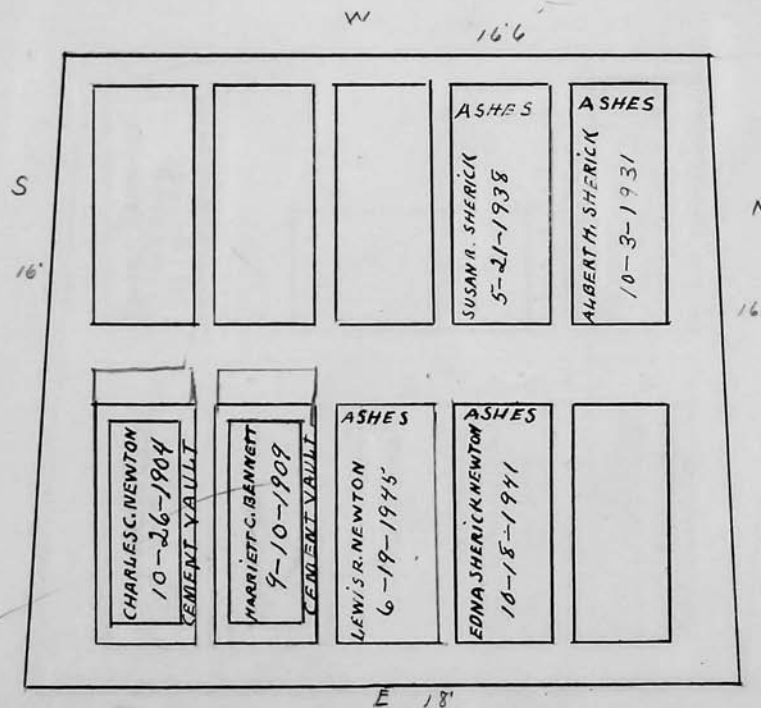

Scale 4 ft. = 1 inch

RIVERSIDE CEMETERY, PLOT RECORD

BLOCK SECTION } G-1 LOT NO. 92

Emily A. Waring

18' 3"

16' 5"

15' 2"

15' 18"

MONUMENT

6
JAMES RANDOLPH
WARING
11-14-1956
MONARCH VAULT

7
ADELAIDE WARING
7-15-89
G.M.

1
JESSIE PRICE WARING
9-8-1961

2
FRANK E. WARING
2-11-1944

3
EMILY A. WARING
10-16-1902

4
ELIAS WARING
6-4-1899

5
INFANT WARING
WILLIE E. WARING
JAMES ARNIE WARING
10-24-1899
BROUGHT FROM INDEPENDENT
BURIED IN ONE BOX

Scale 4 ft. = 1 inch

RIVERSIDE CEMETERY, PLOT RECORD

BLOCK
SECTION

G-4

LOT NO.

93

William L. Thompson

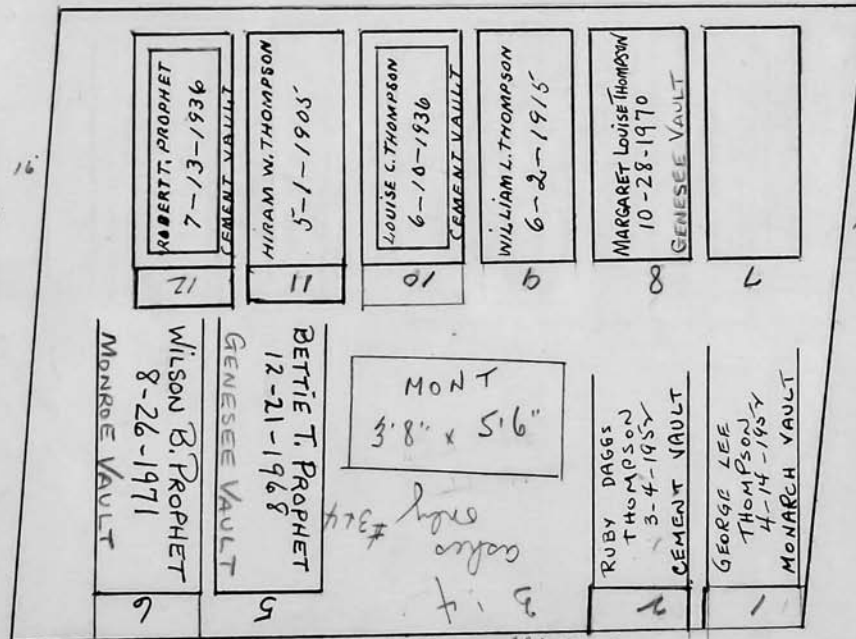

Scale 1/4 ft. = 1 inch

James J. and Hiram J. Kishlar

ORDER ON FILE

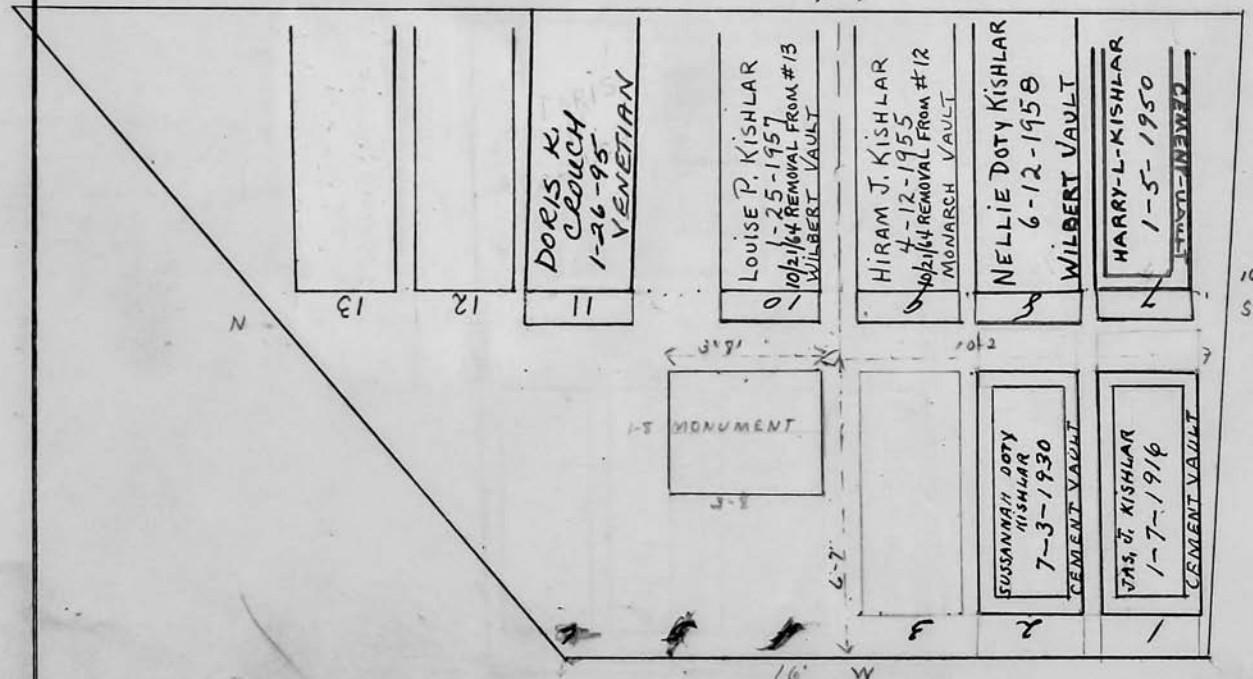

Scale 4 ft. = 1 inch

RIVERSIDE CEMETERY, PLOT RECORD

BLOCK
SECTION

G-4

LOT NO.

95

Marie Nelson Yates

IN MONT. FOUNDATION -
ASHES OF
RUSSELL P. YATES
5-18-1949
DIED 3/31/1944 - 66 YRS.

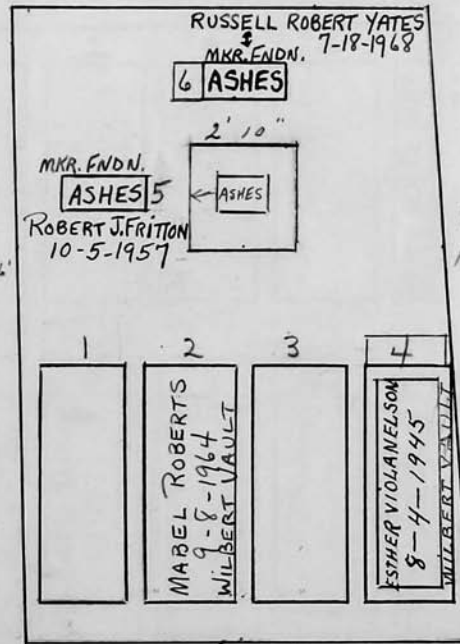

Scale 4 ft. = 1 inch

RIVERSIDE CEMETERY, PLOT RECORD

BLOCK
SECTION

G-4

LOT NO.

96

Pomeroy P. Dickinson

1	2	3	4	5	6
				HARRY M. GLOVER ASHES - 6-14-1948 ELIZABETH M. GLOVER 3-1-1949	
SEE FILE FOR LETTER RELATIVE TO THESE GRAVES					
7	8	9	10	11	12
CARRILL HOWARD TAYLOR 4-18-1954 CEMENT VAULT	POMONA D. TAYLOR 6-14-1979 ASHES	POMEROY P. DICKINSON 1-27-1919	EMMA M. DICKINSON 8-25-1942 CEMENT VAULT	ESTHER WELLES DICKINSON 4-15-1912	

E 196

Scale 4 ft. = 1 inch

RIVERSIDE CEMETERY, PLOT RECORD

BLOCK SECTION } *G-4* LOT NO. **97**

Caroline M. Parkinson

18'

6'

3'6"

16'

1

2

3

4

5

BENJAMINE S. HEBARD 12-4-1899	ELLEN P. HEBARD 8-13-1953 WILBERT VAULT	CHARLES R. PARKINSON 7-16-1896 STONE VAULT	CAROLINE M. PARKINSON 7-31-1909 CEMENT VAULT	HENRY A. HEBARD 87 2-1950
----------------------------------	---	--	--	------------------------------

Scale 4 ft. = 1 inch

RIVERSIDE CEMETERY, PLOT RECORD

BLOCK SECTION } G-4 LOT NO. 98

Dean Alvord.

W 17'6"

S

16

10 9 8 7

MONUMENT SPACE

6 5 4 3 2 1

MARY ALVORD
10-28-1892

MILDRED ALVORD
5-9-1898

NELLIE BARNUM ALVORD
7-15-1935

DEAN ALVORD
6-4-1941

EVERETT ALVORD
CONWAY
7-8-1964

ASHES

ASHES

ASHES

ASHES

ASHES

ELIZABETH C. BARNUM
9-10-1912

N

16

E 19

Scale 4 ft. = 1 inch

RIVERSIDE CEMETERY, PLOT RECORD

BLOCK
SECTION

G-4

LOT NO.

100

son - Frank B. Mehlenbacher
36 Bronshire Ct.
Pinfield, N.Y.

Frank A. Brownell

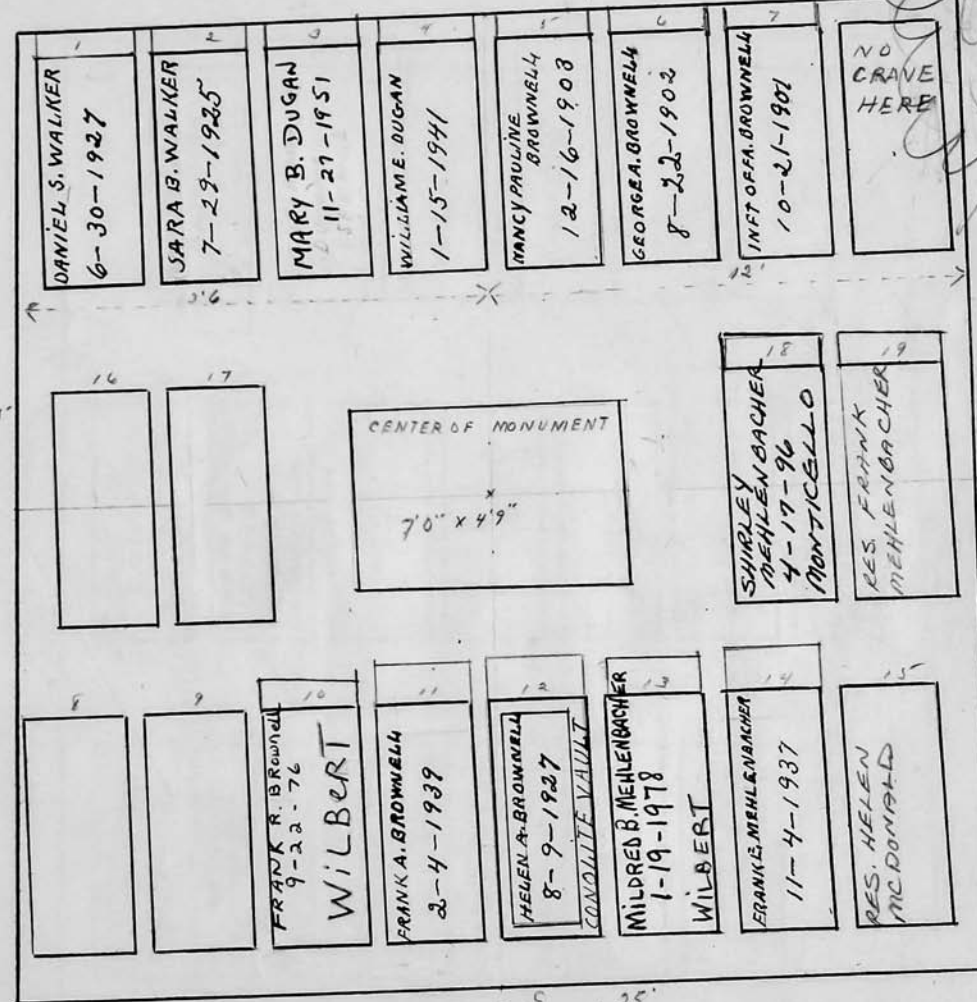

Scale 4 ft. = 1 inch

RIVERSIDE CEMETERY, PLOT RECORD

BLOCK
SECTION

G-4

LOT NO.

101

Lewis V. Rathbun and Ambrose E. Sawyer

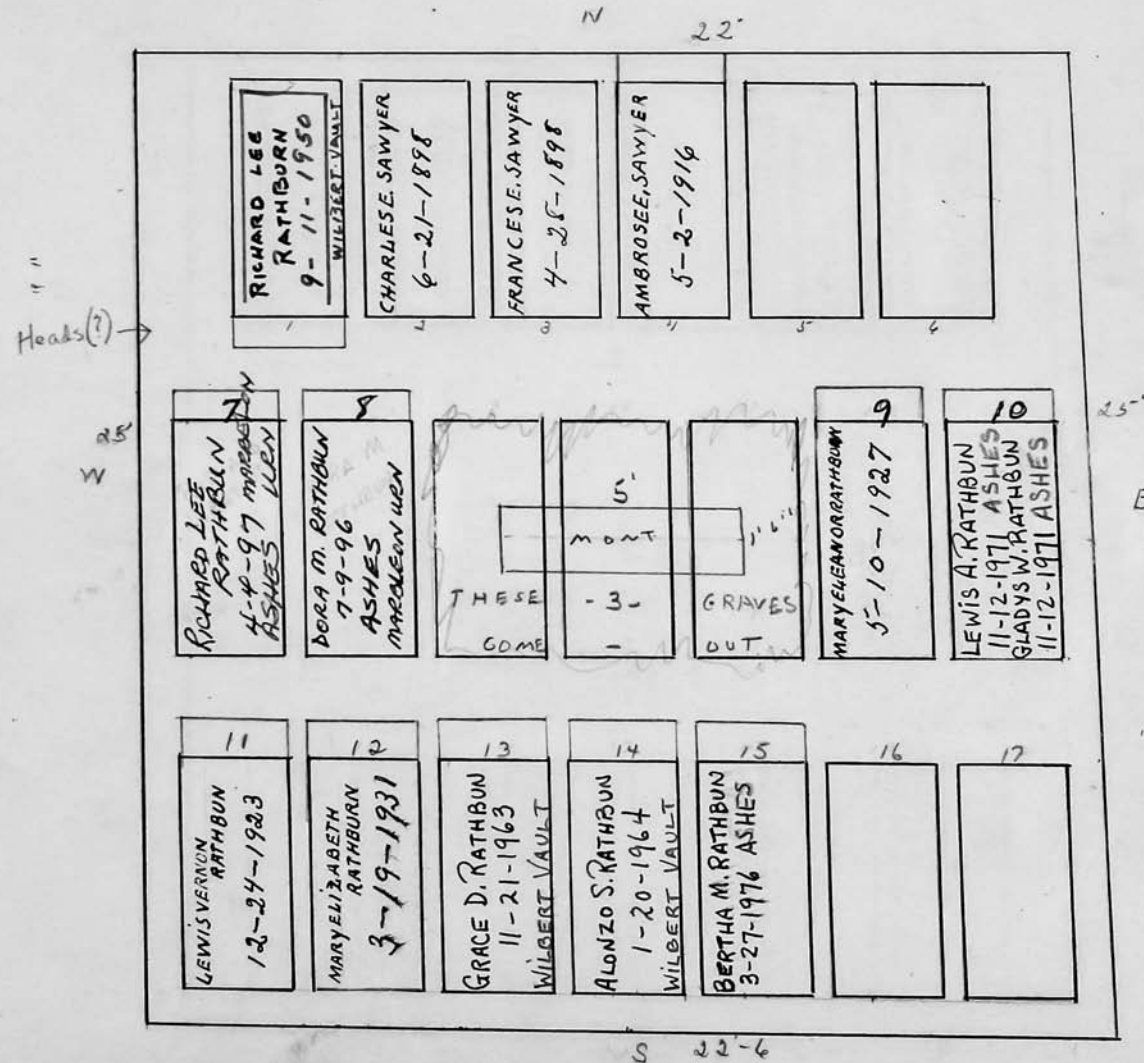

Scale 4 ft. = 1 inch

RIVERSIDE CEMETERY, PLOT RECORD

BLOCK
SECTION

LOT NO.

102

Ida G. Smith

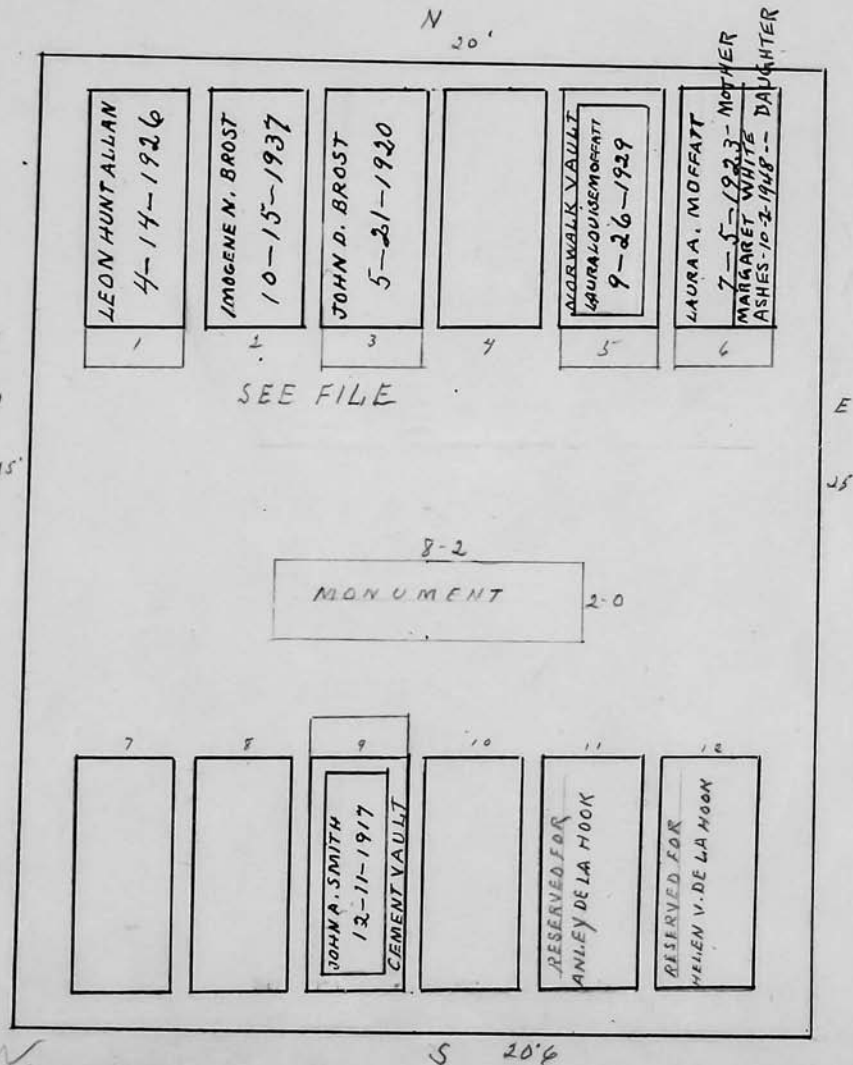

Lee Bill Hedges

Scale 4 ft. = 1 inch

© 2013 Riverside Cemetery Published with permission.

LOT G-5

<u>Lot #</u>	<u>NAME</u>	<u>MONUMENT/MARKER</u>
15	MALDONADO	MONUMENT
19	BRINKER	MARKER
22	HOWE	MARKER
23	SMITH	MONUMENT
24	ARROYO	MARKER
51	JENNINGS	MONUMENT
54	LESTER	MONUMENT
72	BROWN	MARKER
73	NICHOLS	MONUMENT
74	ROWELL	MONUMENT
75	DAVIS/DAY	MARKER
76	MCDONALD	MARKER
77	BUCHHOLZ	MARKER (GR#1-7 AVAIL)
78	TODD	MARKER

RIVERSIDE CEMETERY, PLOT RECORD		BLOCK SECTION	LOT NO.
		G-5	14
<p>Subdivided</p> <p>See map 9-14-06</p>			
Scale ft. = 1 inch			

RIVERSIDE CEMETERY, PLOT RECORD

BLOCK
SECTION

G-5

LOT NO. 15

N
↑

9.5 x 25
237.5
51 ft

DO NOT SEPARATE
#1-3
1 Moni. allowed
9.2'

REYNALDO A. MALDONADO
on contract
10/25/96 PIF

SEE
FOLDER
FOR RESTRICTIONS

9.5 x 25
237.5
51 ft

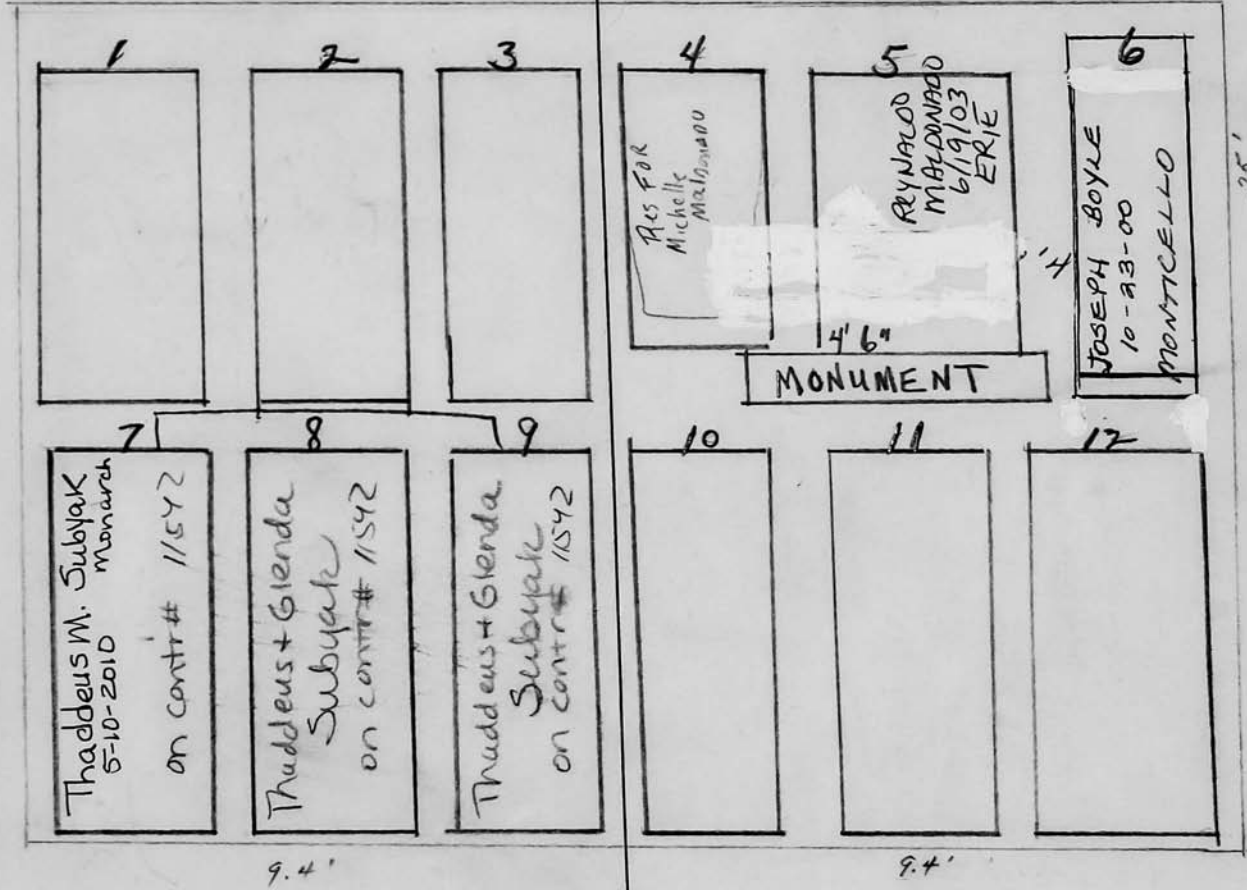

ROADWAY
↓

Scale ft. = 1 inch

RIVERSIDE CEMETERY, PLOT RECORD

BLOCK SECTION } **G-5** LOT NO. **# 16**

1 **2** **3** **4** **5** **6**

7 **8** **9** **10** **11** **12**

SOGA
CARDWELL
11728

SOLD
Cardwell
Family
oversize
cost 1 1/2 graves
@ \$1450
11728

TYREK CARDWELL
5-16-2008
MAMMOTH
@ \$1475

SOLD
S. JACKSON
11786
7-11

LARRY JACKSON
10-11-2011
GRAVEINDER

JANUEL SCOTT
9-10-2008
GRAVEINDER

5 **18'8**

18'2 **18'**

Scale ft. = 1 inch

JOHN C. MOORE CORPORATION, ROCHESTER, N. Y. 412765

RIVERSIDE CEMETERY, PLOT RECORD

BLOCK
SECTION

35

LOT NO.

17

18'2"

1	2	3	4	5	6
<p>Lisa Hold Jackson</p> <p>7</p> <p>9/28/11 Lisa Jackson</p>	<p>Hold Cadwell</p> <p>8</p> <p>Lisa Hold Jackson</p>	<p>Hold for Cardwell 9/28/2011</p> <p>9</p>	<p>ANGELA KIRKLAND 10-3-2011</p> <p>10</p>	<p>0</p> <p>RDWELL</p> <p>#11728</p> <p>11</p>	<p>12</p> <p>Hold Sheila 10-6-2011 Jackson</p>

25'

Scale ft. = 1 inch

RIVERSIDE CEMETERY, PLOT RECORD

BLOCK SECTION } G-5 LOT NO. 18

Check map subdivided 9-14-06

N	18'7"				N		
W	<u>1</u>	<u>2</u>	<u>3</u>	<u>4</u>	<u>1</u>	<u>2</u>	E
	\$4,000				\$2,000		
25'							25'
	<u>1</u>	<u>2</u>	<u>3</u>	<u>4</u>	<u>1</u>	<u>2</u>	
	\$4,000				\$2,000		
W							E
S	19'6"						S

Scale ft. = 1 inch

RIVERSIDE CEMETERY, PLOT RECORD

BLOCK
SECTION

G-5

LOT NO.

19

Henry Brinker

W

N

5' 5"

25'

E

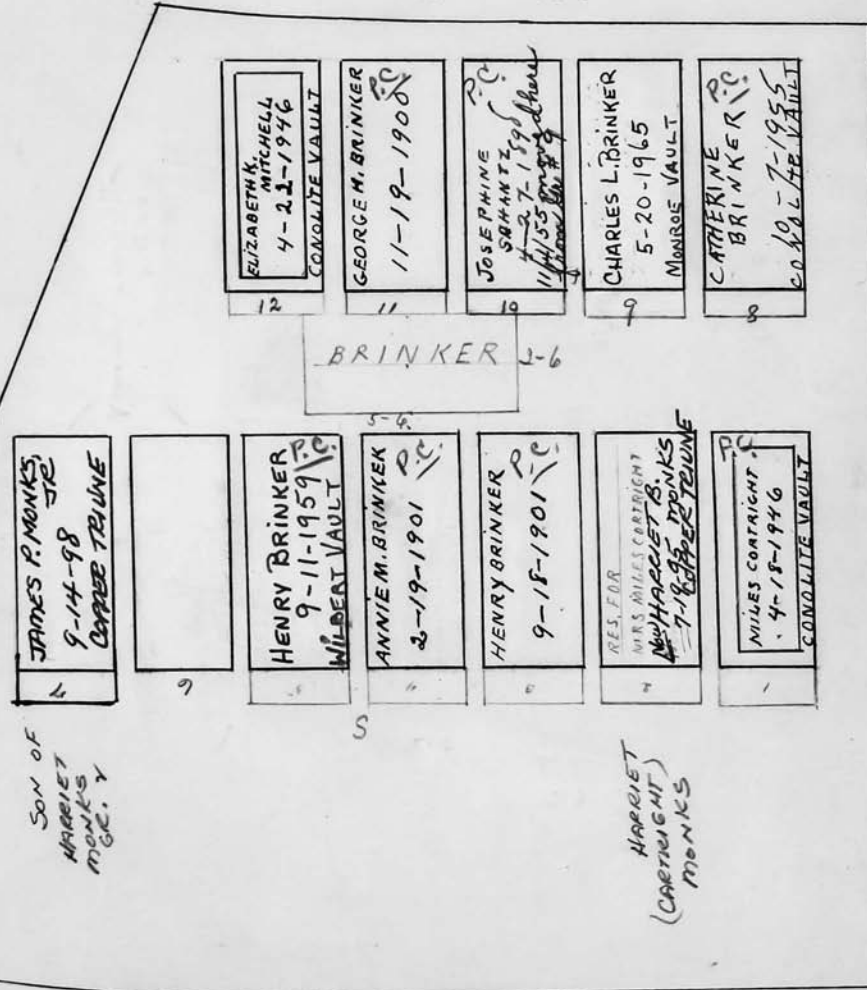

SON OF
HARRIET
MONKS
M.C. Y

HARRIET
(CARTRIGHT)
MONKS

Scale 1/4 ft. = 1 inch

RIVERSIDE CEMETERY, PLOT RECORD

BLOCK
SECTION

G 5

LOT NO.

22 S.P.T.

Gordon A. and Lois S. Howe
(Also N.P.T. 22-G-5)

S

E

W

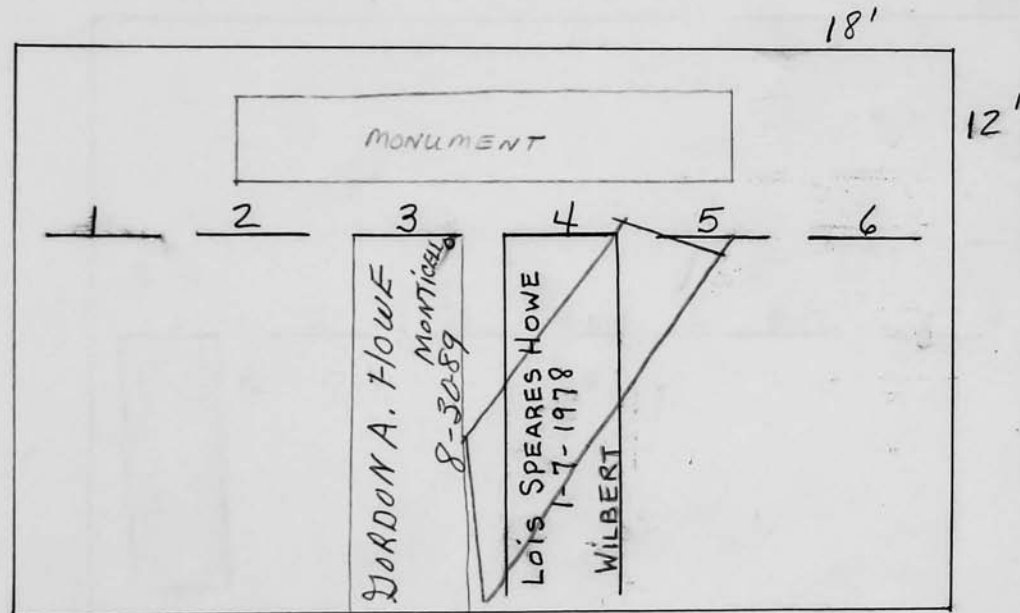

NOTE: GRAVE #5
CANNOT BE USED, UNLESS
#6 IS MOVED OVER.

N

Scale 3 ft. = 1 inch

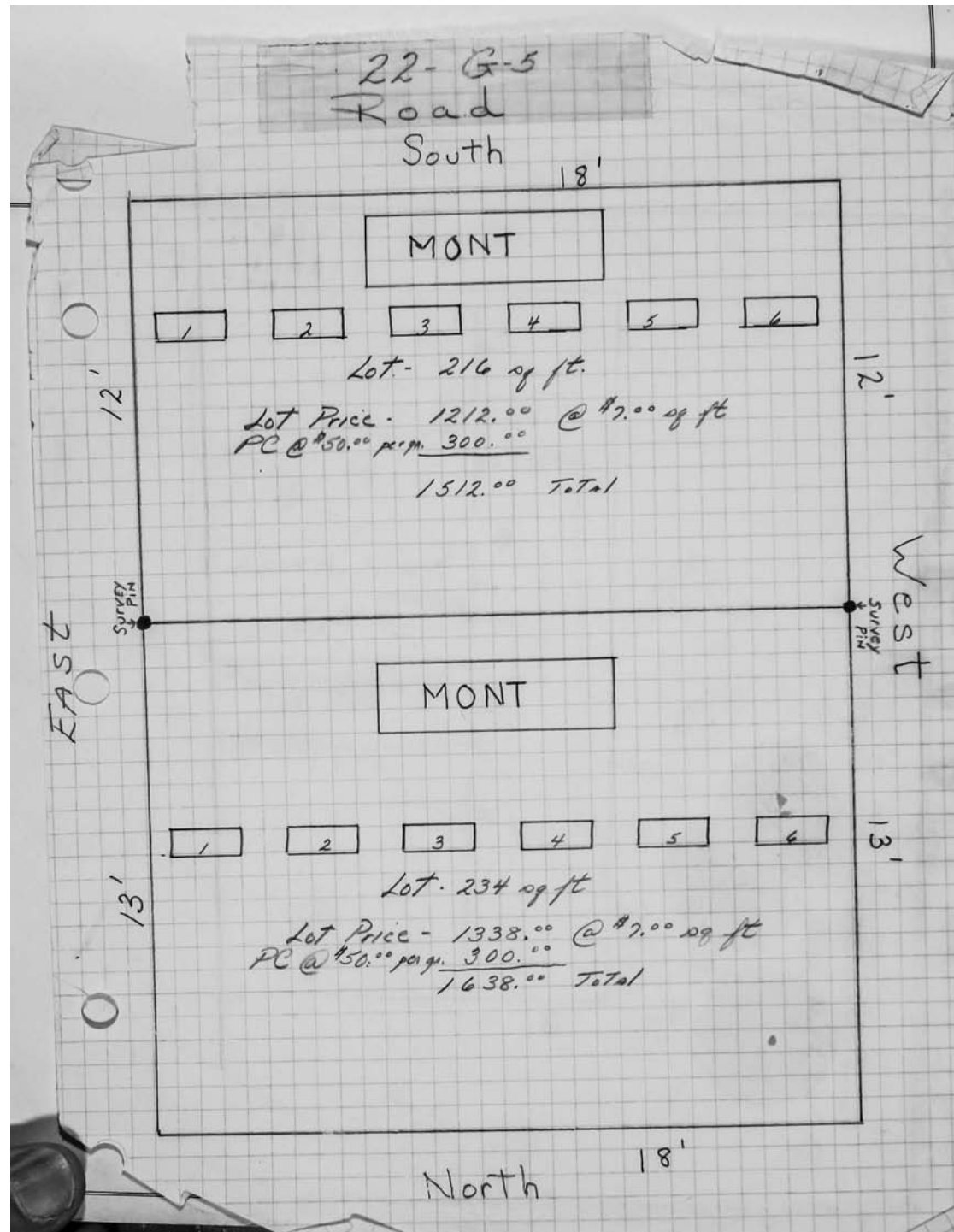

RIVERSIDE CEMETERY, PLOT RECORD

BLOCK
SECTION

G 5

LOT NO.

22

N.P.T.

Gordon A. Howe

(See S.P.T. 22-G-5)

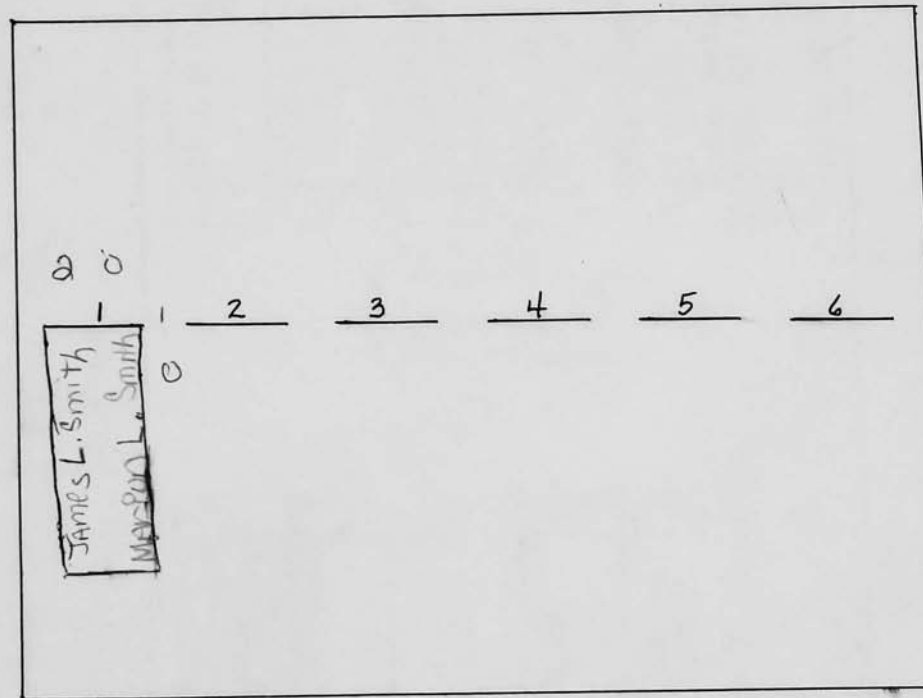

Scale ft. = 1 inch

RIVERSIDE CEMETERY, PLOT RECORD

BLOCK
SECTION

G-5

LOT NO.

23

SURVIVING
SONS

ROSS H. SMITH
771 COUNTRY CLUB DR
CARMEL VALLEY
CA 93924

FRANK P. SMITH MD
P.O. BOX 367
PLEBE BEACH
CA 93953
(408) 624-7640

Graves left
to be res.
for Marion Smith
& James Smith

JULIA O. PYE 3-26-1956	JESE PYE 4-14-1934	FRANK PYE 8-3-1919 STEEL VAULT	BARBARA CHERYL SMITH 9-2-1950	FRANK ROSS SMITH 18-29-1953	CORA PYE SMITH 12-10-1955 MONARCH VAULT
21	11	01	6	3	6

9' 0" MONUMENT 1' 8"

JAMES L. SMITH 10-23-00 CREMATORY URN MARION L. SMITH 1-18-2002 FINAL URN	ROSS SMITH ASHES 6-25-98 CREMATORY URN	Remains of CHILDREN OF ROSS H. SMITH	RUTH F. SMITH 7-21-94 ASHES	FRANK P. SMITH 11-10-03 ASHES HUSBAND OF RUTH	Remains of CHILDREN OF FRANK P. SMITH
1	2	3	4	5	6

Remains of
SMITH MD
6/24/98

Remains of
SMITH MD
6/24/98

Scale 4 ft. = 1 inch

RIVERSIDE CEMETERY, PLOT RECORD

BLOCK
SECTION

G-5

LOT NO.

24

9/5/96
ADELINA
LAGARES
Cancelled
for non-
payment

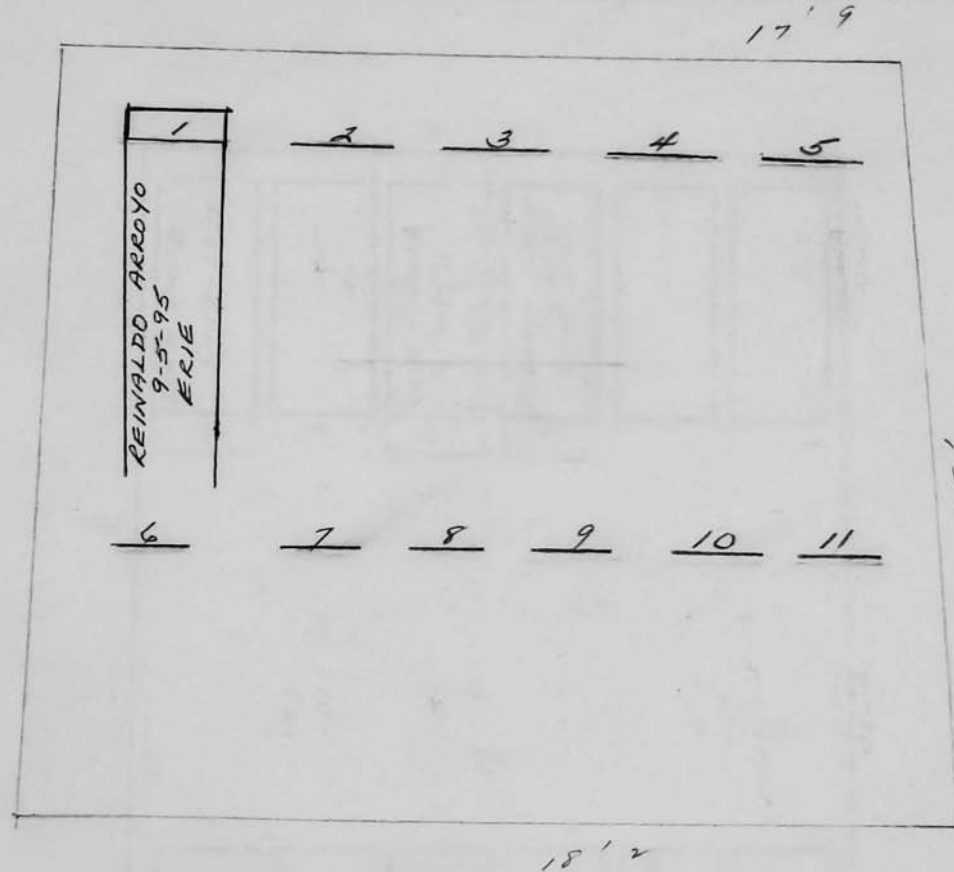

Scale ft. = 1 inch

RIVERSIDE CEMETERY, PLOT RECORD

BLOCK
SECTION

G-5

LOT NO.

51

Clarence E. Jennings

See File -

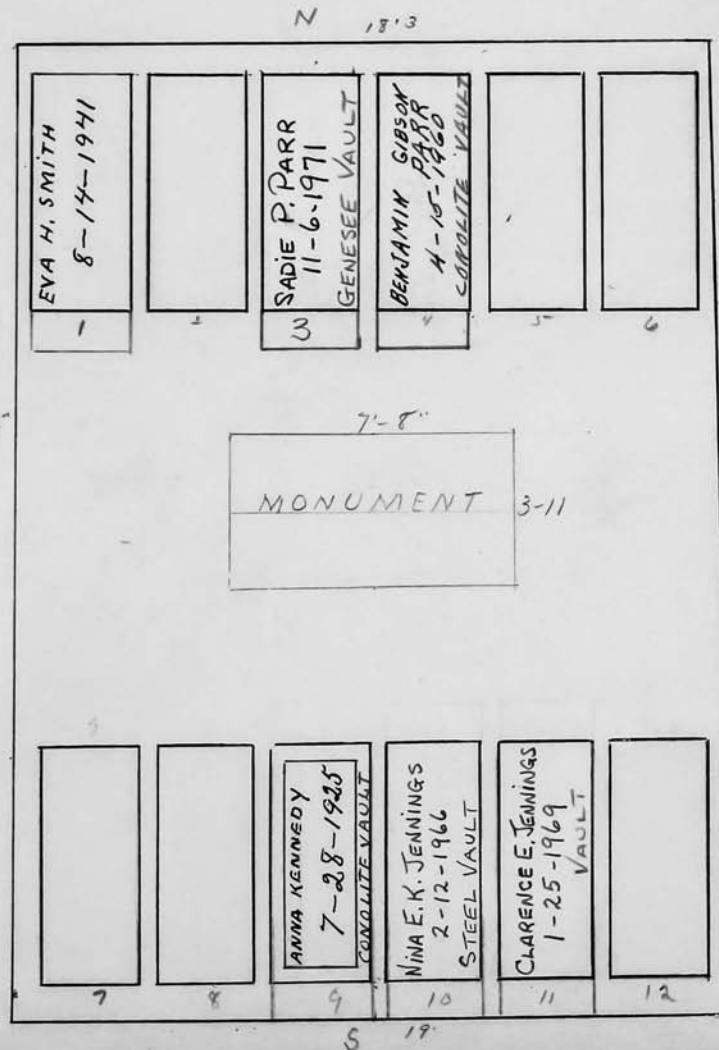

Scale 4 ft. = 1 inch

Sections G-4 and G-5

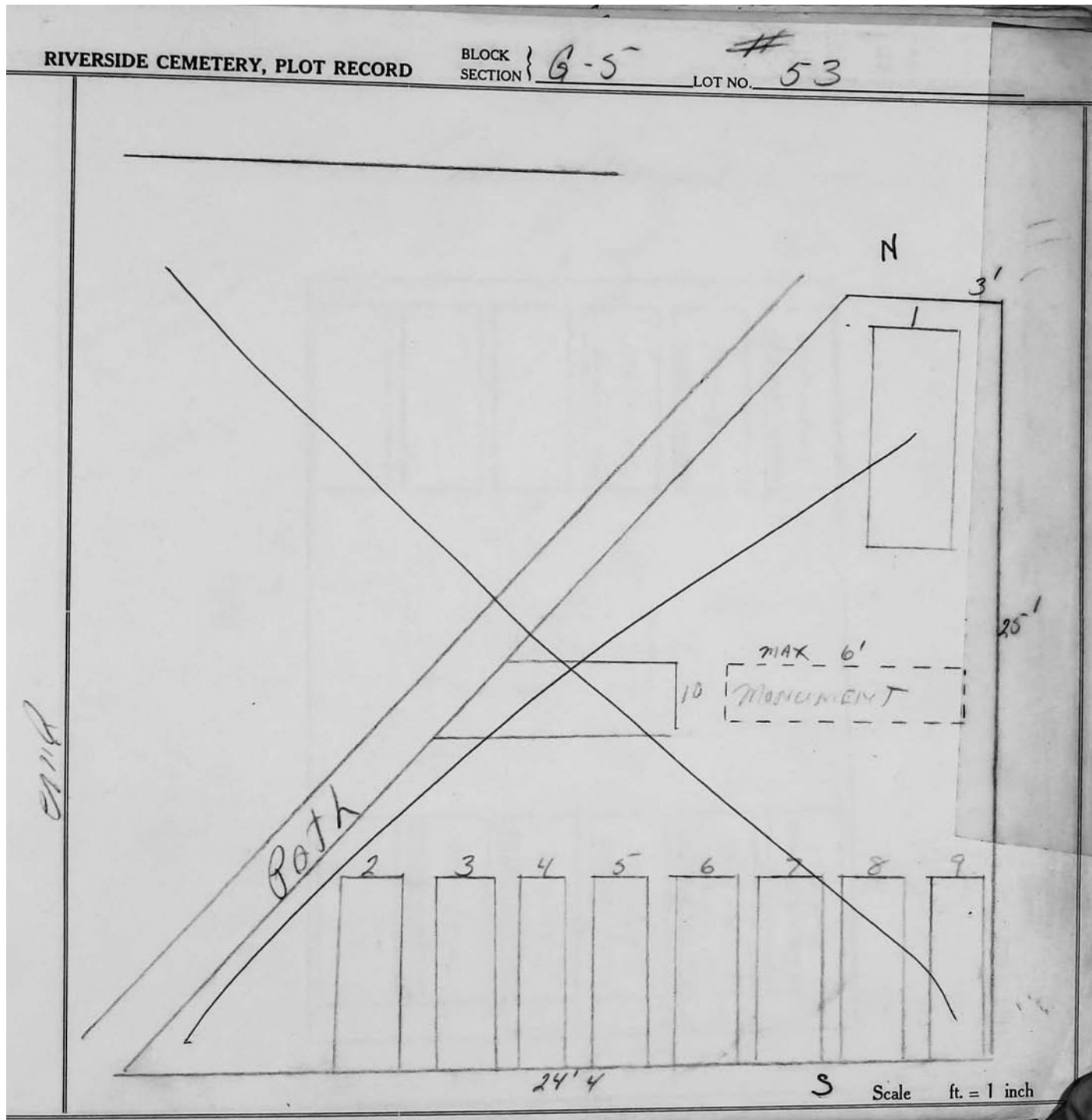

RIVERSIDE CEMETERY, PLOT RECORD

BLOCK
SECTION

G-5

LOT NO.

54

Henry Lester and Margaret, his wife

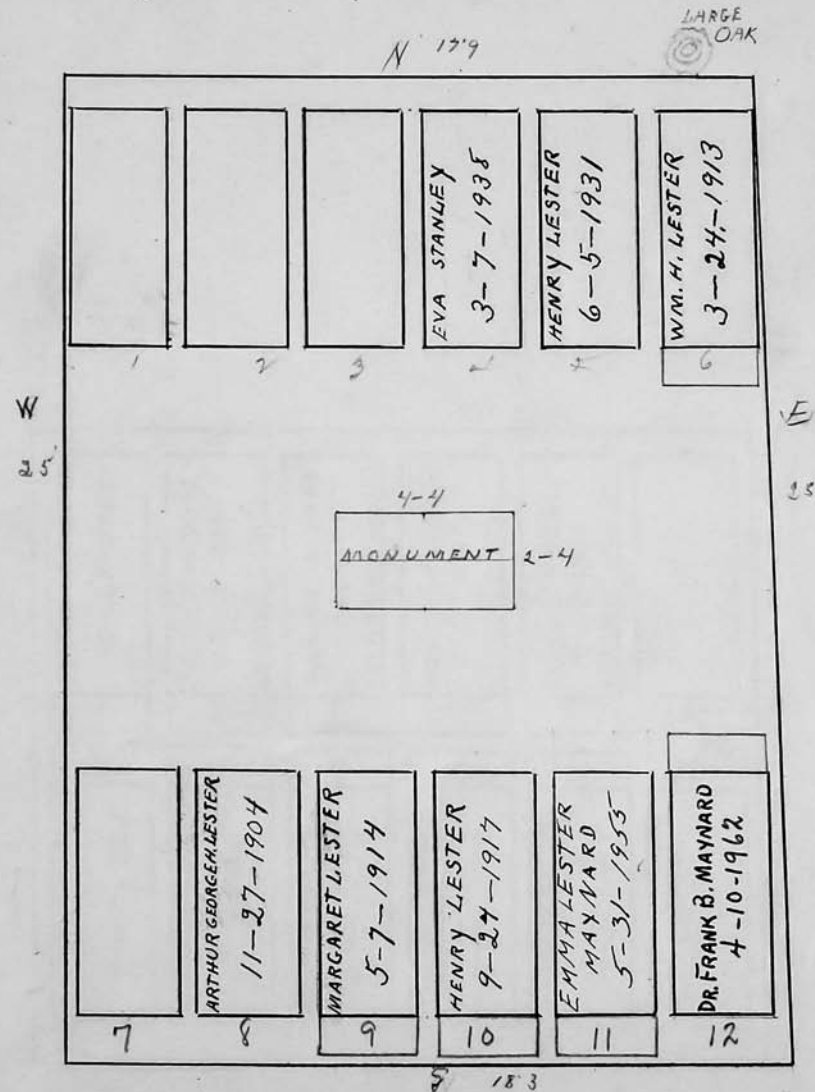
Carl L. Maynard
son of Emma +
Dr. F. B. Maynard

Scale 4 ft. = 1 inch

RIVERSIDE CEMETERY, PLOT RECORD

BLOCK
SECTION

G-5

LOT NO.

72

Alvin J. Brown

see file

FRANCES J. LOYSEN 12-23-1929	1	CATHERINE C. WARNER 8-19-1925	7
JESSIE MAY WOOD 3-12-1956 WILBERT VAULT	2	DOROTHY E. BROWN 1-2-1945	8
WILLIAM H. WOOD 9-10-1951 WILBERT VAULT	3	ALVIN T. BROWN 6-11-1946	9
HARRIS HENRY SNELL 10-28-1968 WILBERT VAULT	4	GERTRUDE GIBSON BROWN 3-4-1903	10
DORIS E. SNELL 9-18-1970 WILBERT VAULT	5	MARGUERITE B. MC FADDAN 3-31-1924	11
RES. CAROL ANN SNELL GEORGE	6		12

GRANT, NIECE OF ALVIN BROWN
416 OLD MIDDLE ST.
GOSHEN, CT. 06956
800-491-2117
SOLE SURVIVING HEIR

Scale 4 ft. = 1 inch

RIVERSIDE CEMETERY, PLOT RECORD

BLOCK
SECTION

G-5

LOT NO.

73

Addie E. Nichols

1 ALYN L. KING 5-15-1902	2 MARY F. MCKEE 1-26-1920	3 MARY NICHOLS 12-27-1928	4 LUCY TANNER 6-20-1932	5 EDWARD TANNER 5-22-1935 STEEL VAULT	6 HARRIET F. TANNER 7-15-77 MONUMENT
7 WILLIAM BROWN 5-15-1902	8 ABBIE BROWN 5-15-1902	MONUMENT 1-6		11 ADDIE E. NICHOLS 4-19-1940	12 CHARLES HENRY NICHOLS 3-3-1922

See file

Scale 4 ft. = 1 inch

RIVERSIDE CEMETERY, PLOT RECORD

BLOCK
SECTION

G-5

LOT NO.

74

Mary L. Rowell

E

16

N 18'6"

4-6

MONUMENT

2-2

W

1	2	3	4	5	6
	ALBERT W. ROWELL 11-27-1946	EVA ROWELL 12-12-1902	MORTIMER H. ROWELL 6-13-1921	MARY LUCINDA ROWELL 11-3-1930	HOMER H. ROWELL 12-25-1923

S 18'4"

Scale 4 ft. = 1 inch

RIVERSIDE CEMETERY, PLOT RECORD

BLOCK SECTION } *G-5* LOT NO. **75**

P.C.

Betsy A. Davis & John William Day

*Call 4 any time
week & visiting
Joie Day Sehnung
168 Birchwood Dr
3331630*

N 152°

7	EARL DAVIS DAY 6-6-1957	8	MILDRED E. DAY 1-19-1988	4-0	MONUMENT	4-0	Reserved Ralph	Reserved Joie			
1		2	JOHN WILLIAM DAY 4-26-1937	3	ADAH B. DAY 1-19-1926	4	ETHAN W. DAVIS 9-30-1899	5	BETSY A. DAVIS 3-15-1905	6	

16'

18'4"

16'

Scale 4 ft. = 1 inch

RIVERSIDE CEMETERY, PLOT RECORD

BLOCK
SECTION

G-5

LOT NO.

76

Elizabeth McDonald and Robert Mac Donald

Look.

17

16

BERTHA McDONALD
FLEMING
12-8-1910

WILLIAM EDGAR
MC DONALD
6-21-1902

ELIZABETH
MC DONALD
4-28-1915

EVA YULE
4-13-1959

Res. for
mosier family

ALBERT C. MOSIER
11-22-1963
LIVINGSTON VAULT

JEAN R FELLOWS
(mosier)
12-22-2003
MONTICELLO

ROBERT MACDONALD
12-6-1917

LOUISE MALE
1-2-1934

CHARLES H. MALE
1-2-1934

ROBERT L. MALE
4-6-1934

see file

13' 6" NORTH

Scale 1/4" ft. = 1 inch

RIVERSIDE CEMETERY, PLOT RECORD

BLOCK
SECTION

G

5

LOT NO.

77

E. Roy and

Dorothy E. Birkicht

P. C.

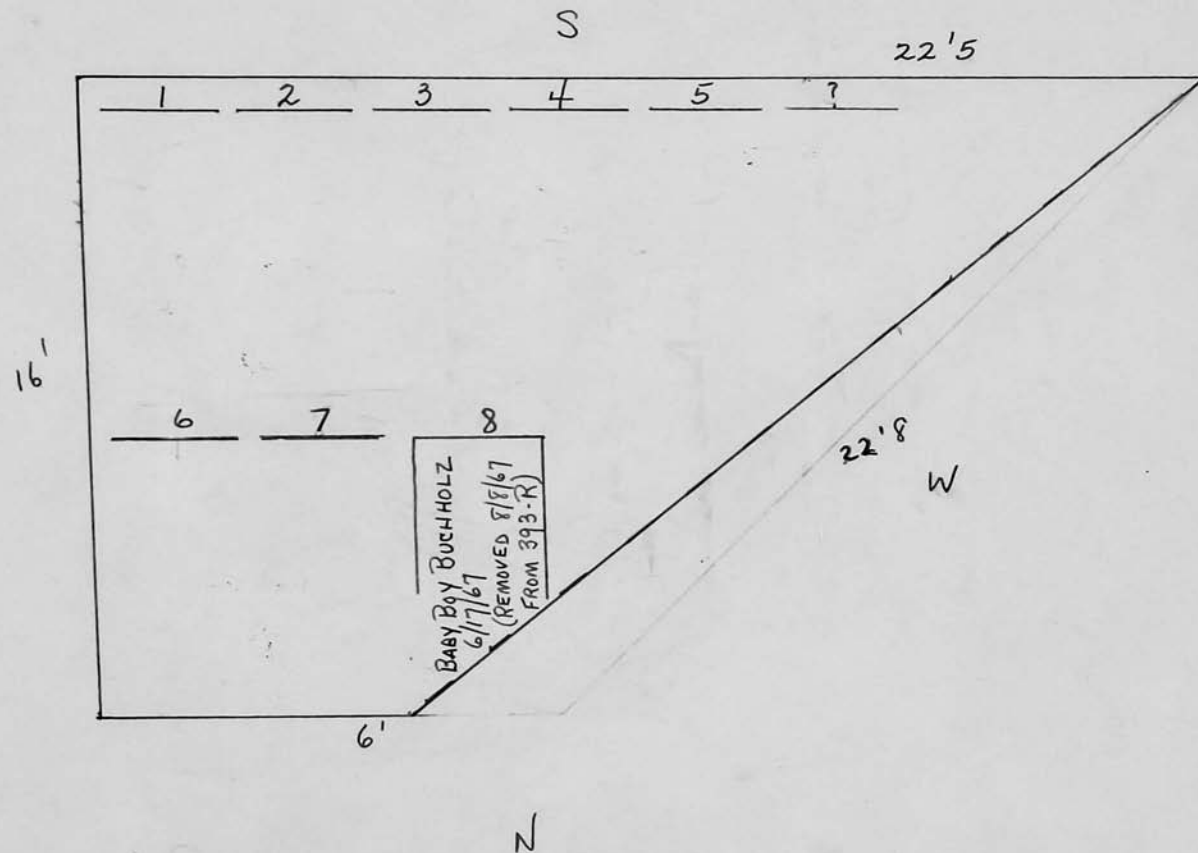

Scale ft. = 1 inch

RIVERSIDE CEMETERY, PLOT RECORD

BLOCK
SECTION

G-5

LOT NO.

78

Fred S. Todd

*Harriett Keutmann
ashes to go in #8
with husband Ernest Henry
marker has both names*

